

## Andrew Currin

---

**From:** Andrew Currin  
**Sent:** Tuesday, August 18, 2020 9:07 AM  
**To:** 'Misty Lyons'; maggiemay020283@gmail.com  
**Subject:** RE: Lot 4 Ashe Ave  
**Attachments:** Requirements for Submittals of Soil Reports and Pretreatment Systems.pdf

Misty & Maggie,

In consultation with our office the report you filed and existing markings on the property do not allow for approval at this time.

- 1) The Soil Report sent over is for an Engineered Option Permit (EOP) originally documented by Pittman Soil Consulting. Due to the advanced system (TS-II Pretreatment) repair, a detailed proposal must be provided by a Licensed Soil Scientist (LSS). Additionally, due to the tight and shallow nature, an onsite layout of initial and repair is required. The lot cannot be approved without a detailed proposal and onsite layout. Attached you will find guidance of the requirements for submittal for the Licensed Soil Scientist (LSS).
- 2) Surveyed Property Irons shall be exposed and clearly visible. Surveyed property lines shall be clearly marked in vicinity of home site (left side, front).
- 3) Revised SWMH location – Per the proposed soil report, the SWMH will need to be relocated and site plan revised to be out of whatever septic layout is proposed by your Licensed Soil Scientist (LSS).

Note: The rough layout proposed by the Soil Scientist is for a gravity system. Due to landscape position, gravity requirements, and size of system I would factor in the initial system being a pump system but I will let the Soil Scientist propose.

Thank you! If you have any questions comments, or concerns feel free to call.

Andrew Currin, REHS  
Harnett County Health Department  
Environmental Health Specialist  
910.893.7547

**From:** Misty Lyons <mistylyonskw@gmail.com>  
**Sent:** Monday, August 17, 2020 10:59 AM  
**To:** Andrew Currin <acurrin@harnett.org>; maggiemay020283@gmail.com  
**Subject:** Lot 4 Ashe Ave

CAUTION: This email originated from outside of the organization. Do not click links or open attachments unless you recognize the sender and know the content is safe.

Good morning Andrew,

Just reach out to see if you have been able to review the soil documents I sent last week.

--

Kind regards,

**PITTMAN SOIL CONSULTING**

Owner: ASHE TRAIL  
 Address: LOT 4  
 Location: ASHE AVENUE

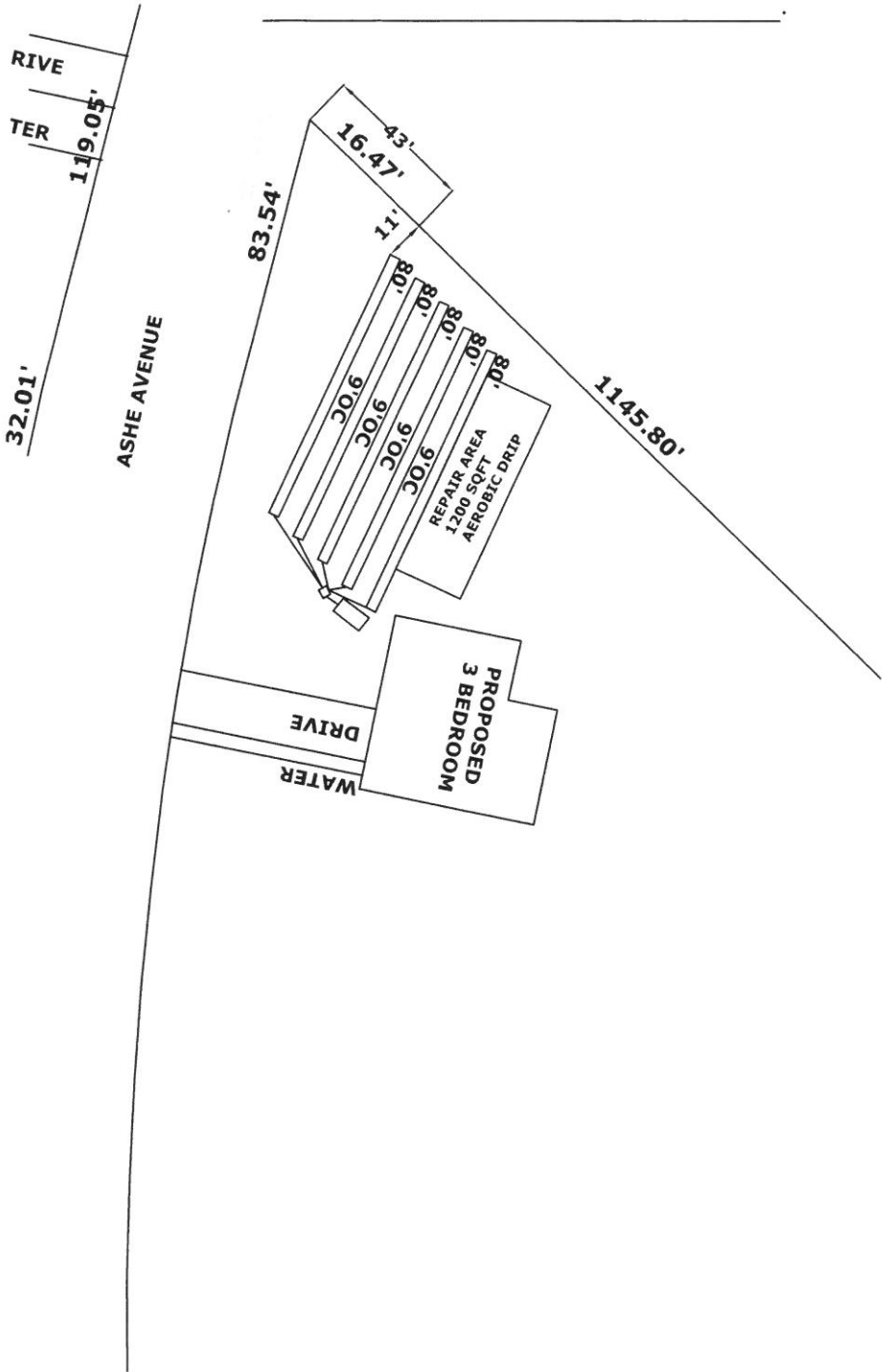

**SOIL BORE(TYP)**  
 0-12 SL, GR, VFR, NEXP, 2.5Y 4/3  
 12-15 SL, GR, VFR, NEXP, 2.5Y 5/4  
 15-22 CL, SBK, SS, SP, FI 10YR 5/8  
 22-36 CL, SBK, SS, SP, FI, 10YR 5/8, 2.5Y 6/1

**SOIL BORE(TYP)**  
 0-12 SL, GR, VFR, NEXP, 2.5Y 4/3  
 12-14 SL, GR, VFR, NEXP, 2.5Y 5/4  
 14-20 CL, SBK, SS, SP, FI, 10YR 5/8  
 20-36 CL, SBK, SS, SP, FI, 10YR 5/8, 2.5Y 6/1



**INITIAL**  
 3 BEDROOM  
 LTAR .3  
 5-80' LOW PROFILE CHAMBER LINES  
 12" TB  
 >6" SOIL COVER REQUIRED OVER  
 SYSTEM AND 5' BEYOND SYSTEM

**REPAIR AREA**  
 3 BEDROOMS  
 LTAR .3  
 1200 SQ' AEROBIC DRIP  
 TS-II PRETREATMENT  
 6" TB  
 >6" SOIL COVER REQUIRED OVER  
 SYSTEM AND 5' BEYOND SYSTEM

**APPROX SCALE 1"=50'**