

Shirley D. Hinson  
 1196 Middle Rd.  
 Dunn NC  
 28333

S-TANK LINES

SEPTIC TANK

HOUSE

JAMES & ASHLEY HINSON  
1196 MIDDLE RD,  
DUNN, NC 28534  
HARNETT COUNTY

ACCESS AT ROAD

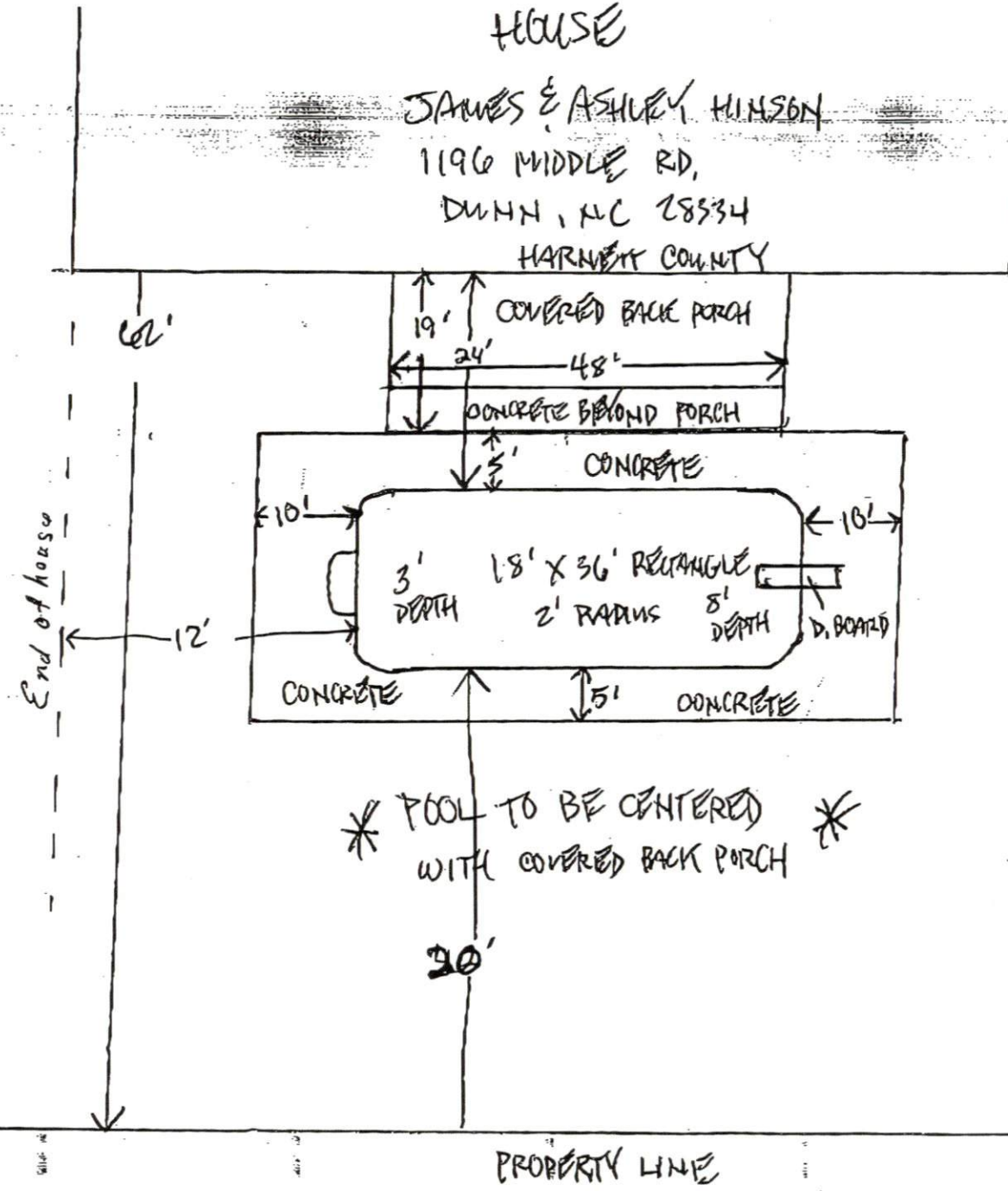

Pool from house  
24'  
Pool from edge of house  
12'  
Pool from edge of  
Back Property  
20'

\* POOL TO BE CENTERED  
WITH COVERED BACK PORCH \*

PROPERTY LINE