

Date: 18 May 20

Application #: \_\_\_\_\_

**PROCEDURES AND GUIDELINES FOR MANUFACTURED HOMES**  
**Replacement & Removal Criteria and Certification**

I, Brandon Wood, do hereby certify the following:  
(Print Name)

1. That I own a tract of land located on SR \_\_\_\_\_ in an RA-30 / RA-40 or RA-20R RA-20M zoning district which has a functional septic tank;
2. That the existing single double-wide manufactured home is to be removed or was removed on July 2020 (date)
3. That I am replacing an existing (circle one) single wide double wide manufactured home with a (circle one) single wide double wide manufactured home or other residential structure, and;
4. That the replacement of this manufactured home creates 1 residence(s) on this single tract of land, and;
5. That there will be 2 manufactured home(s) on this single tract of land and I (circle one) do do not own property within 500 feet of this tract that contains a manufactured home.
6. The home must have a pitched roof, for a manufactured home, whether A-shaped or rounded, which has a minimum rise of twelve (12) inches for every seven (7) feet of width. (See diagram)

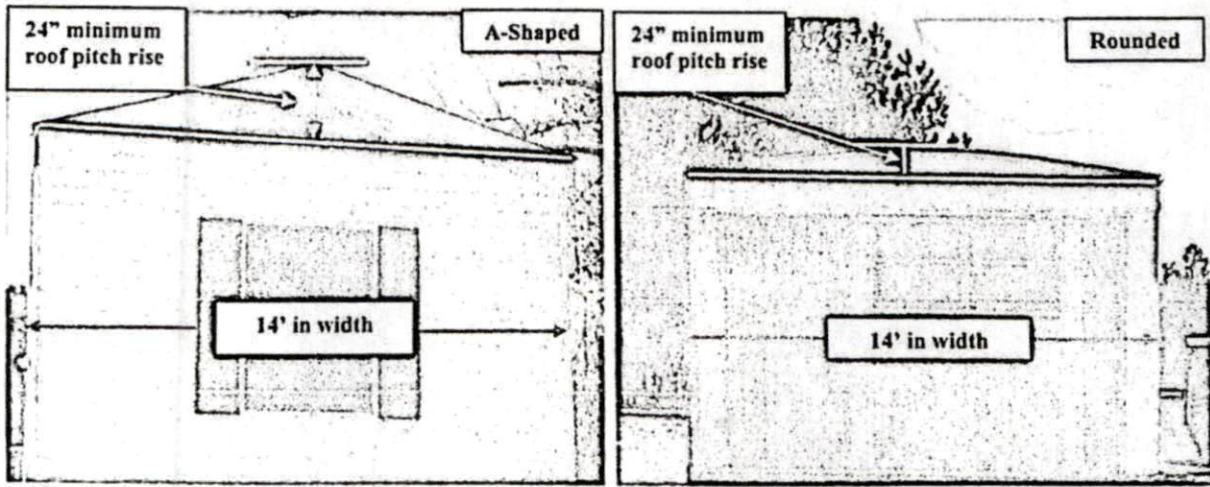

Note: Most rounded roofs will not meet the roof pitch requirement as illustrated. The measurement from the peak of the roof to the base line of the roof must be 12" for every 7" of total width of the home. (Example: 14' wide home = 24" roof rise)

Continued...



