

4000032

HARRIS COUNTY HEALTH DEPARTMENT
ENVIRONMENTAL HEALTH SECTION

No 14837

OPERATIONS PERMIT

Name: (owner) Gibson Const. New Installation Septic Tank
 Property Location: SR# 1486 Repairs Nitrification Line
 Subdivision Ne. 11s Creek Farms Phs Dist 3 Lot # 56
 TAX ID# _____ Quadrant # _____
 Contractor: Licky Holland Registration # _____

Basement with Plumbing: Garage:
 Water Supply: Well Public Community
 Distance From Well: 50 ft.

Following are the specifications for the sewage disposal system on above captioned property.

Type of system: Conventional Other Pump to Conventional
 Size of tank: Septic Tank: 1000 gallons Pump Tank: 1000 gallons
 Subsurface Drainage Field No. of ditches 4 exact length of each ditch 80 ft. width of ditches 3 ft. depth of ditches 18 in.
 French Drain: _____ Linear feet

Date: 11-15-00
 Inspected by: James E. Manhart Environmental Health Specialist

PERMIT NO. 13771

Tanks + Ditches Ok 11/6/2000 BM
 * Needs pump, alarm + D-Box tube checked

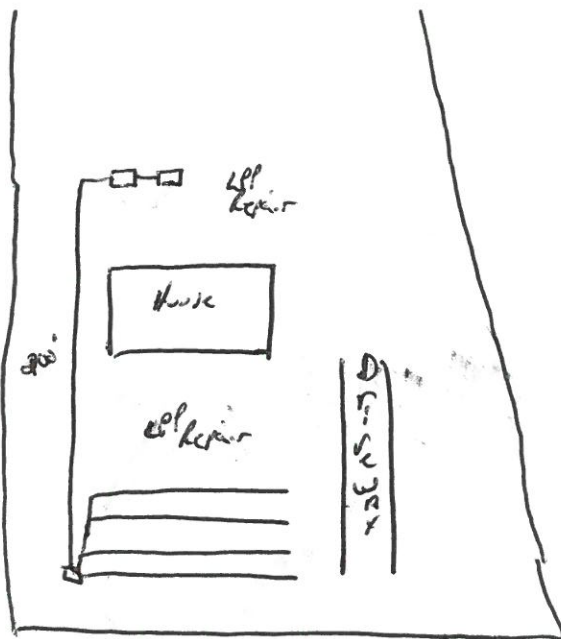

LV# 4000032

HARNETT COUNTY HEALTH DEPARTMENT

No 13771

IMPROVEMENT PERMIT

Be it ordained by the Harnett County Board of Health as follows: Section III, Item B. "No Person shall begin construction of any building at which a septic tank system is to be used for disposal of sewage without first obtaining a written permit from the Harnett County Health Department."

Name: (owner) Gibson Contractors New Installation Septic Tank
Property Location: SR# 1486 Green level Dr. Repairs Nitrification Line

Subdivision McIlly Creek Farms Phs I Sect 3 Lot # 5356B

Tax ID # _____ Quadrant # _____

Number of Bedrooms Proposed: 4 Lot Size: 1.607 Ac

Basement with Plumbing: Garage:

Water Supply: Well Public Community

Distance From Well: 50 mi - ft.

Following is the minimum specifications for sewage disposal system on above captioned property. Subject to final approval.

Type of system: Conventional Other Pump to Conventional

Size of tank: Septic Tank: 1000 gallons Pump Tank: 1000 gallons

Subsurface Drainage Field No. of ditches 4 exact length of each ditch 80 ft. width of ditches 3 ft. depth of ditches 18 in. MAX

French Drain Required: _____ Linear feet

Date: 2/11/2000

Signed: Bryan M. Swain R.S. Environmental Health Specialist

This permit is subject to revocation if site plans or intended use change.

- * Maintain setbacks
* Run lines on contour
* Ditches to be NO DEEPER THAN 18 INCHES

