

1 N

135 Green level Rd  
Anger NC 27501

225'  
Back wash / Discharge line  
to storm drain on St.

(Pool has cartridge filter, no  
backwashing needed. Draining  
a vinyl pool will cause major  
damage and should only be done  
for liner changes.)

ISA

House 3800  
Drive/walk 3600  
Total = 7400

proposed Pool = 637  
Patio

Proposed total 8037

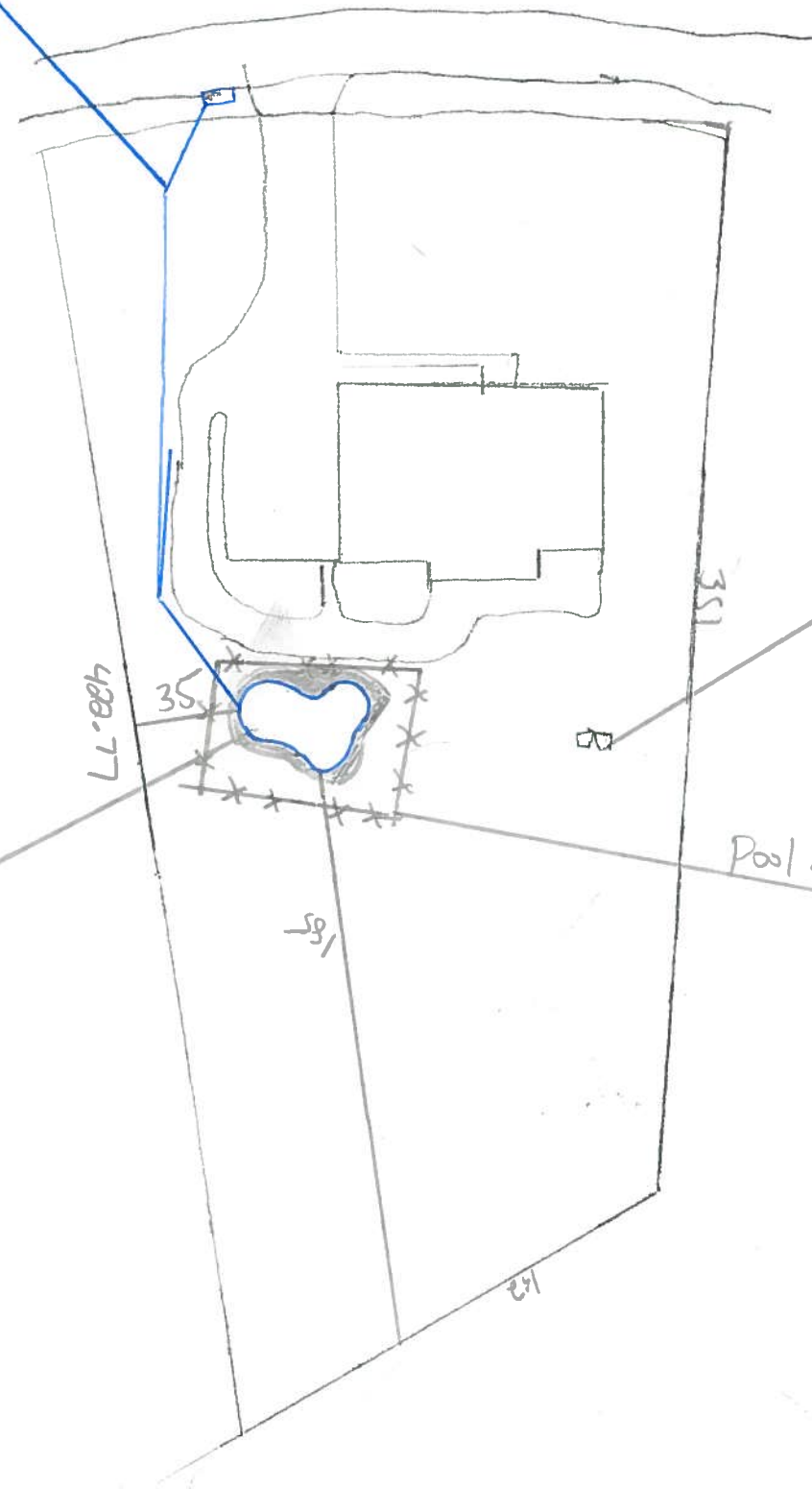

Pool 18x37x29

septic tanks

Pool approved fence