

Harnett County Department of Public Health Improvement Permit

A building permit cannot be issued with only an Improvement Permit

ISSUED TO: Karina & Malcom Stone PROPERTY LOCATION: 3325 Cokesbury Road (S21403)
 SUBDIVISION: Wilburn Horace Abernathy LOT # 1
 NEW REPAIR EXPANSION
 Type of Structure: 3-Bedroom 32'x68' DWMT
 Proposed Wastewater System Type: 25% Reduction Sys.
 Projected Daily Flow: 360 GPD
 Number of bedrooms: 3 Number of Occupants: 6 max
 Basement Yes No
 Pump Required: Yes No May be required based on final location and elevations of facilities
 Type of Water Supply: Community Public Well Distance from well NA feet
 Permit valid for: Five years No expiration
 Permit conditions: _____

Authorized State Agent: [Signature] Date: 01/17/2020 SEE ATTACHED SITE SKETCH
 The issuance of this permit by the Health Department in no way guarantees the issuance of other permits. The permit holder is responsible for checking with appropriate governing bodies in meeting their requirements. This site is subject to revocation if the site plan, plat, or the intended use changes. The Improvement Permit shall not be affected by a change in ownership of the site. This permit is subject to compliance with the provisions of the Laws and Rules for Sewage Treatment and Disposal and to conditions of this permit.

Construction Authorization

(Required for Building Permit)

The construction and installation requirements of Rules .1950, .1952, .1954, .1955, .1956, .1957, .1958, and .1959 are incorporated by references into this permit and shall be met. Systems shall be installed in accordance with the attached system layout.

ISSUED TO: Karina & Malcom Stone PROPERTY LOCATION: 3325 Cokesbury Road (S21403)
 SUBDIVISION: Wilburn Horace Abernathy LOT # 1
 Facility Type: 3-BR 32'x68' DW New Expansion Repair
 Basement? Yes No Basement Fixtures? Yes No
 Type of Wastewater System** 25% Reduction System (Initial) Wastewater Flow: 360 GPD
 (See note below, if applicable)
25% Reduction System (Repair)
 Installation Requirements/Conditions
 Septic Tank Size 1000 gallons
 Pump Tank Size _____ gallons
 Number of trenches 3
 Exact length of each trench 100 feet
 Trenches shall be installed on contour at a
 Maximum Trench Depth of: 20 inches
 (Trench bottoms shall be level to +/-1/4"
 in all directions)
 Trench Spacing: 9 Feet on Center
 Soil Cover: 8 inches
 (Maximum soil cover shall not exceed
 36" above the trench bottom)
 Pump Requirements: _____ ft. TDH vs. _____ GPM
 Aggregate Depth: NA inches below pipe
NA inches above pipe
NA inches total
 Conditions: Gravity to D-Box Equal Distribution Required

**WATER LINES (INCLUDING IRRIGATION) MUST BE 10FT. FROM ANY PART OF SEPTIC SYSTEM OR REPAIR AREA.
 NO UTILITIES ALLOWED IN INITIAL OR REPAIR DRAIN FIELD AREA.**

**If applicable: I understand the system type specified is different from the type specified on the application. I accept the specifications of this permit.
 Owner/Legal Representative Signature: _____ Date: _____

This Construction Authorization is subject to revocation if the site plan, plat, or the intended use changes. The Construction Authorization shall not be transferred when there is a change in ownership of the site. This Construction Authorization is subject to compliance with the provisions of the Laws and Rules for Sewage Treatment and Disposal and to the conditions of this permit. SEE ATTACHED SITE SKETCH

Authorized State Agent: [Signature] Date: 01/17/2020
ANDREW WARRIN Construction Authorization Expiration Date: 01/17/2025

Application # BRES2001-0007

Harnett County Department of Public Health Site Sketch

Property Location: 3325 Cokesbury Road (SR 1403)

Issued To: Katrina & Malcom Stone Subdivision Wilbur Horace Abernethy Lot # 1

Authorized State Agent: *Andrew Corbin* Date: 01/17/2026

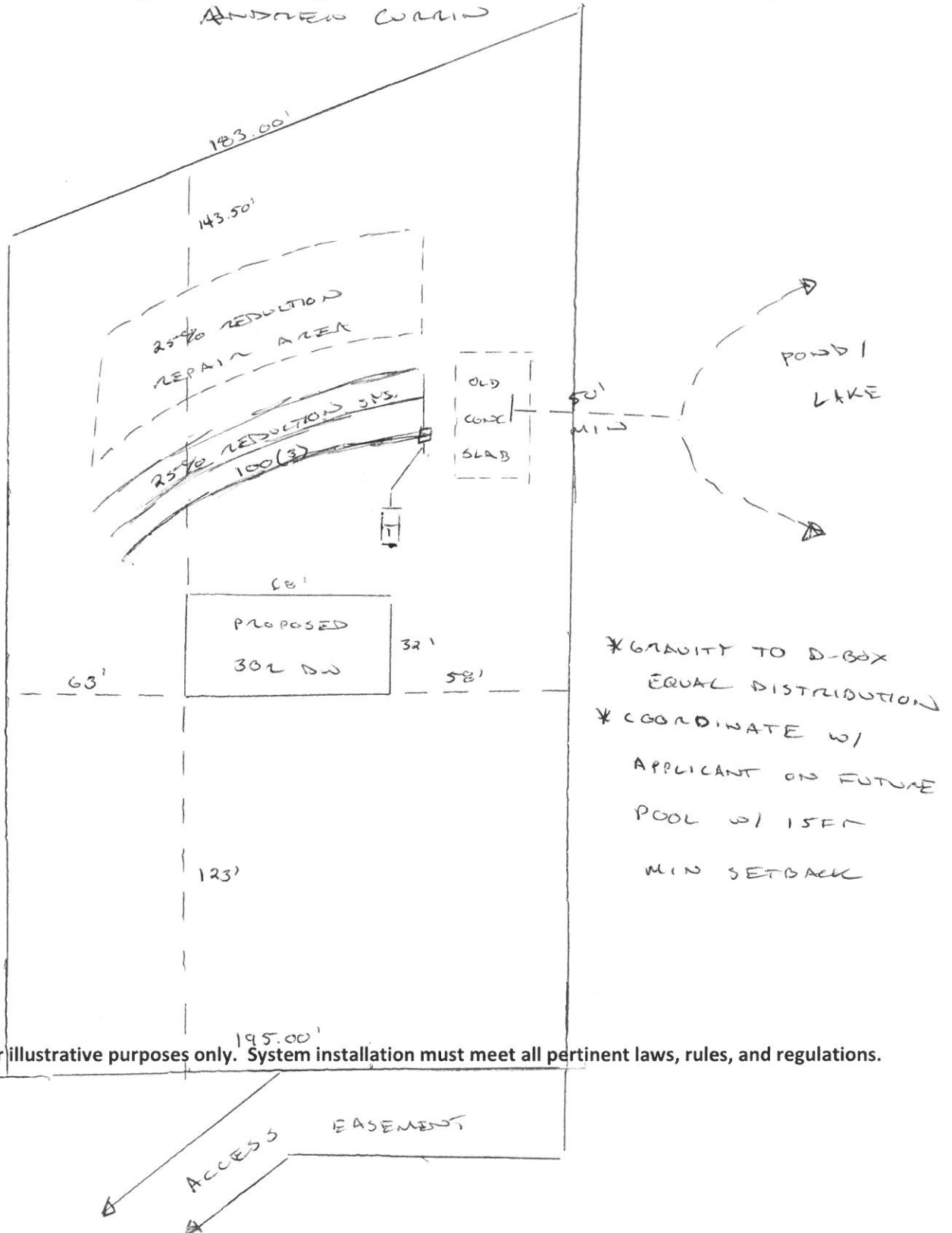

This drawing is for illustrative purposes only. System installation must meet all pertinent laws, rules, and regulations.