

# Harnett County Department of Public Health

## Improvement Permit

A building permit cannot be issued with only an Improvement Permit

ISSUED TO: Shirlene Walker      PROPERTY LOCATION: 22 Haynes St, Cameron (SR#1155)  
 SUBDIVISION \_\_\_\_\_ LOT # \_\_\_\_\_  
 NEW  REPAIR  EXPANSION       Site Improvements required prior to Construction Authorization Issuance: \_\_\_\_\_  
 Type of Structure: DWMH 28'x52'  
 Proposed Wastewater System Type: 25% Reduction  
 Projected Daily Flow: 360 GPD  
 Number of bedrooms: 3      Number of Occupants: 6 max  
 Basement  Yes  No  
 Pump Required:  Yes  No  May be required based on final location and elevations of facilities  
 Type of Water Supply:  Community  Public  Well      Distance from well \_\_\_\_\_ feet      Permit valid for:  Five years  
 Permit conditions: \_\_\_\_\_  No expiration

Authorized State Agent: *[Signature]*      Date: 12/5/2019      SEE ATTACHED SITE SKETCH  
 The issuance of this permit by the Health Department in no way guarantees the issuance of other permits. The permit holder is responsible for checking with appropriate governing bodies in meeting their requirements. This site is subject to revocation if the site plan, plat, or the intended use changes. The Improvement Permit shall not be affected by a change in ownership of the site. This permit is subject to compliance with the provisions of the Laws and Rules for Sewage Treatment and Disposal and to conditions of this permit.

## Construction Authorization

(Required for Building Permit)

The construction and installation requirements of Rules .1950, .1952, .1954, .1955, .1956, .1957, .1958, and .1959 are incorporated by references into this permit and shall be met. Systems shall be installed in accordance with the attached system layout.

ISSUED TO: Shirlene Walker      PROPERTY LOCATION: 22 Haynes St, Cameron (SR#1155)  
 SUBDIVISION \_\_\_\_\_ LOT # \_\_\_\_\_  
 Facility Type: DWMH 28'x52'       New       Expansion       Repair  
 Basement?  Yes  No      Basement Fixtures?  Yes  No  
 Type of Wastewater System\*\* 25% Reduction      (Initial) Wastewater Flow: 360 GPD  
 (See note below, if applicable  25% Reduction (Repair))

<u>Installation Requirements/Conditions</u>		Number of trenches <u>1</u>
Septic Tank Size <u>1000</u> gallons	Exact length of each trench <u>200</u> feet	Trench Spacing: <u>9</u> Feet on Center
Pump Tank Size _____ gallons	Trenches shall be installed on contour at a Maximum Trench Depth of: <u>18</u> inches (Trench bottoms shall be level to +/-1/4" in all directions)	Soil Cover: <u>6</u> inches (Maximum soil cover shall not exceed 36" above the trench bottom)
Pump Requirements: _____ ft. TDH vs. _____ GPM		Aggregate Depth: _____ inches below pipe _____ inches above pipe _____ inches total

Conditions: \_\_\_\_\_

**WATER LINES (INCLUDING IRRIGATION) MUST BE 10FT. FROM ANY PART OF SEPTIC SYSTEM OR REPAIR AREA.  
 NO UTILITIES ALLOWED IN INITIAL OR REPAIR DRAIN FIELD AREA.**

\*\*If applicable: I understand the system type specified is different from the type specified on the application. I accept the specifications of this permit.

Owner/Legal Representative Signature: \_\_\_\_\_ Date: \_\_\_\_\_

This Construction Authorization is subject to revocation if the site plan, plat, or the intended use changes. The Construction Authorization shall not be transferred when there is a change in ownership of the site. This Construction Authorization is subject to compliance with the provisions of the Laws and Rules for Sewage Treatment and Disposal and to the conditions of this permit.      SEE ATTACHED SITE SKETCH

Authorized State Agent: *[Signature]*      Date: 12/5/2019  
 Construction Authorization Expiration Date: 12/5/2024

Application # BRES1911-0022

### Harnett County Department of Public Health Site Sketch

Property Location: 22 Haynes St, Cameron (SR#1155)  
Issued To: Shirlene Walker Subdivision \_\_\_\_\_ Lot # \_\_\_\_\_

Authorized State Agent: Butt Adh REHS Date: 12/5/19

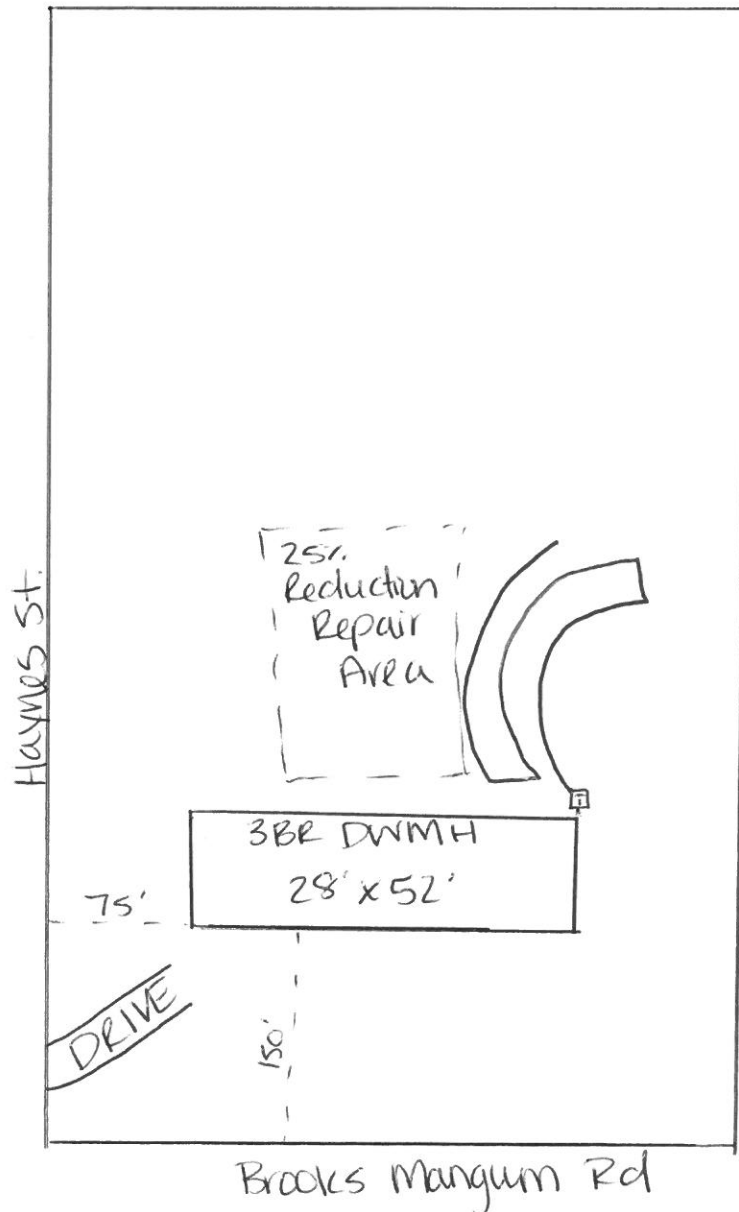

This drawing is for illustrative purposes only. System installation must meet all pertinent laws, rules, and regulations.