

Harnett County Department of Public Health Improvement Permit

A building permit cannot be issued with only an Improvement Permit

ISSUED TO: Tanya Parrish Grant PROPERTY LOCATION: SR 2005 BRICKMILL RD SUBDIVISION _____ LOT # _____

NEW REPAIR EXPANSION Site Improvements required prior to Construction Authorization Issuance: _____

Type of Structure: EX BLDG

Proposed Wastewater System Type: 25% RAD

Projected Daily Flow: 100 GPD

Number of bedrooms: _____ Number of Occupants: _____ max

Basement Yes No

Pump Required: Yes No May be required based on final location and elevations of facilities

Type of Water Supply: Community Public Well Distance from well _____ feet Permit valid for: Five years No expiration

Permit conditions: _____

Authorized State Agent:  Date: 06/29/2020 SEE ATTACHED SITE SKETCH

The issuance of this permit by the Health Department in no way guarantees the issuance of other permits. The permit holder is responsible for checking with appropriate governing bodies in meeting their requirements. This site is subject to revocation if the site plan, plat, or the intended use changes. The Improvement Permit shall not be affected by a change in ownership of the site. This permit is subject to compliance with the provisions of the Laws and Rules for Sewage Treatment and Disposal and to conditions of this permit.

Construction Authorization

(Required for Building Permit)

The construction and installation requirements of Rules .1950, .1952, .1954, .1955, .1956, .1957, .1958, and .1959 are incorporated by references into this permit and shall be met. Systems shall be installed in accordance with the attached system layout.

ISSUED TO: Tanya Parrish Grant PROPERTY LOCATION: SR 2005 Brickmill Rd SUBDIVISION _____ LOT # _____

Facility Type: EX BLDG New Expansion Repair

Basement? Yes No Basement Fixtures? Yes No

Type of Wastewater System** 25% REDUCED system (Initial) Wastewater Flow: _____ GPD

(See note below, if applicable 25% REDUCED (Repair)

Installation Requirements/Conditions

Septic Tank Size 1000 gallons Number of trenches 3

Pump Tank Size _____ gallons Exact length of each trench 35 feet Trench Spacing: 9 Feet on Center

Trenches shall be installed on contour at a Maximum Trench Depth of: 28-18 inches Soil Cover: 6 inches (Maximum soil cover shall not exceed 36" above the trench bottom)

(Trench bottoms shall be level to +/-1/4" in all directions)

Pump Requirements: _____ ft. TDH vs. _____ GPM Aggregate Depth: 6 inches below pipe 2 inches above pipe 12 inches total

Conditions: _____

**WATER LINES (INCLUDING IRRIGATION) MUST BE 10FT. FROM ANY PART OF SEPTIC SYSTEM OR REPAIR AREA.
NO UTILITIES ALLOWED IN INITIAL OR REPAIR DRAIN FIELD AREA.**

****If applicable:** I understand the system type specified is different from the type specified on the application. I accept the specifications of this permit.

Owner/Legal Representative Signature: _____ Date: _____

This Construction Authorization is subject to revocation if the site plan, plat, or the intended use changes. The Construction Authorization shall not be transferred when there is a change in ownership of the site. This Construction Authorization is subject to compliance with the provisions of the Laws and Rules for Sewage Treatment and Disposal and to the conditions of this permit. SEE ATTACHED SITE SKETCH

Authorized State Agent:  Date: 06/29/2020

ANDREW CURRAN Construction Authorization Expiration Date: 06/29/2025

Application # BRES1910-0054

Harnett County Department of Public Health Site Sketch

Property Location: SR 2005 BRICKMILL RD

Issued To: Tanya Parvish Grant Subdivision _____ Lot # _____

Authorized State Agent: ~~ANDRÉO CURRAN~~ Date: 06/29/2020
ANDRÉO CURRAN

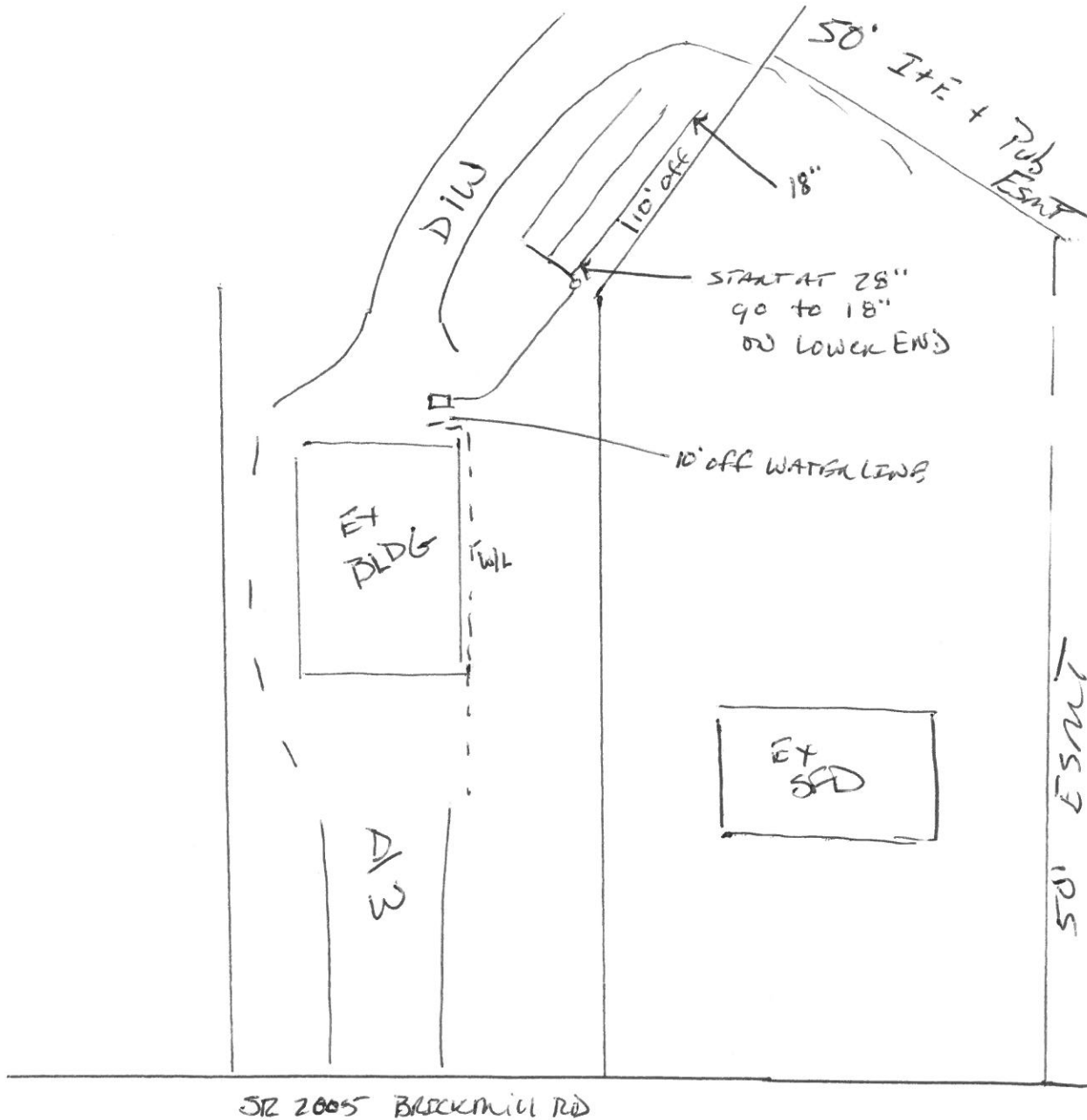

This drawing is for illustrative purposes only. System installation must meet all pertinent laws, rules, and regulations.