

28 x 56

HEAVENLY HOMES
 4629 US HWY 70 W
 PRINCETON, NC 27569
 (919)735-4400 - FAX (919)735-4494
 buyheavenlyhomes.com

BUYER(S) Christine Williams PHONE 910 890 4099 DATE 9-12-19
 ADDRESS 184 Rodeo Ln. Lillington, NC 27546 SALESPERSON R. JEFF
 DELIVERY ADDRESS 3545 US Hwy 401 S Lillington, NC 27546
 MAKE & MODEL Fleetwood Woodford 28563B YEAR 2020 BEDROOMS 3 FLOOR SIZE L 8 W 27 HITCH SIZE L 60 W 27 STOCK NUMBER _____
 SERIAL NUMBER TBA COLOR Gray PROPOSED DELIVERY DATE < 30 days KEY NUMBERS _____
 NEW USED

LOCATION	R-VALUE	THICKNESS	TYPE OF INSULATION	BASE PRICE OF UNIT	
CEILING				\$ 46,600	
EXTERIOR	<u>NC</u>	<u>Thermal zone 2</u>			OPTIONAL EQUIPMENT <u>1,000</u>
FLOORS					SUB-TOTAL \$

THIS INSULATION INFORMATION WAS FURNISHED BY THE MANUFACTURER AND IS DISCLOSED IN COMPLIANCE WITH THE FEDERAL TRADE COMMISSION RULE 16CFR SECTION 460.16.

OPTIONAL EQUIPMENT, LABOR AND ACCESSORIES	NON-TAXABLE ITEMS
	VARIOUS FEES AND INSURANCE
	CASH PURCHASE PRICE \$ <u>48,707</u>
	TRADE-IN ALLOWANCE \$
	LESS BAL. DUE on above \$
	NET ALLOWANCE \$
	CASH DOWN PAYMENT \$
	CASH AS AGREED \$
	LESS TOTAL CREDITS \$
	SUB-TOTAL \$
	SALES TAX (If Not Included Above)
	Unpaid Balance of Cash Sale Price \$

This purchase includes the new home unit, dropped off only.

Buyer is responsible for all items necessary to complete home, including, but not limited to satisfying zoning, permits, covenants, setup, inspections, and overall completion of home.

*wheels & axles were rented, will be picked up

check # 3658

Dealer and Buyer certify that the additional terms and conditions printed on the other side of this Agreement are agreed to as a part of this Agreement, the same as if printed above the signatures. Buyer is purchasing the above described manufactured home; the optional equipment and accessories, the insurance as described has been voluntary; that Buyer's trade-in is free from all claims whatsoever, except as noted.

ESTIMATED RATE OF FINANCING _____ %

NUMBER OF YEARS _____

ESTIMATED MONTHLY PAYMENTS \$ _____

THIS AGREEMENT CONTAINS THE ENTIRE UNDERSTANDING BETWEEN DEALER AND BUYER AND NO OTHER REPRESENTATION OR INDUCEMENT, VERBAL OR WRITTEN, HAS BEEN MADE WHICH IS NOT COVERED IN THIS AGREEMENT.

BUYER(S) ACKNOWLEDGE RECEIPT OF A COPY OF THIS ORDER AND THAT BUYER(S) HAVE READ AND UNDERSTAND THE BACK OF THIS AGREEMENT.

I UNDERSTAND THAT I HAVE THE RIGHT TO CANCEL THIS PURCHASE BEFORE MIDNIGHT OF THE THIRD BUSINESS DAY AFTER THE DATE THAT I HAVE SIGNED THIS AGREEMENT. I UNDERSTAND THAT THIS CANCELLATION MUST BE IN WRITING. IF I CANCEL THE PURCHASE AFTER THE THREE DAY PERIOD, I UNDERSTAND THAT THE DEALER MAY NOT HAVE ANY OBLIGATION TO GIVE ME BACK ALL OF THE MONEY THAT I PAID THE DEALER. I UNDERSTAND ANY CHANGE TO THE TERMS OF THE PURCHASE AGREEMENT BY THE DEALER WILL CANCEL THIS AGREEMENT.

NOTE: WARRANTY AND EXCLUSIONS AND LIMITATIONS OF DAMAGES ON THE REVERSE SIDE.

DESCRIPTION OF TRADE-IN	YEAR	SIZE
MAKE	MODEL	BEDROOMS
TITLE NO.	SERIAL NO.	COLOR
AMOUNT OWING TO WHOM		
ANY DEBT BUYER OWES ON TRADE-IN IS TO BE PAID BY <input type="checkbox"/> DEALER <input type="checkbox"/> BUYER		

HEAVENLY HOMES _____ DEALER

SIGNED X Christine Williams BUYER

Not Valid Unless Signed and Accepted by an Officer of the Company or an Authorized Agent

Approved By _____

SOCIAL SECURITY NO. _____

SIGNED X _____ BUYER

SOCIAL SECURITY NO. _____

The Woodford

By: Fleetwood Homes

3 Bedroom, 2 Bath

Approx. size: 27' X 56'

Approx. area: 1,512 Square Feet

~~Aid 60's~~

47⁷⁰⁰
 46⁶⁰⁰ house
 1,000 freight

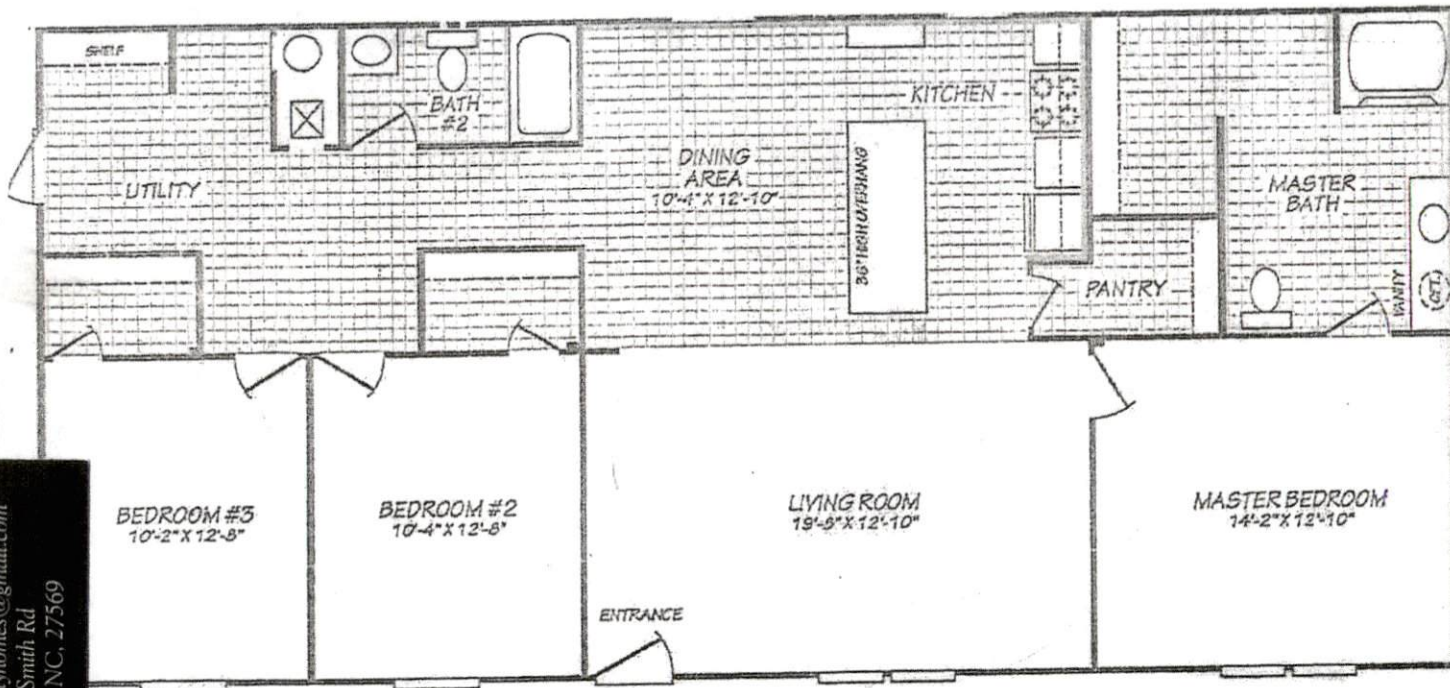

1107 tax

48,707



Heavenly Homes
 Custom Homes & Leftover Specials

Rob Jett - Owner
 919-735-4400 - fax: 735-4494
 BuyHeavenlyHomes.com
 biz@heavenlyhomes@gmail.com
 127 Luby Smith Rd
 Princeton, NC, 27569

Model # NOR28603b		Available:	Heavenly Homes
As Shown:	3 Br 2 Ba	Address:	127 Luby Smith Rd
Rough Size:	27' x 56'		Princeton, NC 27569
Doublewide / Manufactured Home		Rev. Drawing # 705132017	