

Centerline Control

COURSE	BEARING	DISTANCE
G-H	S 40°12'17"E	275.00'
H-I	S 17°42'17"E	405.64'
I-J	S 04°47'43"W	166.227'
J-K	N 85°12'17"W	25.00'

FEMA FLOOD HAZARD STATEMENT
 Lots shown on this plat are not located within the FEMA 100 year Flood Hazard Area as shown on FEMA map No. 37086C 0050D
 Effective date: April 16, 1990

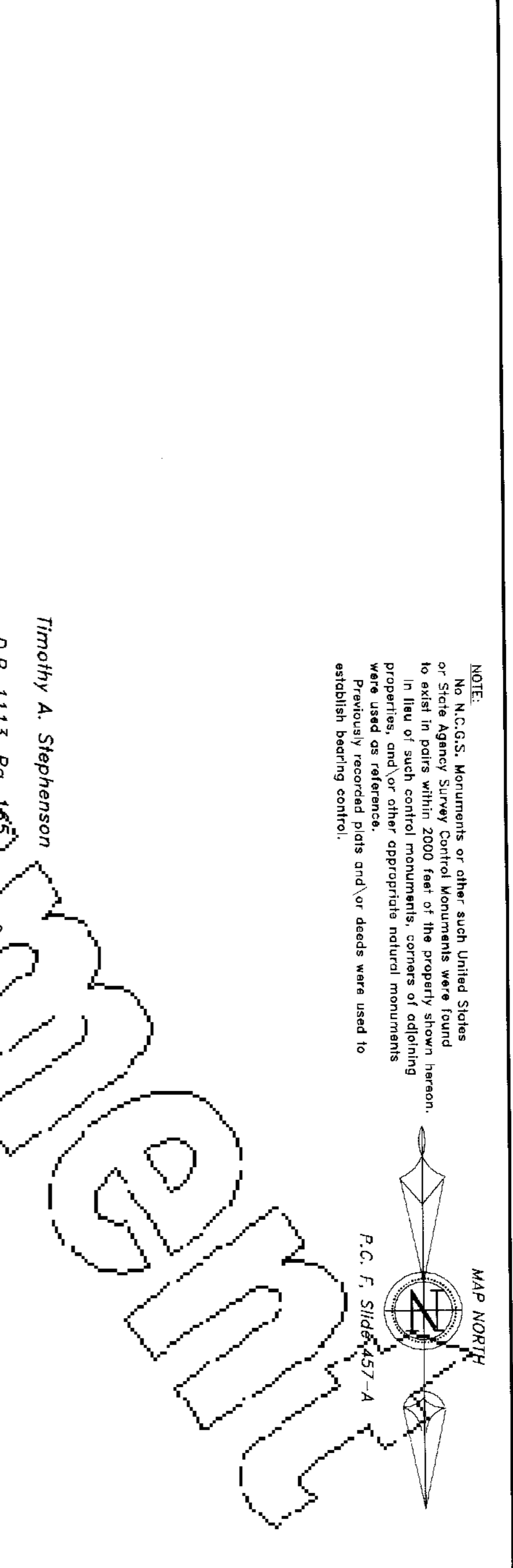

- LEGEND:**
- Lines Surveyed
 - Lines Not Surveyed
 - EP/7/5 Existing Iron Pipe or Stake
 - EPK Existing Concrete Monument
 - EPK Existing P.K. Nail
 - PKK Iron Stake Set
 - SS Cotton Spindle Set
 - RSS Railroad Spike
 - SS Existing Lightwood Stake
 - LP Light Pole
 - OHE Overhead Electric Lines
 - MAO 27 North American Datum of 1927
 - MAO 83 North American Datum of 1983
 - N.C.G.S. North Carolina Geodetic Survey
- NOTES:**
- Iron Stakes set at all property corners unless noted otherwise.
 - P.K. Nails set at all points in asphalt road surfaces, unless noted otherwise.
 - Areas determined by coordinate method.
 - All distances/dimensions are horizontal.
 - Ground distances unless otherwise indicated.
 - A 10' wide Utility Easement centered on each lot line shall extend from the street right of way line onto the lots for a distance of 20' for the installation, maintenance, monitoring and inspection of utility fixtures. No objects such as fences and landscaping which impede access to such fixtures shall be placed within this easement.

Harnett County Minimum Building Setback Requirements
 RA-30 & RA-40

FRONT: 35' from R/W
 REAR: 25'
 SIDE: 10'
 CORNER LOT SIDE: 20'

Harnett County Register of Deeds
 HARNETT COUNTY, N.C.
 FILED DATE: 11-4-03 TIME: 4:52 PM
 MAP NUMBER: 2003-1051
 REGISTER OF DEEDS
 KIMBERLY S. HANCOCK

Joseph & Billie J. Stephenson
 D.B. 1117, Pg. 888
 P.C. F. Slide 457-A
 Zone RA-30

Timothy A. Stephenson
 D.B. 1113, Pg. 165
 P.C. F. Slide 457-A
 Zone RA-30

Donald R. Andrews
 D.B. 1741, Pg. 992
 Map # 2003-297
 Zone RA-30

Graham F. Howard, Jr.
 D.B. 828, Pg. 281
 Zone RA-30

Run of Raccoon

Branch is Property Line

50' R/W

Whitfield Lee Morgan, et al.
 D.B. 1449, Pg. 793
 Zone RA-30

Wynndham Place Subdivision

Reference: Deed Bk. 1730, Pg. 249; Map # 2003-219
 Total Acreage = 26.48 Ac. Cul-de-sac Length = 2,136.89'

R. L. Properties, LLC
 221 Pope's Lake Rd., Angier, NC 27501 (919) 639-4295
 TOWNSHIP: Black River
 COUNTY: Harnett

STREAMLINE LAND SURVEYING, Inc.
 870 N.C. Hwy. 55 West, Coats, N.C. 27521
 Phone: 910-897-7715 Fax: 910-897-7284

Map For: R. L. Properties, LLC
 221 Pope's Lake Rd., Angier, NC 27501 (919) 639-4295
 TOWNSHIP: Black River
 COUNTY: Harnett

DATE: 8-12-2003
DRAWN BY: M.G.G.
CHECKED & CLOSE BY: LA30J102 B

Revisions:
 9-26-2003: per NC DOT
 11-3-2003: street name per 911 addressing

SCALE: 1" = 100'
DRAWING FILE NO.: LA30J102 B

Wynndham Place Subdivision

Previously recorded as Map # 2003-949, 951 & 953

The purpose of this plat is to revise the street name ONLY. See Map # 2003-949, 951 & 953 for Certifications and Signatures of Approval.

Sheet 2 of 3

DATA\0664\LA30J102

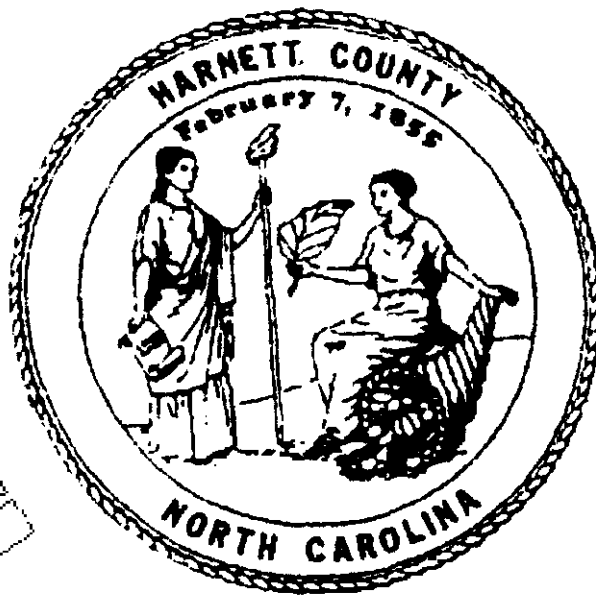

KIMBERLY S. HARGROVE
REGISTER OF DEEDS, HARNETT
305 W CORNELIUS HARNETT BLVD
SUITE 200
LILINGTON, NC 27546

Filed For Registration: 11/04/2003 04:52:29 PM
Book: PLAT 2003 Page: 1051-1052
Document No.: 2003022916
MAP 2 PGS \$21.00
Recorder: ELMIRA MCLEAN

State of North Carolina, County of Harnett

KIMBERLY S. HARGROVE , REGISTER OF DEEDS

By: Elmira McLean
Deputy/Assistant Register of Deeds

DO NOT DISCARD



2003022916