



Initial Application Date: 9-18-19

Application # BRES 1909-0041

CU# \_\_\_\_\_

**COUNTY OF HARNETT RESIDENTIAL LAND USE APPLICATION**

Central Permitting 108 E. Front Street, Lillington, NC 27546 Phone: (910) 893-7525 ext:2 Fax: (910) 893-2793 www.harnett.org/permits

**\*\*A RECORDED SURVEY MAP, RECORDED DEED (OR OFFER TO PURCHASE) & SITE PLAN ARE REQUIRED WHEN SUBMITTING A LAND USE APPLICATION\*\***

LANDOWNER: Melvin R. Cox Mailing Address: 530 Holder Road  
City: Lillington State: NC Zip: 27546 Contact No: 910-591-6462 Email: mcox9804@gmail.com

APPLICANT\*: \_\_\_\_\_ Mailing Address: \_\_\_\_\_  
City: \_\_\_\_\_ State: \_\_\_\_\_ Zip: \_\_\_\_\_ Contact No: \_\_\_\_\_ Email: \_\_\_\_\_

\*Please fill out applicant information if different than landowner  
ADDRESS: 530 Holder Rd. Lillington, NC 27546 PIN: \_\_\_\_\_

Zoning: RA-30 Flood: \_\_\_\_\_ Watershed: \_\_\_\_\_ Deed Book / Page: \_\_\_\_\_

Setbacks - Front: \_\_\_\_\_ Back: \_\_\_\_\_ Side: \_\_\_\_\_ Corner: \_\_\_\_\_

**PROPOSED USE:**

SFD: (Size \_\_\_\_\_ x \_\_\_\_\_) # Bedrooms: \_\_\_\_\_ # Baths: \_\_\_\_\_ Basement(w/wo bath): \_\_\_\_\_ Garage: \_\_\_\_\_ Deck: \_\_\_\_\_ Crawl Space: \_\_\_\_\_ Slab: \_\_\_\_\_ Slab: \_\_\_\_\_  
(Is the bonus room finished? ( ) yes ( ) no w/ a closet? ( ) yes ( ) no (if yes add in with # bedrooms)

Mod: (Size \_\_\_\_\_ x \_\_\_\_\_) # Bedrooms \_\_\_\_\_ # Baths \_\_\_\_\_ Basement (w/wo bath) \_\_\_\_\_ Garage: \_\_\_\_\_ Site Built Deck: \_\_\_\_\_ On Frame \_\_\_\_\_ Off Frame \_\_\_\_\_  
(Is the second floor finished? ( ) yes ( ) no Any other site built additions? ( ) yes ( ) no

Manufactured Home: \_\_\_\_\_ SW \_\_\_\_\_ DW \_\_\_\_\_ TW (Size \_\_\_\_\_ x \_\_\_\_\_) # Bedrooms: \_\_\_\_\_ Garage: \_\_\_\_\_ (site built? \_\_\_\_\_) Deck: \_\_\_\_\_ (site built? \_\_\_\_\_)

Duplex: (Size \_\_\_\_\_ x \_\_\_\_\_) No. Buildings: \_\_\_\_\_ No. Bedrooms Per Unit: \_\_\_\_\_

Home Occupation: # Rooms: \_\_\_\_\_ Use: \_\_\_\_\_ Hours of Operation: \_\_\_\_\_ #Employees: \_\_\_\_\_

Addition/Accessory/Other: (Size 21'4" x 16') Use: additional living space Closets in addition? ( ) yes ( ) no  
drywall + trim work only

Water Supply:  County \_\_\_\_\_ Existing Well \_\_\_\_\_ New Well (# of dwellings using well \_\_\_\_\_) \*Must have operable water before final  
(Need to Complete New Well Application at the same time as New Tank)

Sewage Supply: \_\_\_\_\_ New Septic Tank \_\_\_\_\_ Expansion \_\_\_\_\_ Relocation \_\_\_\_\_ Existing Septic Tank \_\_\_\_\_ County Sewer  
(Complete Environmental Health Checklist on other side of application if Septic)

Does owner of this tract of land, own land that contains a manufactured home within five hundred feet (500') of tract listed above? ( ) yes ( ) no

Does the property contain any easements whether underground or overhead ( ) yes ( ) no

Structures (existing or proposed): Single family dwellings: \_\_\_\_\_ Manufactured Homes: \_\_\_\_\_ Other (specify): \_\_\_\_\_

If permits are granted I agree to conform to all ordinances and laws of the State of North Carolina regulating such work and the specifications of plans submitted. I hereby state that foregoing statements are accurate and correct to the best of my knowledge. Permit subject to revocation if false information is provided.

Melvin R. Cox 9/17/19  
Signature of Owner or Owner's Agent Date

\*\*\*It is the owner/applicants responsibility to provide the county with any applicable information about the subject property, including but not limited to: boundary information, house location, underground or overhead easements, etc. The county or its employees are not responsible for any incorrect or missing information that is contained within these applications.\*\*\*

**\*This application expires 6 months from the initial date if permits have not been issued\*\***

**APPLICATION CONTINUES ON BACK**

**\*\*This application expires 6 months from the initial date if permits have not been issued\*\***

**\*This application to be filled out when applying for a septic system inspection.\***

**County Health Department Application for Improvement Permit and/or Authorization to Construct**

IF THE INFORMATION IN THIS APPLICATION IS FALSIFIED, CHANGED, OR THE SITE IS ALTERED, THEN THE IMPROVEMENT PERMIT OR AUTHORIZATION TO CONSTRUCT SHALL BECOME INVALID. The permit is valid for either 60 months or without expiration depending upon documentation submitted. (Complete site plan = 60 months; Complete plat = without expiration)

**Environmental Health New Septic System**

- **All property irons must be made visible.** Place "pink property flags" on each corner iron of lot. All property lines must be clearly flagged approximately every 50 feet between corners.
- Place "orange house corner flags" at each corner of the proposed structure. Also flag driveways, garages, decks, out buildings, swimming pools, etc. Place flags per site plan developed at/for Central Permitting.
- Place orange Environmental Health card in location that is easily viewed from road to assist in locating property.
- If property is thickly wooded, Environmental Health requires that you clean out the undergrowth to allow the soil evaluation to be performed. Inspectors should be able to walk freely around site. **Do not grade property.**
- **All lots to be addressed within 10 business days after confirmation. \$25.00 return trip fee may be incurred for failure to uncover outlet lid, mark house corners and property lines, etc. once lot confirmed ready.**

**Environmental Health Existing Tank Inspections**

- Follow above instructions for placing flags and card on property.
- Prepare for inspection by removing soil over **outlet end** of tank as diagram indicates, and lift lid straight up (*if possible*) and then **put lid back in place.** (Unless inspection is for a septic tank in a mobile home park)
- **DO NOT LEAVE LIDS OFF OF SEPTIC TANK**

**"MORE INFORMATION MAY BE REQUIRED TO COMPLETE ANY INSPECTION"**

**SEPTIC**

If applying for authorization to construct please indicate desired system type(s): can be ranked in order of preference, must choose one.

- Accepted     
  Innovative     
  Conventional     
  Any  
 Alternative     
  Other \_\_\_\_\_

The applicant shall notify the local health department upon submittal of this application if any of the following apply to the property in question. If the answer is "yes", applicant **MUST ATTACH SUPPORTING DOCUMENTATION:**

- YES     NO    Does the site contain any Jurisdictional Wetlands?
- YES     NO    Do you plan to have an irrigation system now or in the future?
- YES     NO    Does or will the building contain any drains? Please explain. \_\_\_\_\_
- YES     NO    Are there any existing wells, springs, waterlines or Wastewater Systems on this property?
- YES     NO    Is any wastewater going to be generated on the site other than domestic sewage?
- YES     NO    Is the site subject to approval by any other Public Agency?
- YES     NO    Are there any Easements or Right of Ways on this property?
- YES     NO    Does the site contain any existing water, cable, phone or underground electric lines?  
If yes please call No Cuts at 800-632-4949 to locate the lines. This is a free service.

**I Have Read This Application And Certify That The Information Provided Herein Is True, Complete And Correct. Authorized County And State Officials Are Granted Right Of Entry To Conduct Necessary Inspections To Determine Compliance With Applicable Laws And Rules. I Understand That I Am Solely Responsible For The Proper Identification And Labeling Of All Property Lines And Corners And Making The Site Accessible So That A Complete Site Evaluation Can Be Performed.**

I hereby certify that I have the authority to make necessary application, that the application is correct and that the construction will conform to the regulations in the Building, Electrical, Plumbing and Mechanical codes, and the Harnett County Zoning Ordinance. I state the information on the above contractors is correct as known to me and that **by signing below I have obtained all subcontractors permission to obtain these permits** and if **any** changes occur including listed contractors, site plan, number of bedrooms, building and trade plans, Environmental Health permit changes or proposed use changes, I certify it is my responsibility to notify the Harnett County Central Permitting Department of any and all changes.

**EXPIRED PERMIT FEES** - 6 Months to 2 years permit re-issue fee is \$150.00. After 2 years re-issue fee is as per current fee schedule.

*Martin R. Lee*  
Signature of Owner/Contractor/Officer(s) of Corporation

9/18/19  
Date

**Affidavit for Worker's Compensation N.C.G.S. 87-14**

The undersigned applicant being the:

General Contractor     Owner     Officer/Agent of the Contractor or Owner

Do hereby confirm under penalties of perjury that the person(s), firm(s) or corporation(s) performing the work set forth in the permit:

- Has three (3) or more employees and has obtained workers' compensation insurance to cover them.
- Has one (1) or more subcontractors(s) and has obtained workers' compensation insurance to cover them.
- Has one (1) or more subcontractors(s) who has their own policy of workers' compensation insurance covering themselves.
- Has no more than two (2) employees and no subcontractors.

While working on the project for which this permit is sought it is understood that the Central Permitting Department issuing the permit may require certificates of coverage of worker's compensation insurance prior to issuance of the permit and at any time during the permitted work from any person, firm or corporation carrying out the work.

Sign w/Title: \_\_\_\_\_ Date: \_\_\_\_\_



Application # \_\_\_\_\_

Harnett County Central Permitting

PO Box 65 Lillington, NC 27546

910-893-7525 Fax 910-893-2793 www.harnett.org/permits

\* Each section below to be filled out by whomever performing work. Must be owner or licensed contractor. Address, company name & phone must match information on license.

**Application for Residential Building and Trades Permit**

Owner's Name: Melvin R. Cox Date: 9/17/19  
Site Address: 530 Holder Road Lillington, NC 27546 Phone: 910-591-6462  
Subdivision: \_\_\_\_\_ Lot: \_\_\_\_\_  
Description of Proposed Work: Finish bonus space over garage

**General Contractor Information**

Melvin R. Cox 910-591-6462  
Building Contractor's Company Name Telephone  
530 Holder Rd. Lillington, NC 27546 mcox9804@gmail.com  
Address Email Address

License # \_\_\_\_\_

**Electrical Contractor Information**

Description of Work ~~ADD DUCT WORK TO EXISTING SYSTEM~~ Service Size: \_\_\_\_\_ Amps T-Pole:  Yes  No  
Electrical Contractor's Company Name Telephone  
Address Email Address

License # \_\_\_\_\_

**Mechanical/HVAC Contractor Information**

Description of Work Adding duct work to existing system  
Melvin R. Cox 910-591-6462  
Mechanical Contractor's Company Name Telephone  
530 Holder Rd. Lillington, NC 27546 mcox9804@gmail.com  
Address Email Address

License # \_\_\_\_\_

**Plumbing Contractor Information**

Description of Work \_\_\_\_\_ # Baths \_\_\_\_\_  
Plumbing Contractor's Company Name Telephone  
Address Email Address

License # \_\_\_\_\_

**Insulation Contractor Information**

Melvin R. Cox 910-591-6462  
Insulation Contractor's Company Name & Address Telephone

**\*NOTE: General Contractor / owner must fill out and sign the second page of this application.**



Harnett County Central Permitting  
PO Box 65 Lillington, NC 27546  
910-893-7525 Fax 910-893-2793 www.harnett.org/permits

Application # BRES19109-0041  
MRES19109-0027  
IRRES19109-0004

\* Each section below to be filled out by whomever performing work. Must be owner or licensed contractor. Address, company name & phone must match information on license.

**Application for Residential Building and Trades Permit**

Owner's Name: Melvin Cox Date: 9/18/19  
Site Address: 530 Holder Road Lillington Phone: \_\_\_\_\_  
Subdivision: \_\_\_\_\_ Lot: \_\_\_\_\_  
Description of Proposed Work: \_\_\_\_\_

**General Contractor Information**

Owner  
Building Contractor's Company Name \_\_\_\_\_ Telephone \_\_\_\_\_  
Address \_\_\_\_\_ Email Address \_\_\_\_\_  
License # \_\_\_\_\_

**Electrical Contractor Information**

Description of Work \_\_\_\_\_ Service Size: \_\_\_\_\_ Amps T-Pole:  Yes  No  
Electrical Contractor's Company Name \_\_\_\_\_ Telephone \_\_\_\_\_  
Address \_\_\_\_\_ Email Address \_\_\_\_\_  
License # \_\_\_\_\_

**Mechanical/HVAC Contractor Information**

Description of Work Instal Ducts + Vents  
Owner  
Mechanical Contractor's Company Name \_\_\_\_\_ Telephone \_\_\_\_\_  
Address \_\_\_\_\_ Email Address \_\_\_\_\_  
License # \_\_\_\_\_

**Plumbing Contractor Information**

Description of Work \_\_\_\_\_ # Baths \_\_\_\_\_  
Plumbing Contractor's Company Name \_\_\_\_\_ Telephone \_\_\_\_\_  
Address \_\_\_\_\_ Email Address \_\_\_\_\_  
License # \_\_\_\_\_

**Insulation Contractor Information**

Owner  
Insulation Contractor's Company Name & Address \_\_\_\_\_ Telephone \_\_\_\_\_

**\*NOTE: General Contractor / owner must fill out and sign the second page of this application.**



I hereby certify that I have the authority to make necessary application, that the application is correct and that the construction will conform to the regulations in the Building, Electrical, Plumbing and Mechanical codes, and the Harnett County Zoning Ordinance. I state the information on the above contractors is correct as known to me and that **by signing below I have obtained all subcontractors permission to obtain these permits** and if **any** changes occur including listed contractors, site plan, number of bedrooms, building and trade plans, Environmental Health permit changes or proposed use changes, I certify it is my responsibility to notify the Harnett County Central Permitting Department of any and all changes.

**EXPIRED PERMIT FEES - 6 Months to 2 years permit re-issue fee is \$150.00. After 2 years re-issue fee is as per current fee schedule.**

Martin R. Lee  
Signature of Owner/Contractor/Officer(s) of Corporation

9/18/19  
Date

**Affidavit for Worker's Compensation N.C.G.S. 87-14**

The undersigned applicant being the:

General Contractor     Owner     Officer/Agent of the Contractor or Owner

Do hereby confirm under penalties of perjury that the person(s), firm(s) or corporation(s) performing the work set forth in the permit:

- Has three (3) or more employees and has obtained workers' compensation insurance to cover them.
- Has one (1) or more subcontractors(s) and has obtained workers' compensation insurance to cover them.
- Has one (1) or more subcontractors(s) who has their own policy of workers' compensation insurance covering themselves.
- Has no more than two (2) employees and no subcontractors.

While working on the project for which this permit is sought it is understood that the Central Permitting Department issuing the permit may require certificates of coverage of worker's compensation insurance prior to issuance of the permit and at any time during the permitted work from any person, firm or corporation carrying out the work.

Sign w/Title: \_\_\_\_\_ Date: \_\_\_\_\_

Finish the optional game room in floor plan.  
 Owner is hanging drywall, running ductwork,  
 insulating ceiling, painting, and trimming.

Wiring and flooring were completed at  
 construction and upstairs HVAC is sized to  
 heat and cool this additional space.

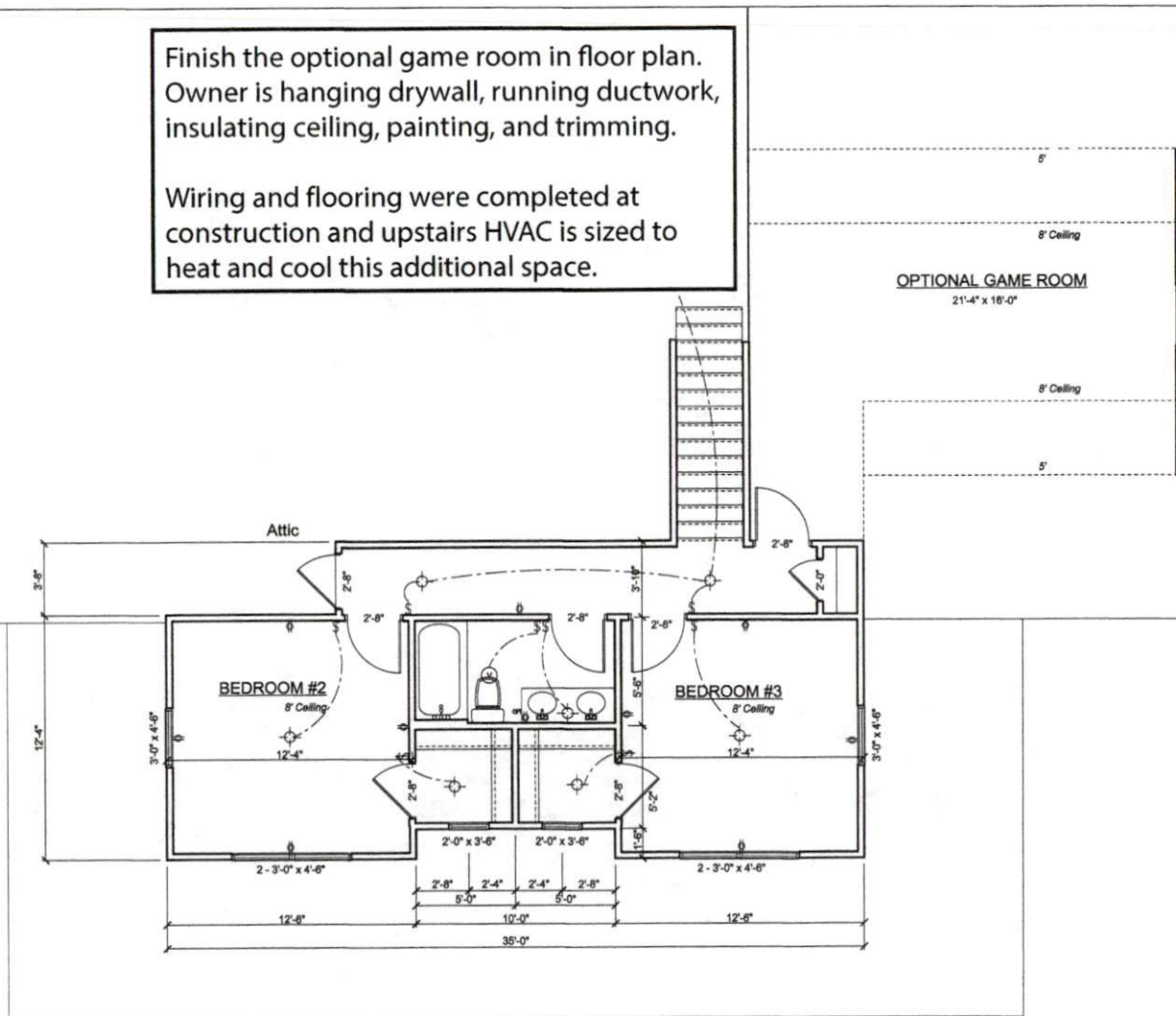

**2nd Floor Plan**

Scale 1/4" = 1'-0"