



STRUCTURAL DESIGN

ENCLOSED BUILDING

**MAXIMUM 30'- 0" WIDE X 16'- 0" HEIGHT-
BOX EAVE FRAME AND BOW FRAME**

**9 August 2019
Revision 0
M&A Project No. 19157S**

Prepared for:

**Southeastern Building Products
714 Warsaw Rd.
Clinton, NC 28328**

Prepared by:

Moore and Associates Engineering and Consulting, Inc.

**1009 East Avenue
North Augusta, SC 29841**

**401 S. Main Street, Suite 200
Mount Airy, NC 27030**



**IF YOU DON'T SEE THE SOUTHEASTERN BUILDING PRODUCT WATERMARK THIS
DRAWING IS VOID**

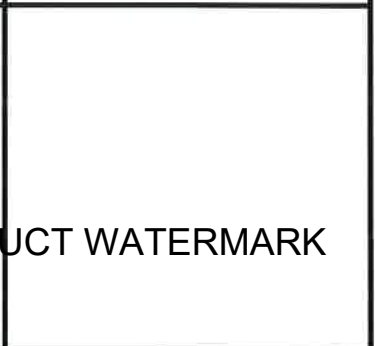
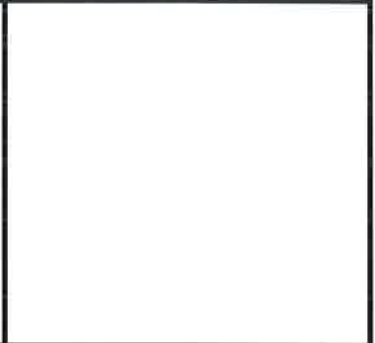
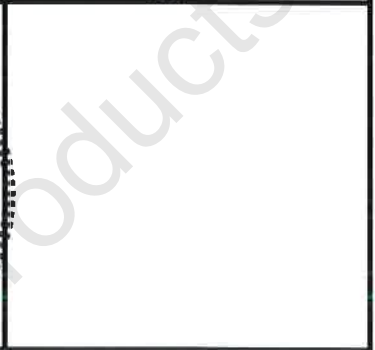
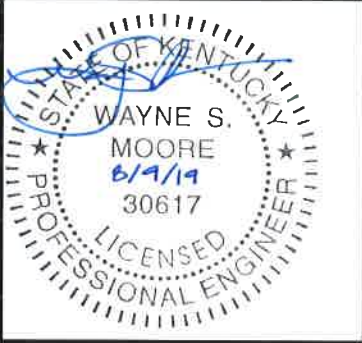
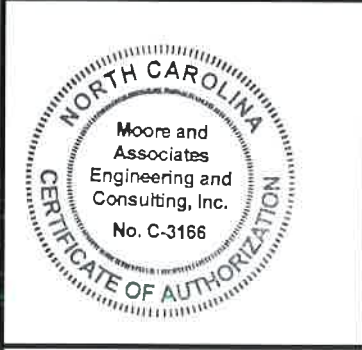
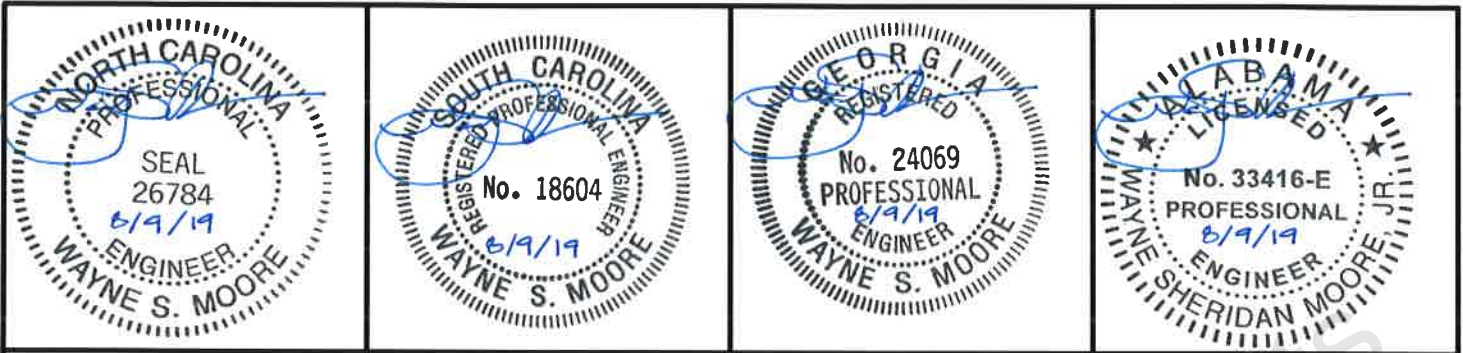

IF YOU DON'T SEE THE SOUTHEASTERN BUILDING PRODUCT WATERMARK
THIS DRAWING IS VOID

MOORE AND ASSOCIATES
ENGINEERING AND CONSULTING, INC.

DRAWN BY: LT

CHECKED BY: PDH

PROJECT MGR: WSM

CLIENT: SOUTHEASTERN

SOUTHEASTERN BUILDING PRODUCTS
714 WARSAW RD.
CLINTON, NC 28328
30'-0"x16'-0" ENCLOSED STRUCTURE

DATE: 8-9-19

SHT. 1

SCALE: NTS

DWG. NO: SK-3

JOB NO: 19157S

REV: 0

THIS DOCUMENT IS THE PROPERTY OF MOORE AND ASSOCIATES ENGINEERING AND CONSULTING. THE UNAUTHORIZED REPRODUCTION, COPYING, OR OTHERWISE USE OF THIS DOCUMENT IS STRICTLY PROHIBITED AND ANY INFRINGEMENT THEREUPON MAY BE SUBJECT TO LEGAL ACTION.

DRAWING INDEX

SHEET 1	PE SEAL COVER SHEET
SHEET 2	DRAWING INDEX
SHEET 3	INSTALLATION NOTES AND SPECIFICATIONS
SHEET 4	TYPICAL END AND SIDE ELEVATIONS
SHEET 5	TYPICAL RAFTER/COLUMN END AND SIDE FRAMING SECTION (BOX EAVE RAFTER)
SHEET 5A	TYPICAL RAFTER/COLUMN END AND SIDE FRAMING SECTION (BOX EAVE RAFTER)
SHEET 6	COLUMN CONNECTION DETAILS (BOX EAVE STRUCTURE)
SHEET 6A	COLUMN CONNECTION DETAILS (BOX EAVE STRUCTURE)
SHEET 7	TYPICAL RAFTER/COLUMN END AND SIDE FRAMING SECTION (BOW RAFTER)
SHEET 7A	TYPICAL RAFTER/COLUMN END AND SIDE FRAMING SECTION (BOW RAFTER)
SHEET 8	COLUMN CONNECTION DETAILS (BOW RAFTER STRUCTURE)
SHEET 8A	COLUMN CONNECTION DETAILS (BOW RAFTER STRUCTURE)
SHEET 9	BASE RAIL ANCHORAGE OPTIONS
SHEET 10	TYPICAL END WALL AND SIDE WALL FRAMING SECTIONS (BOX EAVE RAFTER)
SHEET 11	TYPICAL END WALL AND SIDE WALL FRAMING SECTIONS (BOW RAFTER)
SHEET 12	CONNECTION DETAILS
SHEET 13	CONNECTION DETAILS
SHEET 14	LEAN-TO OPTIONS (BOX EAVE RAFTER)
SHEET 15	LEAN-TO OPTIONS (BOW RAFTER)
SHEET 16	VERTICAL ROOF/SIDING OPTION END AND SIDE ELEVATION AND SECTION

**IF YOU DON'T SEE THE SOUTHEASTERN BUILDING PRODUCT WATERMARK
THIS DRAWING IS VOID**

MOORE AND ASSOCIATES ENGINEERING AND CONSULTING, INC.	DRAWN BY: LT	SOUTHEASTERN BUILDING PRODUCTS 714 WARSAW RD. CLINTON, NC 28328		
	CHECKED BY: PDH	30'-0" x 16'-0" ENCLOSED STRUCTURE		
THIS DOCUMENT IS THE PROPERTY OF MOORE AND ASSOCIATES ENGINEERING AND CONSULTING. THE UNAUTHORIZED REPRODUCTION, COPYING, OR OTHERWISE USE OF THIS DOCUMENT IS STRICTLY PROHIBITED AND ANY INFRINGEMENT THEREUPON MAY BE SUBJECT TO LEGAL ACTION.	PROJECT MGR: WSM	DATE: 8-9-19	SCALE: NTS	JOB NO: 19157S
	CLIENT: SOUTHEASTERN	SHT. 2	DWG. NO: SK-3	REV: 0

INSTALLATION NOTES AND SPECIFICATIONS

1. DESIGN IS FOR MAXIMUM 30'-0" WIDE x 16'-0" EAVE HEIGHT ENCLOSED STRUCTURES
2. DESIGN WAS DONE IN ACCORDANCE WITH THE 2018 NORTH CAROLINA BUILDING CODE (NCBC), 2012 INTERNATIONAL BUILDING CODE (IBC), AND 2015 IBC
3. DESIGN LOADS ARE AS FOLLOWS
 - A) DEAD LOAD = 15 PSF
 - B) LIVE LOAD = 12 PSF
 - C) GROUND SNOW LOAD = 25 PSF

NOTE: UNBALANCED SNOW LOADS DUE TO DRIFTING HAVE NOT BEEN EVALUATED
4. 3-SECOND GUST ULTIMATE WIND SPEED (V_{ULT}) = 145 MPH (NOMINAL WIND SPEED = 112 MPH)
5. MAXIMUM RAFTER/COLUMN AND END COLUMN SPACING = 50 FEET (UNLESS NOTED OTHERWISE)
6. END WALL COLUMNS (POSTS) ARE EQUIVALENT TO SIDE WALL COLUMNS IN SIZE AND SPACING (UNLESS NOTED OTHERWISE)
7. RISK CATEGORY I
8. WIND EXPOSURE CATEGORY B/C
9. SPECIFICATIONS APPLICABLE TO 29 GAUGE METAL PANELS FASTENED DIRECTLY TO 2" x 3" - 14 GAUGE TUBE STEEL (TS) FRAMING MEMBERS (UNLESS NOTED OTHERWISE)
10. AVERAGE FASTENER SPACING ON-CENTERS ALONG RAFTERS OR HAT CHANNELS, AND COLUMNS (INTERIOR OR END) = 10" OC (MAX)
11. FASTENERS CONSIST OF #12-14x3/4" SELF-DRILLING FASTENER (SDF), USE CONTROL SEAL WASHER WITH EXTERIOR FASTENERS. SPECIFICATIONS APPLICABLE ONLY FOR MEAN ROOF HEIGHT OF 20 FEET OR LESS, AND ROOF SLOPES OF 14° (3:12 PITCH) OR LESS. SPACING REQUIREMENTS FOR OTHER ROOF HEIGHTS AND/OR SLOPES MAY VARY
12. ANCHORS SHALL BE INSTALLED THROUGH BASE RAIL WITHIN 6" OF EACH RAFTER COLUMN ALONG SIDES.
13. STANDARD GROUND ANCHORS (SOIL NAILS) CONSIST OF #4 REBAR W/ WELDED NUT x 36" LONG AND MAY ONLY BE USED IN SUITABLE SOIL CONDITIONS. OPTIONAL ANCHORAGE MAY BE USED IN SUITABLE SOILS AND MUST BE USED IN UNSUITABLE SOILS AS NOTED
14. WIND FORCES GOVERN OVER SEISMIC FORCES. SEISMIC PARAMETERS ANALYZED ARE:
 - SOIL SITE CLASS = D
 - RISK CATEGORY I/II/III
 - R = 3.25 $I_e = 1.0$
 - $S_{DS} = 2.039 g$ V = $C_s W$
 - $S_{DI} = 1.258 g$

**IF YOU DON'T SEE THE SOUTHEASTERN BUILDING PRODUCT WATERMARK
THIS DRAWING IS VOID**

MOORE AND ASSOCIATES ENGINEERING AND CONSULTING, INC.	DRAWN BY: LT	SOUTHEASTERN BUILDING PRODUCTS 714 WARSAW RD. CLINTON, NC 28328		
	CHECKED BY: PDH	30'-0" x 16'-0" ENCLOSED STRUCTURE		
THIS DOCUMENT IS THE PROPERTY OF MOORE AND ASSOCIATES ENGINEERING AND CONSULTING. THE UNAUTHORIZED REPRODUCTION, COPYING, OR OTHERWISE USE OF THIS DOCUMENT IS STRICTLY PROHIBITED AND ANY INFRINGEMENT THEREUPON MAY BE SUBJECT TO LEGAL ACTION.	PROJECT MGR: WSM	DATE: 8-9-19	SCALE: NTS	JOB NO: 19157S
	CLIENT: SOUTHEASTERN	SHT. 3	DWG. NO: SK-3	REV: 0

BOX EAVE FRAME RAFTER STRUCTURE

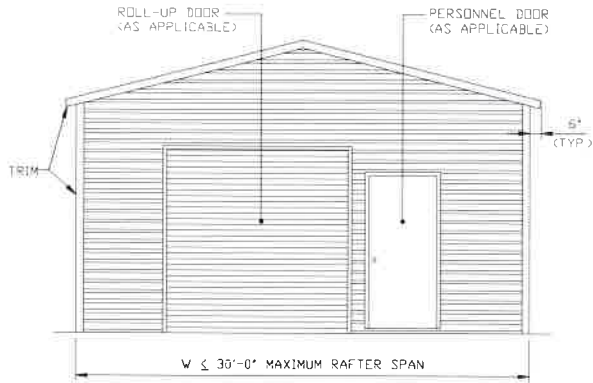

TYPICAL END ELEVATION

SCALE: NTS

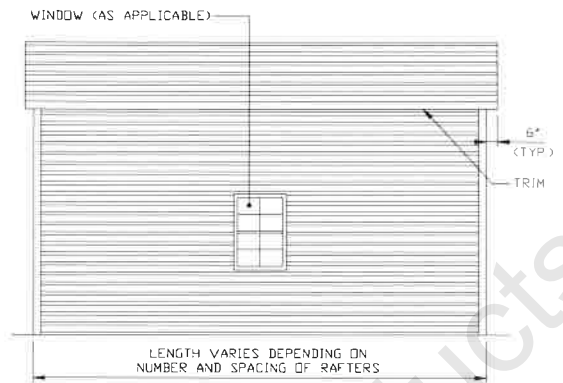

TYPICAL SIDE ELEVATION

SCALE: NTS

BOW FRAME RAFTER STRUCTURE

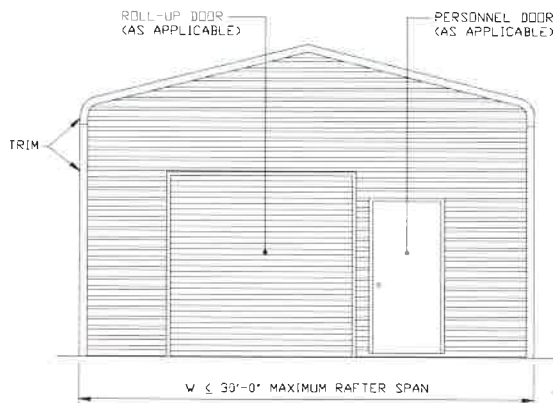

TYPICAL END ELEVATION

SCALE: NTS

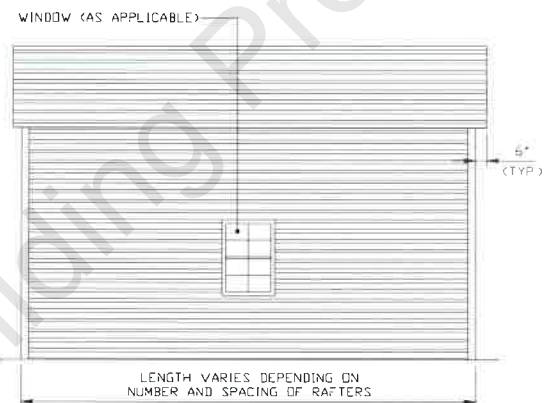

TYPICAL SIDE ELEVATION

SCALE: NTS

IF YOU DON'T SEE THE SOUTHEASTERN BUILDING PRODUCT WATERMARK
THIS DRAWING IS VOID

MOORE AND ASSOCIATES
ENGINEERING AND CONSULTING, INC.

DRAWN BY: LT

CHECKED BY: PDH

PROJECT MGR: WSM

CLIENT: SOUTHEASTERN

SOUTHEASTERN BUILDING PRODUCTS
714 WARSAW RD.
CLINTON, NC 28328
30'-0" x 16'-0" ENCLOSED STRUCTURE

DATE: 8-9-19

SHT. 4

SCALE: NTS

DWG. NO: SK-3

JOB NO: 19157S

REV: 0

THIS DOCUMENT IS THE PROPERTY OF MOORE AND ASSOCIATES ENGINEERING AND CONSULTING. THE UNAUTHORIZED REPRODUCTION, COPYING, OR OTHERWISE USE OF THIS DOCUMENT IS STRICTLY PROHIBITED AND ANY INFRINGEMENT THEREUPON MAY BE SUBJECT TO LEGAL ACTION.

EXPOSURE B

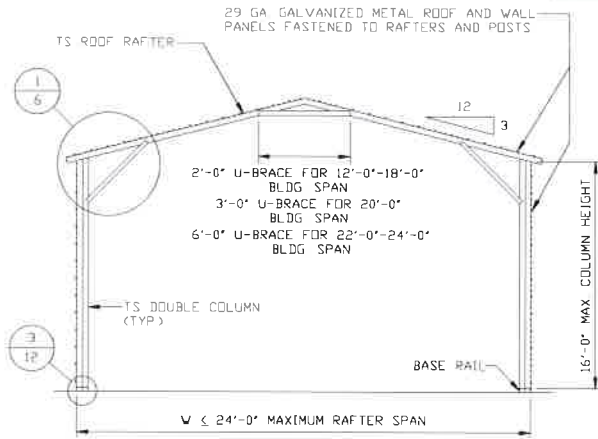

TYPICAL RAFTER/COLUMN END FRAME SECTION

SCALE: NTS

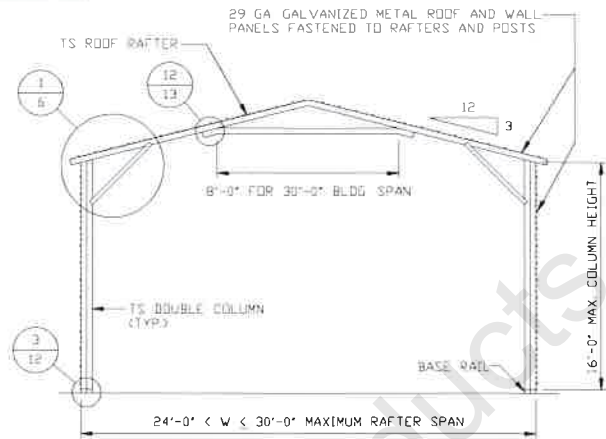

TYPICAL RAFTER/COLUMN END FRAME SECTION

SCALE: NTS

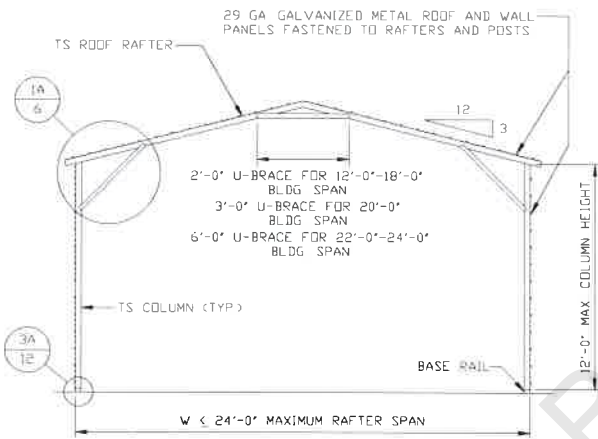

TYPICAL RAFTER/COLUMN END FRAME SECTION

SCALE: NTS

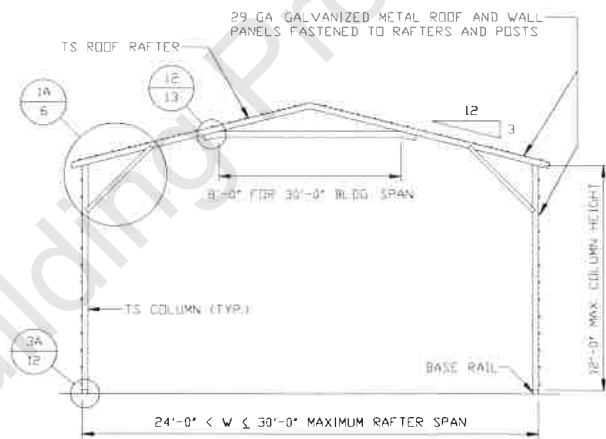

TYPICAL RAFTER/COLUMN END FRAME SECTION

SCALE: NTS

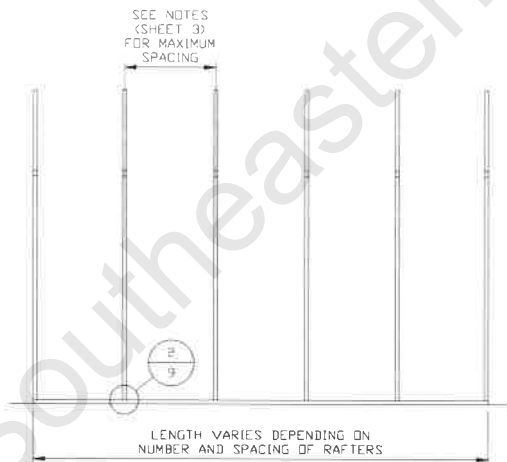

TYPICAL RAFTER/COLUMN SIDE FRAMING SECTION

SCALE: NTS

**IF YOU DON'T SEE THE SOUTHEASTERN BUILDING PRODUCT WATERMARK
THIS DRAWING IS VOID**

MOORE AND ASSOCIATES ENGINEERING AND CONSULTING, INC.	DRAWN BY: LT	SOUTHEASTERN BUILDING PRODUCTS 714 WARSAW RD. CLINTON, NC 28328 30'-0" x 16'-0" ENCLOSED STRUCTURE		
	CHECKED BY: PDH			
PROJECT MGR: WSM	DATE: 8-9-19	SCALE: NTS	JOB NO: 19157S	
CLIENT: SOUTHEASTERN	SHT. 5	DWG. NO: SK-3	REV: 0	

THIS DOCUMENT IS THE PROPERTY OF MOORE AND ASSOCIATES ENGINEERING AND CONSULTING. THE UNAUTHORIZED REPRODUCTION, COPYING, OR OTHERWISE USE OF THIS DOCUMENT IS STRICTLY PROHIBITED AND ANY INFRINGEMENT THEREUPON MAY BE SUBJECT TO LEGAL ACTION.

EXPOSURE C

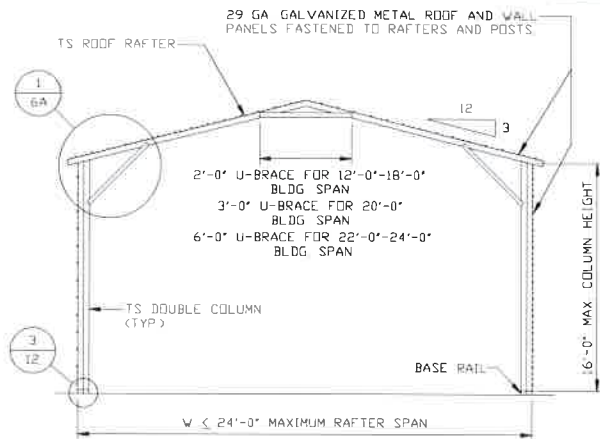

TYPICAL RAFTER/COLUMN END FRAME SECTION
SCALE: NTS

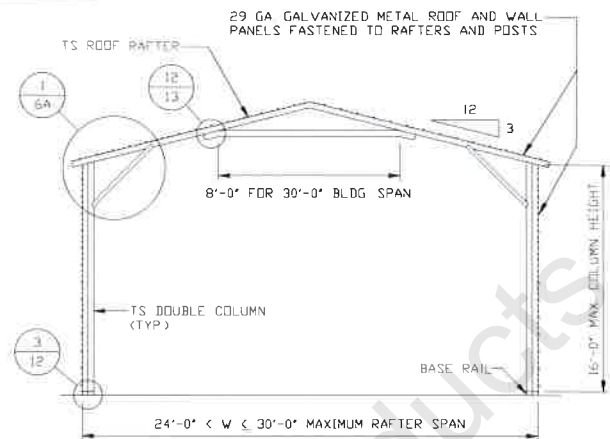

TYPICAL RAFTER/COLUMN END FRAME SECTION
SCALE: NTS

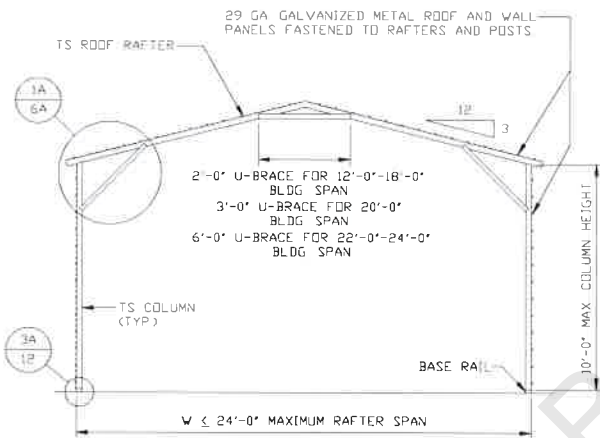

TYPICAL RAFTER/COLUMN END FRAME SECTION
SCALE: NTS

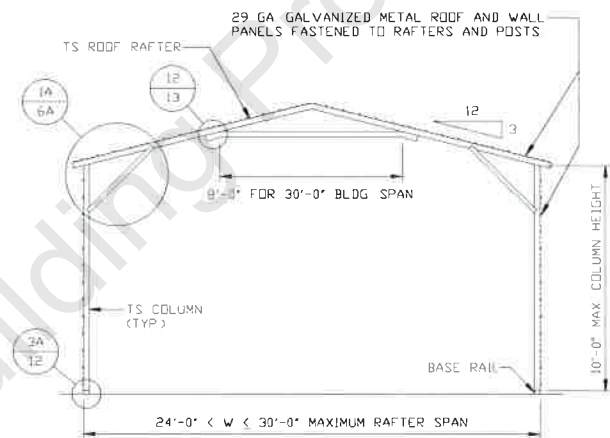

TYPICAL RAFTER/COLUMN END FRAME SECTION
SCALE: NTS

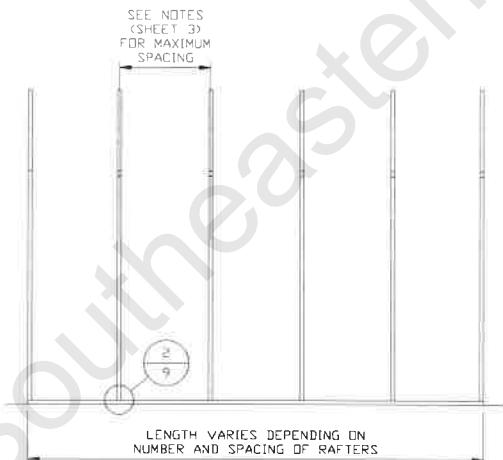

TYPICAL RAFTER/COLUMN SIDE FRAMING SECTION
SCALE: NTS

**IF YOU DON'T SEE THE SOUTHEASTERN BUILDING PRODUCT WATERMARK
THIS DRAWING IS VOID**

**MOORE AND ASSOCIATES
ENGINEERING AND CONSULTING, INC.**

DRAWN BY: LT

CHECKED BY: PDH

PROJECT MGR: WSM

CLIENT: SOUTHEASTERN

SOUTHEASTERN BUILDING PRODUCTS
714 WARSAW RD.
CLINTON, NC 28328
30'-0"x16'-0" ENCLOSED STRUCTURE

DATE: 8-9-19

SHT. 5A

SCALE: NTS

DWG. NO: SK-3

JOB NO: 19157S

REV: 0

THIS DOCUMENT IS THE PROPERTY OF MOORE AND ASSOCIATES ENGINEERING AND CONSULTING. THE UNAUTHORIZED REPRODUCTION, COPYING, OR OTHERWISE USE OF THIS DOCUMENT IS STRICTLY PROHIBITED AND ANY INFRINGEMENT THEREUPON MAY BE SUBJECT TO LEGAL ACTION.

EXPOSURE B

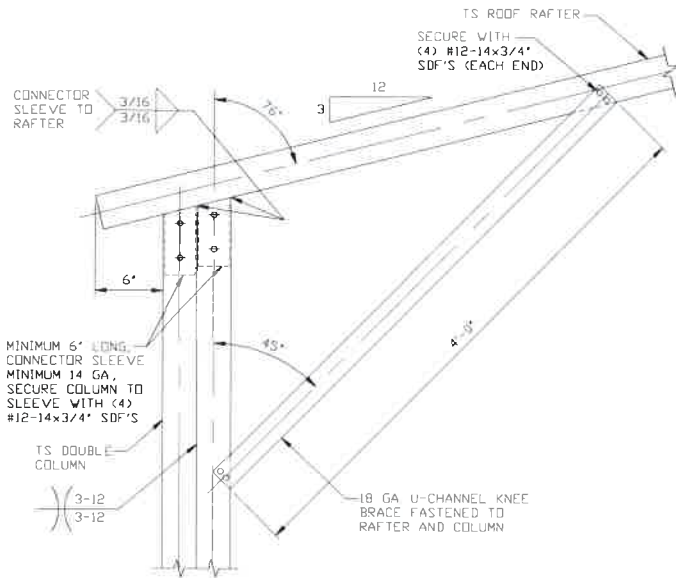

1
BOX EAVE RAFTER COLUMN CONNECTION DETAIL FOR HEIGHTS 12'-0" < TO ≤ 16'-0"
 SCALE: NTS

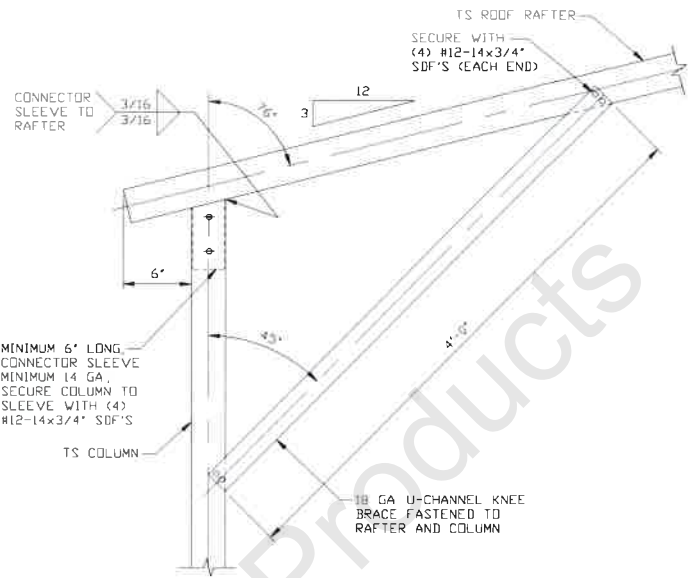

1A
BOX EAVE RAFTER COLUMN CONNECTION DETAIL FOR HEIGHTS 10'-0" < TO ≤ 12'-0"
 SCALE: NTS

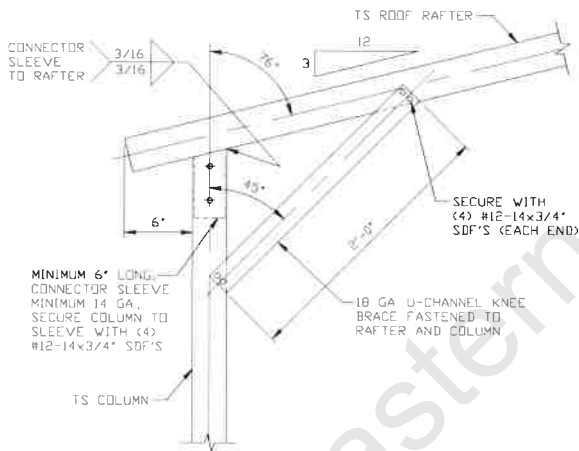

1B
BOX EAVE RAFTER COLUMN CONNECTION DETAIL FOR HEIGHTS ≤ 10'-0"
 SCALE: NTS

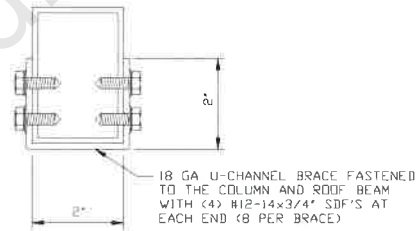

BRACE SECTION
 SCALE: NTS

IF YOU DON'T SEE THE SOUTHEASTERN BUILDING PRODUCT WATERMARK THIS DRAWING IS VOID

**MOORE AND ASSOCIATES
 ENGINEERING AND CONSULTING, INC.**

**DRAWN BY: LT
 CHECKED BY: PDH**

**SOUTHEASTERN BUILDING PRODUCTS
 714 WARSAW RD.
 CLINTON, NC 28328
 30'-0" x 16'-0" ENCLOSED STRUCTURE**

THIS DOCUMENT IS THE PROPERTY OF MOORE AND ASSOCIATES ENGINEERING AND CONSULTING. THE UNAUTHORIZED REPRODUCTION, COPYING, OR OTHERWISE USE OF THIS DOCUMENT IS STRICTLY PROHIBITED AND ANY INFRINGEMENT THEREUPON MAY BE SUBJECT TO LEGAL ACTION.

PROJECT MGR: WSM	DATE: 8-9-19	SCALE: NTS	JOB NO: 19157S
CLIENT: SOUTHEASTERN	SHT. 6	DWG. NO: SK-3	REV: 0

EXPOSURE C

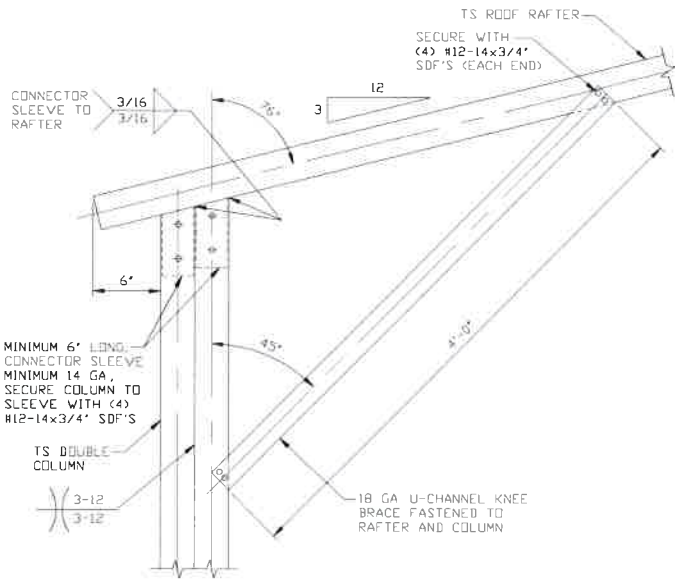

1
BOX EAVE RAFTER COLUMN CONNECTION DETAIL FOR HEIGHTS 10'-0" < TO ≤ 16'-0"
 SCALE: NTS

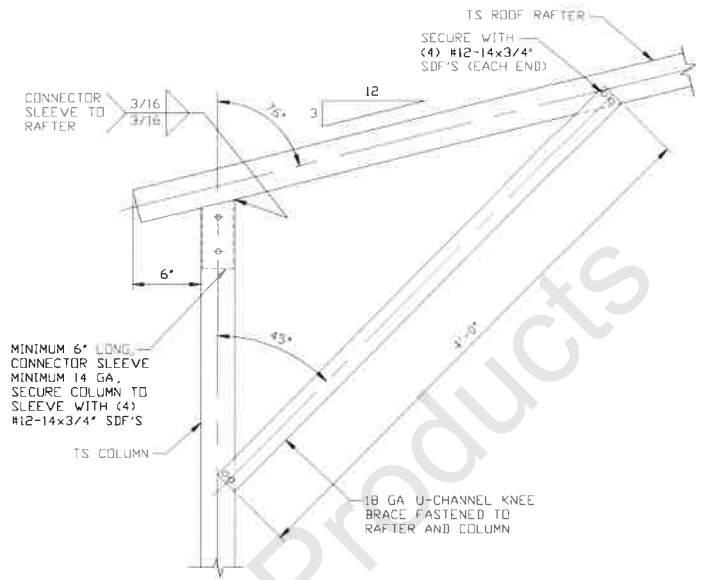

1A
BOX EAVE RAFTER COLUMN CONNECTION DETAIL FOR HEIGHTS 8'-0" < TO ≤ 10'-0"
 SCALE: NTS

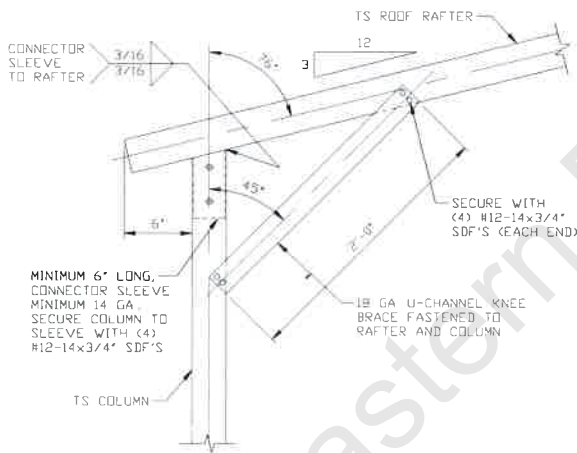

1B
BOX EAVE RAFTER COLUMN CONNECTION DETAIL FOR HEIGHTS ≤ 8'-0"
 SCALE: NTS

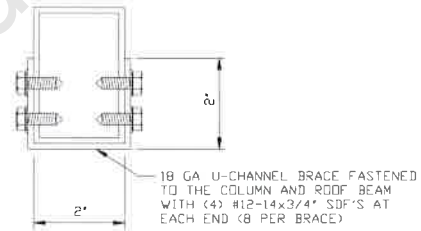

BRACE SECTION
 SCALE: NTS

IF YOU DON'T SEE THE SOUTHEASTERN BUILDING PRODUCT WATERMARK THIS DRAWING IS VOID

**MOORE AND ASSOCIATES
 ENGINEERING AND CONSULTING, INC.**

DRAWN BY: LT

CHECKED BY: PDH

PROJECT MGR: WSM

CLIENT: SOUTHEASTERN

SOUTHEASTERN BUILDING PRODUCTS
 714 WARSAW RD.
 CLINTON, NC 28328
 30'-0" x 16'-0" ENCLOSED STRUCTURE

DATE: 8-9-19

SHT. 6A

SCALE: NTS

DWG. NO: SK-3

JOB NO: 19157S

REV: 0

THIS DOCUMENT IS THE PROPERTY OF MOORE AND ASSOCIATES ENGINEERING AND CONSULTING. THE UNAUTHORIZED REPRODUCTION, COPYING, OR OTHERWISE USE OF THIS DOCUMENT IS STRICTLY PROHIBITED AND ANY INFRINGEMENT THEREUPON MAY BE SUBJECT TO LEGAL ACTION.

EXPOSURE B

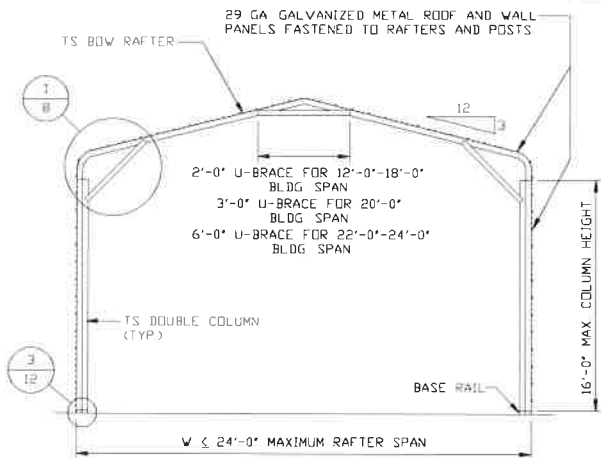

TYPICAL RAFTER/COLUMN END FRAME SECTION

SCALE: NTS

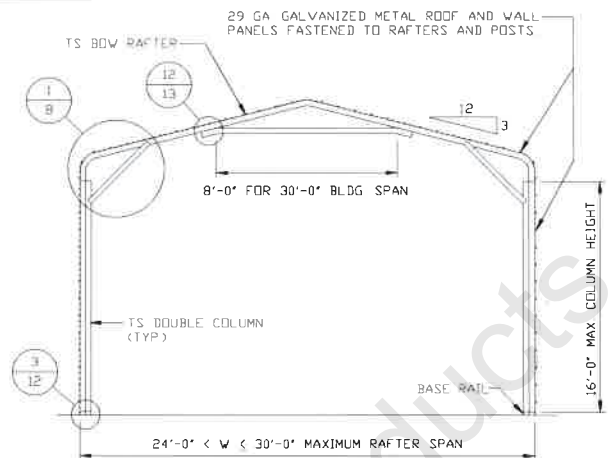

TYPICAL RAFTER/COLUMN END FRAME SECTION

SCALE: NTS

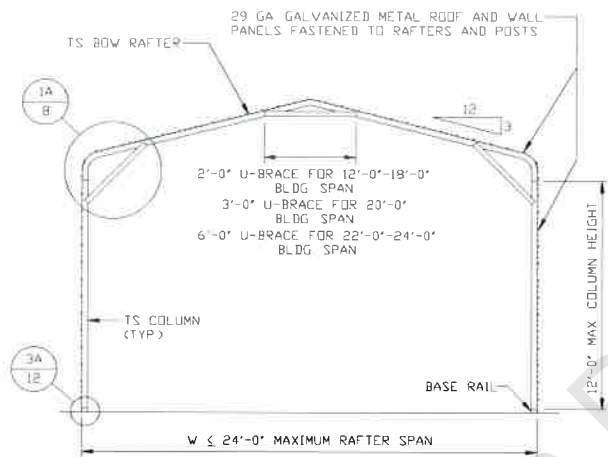

TYPICAL RAFTER/COLUMN END FRAME SECTION

SCALE: NTS

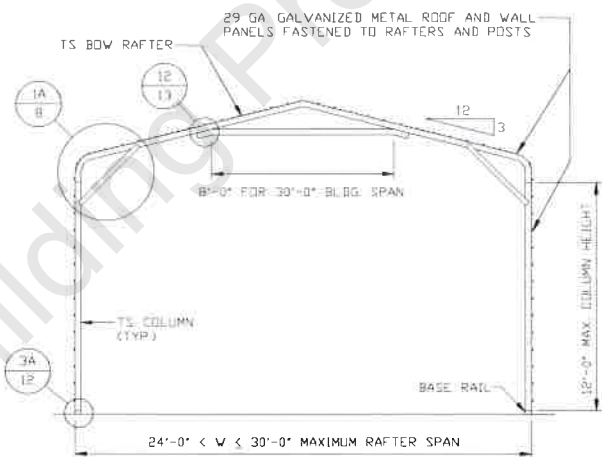

TYPICAL RAFTER/COLUMN END FRAME SECTION

SCALE: NTS

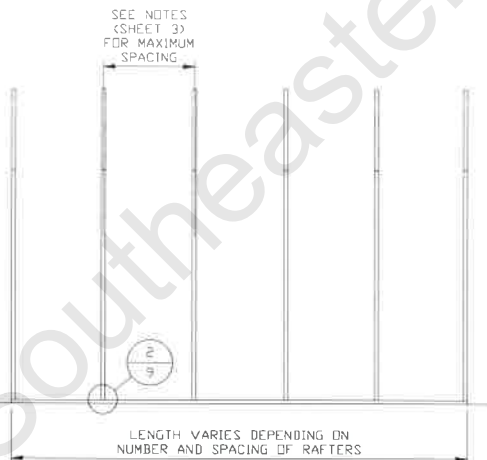

TYPICAL RAFTER/COLUMN SIDE FRAMING SECTION

SCALE: NTS

**IF YOU DON'T SEE THE SOUTHEASTERN BUILDING PRODUCT WATERMARK
THIS DRAWING IS VOID**

**MOORE AND ASSOCIATES
ENGINEERING AND CONSULTING, INC.**

DRAWN BY: LT

CHECKED BY: PDH

PROJECT MGR: WSM

CLIENT: SOUTHEASTERN

**SOUTHEASTERN BUILDING PRODUCTS
714 WARSAW RD.
CLINTON, NC 28328
30'-0"x16'-0" ENCLOSED STRUCTURE**

DATE: 8-9-19

SHT. 7

SCALE: NTS

DWG. NO: SK-3

JOB NO: 19157S

REV: 0

THIS DOCUMENT IS THE PROPERTY OF MOORE AND ASSOCIATES ENGINEERING AND CONSULTING. THE UNAUTHORIZED REPRODUCTION, COPYING, OR OTHERWISE USE OF THIS DOCUMENT IS STRICTLY PROHIBITED AND ANY INFRINGEMENT THEREUPON MAY BE SUBJECT TO LEGAL ACTION.

EXPOSURE C

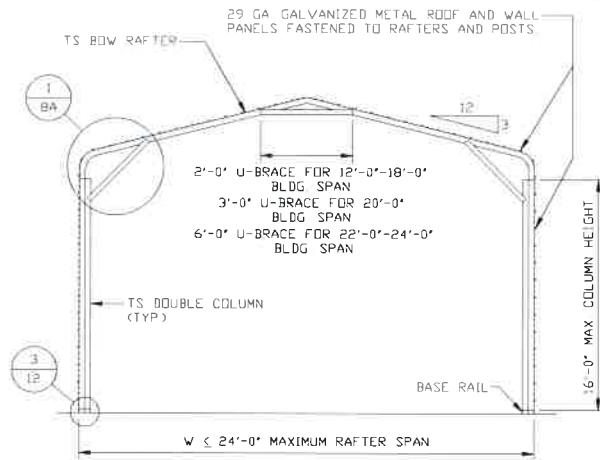

TYPICAL RAFTER/COLUMN END FRAME SECTION

SCALE: NTS

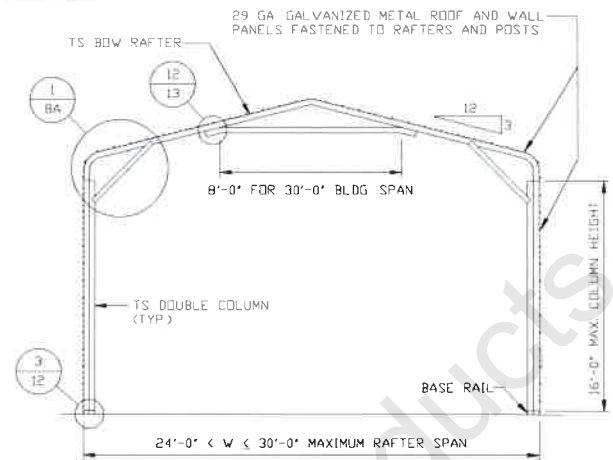

TYPICAL RAFTER/COLUMN END FRAME SECTION

SCALE: NTS

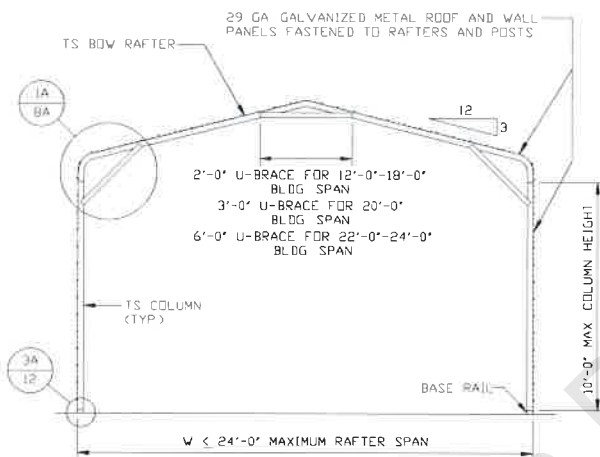

TYPICAL RAFTER/COLUMN END FRAME SECTION

SCALE: NTS

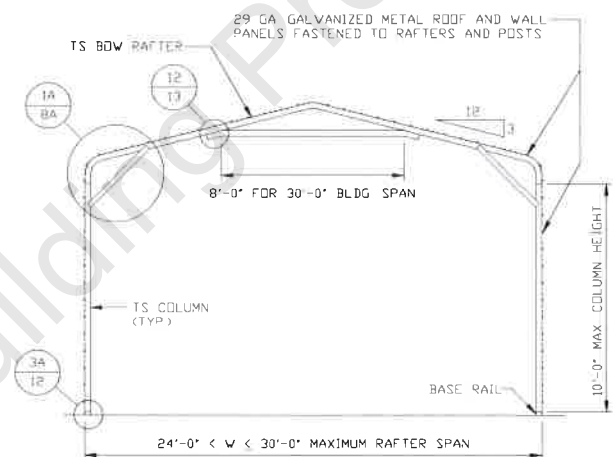

TYPICAL RAFTER/COLUMN END FRAME SECTION

SCALE: NTS

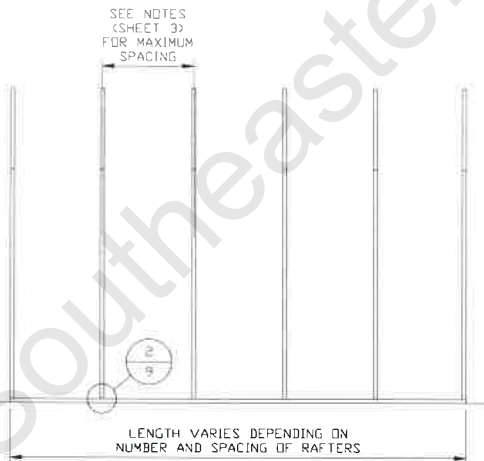

TYPICAL RAFTER/COLUMN SIDE FRAMING SECTION

SCALE: NTS

**IF YOU DON'T SEE THE SOUTHEASTERN BUILDING PRODUCT WATERMARK
THIS DRAWING IS VOID**

MOORE AND ASSOCIATES ENGINEERING AND CONSULTING, INC.	DRAWN BY: LT	SOUTHEASTERN BUILDING PRODUCTS 714 WARSAW RD. CLINTON, NC 28328 30'-0" x 16'-0" ENCLOSED STRUCTURE		
	CHECKED BY: PDH			
THIS DOCUMENT IS THE PROPERTY OF MOORE AND ASSOCIATES ENGINEERING AND CONSULTING. THE UNAUTHORIZED REPRODUCTION, COPYING, OR OTHERWISE USE OF THIS DOCUMENT IS STRICTLY PROHIBITED AND ANY INFRINGEMENT THEREUPON MAY BE SUBJECT TO LEGAL ACTION.	PROJECT MGR: WSM	DATE: 8-9-19	SCALE: NTS	JOB NO: 19157S
	CLIENT: SOUTHEASTERN	SHT. 7A	DWG. NO: SK-3	REV: 0

EXPOSURE B

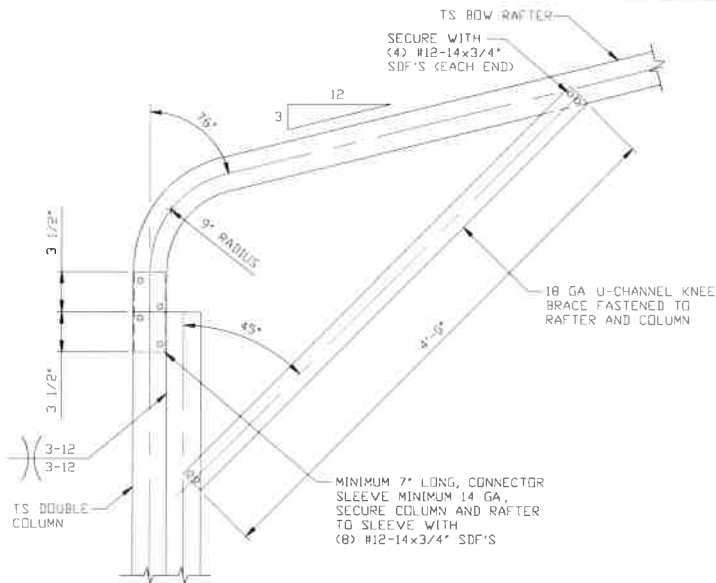

1
BOW EAVE RAFTER COLUMN CONNECTION DETAIL FOR HEIGHTS 12'-0" < TO ≤ 16'-0"
 SCALE: NTS

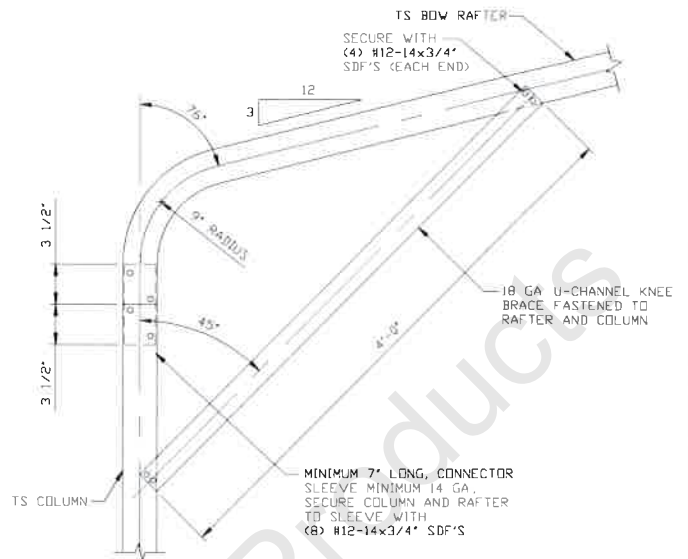

1A
BOW EAVE RAFTER COLUMN CONNECTION DETAIL FOR HEIGHTS 10'-0" < TO ≤ 12'-0"
 SCALE: NTS

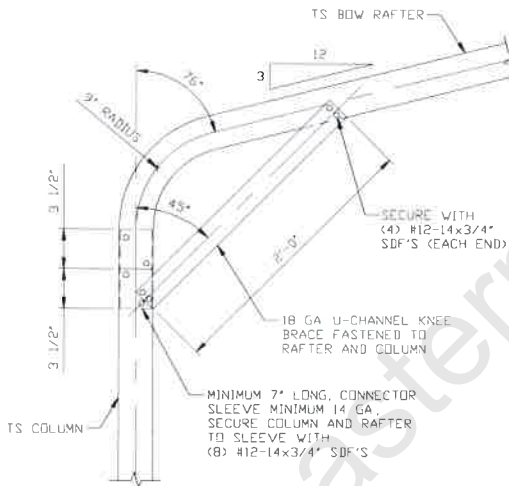

1B
BOW EAVE RAFTER COLUMN CONNECTION DETAIL FOR HEIGHTS ≤ 10'-0"
 SCALE: NTS

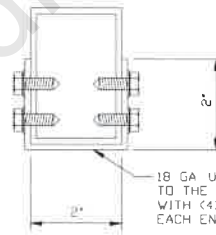

BRACE SECTION
 SCALE: NTS

IF YOU DON'T SEE THE SOUTHEASTERN BUILDING PRODUCT WATERMARK THIS DRAWING IS VOID

**MOORE AND ASSOCIATES
 ENGINEERING AND CONSULTING, INC.**

DRAWN BY: LT

CHECKED BY: PDH

PROJECT MGR: WSM

CLIENT: SOUTHEASTERN

SOUTHEASTERN BUILDING PRODUCTS
 714 WARSAW RD.
 CLINTON, NC 28328
 30'-0" x 16'-0" ENCLOSED STRUCTURE

DATE: 8-9-19

SHT. 8

SCALE: NTS

DWG. NO: SK-3

JOB NO: 19157S

REV: 0

THIS DOCUMENT IS THE PROPERTY OF MOORE AND ASSOCIATES ENGINEERING AND CONSULTING. THE UNAUTHORIZED REPRODUCTION, COPYING, OR OTHERWISE USE OF THIS DOCUMENT IS STRICTLY PROHIBITED AND ANY INFRINGEMENT THEREUPON MAY BE SUBJECT TO LEGAL ACTION.

EXPOSURE C

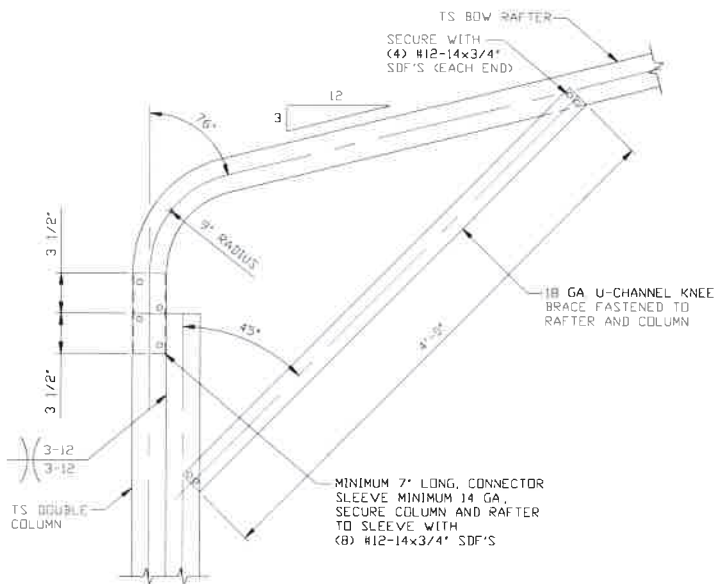

1
BOW EAVE RAFTER COLUMN CONNECTION DETAIL FOR HEIGHTS 10'-0" < TO ≤ 16'-0"
 SCALE: NTS

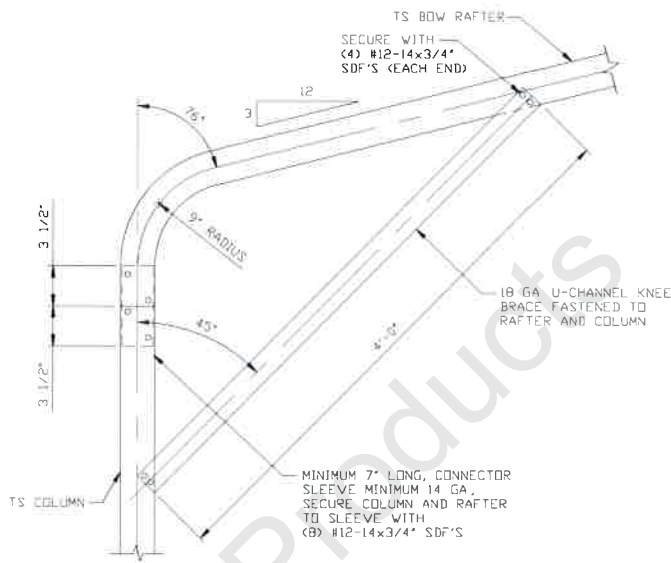

1A
BOW EAVE RAFTER COLUMN CONNECTION DETAIL FOR HEIGHTS 8'-0" < TO ≤ 10'-0"
 SCALE: NTS

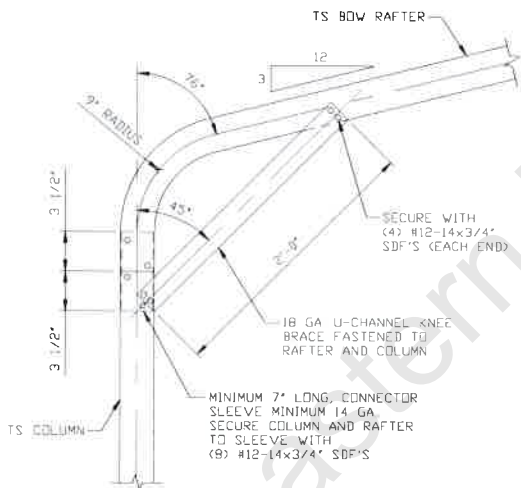

1B
BOW EAVE RAFTER COLUMN CONNECTION DETAIL FOR HEIGHTS ≤ 8'-0"
 SCALE: NTS

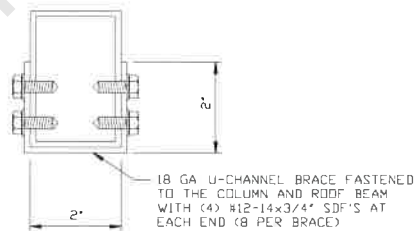

BRACE SECTION
 SCALE: NTS

IF YOU DON'T SEE THE SOUTHEASTERN BUILDING PRODUCT WATERMARK THIS DRAWING IS VOID

**MOORE AND ASSOCIATES
 ENGINEERING AND CONSULTING, INC.**

DRAWN BY: LT
CHECKED BY: PDH

SOUTHEASTERN BUILDING PRODUCTS
 714 WARSAW RD.
 CLINTON, NC 28328
 30'-0"x16'-0" ENCLOSED STRUCTURE

THIS DOCUMENT IS THE PROPERTY OF MOORE AND ASSOCIATES ENGINEERING AND CONSULTING. THE UNAUTHORIZED REPRODUCTION, COPYING, OR OTHERWISE USE OF THIS DOCUMENT IS STRICTLY PROHIBITED AND ANY INFRINGEMENT THEREUPON MAY BE SUBJECT TO LEGAL ACTION.

PROJECT MGR: WSM	DATE: 8-9-19	SCALE: NTS	JOB NO: 19157S
CLIENT: SOUTHEASTERN	SHT. 8A	DWG. NO: SK-3	REV: 0

BASE RAIL ANCHORAGE OPTIONS

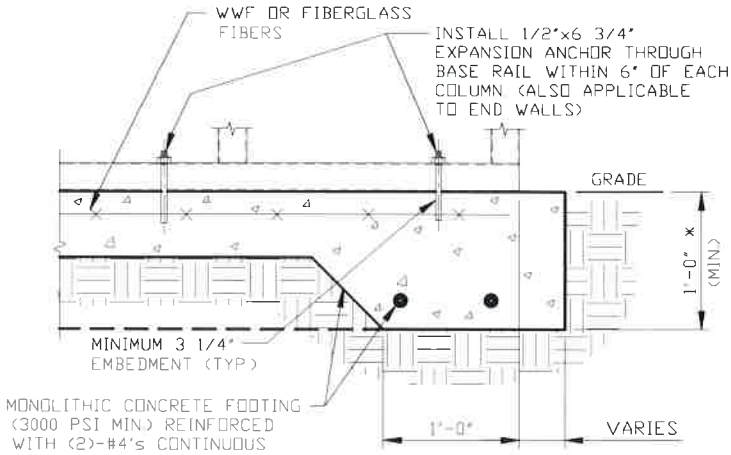

2A

CONCRETE MONOLITHIC SLAB BASE RAIL ANCHORAGE

SCALE: NTS
MINIMUM ANCHOR EDGE DISTANCE IS 4"
* COORDINATE WITH LOCAL BUILDING CODE AND/OR BUILDING OFFICIAL REGARDING REQUIRED FOOTING DEPTH

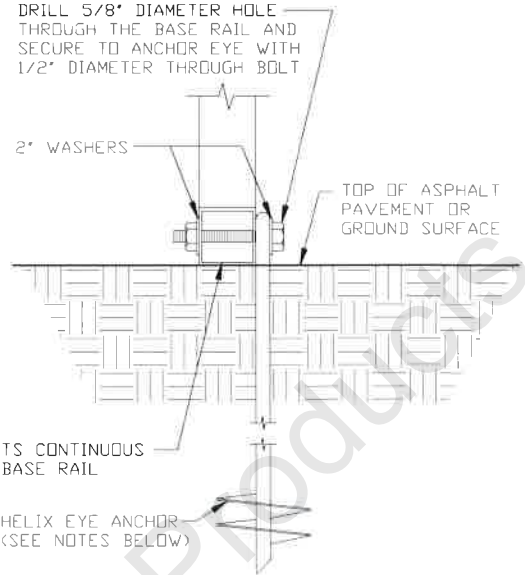

2B

GROUND BASE HELIX ANCHORAGE

SCALE: NTS (CAN BE USED FOR ASPHALT)

GENERAL NOTES

NOTE: CONCRETE MONOLITHIC SLAB DESIGN BASED ON MINIMUM SOIL BEARING CAPACITY OF 1,500 PSF

CONCRETE:

CONCRETE SHALL HAVE A MINIMUM SPECIFIED COMPRESSIVE STRENGTH OF 3,000 PSI AT 28 DAYS

COVER OVER REINFORCING STEEL:

FOR FOUNDATIONS, MINIMUM CONCRETE COVER OVER REINFORCING BARS SHALL BE PER ACI-318:
3" IN FOUNDATIONS WHERE THE CONCRETE IS CAST AGAINST AND PERMANENTLY IN CONTACT WITH THE EARTH OR EXPOSED TO THE EARTH OR WEATHER, AND 1 1/2" ELSEWHERE

REINFORCING STEEL:

THE TURNDOWN REINFORCING STEEL SHALL BE ASTM A615 GRADE 60. THE SLAB REINFORCEMENT SHALL BE WELDED WIRE FABRIC MEETING ASTM A185 OR FIBERGLASS FIBER REINFORCEMENT

REINFORCEMENT MAY BE BENT IN THE SHOP OR THE FIELD PROVIDED:

- 1 REINFORCEMENT IS BENT COLD
- 2 THE DIAMETER OF THE BEND, MEASURED ON THE INSIDE OF THE BAR, IS NOT LESS THAN SIX-BAR DIAMETERS
- 3 REINFORCEMENT PARTIALLY EMBEDDED IN CONCRETE SHALL NOT BE FIELD BENT

HELIX ANCHOR NOTES:

- 1 FOR VERY DENSE AND/OR CEMENTED SANDS, COARSE GRAVEL AND COBBLES, CALICHE, PRELOADED SILTS AND CLAYS, USE MINIMUM (2) 4" HELICES WITH MINIMUM 30" EMBEDMENT OR SINGLE 6" HELIX WITH MINIMUM 50" EMBEDMENT
- 2 FOR CORAL USE MINIMUM (2) 4" HELICES WITH MINIMUM 30" EMBEDMENT OR SINGLE 6" HELIX WITH MINIMUM 50" EMBEDMENT
- 3 FOR MEDIUM DENSE COARSE SANDS, SANDY GRAVELS, VERY STIFF SILTS, AND CLAYS USE MINIMUM (2) 4" HELICES WITH MINIMUM 30 INCH EMBEDMENT OR SINGLE 6" HELIX WITH MINIMUM 50" EMBEDMENT
- 4 FOR LOOSE TO MEDIUM DENSE SANDS, FIRM TO STIFF CLAYS AND SILTS ALLUVIAL FILL, USE MINIMUM (2) 6" HELICES WITH MINIMUM 50" EMBEDMENT
- 5 FOR VERY LOOSE TO MEDIUM DENSE SANDS, FIRM TO STIFFER CLAYS AND SILTS, ALLUVIAL FILL, USE MINIMUM (2) 8" HELICES WITH MINIMUM 50" EMBEDMENT

IF YOU DON'T SEE THE SOUTHEASTERN BUILDING PRODUCT WATERMARK THIS DRAWING IS VOID

**MOORE AND ASSOCIATES
ENGINEERING AND CONSULTING, INC.**

DRAWN BY: LT

CHECKED BY: PDH

PROJECT MGR: WSM

CLIENT: SOUTHEASTERN

SOUTHEASTERN BUILDING PRODUCTS
714 WARSAW RD.
CLINTON, NC 28328
30'-0"x16'-0" ENCLOSED STRUCTURE

DATE: 8-9-19

SHT. 9

SCALE: NTS

DWG. NO: SK-3

JOB NO: 19157S

REV: 0

THIS DOCUMENT IS THE PROPERTY OF MOORE AND ASSOCIATES ENGINEERING AND CONSULTING. THE UNAUTHORIZED REPRODUCTION, COPYING, OR OTHERWISE USE OF THIS DOCUMENT IS STRICTLY PROHIBITED AND ANY INFRINGEMENT THEREUPON MAY BE SUBJECT TO LEGAL ACTION.

BOX EAVE RAFTER END WALL AND SIDE WALL OPENINGS

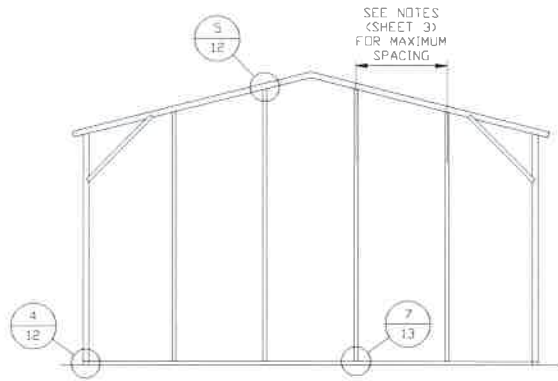

**TYPICAL BOX EAVE RAFTER
END WALL FRAMING SECTION**

SCALE: NTS

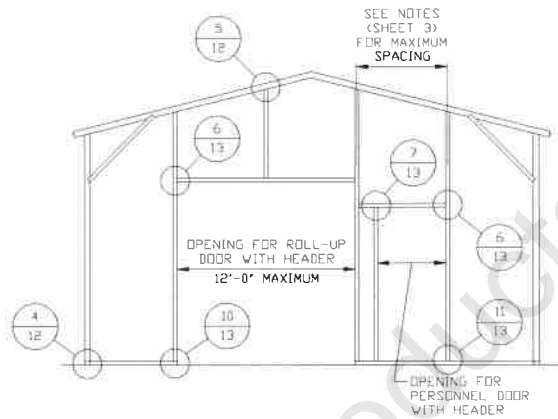

**TYPICAL BOX EAVE RAFTER END
WALL OPENINGS FRAMING SECTION**

SCALE: NTS

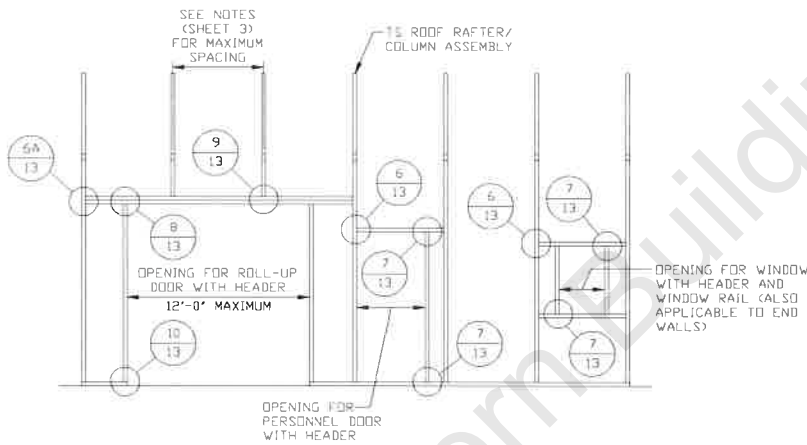

**TYPICAL BOX EAVE RAFTER
SIDE WALL OPENINGS FRAMING SECTION**

SCALE: NTS

**IF YOU DON'T SEE THE SOUTHEASTERN BUILDING PRODUCTS WATERMARK
THIS DRAWING IS VOID**

**MOORE AND ASSOCIATES
ENGINEERING AND CONSULTING, INC.**

DRAWN BY: LT

CHECKED BY: PDH

PROJECT MGR: WSM

CLIENT: SOUTHEASTERN

SOUTHEASTERN BUILDING PRODUCTS
714 WARSAW RD.
CLINTON, NC 28328
30'-0"x16'-0" ENCLOSED STRUCTURE

DATE: 8-9-19

SCALE: NTS

JOB NO: 19157S

SHT. 10

DWG. NO: SK-3

REV: 0

THIS DOCUMENT IS THE PROPERTY OF MOORE AND ASSOCIATES ENGINEERING AND CONSULTING. THE UNAUTHORIZED REPRODUCTION, COPYING, OR OTHERWISE USE OF THIS DOCUMENT IS STRICTLY PROHIBITED AND ANY INFRINGEMENT THEREUPON MAY BE SUBJECT TO LEGAL ACTION.

BOW RAFTER END WALL AND SIDE WALL OPENINGS

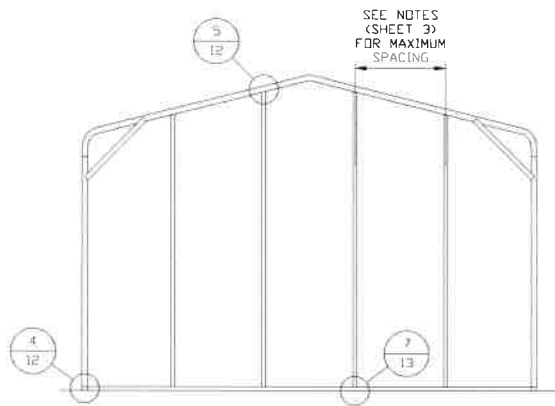

**TYPICAL BOW RAFTER
END WALL FRAMING SECTION**

SCALE: NTS

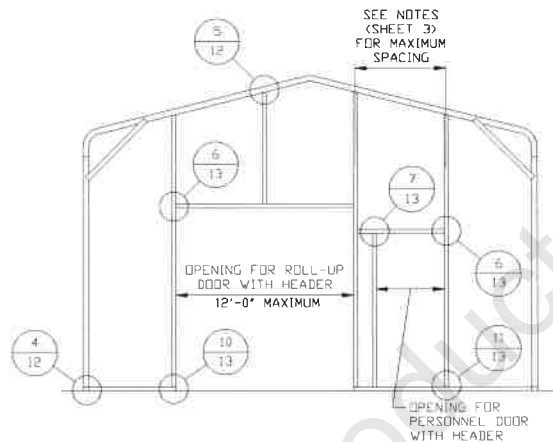

**TYPICAL BOW RAFTER END
WALL OPENINGS FRAMING SECTION**

SCALE: NTS

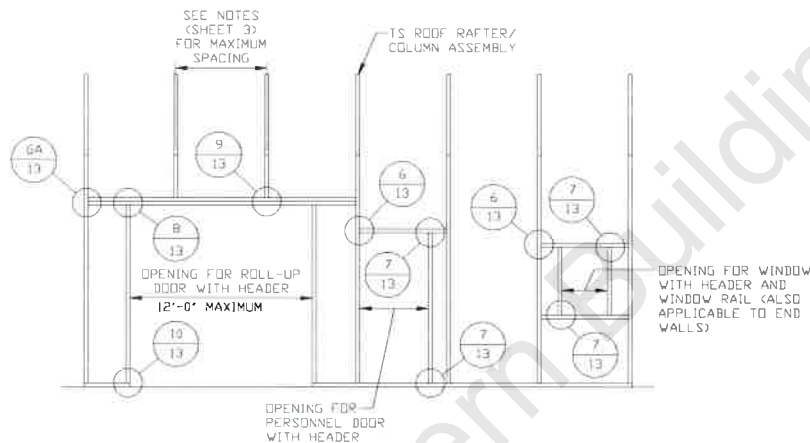

**TYPICAL BOW RAFTER SIDE
WALL OPENINGS FRAMING SECTION**

SCALE: NTS

**IF YOU DON'T SEE THE SOUTHEASTERN BUILDING PRODUCT WATERMARK
THIS DRAWING IS VOID**

**MOORE AND ASSOCIATES
ENGINEERING AND CONSULTING, INC.**

DRAWN BY: LT

CHECKED BY: PDH

PROJECT MGR: WSM

CLIENT: SOUTHEASTERN

SOUTHEASTERN BUILDING PRODUCTS
714 WARSAW RD.
CLINTON, NC 28328
30'-0"x16'-0" ENCLOSED STRUCTURE

DATE: 8-9-19

SHT. 11

SCALE: NTS

DWG. NO: SK-3

JOB NO: 19157S

REV: 0

THIS DOCUMENT IS THE PROPERTY OF MOORE AND ASSOCIATES ENGINEERING AND CONSULTING. THE UNAUTHORIZED REPRODUCTION, COPYING, OR OTHERWISE USE OF THIS DOCUMENT IS STRICTLY PROHIBITED AND ANY INFRINGEMENT THEREUPON MAY BE SUBJECT TO LEGAL ACTION.

CONNECTION DETAILS

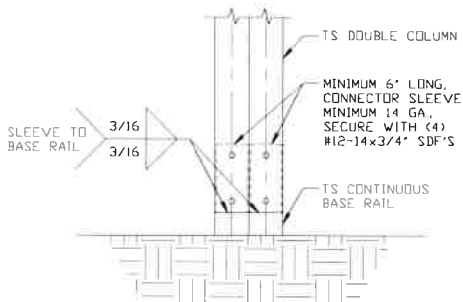

3 **RAFTER COLUMN/BASE RAIL CONNECTION DETAIL**

SCALE: NTS

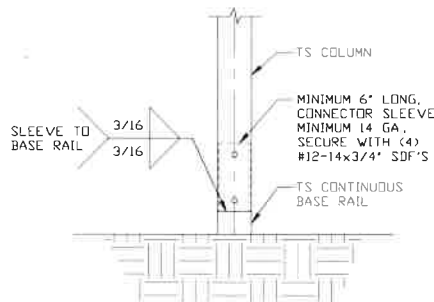

3A **RAFTER COLUMN/BASE RAIL CONNECTION DETAIL**

SCALE: NTS

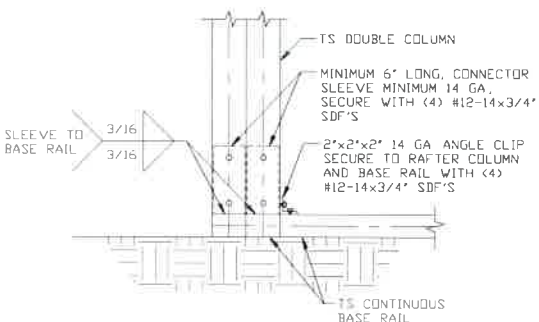

4 **END COLUMN/BASE RAIL CONNECTION DETAIL**

SCALE: NTS

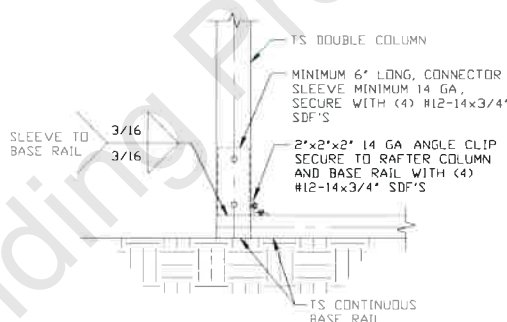

4A **END COLUMN/BASE RAIL CONNECTION DETAIL**

SCALE: NTS

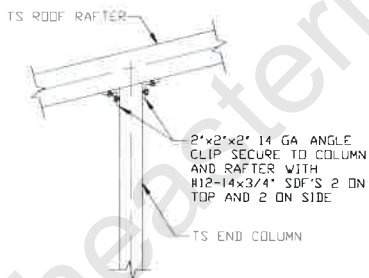

5 **END COLUMN/RAFTER CONNECTION DETAIL**

SCALE: NTS

IF YOU DON'T SEE THE SOUTHEASTERN BUILDING PRODUCT WATERMARK THIS DRAWING IS VOID

MOORE AND ASSOCIATES ENGINEERING AND CONSULTING, INC.	DRAWN BY: LT	SOUTHEASTERN BUILDING PRODUCTS 714 WARSAW RD. CLINTON, NC 28328		
	CHECKED BY: PDH	30'-0" x 16'-0" ENCLOSED STRUCTURE		
THIS DOCUMENT IS THE PROPERTY OF MOORE AND ASSOCIATES ENGINEERING AND CONSULTING. THE UNAUTHORIZED REPRODUCTION, COPYING, OR OTHERWISE USE OF THIS DOCUMENT IS STRICTLY PROHIBITED AND ANY INFRINGEMENT THEREUPON MAY BE SUBJECT TO LEGAL ACTION.	PROJECT MGR: WSH	DATE: 8-9-19	SCALE: NTS	JOB NO: 19157S
	CLIENT: SOUTHEASTERN	SHT. 12	DWG. NO: SK-3	REV: 0

CONNECTION DETAILS

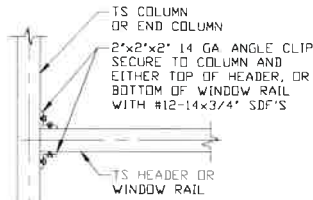

6 COLUMN OR WINDOW RAIL TO POST CONNECTION DETAIL
SCALE: NTS

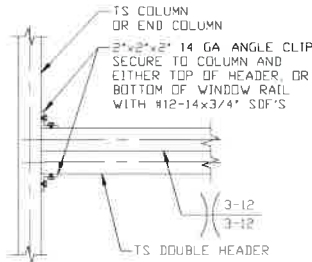

6A LACED HEADER/COLUMN CONNECTION DETAIL
SCALE: NTS

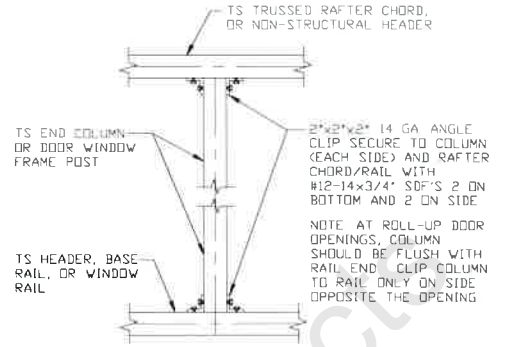

7 COLUMN TO WINDOW RAIL CONNECTION DETAIL
SCALE: NTS

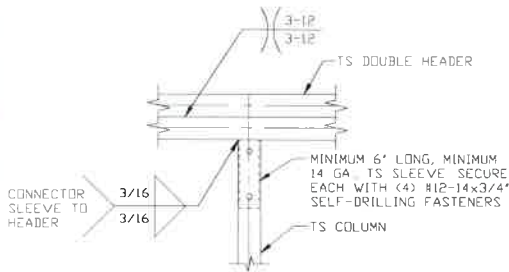

8 LACED HEADER/COLUMN CONNECTION DETAIL
SCALE: NTS

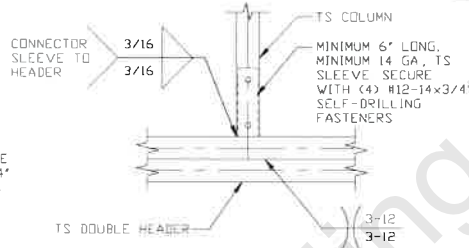

9 COLUMN/LACED HEADER CONNECTION DETAIL
SCALE: NTS

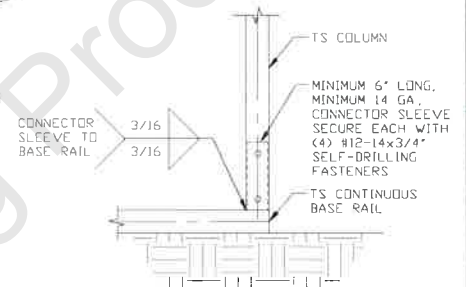

10 COLUMN/BASE RAIL CONNECTION DETAIL
SCALE: NTS

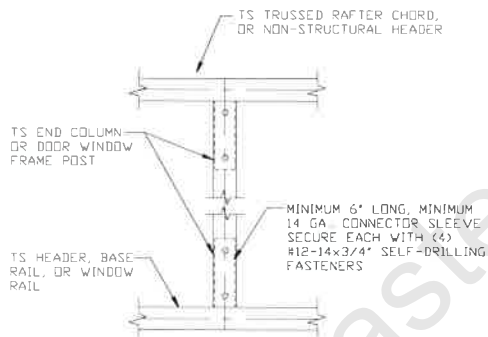

11 COLUMN TO HEADER OR BASE RAIL CONNECTION DETAIL
SCALE: NTS

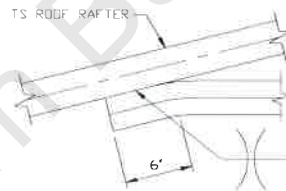

12 COLLAR TIE CONNECTION DETAIL
SCALE: NTS

IF YOU DON'T SEE THE SOUTHEASTERN BUILDING PRODUCT WATERMARK
THIS DRAWING IS VOID

**MOORE AND ASSOCIATES
ENGINEERING AND CONSULTING, INC.**

DRAWN BY: LT

CHECKED BY: PDH

PROJECT MGR: WSM

CLIENT: SOUTHEASTERN

SOUTHEASTERN BUILDING PRODUCTS
714 WARSAW RD.
CLINTON, NC 28328
30'-0" x 16'-0" ENCLOSED STRUCTURE

DATE: 8-9-19

SHT. 13

SCALE: NTS

DWG. NO: SK-3

JOB NO: 19157S

REV: 0

THIS DOCUMENT IS THE PROPERTY OF MOORE AND ASSOCIATES ENGINEERING AND CONSULTING. THE UNAUTHORIZED REPRODUCTION, COPYING, OR OTHERWISE USE OF THIS DOCUMENT IS STRICTLY PROHIBITED AND ANY INFRINGEMENT THEREUPON MAY BE SUBJECT TO LEGAL ACTION.

BOX EAVE RAFTER LEAN-TO OPTIONS

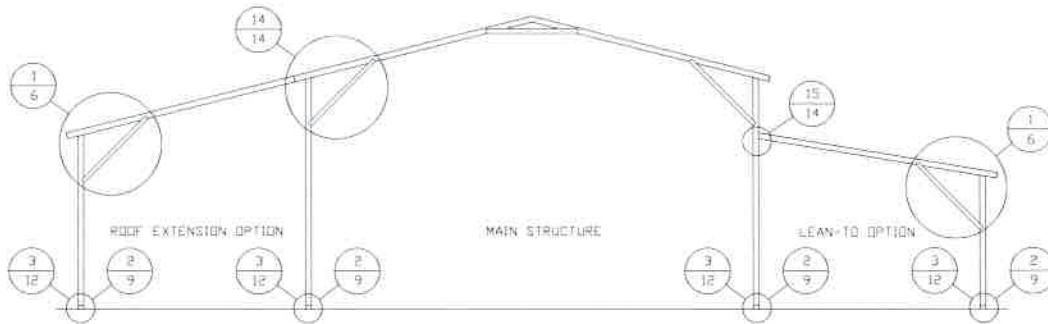

TYPICAL BOX EAVE RAFTER LEAN-TO OPTIONS FRAMING SECTION (BOTH OPTIONS SHOWN)

SCALE: NTS
 MAXIMUM WIDTH OF ROOF EXTENSION AND LEAN-TO IS 12'-0"

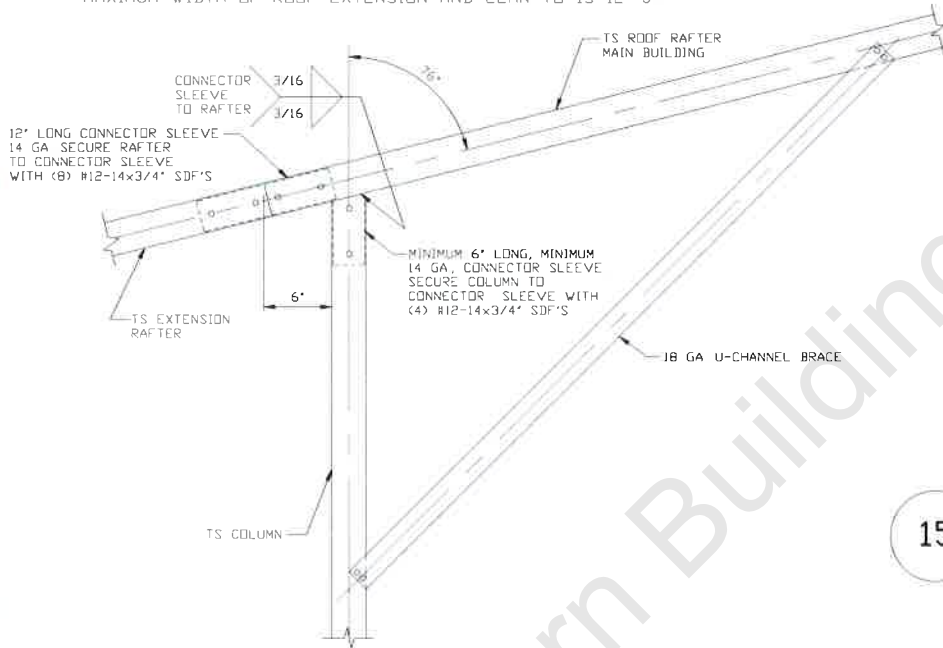

14 SIDE EXTENSION RAFTER/ COLUMN
 DETAIL FOR RAFTER SPANS \leq 12'-0"
 SCALE: NTS

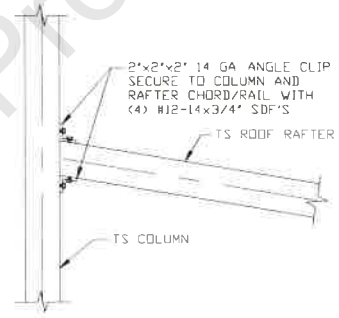

15 LEAN-TO RAFTER TO RAFTER
 COLUMN CONNECTION DETAIL
 FOR RAFTER SPANS \leq 12'-0"
 SCALE: NTS

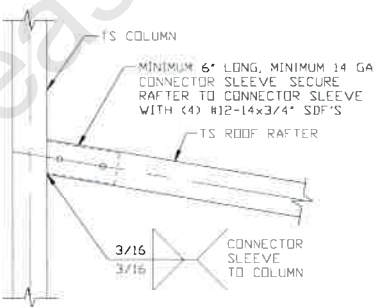

15A LEAN-TO RAFTER TO RAFTER
 COLUMN CONNECTION DETAIL
 FOR RAFTER SPANS \leq 12'-0"
 SCALE: NTS

IF YOU DON'T SEE THE SOUTHEASTERN BUILDING PRODUCT WATERMARK THIS DRAWING IS VOID

MOORE AND ASSOCIATES ENGINEERING AND CONSULTING, INC.	DRAWN BY: LT	SOUTHEASTERN BUILDING PRODUCTS 714 WARSAW RD. CLINTON, NC 28328 30'-0"x16'-0" ENCLOSED STRUCTURE		
	CHECKED BY: PDH			
THIS DOCUMENT IS THE PROPERTY OF MOORE AND ASSOCIATES ENGINEERING AND CONSULTING. THE UNAUTHORIZED REPRODUCTION, COPYING, OR OTHERWISE USE OF THIS DOCUMENT IS STRICTLY PROHIBITED AND ANY INFRINGEMENT THEREUPON MAY BE SUBJECT TO LEGAL ACTION.	PROJECT MGR: WSM	DATE: 8-9-19	SCALE: NTS	JOB NO: 19157S
	CLIENT: SOUTHEASTERN	SHT. 14	DWG. NO: SK-3	REV: 0

BOW EAVE RAFTER LEAN-TO OPTION

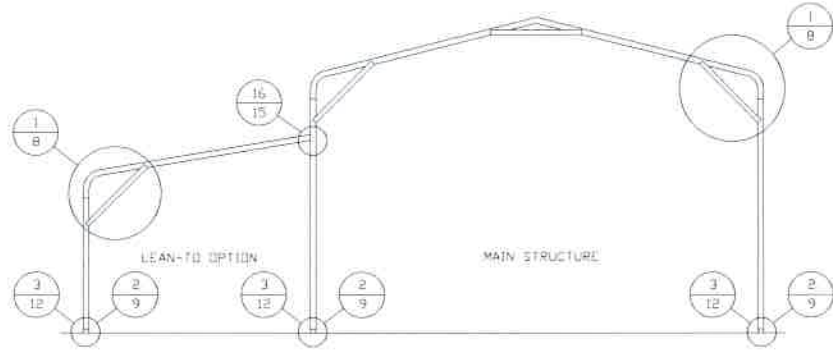

TYPICAL BOW RAFTER LEAN-TO OPTION FRAMING SECTION

SCALE: NTS

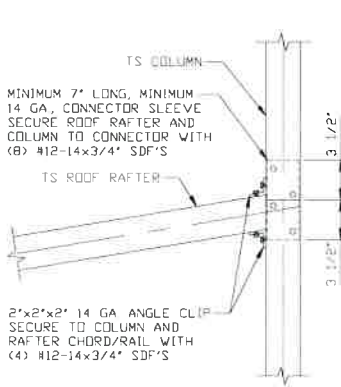

LEAN-TO RAFTER TO RAFTER COLUMN CONNECTION DETAIL FOR RAFTER SPANS \leq 12'-0"

SCALE: NTS

16

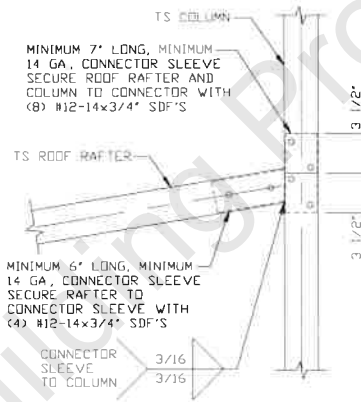

LEAN-TO RAFTER TO RAFTER COLUMN CONNECTION DETAIL FOR RAFTER SPANS \leq 12'-0"

SCALE: NTS

16A

IF YOU DON'T SEE THE SOUTHEASTERN BUILDING PRODUCT WATERMARK THIS DRAWING IS VOID

**MOORE AND ASSOCIATES
ENGINEERING AND CONSULTING, INC.**

DRAWN BY: LT

CHECKED BY: PDH

PROJECT MGR: WSM

CLIENT: SOUTHEASTERN

SOUTHEASTERN BUILDING PRODUCTS
714 WARSAW RD.
CLINTON, NC 28328
30'-0"x16'-0" ENCLOSED STRUCTURE

DATE: 8-9-19

SHT. 15

SCALE: NTS

DWG. NO: SK-3

JOB NO: 19157S

REV: 0

THIS DOCUMENT IS THE PROPERTY OF MOORE AND ASSOCIATES ENGINEERING AND CONSULTING. THE UNAUTHORIZED REPRODUCTION, COPYING, OR OTHERWISE USE OF THIS DOCUMENT IS STRICTLY PROHIBITED AND ANY INFRINGEMENT THEREUPON MAY BE SUBJECT TO LEGAL ACTION.

BOX EAVE RAFTER VERTICAL ROOF/SIDING OPTION

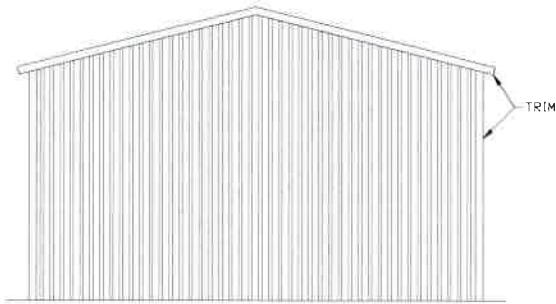

**TYPICAL END ELEVATION
VERTICAL ROOF/SIDING**

SCALE: NTS

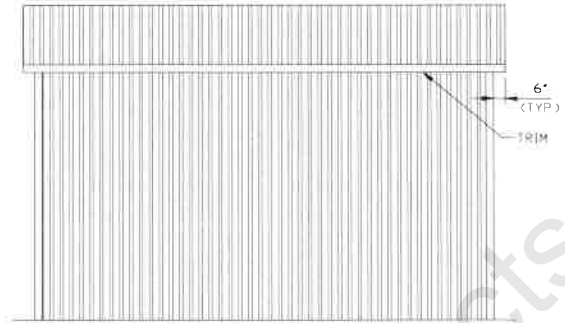

**TYPICAL SIDE ELEVATION
VERTICAL ROOF/SIDING**

SCALE: NTS

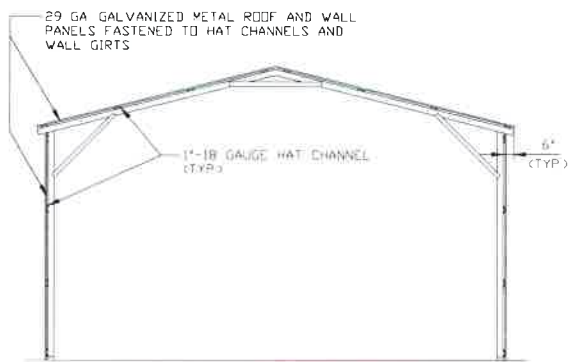

**TYPICAL SECTION VERTICAL
ROOF/SIDING OPTION**

SCALE: NTS

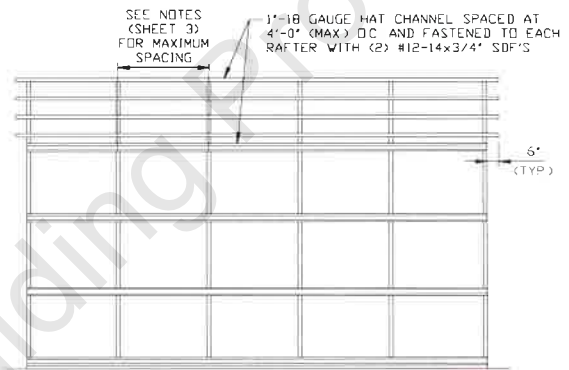

**TYPICAL FRAMING SECTION
VERTICAL ROOF/SIDING OPTION**

SCALE: NTS

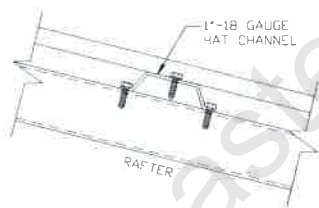

ROOF PANEL ATTACHMENT

(ALTERNATE FOR VERTICAL ROOF PANELS)
SCALE: NTS

**IF YOU DON'T SEE THE SOUTHEASTERN BUILDING PRODUCT WATERMARK THIS
DRAWING IS VOID**

**MOORE AND ASSOCIATES
ENGINEERING AND CONSULTING, INC.**

DRAWN BY: LT

CHECKED BY: PDH

PROJECT MGR: WSM

CLIENT: SOUTHEASTERN

SOUTHEASTERN BUILDING PRODUCTS
714 WARSAW RD.
CLINTON, NC 28328
30'-0"x16'-0" ENCLOSED STRUCTURE

DATE: 8-9-19

SHT. 16

SCALE: NTS

DWG. NO: SK-3

JOB NO: 19157S

REV: 0

THIS DOCUMENT IS THE PROPERTY OF MOORE AND ASSOCIATES ENGINEERING AND CONSULTING. THE UNAUTHORIZED REPRODUCTION, COPYING, OR OTHERWISE USE OF THIS DOCUMENT IS STRICTLY PROHIBITED AND ANY INFRINGEMENT THEREUPON MAY BE SUBJECT TO LEGAL ACTION.