

Harnett County Department of Public Health Improvement Permit

A building permit cannot be issued with only an Improvement Permit

ISSUED TO: Omar Peña Leyva PROPERTY LOCATION: 2221 Ebenezer Church Rd. (SR 1538)
 SUBDIVISION _____ LOT # _____
 NEW REPAIR EXPANSION Site Improvements required prior to Construction Authorization Issuance: _____
 Type of Structure: 3-Bedroom 32'x70' DW
 Proposed Wastewater System Type: 25% Reduction Sys.
 Projected Daily Flow: 360 GPD
 Number of bedrooms: 3 Number of Occupants: 6 max
 Basement Yes No
 Pump Required: Yes No May be required based on final location and elevations of facilities
 Type of Water Supply: Community Public Well Distance from well NA feet Permit valid for: Five years
 Permit conditions: _____ No expiration

Authorized State Agent: [Signature] Date: 08/28/2019 SEE ATTACHED SITE SKETCH
08/14/2019
 The issuance of this permit by the Health Department in no way guarantees the issuance of other permits. The permit holder is responsible for checking with appropriate governing bodies in meeting their requirements. This site is subject to revocation if the site plan, plat, or the intended use changes. The Improvement Permit shall not be affected by a change in ownership of the site. This permit is subject to compliance with the provisions of the Laws and Rules for Sewage Treatment and Disposal and to conditions of this permit.

Construction Authorization (Required for Building Permit)

The construction and installation requirements of Rules .1950, .1952, .1954, .1955, .1956, .1957, .1958, and .1959 are incorporated by references into this permit and shall be met. Systems shall be installed in accordance with the attached system layout.

ISSUED TO: Omar Peña Leyva PROPERTY LOCATION: 2221 Ebenezer Church Rd. (SR 1538)
 SUBDIVISION _____ LOT # _____
 Facility Type: 3BR 32'x70' DW New Expansion Repair
 Basement? Yes No Basement Fixtures? Yes No
 Type of Wastewater System** 25% Reduction system (Initial) Wastewater Flow: 360 GPD
 (See note below, if applicable)
25% reduction sys. (Repair)
 Installation Requirements/Conditions
 Number of trenches 3
 Septic Tank Size 1000 gallons Exact length of each trench 75 feet Trench Spacing: 9 Feet on Center
 Pump Tank Size _____ gallons Trenches shall be installed on contour at a Soil Cover: 10 inches
 Maximum Trench Depth of: 22 inches (Maximum soil cover shall not exceed 36" above the trench bottom)
 (Trench bottoms shall be level to +/-1/4" in all directions)
 Pump Requirements: _____ ft. TDH vs. _____ GPM Aggregate Depth: NA inches below pipe
NA inches above pipe
NA inches total
 Conditions: _____

**WATER LINES (INCLUDING IRRIGATION) MUST BE 10FT. FROM ANY PART OF SEPTIC SYSTEM OR REPAIR AREA.
NO UTILITIES ALLOWED IN INITIAL OR REPAIR DRAIN FIELD AREA.**

**If applicable: I understand the system type specified is different from the type specified on the application. I accept the specifications of this permit.

Owner/Legal Representative Signature: _____ Date: _____

This Construction Authorization is subject to revocation if the site plan, plat, or the intended use changes. The Construction Authorization shall not be transferred when there is a change in ownership of the site. This Construction Authorization is subject to compliance with the provisions of the Laws and Rules for Sewage Treatment and Disposal and to the conditions of this permit. SEE ATTACHED SITE SKETCH

Authorized State Agent: [Signature] Date: 08/14/2019 08/28/2019
ANDREW CURRIE Construction Authorization Expiration Date: 08/14/2024 08/28/2024

HTE# BLES1908-00052

Permit # NA

Harnett County Department of Public Health Site Sketch

ISSUED TO: Omar Peña Leyva PROPERTY LOCATOR: 2221 Ebenezer Church Rd. (S71538)
SUBDIVISION _____ LOT # _____

Authorized State Agent: ANDREW L. WAIN Date: 08/28/2019

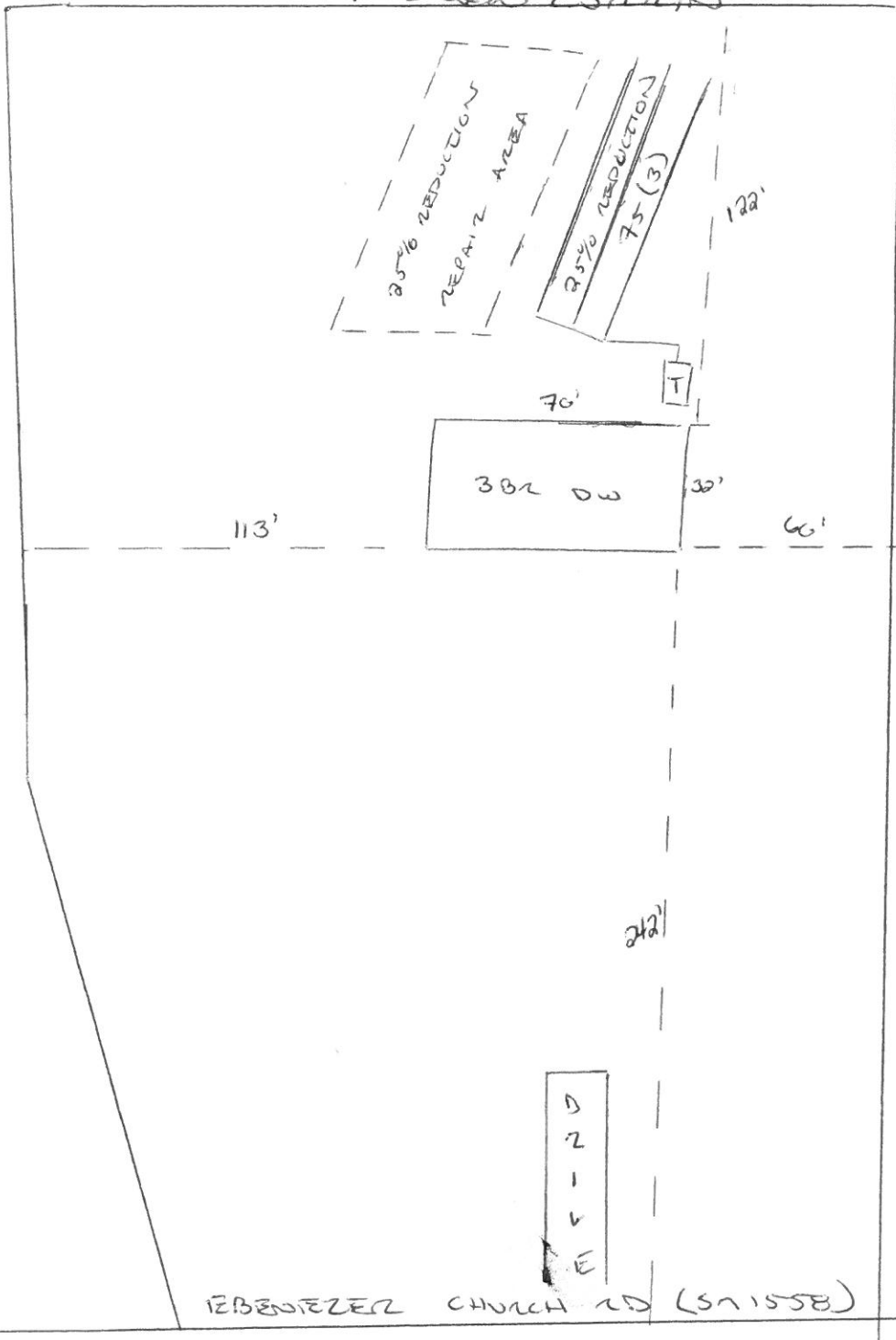

- * APPLICANT STATED REVISION WAS DUE TO AN EASEMENT BUT NO EASEMENT APPLIED OR LOCATED ON SITE PLAN
- * APPLICANT CHECKED NO EASEMENTS OR R/O ON LAND USE APPLICATION
- * NO DRIVING IN SEPTIC AREA
- * NO PORCH OR DECK WITHIN 5 FT OF SEPTIC AREA
- * THIS DRAWING IS FOR ILLUSTRATIVE PURPOSES ONLY. SYS. INSTALLATION MUST MEET ALL PERTINENT LAWS, RULES, AND REGULATIONS