

Initial Application Date: 7-11-19

Application # BRES1907-0025

CU# \_\_\_\_\_

**COUNTY OF HARNETT RESIDENTIAL LAND USE APPLICATION**

Central Permitting 108 E. Front Street, Lillington, NC 27546 Phone: (910) 893-7525 ext:2 Fax: (910) 893-2793 www.harnett.org/permits

\*\*A RECORDED SURVEY MAP, RECORDED DEED (OR OFFER TO PURCHASE) & SITE PLAN ARE REQUIRED WHEN SUBMITTING A LAND USE APPLICATION\*\*

**LANDOWNER:** Halina Llubenes Mailing Address: \_\_\_\_\_  
 City: \_\_\_\_\_ State: \_\_\_\_\_ Zip: \_\_\_\_\_ Contact No: \_\_\_\_\_ Email: \_\_\_\_\_

**APPLICANT:** Halina Llubenes Mailing Address: \_\_\_\_\_  
 City: \_\_\_\_\_ State: \_\_\_\_\_ Zip: \_\_\_\_\_ Contact No: \_\_\_\_\_ Email: \_\_\_\_\_

\*Please fill out applicant information if different than landowner

**ADDRESS:** 395 Wyratham Pl. **PIN:** 0664-97-9415.000  
**Zoning:** RA30 **Flood:** \_\_\_\_\_ **Watershed:** 13-10 **Deed Book / Page:** \_\_\_\_\_

**Setbacks - Front:** \_\_\_\_\_ **Back:** \_\_\_\_\_ **Side:** \_\_\_\_\_ **Corner:** \_\_\_\_\_

**PROPOSED USE:**

- SFD: (Size \_\_\_\_\_ x \_\_\_\_\_) # Bedrooms: \_\_\_\_\_ # Baths: \_\_\_\_\_ Basement(w/wo bath): \_\_\_\_\_ Garage: \_\_\_\_\_ Deck: \_\_\_\_\_ Crawl Space: \_\_\_\_\_ Slab: \_\_\_\_\_ Slab: \_\_\_\_\_  
 (Is the bonus room finished? ( ) yes ( ) no w/ a closet? ( ) yes ( ) no (if yes add in with # bedrooms) Monolithic
- Mod: (Size \_\_\_\_\_ x \_\_\_\_\_) # Bedrooms \_\_\_\_\_ # Baths \_\_\_\_\_ Basement (w/wo bath) \_\_\_\_\_ Garage: \_\_\_\_\_ Site Built Deck: \_\_\_\_\_ On Frame \_\_\_\_\_ Off Frame \_\_\_\_\_  
 (Is the second floor finished? ( ) yes ( ) no Any other site built additions? ( ) yes ( ) no
- Manufactured Home: \_\_\_\_\_ SW \_\_\_\_\_ DW \_\_\_\_\_ TW (Size \_\_\_\_\_ x \_\_\_\_\_) # Bedrooms: \_\_\_\_\_ Garage: \_\_\_\_\_ (site built? \_\_\_\_\_) Deck: \_\_\_\_\_ (site built? \_\_\_\_\_)
- Duplex: (Size \_\_\_\_\_ x \_\_\_\_\_) No. Buildings: \_\_\_\_\_ No. Bedrooms Per Unit: \_\_\_\_\_
- Home Occupation: # Rooms: \_\_\_\_\_ Use: \_\_\_\_\_ Hours of Operation: \_\_\_\_\_ #Employees: \_\_\_\_\_
- Addition/Accessory/Other: (Size \_\_\_\_\_ x \_\_\_\_\_) Use: Deck extension Closets in addition? ( ) yes ( ) no

Water Supply: \_\_\_\_\_ County \_\_\_\_\_ Existing Well \_\_\_\_\_ New Well (# of dwellings using well \_\_\_\_\_) **\*Must have operable water before final**  
 (Need to Complete New Well Application at the same time as New Tank)

Sewage Supply: \_\_\_\_\_ New Septic Tank \_\_\_\_\_ Expansion \_\_\_\_\_ Relocation \_\_\_\_\_ Existing Septic Tank \_\_\_\_\_ County Sewer  
 (Complete Environmental Health Checklist on other side of application if Septic)

Does owner of this tract of land, own land that contains a manufactured home within five hundred feet (500') of tract listed above? ( ) yes ( ) no

Does the property contain any easements whether underground or overhead ( ) yes ( ) no

Structures (existing or proposed): Single family dwellings: \_\_\_\_\_ Manufactured Homes: \_\_\_\_\_ Other (specify): \_\_\_\_\_

If permits are granted I agree to conform to all ordinances and laws of the State of North Carolina regulating such work and the specifications of plans submitted. I hereby state that foregoing statements are accurate and correct to the best of my knowledge. Permit subject to revocation if false information is provided.

Halina Llubenes  
 Signature of Owner or Owner's Agent

7/11/19  
 Date

\*\*\*It is the owner/applicants responsibility to provide the county with any applicable information about the subject property, including but not limited to: boundary information, house location, underground or overhead easements, etc. The county or its employees are not responsible for any incorrect or missing information that is contained within these applications.\*\*\*

\*This application expires 6 months from the initial date if permits have not been issued\*\*

**APPLICATION CONTINUES ON BACK**

strong roots • new growth

Print this page



Property Description:

LT#18 WYNDHAM PLACE 0.574MAP#2003-1051

Harnett County GIS

PID: 040664 0038 18

PIN: 0664-97-9415.000

REID: 0058874

Subdivision:

Taxable Acreage: 1.000 LT ac

Caclulated Acreage: 0.51 ac

Account Number: 1500013114

Owners: LLUBERES FREDERICO A & LLUBERES HALINA

Owner Address : 395 WYNDHAM PLACE FUQUAY VARINA, NC 27526

Property Address: 395 WYNDHAM PLACE DR FUQUAY VARINA, NC 27526

City, State, Zip: FUQUAY VARINA, NC, 27526

Building Count: 1

Township Code: 04

Fire Tax District: Angier Black River

Parcel Building Value: \$154570

Parcel Outbuilding Value : \$0

Parcel Land Value : \$32000

Parcel Special Land Value : \$0

Total Value : \$186570

Parcel Deferred Value : \$0

Total Assessed Value : \$186570

Neighborhood: 00469

Actual Year Built: 2004

TotalAcutalAreaHeated: 1990 Sq/Ft

Sale Month and Year: 8 / 2014

Sale Price: \$175000

Deed Book & Page: 3237-0989

Deed Date: 2014/08/13

Plat Book & Page: 2003-1051

Instrument Type: WD

Vacant or Improved:

QualifiedCode: Q

Transfer or Split: T

Within 1mi of Agriculture District: Yes

Prior Building Value: \$158900

Prior Outbuilding Value : \$0

Prior Land Value : \$35000

Prior Special Land Value : \$0

Prior Deferred Value : \$0

Prior Assessed Value : \$193900

SITE PLAN APPROVAL

DISTRICT RA30 USE Deck extension

#BEDROOMS —

7-11-19

K.A.G.  
ZONING ADMINISTRATOR



FEDERICO AND HAINA LINDERER  
 395 WYNNDHAM PLACE DRIVE  
 FURQUAY VARIANA, N.C. 27526  
 PHONE: 919-210-9507  
 EMAIL: FALLUBERES@GMAIL.COM

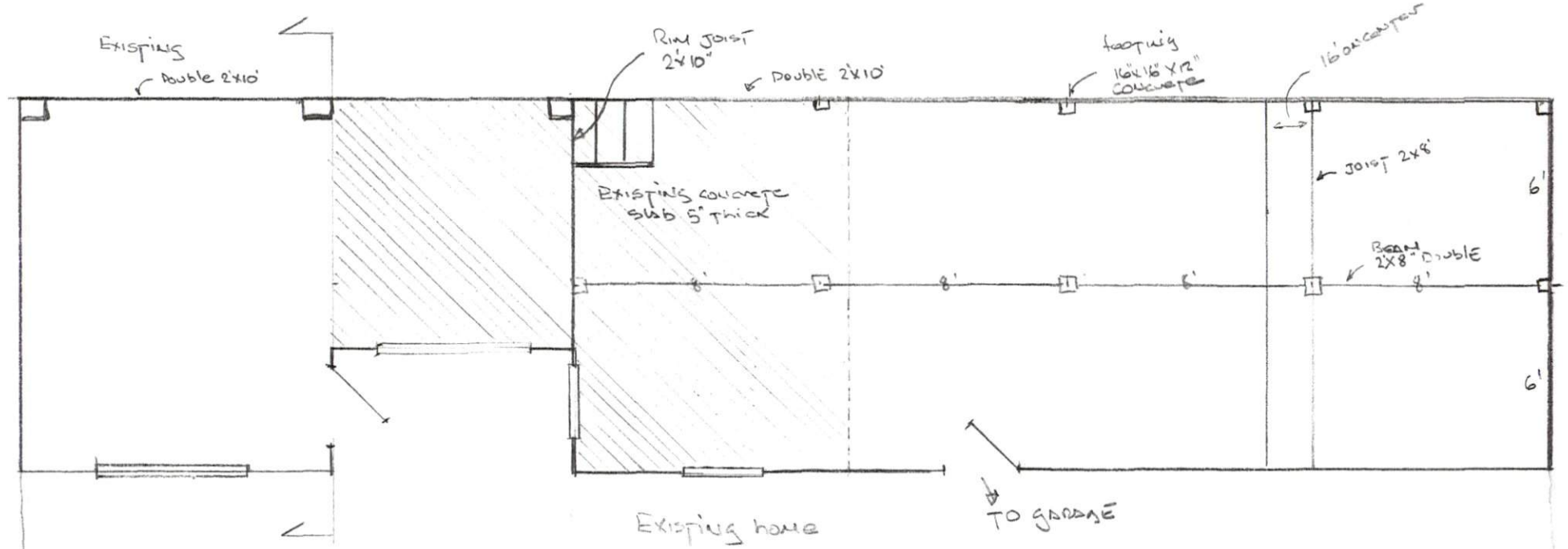
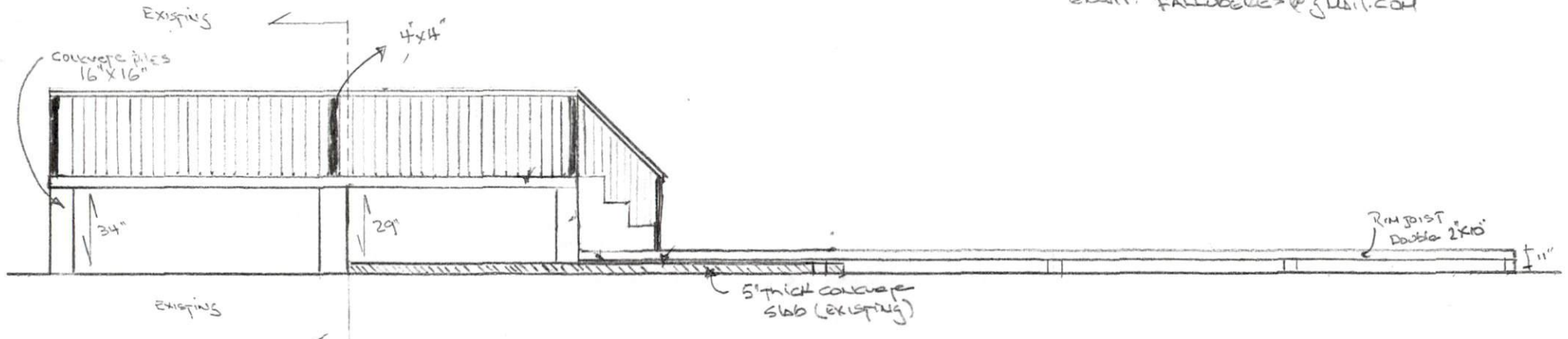

- All wood will be outdoor pressure treated
- THE DECK WILL BE ATTACHED TO THE HOUSE
- THE LOWER PART OF THE EXPANSION WILL BE 11 INCHES FROM GROUND
- FLASHING: GALVANIZED STEEL
- RIM JOIST - DOUBLE 2x10

- DECKING BOARD WILL BE COMPOSITE





EXISTING DECK TO BE EXTENDED