

**SOIL/SITE EVALUATION
 for ON-SITE WASTEWATER SYSTEM**

Owner: Applicant: John and Amanda Stanley
 Address: 1060 Wornacker Rd Date Evaluated: 8-7-19
 Proposed Facility: DW 58' x 30' Design Flow (.1949): 3600 GPD Property Size:
 Location of Site: Broadway Property Recorded:
 Water Supply: Public Individual Well Spring Other
 Evaluation Method: Auger Boring Pit Cut
 Type of Wastewater: Sewage Industrial Process Mixed

P R O F I L E #	.1940 Landscape Position/ Slope %	Horizon Depth (In.)	SOIL MORPHOLOGY .1941		OTHER PROFILE FACTORS				Profile Class & LTAR
			.1941 Structure/ Texture	.1941 Consistence Mineralogy	.1942 Soil Wetness/ Color	.1943 Soil Depth (IN.)	.1956 Sapro Class	.1944 Restr Horiz	
1	L 25%	0-12	BK SiL	V Fr Sexp	nsnp				
		12-36	BK SiCL	Fr Sexp	sssp				
		36+	PM			36"			PS 0.35
2	L 45%	0-12	BK SiL	V Fr Sexp	nsnp				
		12-48	BK SiCL	Fr Sexp	sssp 10YR 7/2	36"			PS 0.35
3	S 25%	0-12	BK SiL	V Fr Sexp	nsnp				
		12-48	BK SiCL	Fr Sexp	sssp 10YR 7/2	12"			U
4,5	Fs 25%					0"			U
Auger 6	L 15%	0-10"	BK L	V Fr Sexp	nsnp				
		10-30	BK C	Fi Sexp	S P	30"			PS 0.35

Description	Initial System	Repair System	Other Factors (.1946):
Available Space (.1945)	✓	✓	Site Classification (.1948): <u>Provisionally suitable</u>
System Type(s)	<u>25% Red</u>	<u>LDP w/ Pump</u>	Evaluated By: <u>Brittany Adams</u>
Site LTAR	<u>0.35</u>	<u>0.35</u>	Others Present: <u>01/16/2019 3:30 PM</u>

COMMENTS: _____

LANDSCAPE POSITIONS	GROUP	TEXTURES	.1955 LTAR	CONSISTENCE MOIST	WET
R-RIDGE	I	S-SAND	1.2 - 0.8	VFR-VERY FRIABLE	NS-NON-STICKY
S-SHOULDER SLOPE		LS-LOAMY SAND		FR-FRIABLE	SS-SLIGHTLY STICKY
L-LINEAR SLOPE	II	SL-SANDY LOAM	0.8 - 0.6	FI-FIRM	S-STICKY
FS-FOOT SLOPE		L-LOAM		VFI-VERY FIRM	VS-VERY STICKY
N-NOSE SLOPE		SI-SILT		EFI-EXTREMELY FIRM	NP-NON-PLASTIC
H-HEAD SLOPE	III	SIL-SILT LOAM	0.6 - 0.3		SP-SLIGHTLY STICKY
CC-CONCLAVE SLOPE		CL-CLAY LOAM			P-PLASTIC
CV-CONVEX SLOPE		SCL-SANDY CLAY LOAM			VP-VERY PLASTIC
T-TERRACE					
FP-FLOOD PLAN	IV	SIC-SILTY CLAY	0.4 - 0.1		
		C-CLAY			
		SC-SANDY CLAY			

STRUCTURE
 SG-SINGLE GRAIN
 M- MASSIVE
 CR-CRUMB
 GR-GRANULAR
 SBK-SUBANGULAR BLOCKY
 ABK-ANGULAR BLOCKY
 PL-PLATY
 PR-PRISMATIC

MINERALOGY
 SLIGHTLY EXPANSIVE
 EXPANSIVE

Show profile locations and other site features (dimensions, references or benchmark, and North)

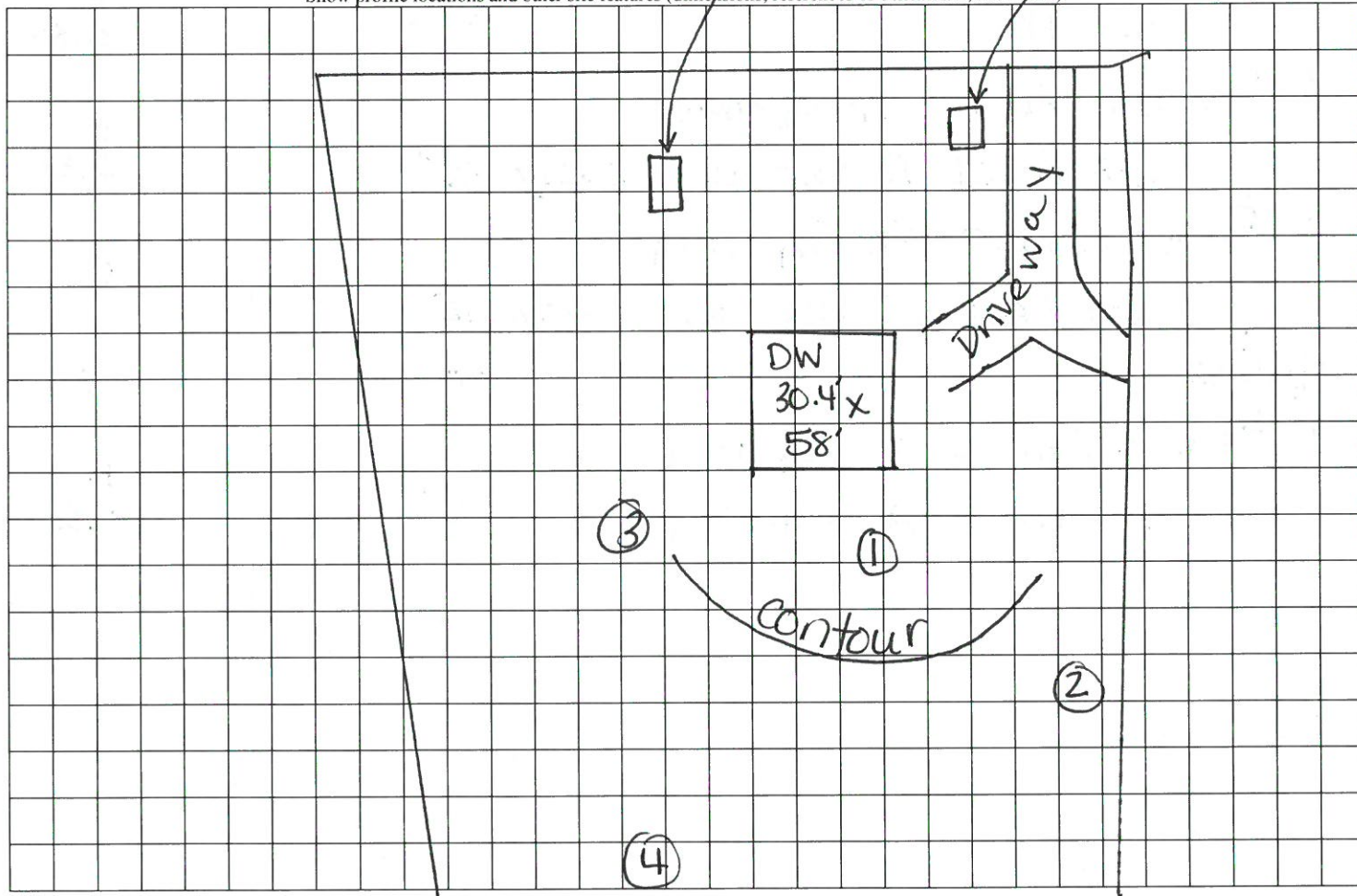

⑤