

HAL OWEN & ASSOCIATES, INC.

SOIL & ENVIRONMENTAL SCIENTISTS

P.O. Box 400, Lillington NC 27546-0400
Phone (910) 893-8743 / Fax (910) 893-3594
www.halowensoil.com

26 August 2019

Mrs. Tonia Parker
62 Jenna Lane
Dunn, NC

Reference: Soil Investigation and Septic Consulting
Tilghman Ridge Subdivision Lot 5; NC PIN 1529-04-0382

Dear Mrs. Parker,

A site investigation was conducted for the above referenced property, which is located at 62 Jenna Lane in Harnett County, North Carolina. The purpose of this investigation was to determine the feasibility of modifying the existing septic system permit for the existing three-bedroom home to allow for installation of a swimming pool. This report represents my professional opinion but does not guarantee or represent permit approval for any lot by the local Health Department.

Hal Owen & Associates Inc. reviewed the septic permit issued by the Harnett County Department of Public Health (Permit # 24105) and identified the existing septic system at the site. The home does not have a foundation drain and it utilizes the public water supply. The existing septic system utilizes a 1000 gallon septic tank and effluent gravity flows to a distribution box to 300 feet of conventional gravel drainlines. It appears that the proposed pool will not impact the existing septic system.

Potential drainlines were flagged on contour west of the existing septic system and a total of 317 feet of potential drainline is available. The repair septic system is proposed as a pump to 225 feet of accepted status drainlines utilizing serial distribution. Drainlines should be installed on contour with a maximum trench depth of 18 inches below surface. Some additional drainline area also exist in the front yard.

This report and the attached septic system design information will need to be submitted to the County Health Department for review and the permitting process. I appreciate the opportunity to provide this service and hope to be allowed to assist you again in the future. If you have any questions or need additional information, please contact me at your convenience.





Sincerely,

Hal Owen
Licensed Soil Scientist

Soil Investigation and Septic System Design
Tilghman Ridge Subdivision Lot 5
26 August 2019

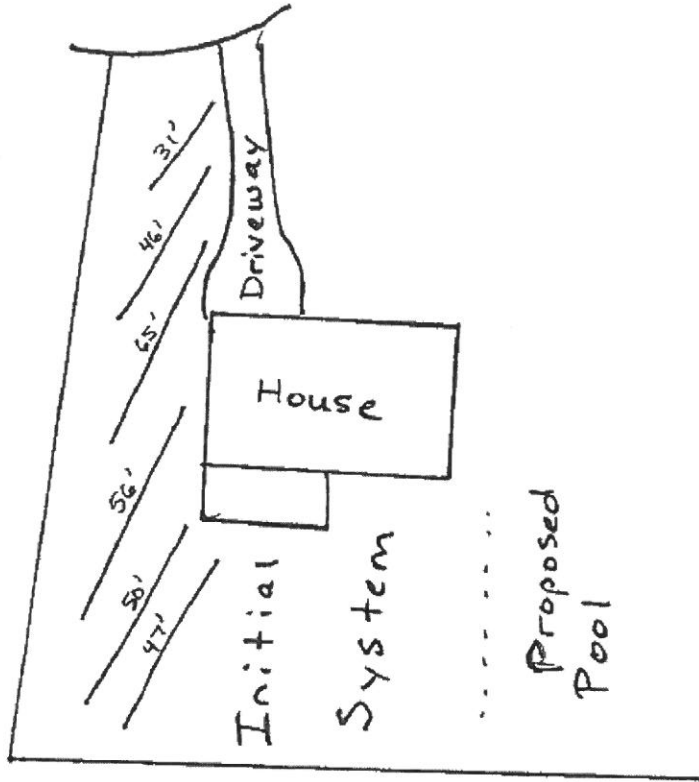
Figure 1. Septic System Layout



Scale 1 in = 50 ft

Distances are paced
and approximate

