



Initial Application Date: 6-27-19

Application # BRES 1906-0061

CU# _____

COUNTY OF HARNETT RESIDENTIAL LAND USE APPLICATION

Central Permitting 108 E. Front Street, Lillington, NC 27546 Phone: (910) 893-7525 ext:2 Fax: (910) 893-2793 www.harnett.org/permits

"A RECORDED SURVEY MAP, RECORDED DEED (OR OFFER TO PURCHASE) & SITE PLAN ARE REQUIRED WHEN SUBMITTING A LAND USE APPLICATION"

LANDOWNER: Zachary Jace LeBlanc Mailing Address: 188 Countryside Drive
City: Lillington State: NC Zip: 27546 Contact No: 910-644-6544 Email: Zacharyleblanc@yahoo.com

APPLICANT: Zachary Jace LeBlanc Mailing Address: 188
City: Lillington State: NC Zip: 27546 Contact No: 910-644-6544 Email: Zacharyleblanc@yahoo.com
*Please fill out applicant information if different than landowner

ADDRESS: _____ PIN: _____

Zoning: RADP Flood: _____ Watershed: --- Deed Book / Page: _____

Setbacks - Front: _____ Back: _____ Side: _____ Corner: _____

PROPOSED USE:

- SFD: (Size _____ x _____) # Bedrooms: _____ # Baths: _____ Basement (w/wo bath): _____ Garage: _____ Deck: _____ Crawl Space: _____ Slab: _____ Slab: _____
(Is the bonus room finished? () yes () no w/ a closet? () yes () no (if yes add in with # bedrooms)
- Mod: (Size _____ x _____) # Bedrooms _____ # Baths _____ Basement (w/wo bath) _____ Garage: _____ Site Built Deck: _____ On Frame _____ Off Frame _____
(Is the second floor finished? () yes () no Any other site built additions? () yes () no
- Manufactured Home: _____ SW _____ DW _____ TW (Size _____ x _____) # Bedrooms: _____ Garage: _____ (site built? _____) Deck: _____ (site built? _____)
- Duplex: (Size _____ x _____) No. Buildings: _____ No. Bedrooms Per Unit: _____
- Home Occupation: # Rooms: _____ Use: _____ Hours of Operation: _____ #Employees: _____
- Addition/Accessory/Other: (Size 12 x 16) Use: Storage (12x12) - permit not needed Closets in addition? () yes () no

Water Supply: County _____ Existing Well _____ New Well (# of dwellings using well _____) *Must have operable water before final
(Need to Complete New Well Application at the same time as New Tank)

Sewage Supply: _____ New Septic Tank _____ Expansion _____ Relocation _____ Existing Septic Tank _____ County Sewer
(Complete Environmental Health Checklist on other side of application if Septic)

Does owner of this tract of land, own land that contains a manufactured home within five hundred feet (500') of tract listed above? () yes () no

Does the property contain any easements whether underground or overhead () yes () no

Structures (existing or proposed): Single family dwellings: _____ Manufactured Homes: _____ Other (specify): _____

If permits are granted I agree to conform to all ordinances and laws of the State of North Carolina regulating such work and the specifications of plans submitted. I hereby state that foregoing statements are accurate and correct to the best of my knowledge. Permit subject to revocation if false information is provided.

[Signature]
Signature of Owner or Owner's Agent

27 June 2019
Date

It is the owner/applicants responsibility to provide the county with any applicable information about the subject property, including but not limited to: boundary information, house location, underground or overhead easements, etc. The county or its employees are not responsible for any incorrect or missing information that is contained within these applications.
*This application expires 6 months from the initial date if permits have not been issued**

APPLICATION CONTINUES ON BACK

strong roots • new growth

SITE PLAN APPROVAL

DISTRICT

RA20 USE 12X16

STORAGE SHED

1 BEDROOM

ZONING ADMINISTRATOR

1921-19 K.A.G.

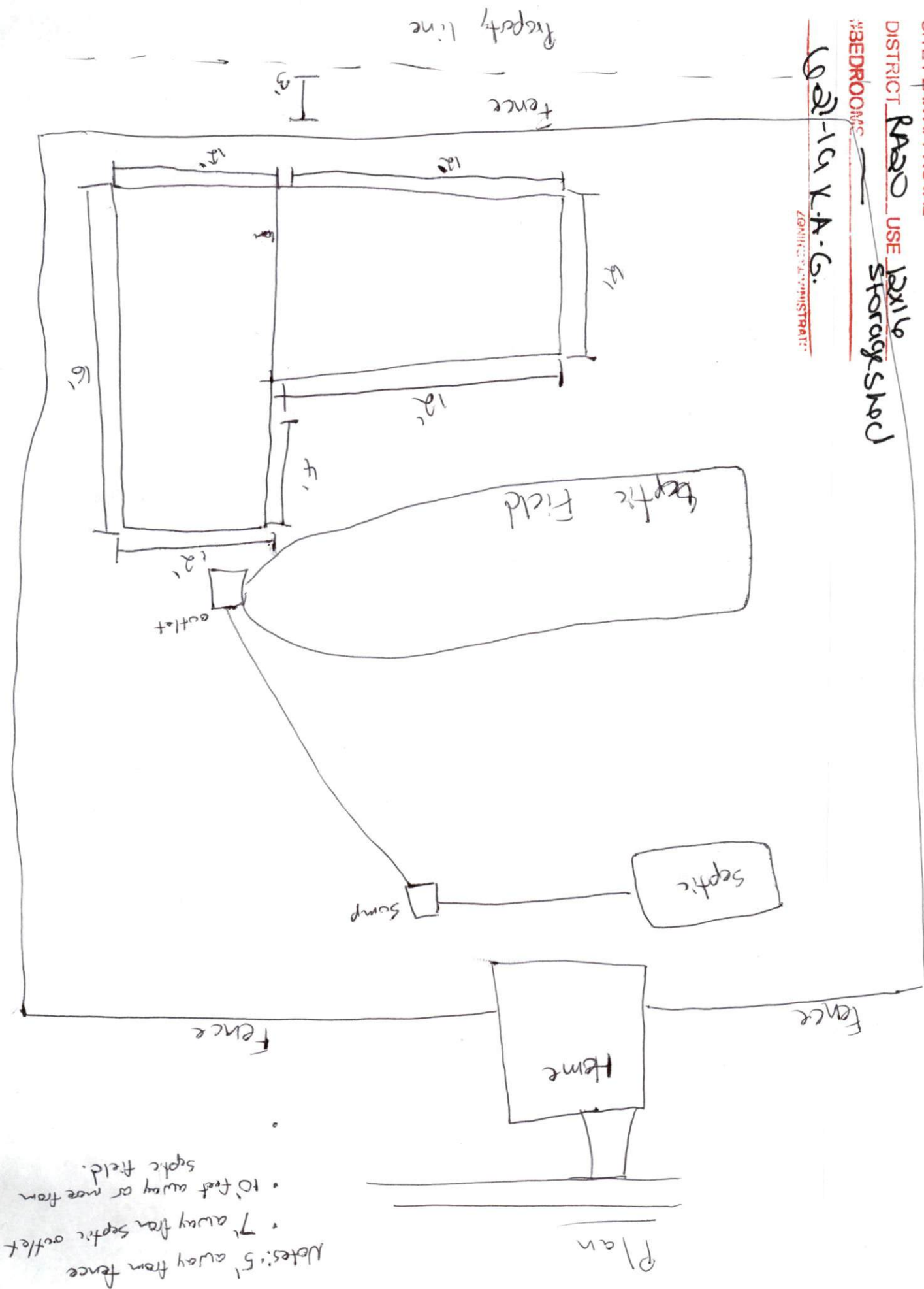

- Notes:
- 5' away from fence
 - 7' away from septic outlet
 - 10' feet away or more from septic field.

Print this page



Property Description:

LT#58 OAKMONT SD PH1 S3 0.50AC MAP#2013-346

Harnett County GIS

PID: 03050701 0046 13

PIN: 0507-31-7649.000

REID: 0081199

Subdivision:

Taxable Acreage: 1.000 LT ac

Cacluated Acreage: 0.5 ac

Account Number: 1500023691

Owners: LEBLANC ZACHARY & LEBLANC GLORIA

Owner Address : 188 COUNTRYSIDE DR LILLINGTON, NC 27546

Property Address: 188 COUNTRYSIDE DR LILLINGTON, NC 27546

City, State, Zip: LILLINGTON, NC, 27546

Building Count: 1

Township Code: 03

Fire Tax District: Benhaven

Parcel Building Value: \$244130

Parcel Outbuilding Value : \$0

Parcel Land Value : \$40000

Parcel Special Land Value : \$0

Total Value : \$284130

Parcel Deferred Value : \$0

Total Assessed Value : \$284130

Neighborhood: 00324

Actual Year Built: 2016

TotalAcutalAreaHeated: 3189 Sq/Ft

Sale Month and Year: 6 / 2017

Sale Price: \$260000

Deed Book & Page: 3517-0619

Deed Date: 2017/06/27

Plat Book & Page: 2013-346

Instrument Type: WD

Vacant or Improved:

QualifiedCode: Q

Transfer or Split: T

Within 1mi of Agriculture District: Yes

Prior Building Value: \$0

Prior Outbuilding Value : \$0

Prior Land Value : \$25000

Prior Special Land Value : \$0

Prior Deferred Value : \$0

Prior Assessed Value : \$25000

