

Approximate Foundation Locations in CrawlSpace
under 1st Floor near project area

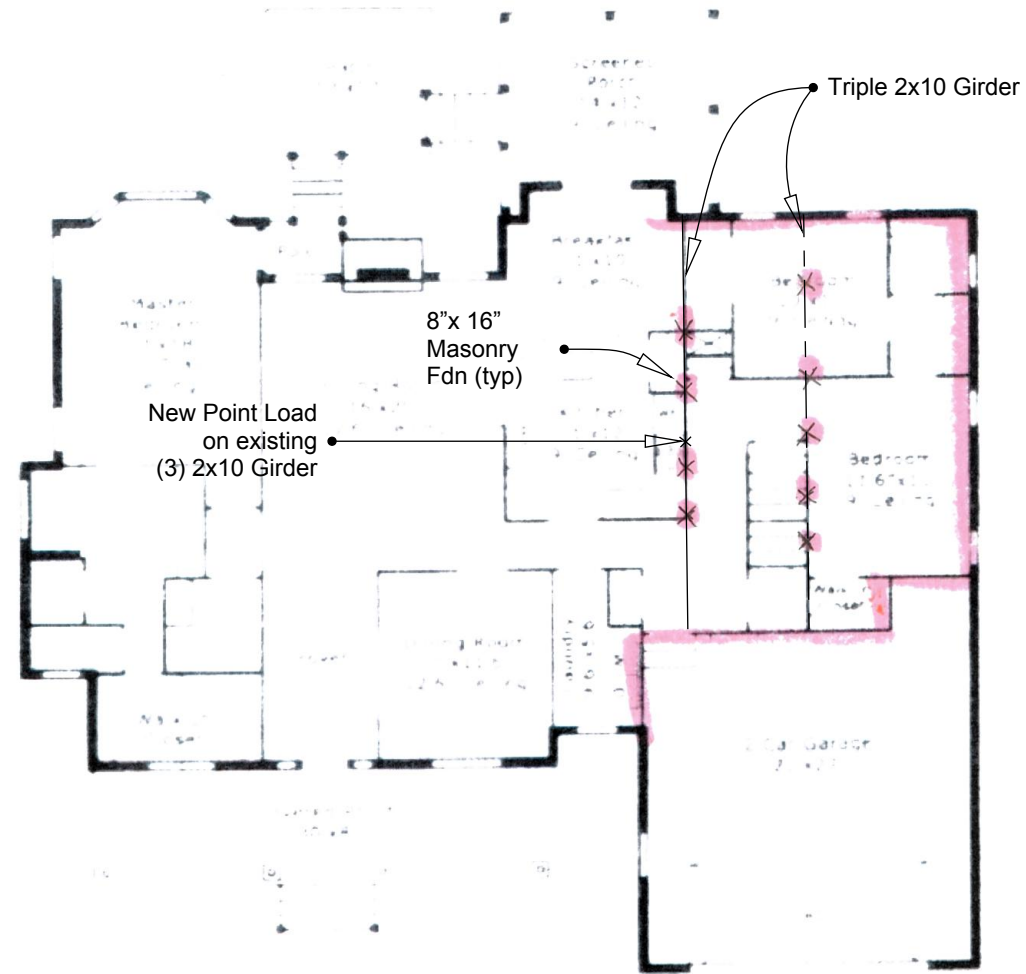

20 Rolling Pines Dr.
First Floor

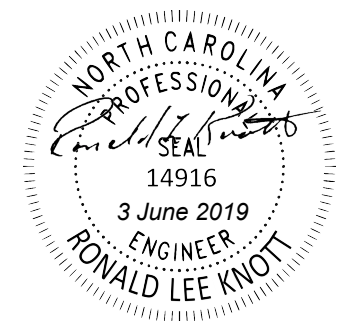

ENGINEER
Ronald L Knott, P.E.
801 Cricket Knoll Rd
Fuquay Varina, NC 27526
(919)417-1962

DESCRIPTION
Foundation Plan

ISSUE
6.3.2019

CLIENT
Daniel Fox
20 Rolling Pines Dr
Spring Lake, NC 28390

Open Stairwell
LOCATION
20 Rolling Pines Dr
Spring Lake, NC

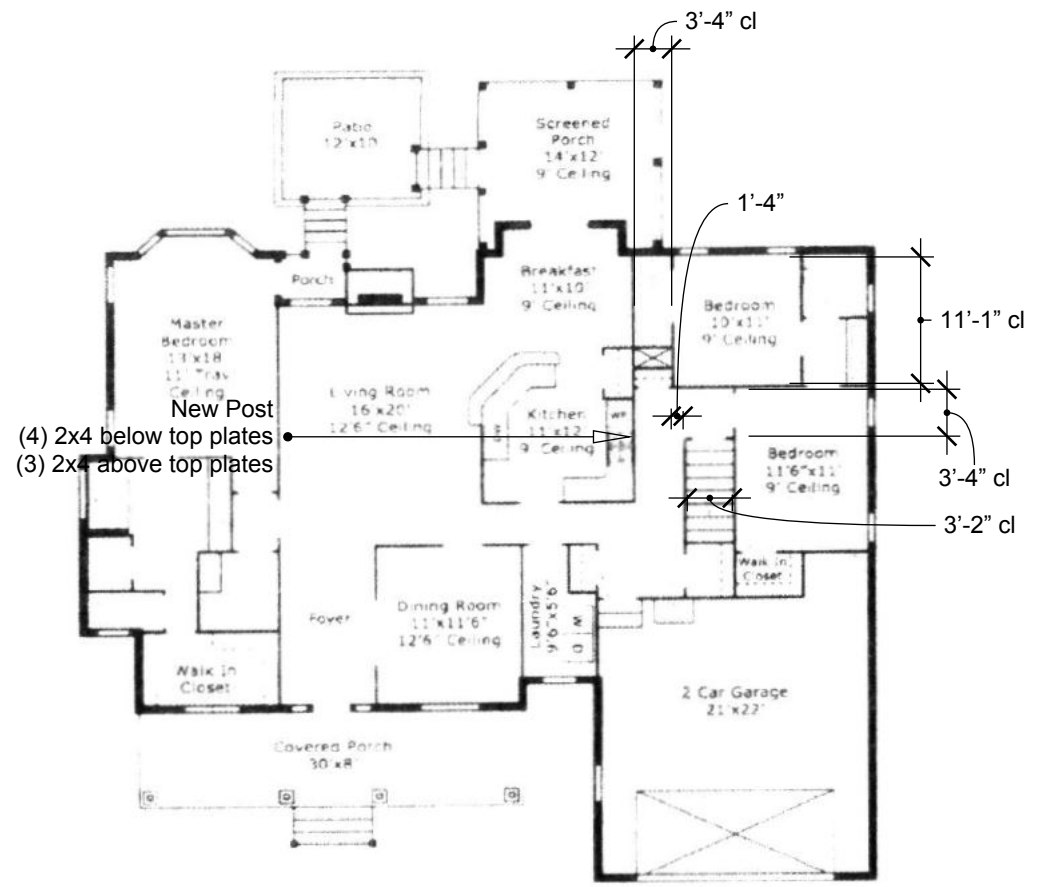

20 Rolling Pines Dr.
First Floor

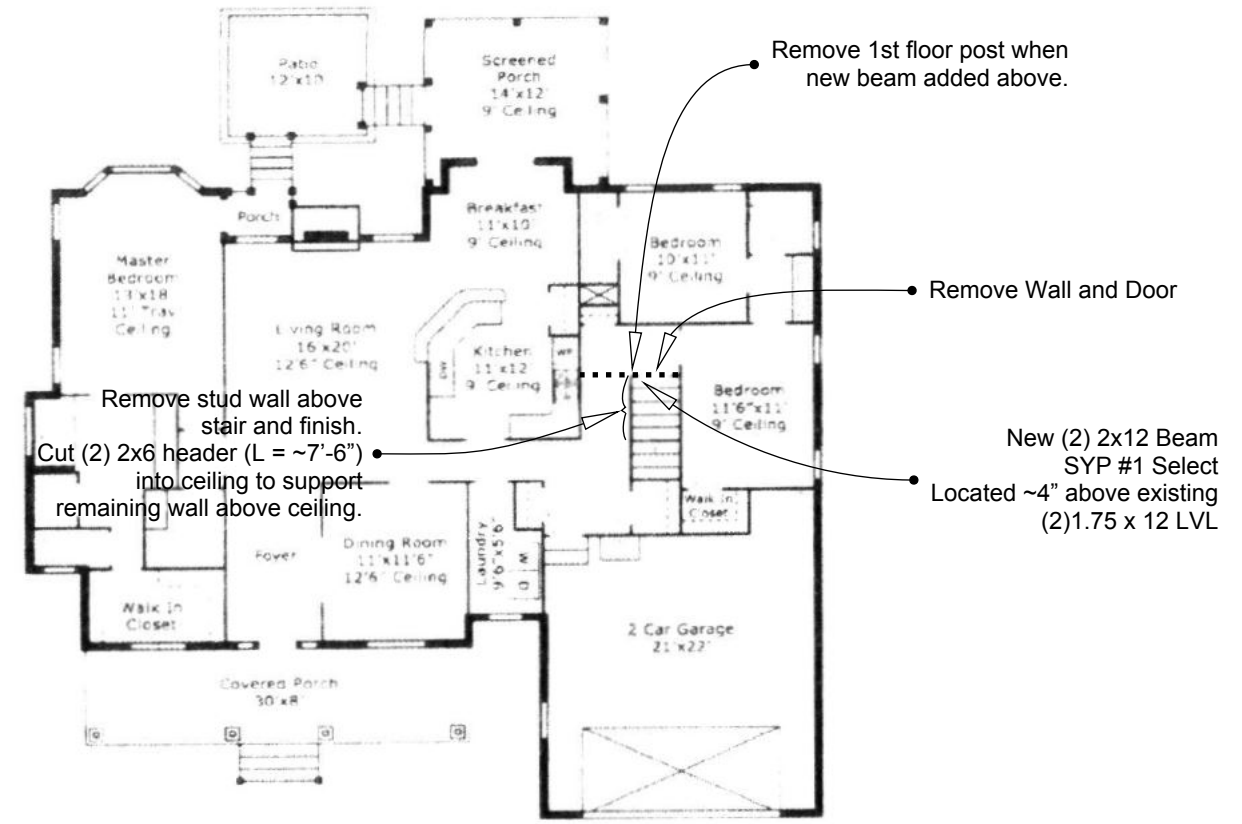

20 Rolling Pines Dr.
First Floor

Access for new beam through closet.
Remove lower part of studs to make room for beam.
Resupport on new beam.

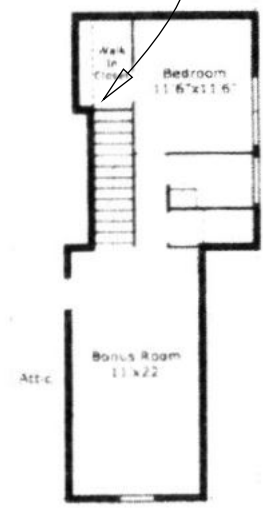

20 Rolling Pines Dr.
Second Floor

Drawings are not to scale. Drawings & room dimensions are for illustration purposes only.

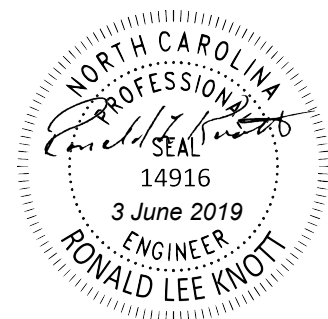

Open Stairwell
LOCATION
20 Rolling Pines Dr
Spring Lake, NC

CLIENT
Daniel Fox
20 Rolling Pines Dr
Spring Lake, NC 28390

ISSUE
6.3.2019

ENGINEER
Ronald L Knott, P.E.
801 Cricket Knoll Rd
Fuquay Varina, NC 27526
(919)417-1962

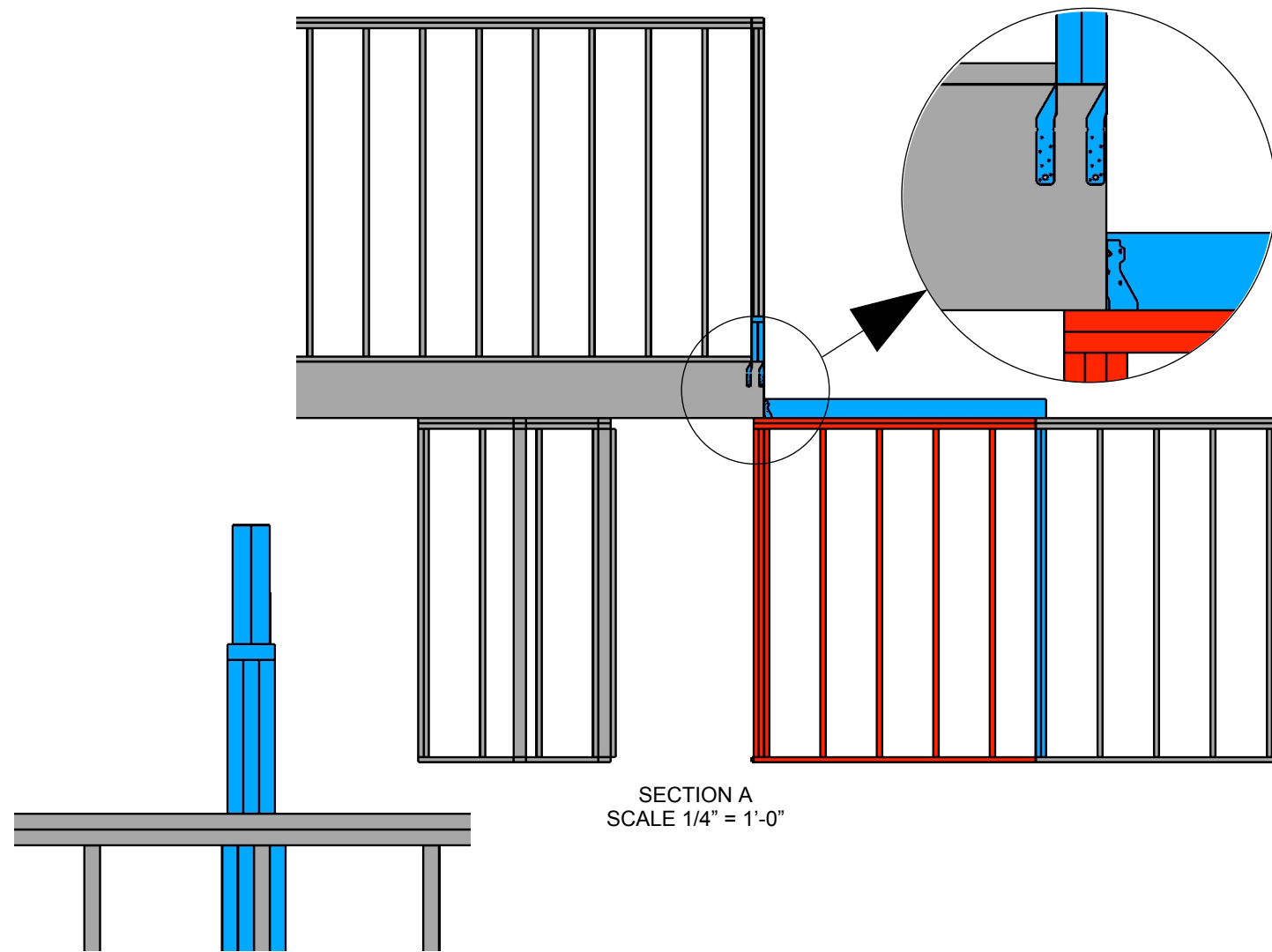

SECTION A
SCALE 1/4" = 1'-0"

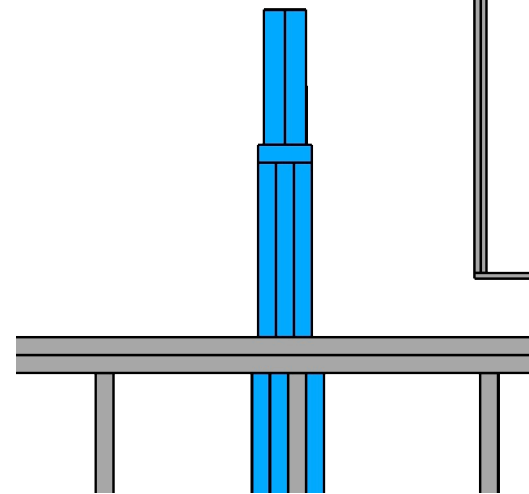

SECTION D
SCALE 3/4" = 1'-0"

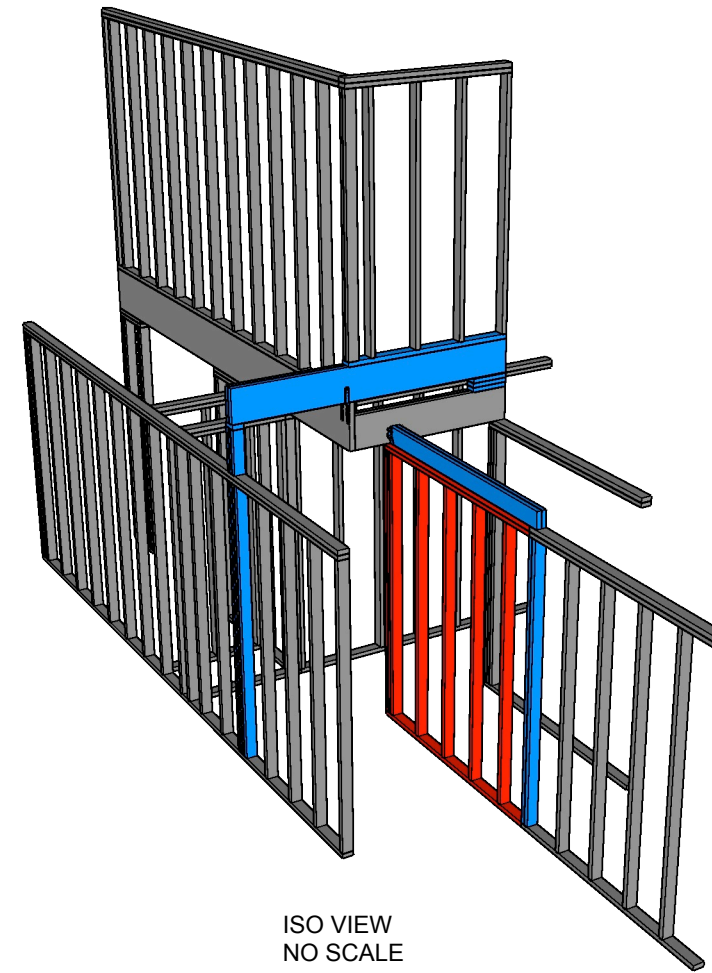

ISO VIEW
NO SCALE

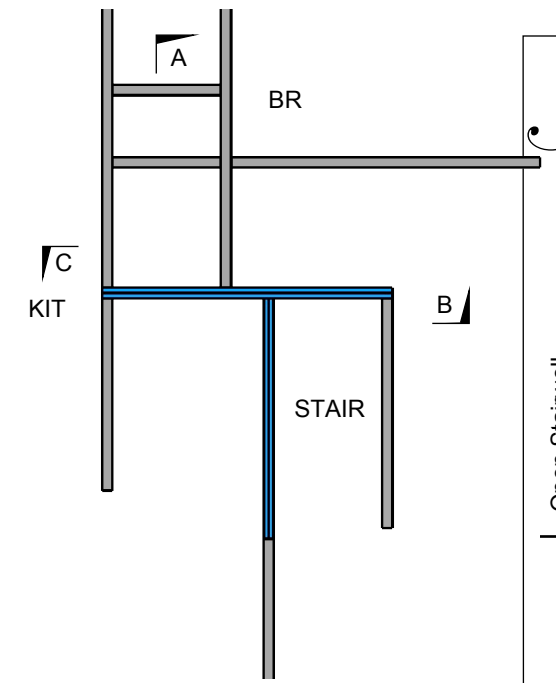

PLAN VIEW
BEAMS AND WALLS
TABOVE FIRST FLOOR
SCALE 3/16" = 1'-0"

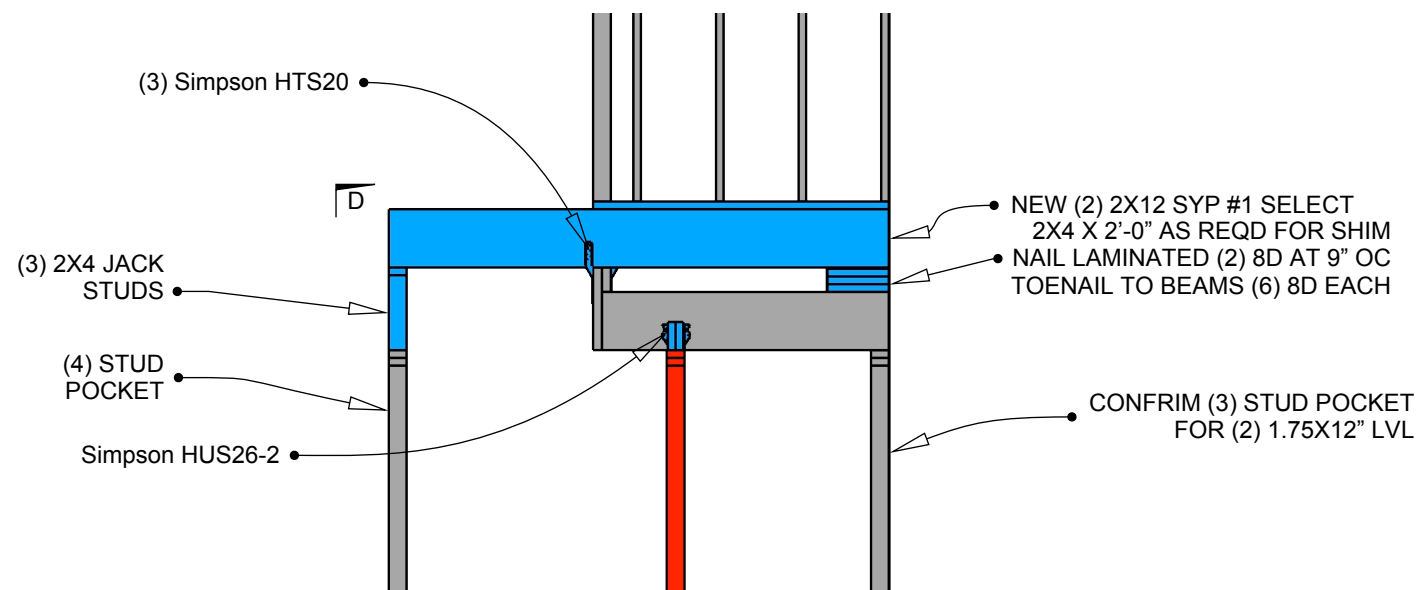

SECTION B
SCALE 3/8" = 1'-0"

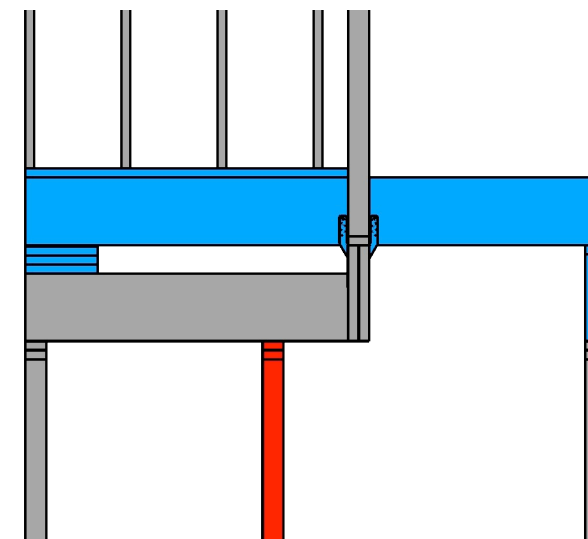

SECTION C
SCALE 3/8" = 1'-0"

NOTES:

RED - MEMBERS TO REMOVE
BLUE - NEW MEMBERS

- 1- NEW DOUBLE 2X12 IS SOUTHERN YELLOW PINE (SYP) #1 SELECT.
- 2- OTHER MEMBERS ARE SPRUCE, PINE, FIR (SPF) #2 SELECT.
- 3- NAILS ARE COMMON LENGTH SMOOTH SHANK NON-GALVANIZED OR SCREWS OF SAME LENGTH (#8 OR #9 CONSTRUCTION SCREWS).
- 4- THE DOUBLE 2X12 OR DOUBLE 2X6 BEAM MAY INCLUDE A 1/2 PLYWOOD CENTER PLY, AS DESIRED OR DIMENSIONALLY REQUIRED. NAIL LAMINATE WITH (2) 8D NAILS AT 8" OC WITHOUT PLYWOOD AND (2) 10D NAILS AT 8" OC WITH PLYWOOD.

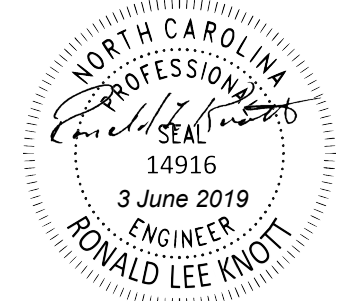

Open Stairwell
LOCATION
20 Rolling Pines Dr
Spring Lake, NC

CLIENT
Daniel Fox
20 Rolling Pines Dr
Spring Lake, NC 28390

ISSUE
6.3.2019

ENGINEER
Ronald L Knott, P.E.
801 Cricket Knoll Rd
Fuquay Varina, NC 27526
(919)417-1962

S

03