



Initial Application Date: 5/26/19
6-20-19 R

Application # BRES1905-0068 R

CU# _____

COUNTY OF HARNETT RESIDENTIAL LAND USE APPLICATION
Central Permitting 108 E. Front Street, Lillington, NC 27546 Phone: (910) 893-7525 ext:2 Fax: (910) 893-2793 www.harnett.org/permits

****A RECORDED SURVEY MAP, RECORDED DEED (OR OFFER TO PURCHASE) & SITE PLAN ARE REQUIRED WHEN SUBMITTING A LAND USE APPLICATION****

LANDOWNER: Crystal McQuaig Mailing Address: 35 GreenOak trail
City: Lillington State: NC Zip: 27546 Contact No: 9107034902 Email: c-mcquaig@yahoo.com

APPLICANT: Crystal McQuaig Mailing Address: 35 GreenOak trail
City: Lillington State: NC Zip: 27546 Contact No: 9107034902 Email: c-mcquaig@yahoo.com

ADDRESS: 35 Green Oak trl PIN: 0517-09-9412.000

Zoning: RA-20R Flood: X Watershed: NO Deed Book / Page: 2725/956

Setbacks - Front: 51' Back: 25' Side: 98' Corner: _____

PROPOSED USE:

SFD: (Size _____ x _____) # Bedrooms: _____ # Baths: _____ Basement(w/wo bath): _____ Garage: _____ Deck: _____ Crawl Space: _____ Slab: _____ Slab: _____
(Is the bonus room finished? () yes () no w/ a closet? () yes () no (if yes add in with # bedrooms))

Mod: (Size _____ x _____) # Bedrooms _____ # Baths _____ Basement (w/wo bath) _____ Garage: _____ Site Built Deck: _____ On Frame _____ Off Frame _____
(Is the second floor finished? () yes () no Any other site built additions? () yes () no)

Manufactured Home: _____ SW DW _____ TW (Size 32 x 66) # Bedrooms: 4 3 Garage: _____ (site built? _____) Deck: _____ (site built? _____)

Duplex: (Size _____ x _____) No. Buildings: _____ No. Bedrooms Per Unit: _____

Home Occupation: # Rooms: _____ Use: _____ Hours of Operation: _____ #Employees: _____

Addition/Accessory/Other: (Size _____ x _____) Use: _____ Closets in addition? () yes () no

Water Supply: County _____ Existing Well _____ New Well (# of dwellings using well _____) ***Must have operable water before final**
(Need to Complete New Well Application at the same time as New Tank)

Sewage Supply: _____ New Septic Tank _____ Expansion _____ Relocation _____ Existing Septic Tank _____ County Sewer
(Complete Environmental Health Checklist on other side of application if Septic)

Does owner of this tract of land, own land that contains a manufactured home within five hundred feet (500') of tract listed above? () yes () no

Does the property contain any easements whether underground or overhead () yes () no

Structures (existing or proposed): Single family dwellings: _____ Manufactured Homes: _____ Other (specify): _____

If permits are granted I agree to conform to all ordinances and laws of the State of North Carolina regulating such work and the specifications of plans submitted. I hereby state that foregoing statements are accurate and correct to the best of my knowledge. Permit subject to revocation if false information is provided.

Crystal McQuaig Signature of Owner or Owner's Agent Date 5-24-19

*****It is the owner/applicant's responsibility to provide the county with any applicable information about the subject property, including but not limited to: boundary information, house location, underground or overhead easements, etc. The county or its employees are not responsible for any incorrect or missing information that is contained within these applications.*****
****This application expires 6 months from the initial date if permits have not been issued****

APPLICATION CONTINUES ON BACK

strong roots • new growth



****This application expires 6 months from the initial date if permits have not been issued****

This application to be filled out when applying for a septic system inspection.

County Health Department Application for Improvement Permit and/or Authorization to Construct

IF THE INFORMATION IN THIS APPLICATION IS FALSIFIED, CHANGED, OR THE SITE IS ALTERED, THEN THE IMPROVEMENT PERMIT OR AUTHORIZATION TO CONSTRUCT SHALL BECOME INVALID. The permit is valid for either 60 months or without expiration depending upon documentation submitted. (Complete site plan = 60 months; Complete plat = without expiration)

Environmental Health New Septic System

- **All property irons must be made visible.** Place "pink property flags" on each corner iron of lot. All property lines must be clearly flagged approximately every 50 feet between corners.
- Place "orange house corner flags" at each corner of the proposed structure. Also flag driveways, garages, decks, out buildings, swimming pools, etc. Place flags per site plan developed at/for Central Permitting.
- Place orange Environmental Health card in location that is easily viewed from road to assist in locating property.
- If property is thickly wooded, Environmental Health requires that you clean out the undergrowth to allow the soil evaluation to be performed. Inspectors should be able to walk freely around site. **Do not grade property.**
- **All lots to be addressed within 10 business days after confirmation. \$25.00 return trip fee may be incurred for failure to uncover outlet lid, mark house corners and property lines, etc. once lot confirmed ready.**

Environmental Health Existing Tank Inspections

- Follow above instructions for placing flags and card on property.
- Prepare for inspection by removing soil over **outlet end** of tank as diagram indicates, and lift lid straight up (if possible) and then **put lid back in place.** (Unless inspection is for a septic tank in a mobile home park)
- **DO NOT LEAVE LIDS OFF OF SEPTIC TANK**

"MORE INFORMATION MAY BE REQUIRED TO COMPLETE ANY INSPECTION"

SEPTIC

If applying for authorization to construct please indicate desired system type(s): can be ranked in order of preference, must choose one.

- Accepted Innovative Conventional Any
 Alternative Other _____

The applicant shall notify the local health department upon submittal of this application if any of the following apply to the property in question. If the answer is "yes", applicant **MUST ATTACH SUPPORTING DOCUMENTATION**:

- YES NO Does the site contain any Jurisdictional Wetlands?
 YES NO Do you plan to have an irrigation system now or in the future?
 YES NO Does or will the building contain any drains? Please explain. _____
 YES NO Are there any existing wells, springs, waterlines or Wastewater Systems on this property?
 YES NO Is any wastewater going to be generated on the site other than domestic sewage?
 YES NO Is the site subject to approval by any other Public Agency?
 YES NO Are there any Easements or Right of Ways on this property?
 YES NO Does the site contain any existing water, cable, phone or underground electric lines?

If yes please call No Cuts at 800-632-4949 to locate the lines. This is a free service.

I Have Read This Application And Certify That The Information Provided Herein Is True, Complete And Correct. Authorized County And State Officials Are Granted Right Of Entry To Conduct Necessary Inspections To Determine Compliance With Applicable Laws And Rules. I Understand That I Am Solely Responsible For The Proper Identification And Labeling Of All Property Lines And Corners And Making The Site Accessible So That A Complete Site Evaluation Can Be Performed.

Harnett GIS

NOT FOR LEGAL USE

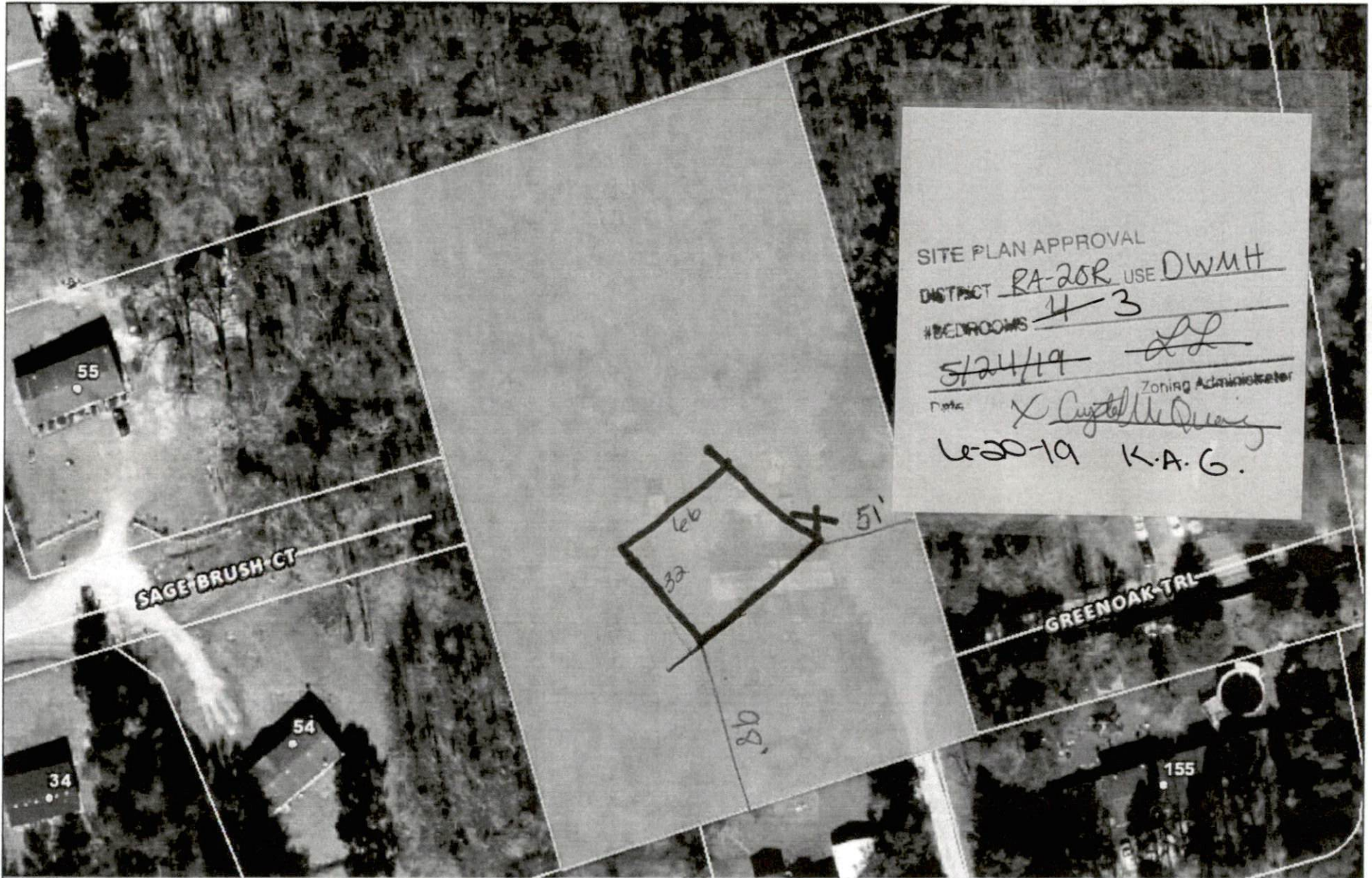

SITE PLAN APPROVAL
 DISTRICT RA-20R USE DWMH
 #BEDROOMS 4-3
 Date: 5/24/19 [Signature]
 Zoning Administrator
X Crystal McQuary
6-20-19 K.A.G.



Harnett COUNTY
NORTH CAROLINA

GIS/E-911 Addressing
May 24, 2019

| | | | |
|-------------------------------|--------------------|--------------|---------|
| Recycle Center | City Limits | NC | Parcels |
| Landfills | Address Numbers | US | |
| Surrounding County Boundaries | Airport | Roads | |
| Federal Property | Major Roads | Mile Markers | |
| | Interstate | Railroad | |



0 40 80 160
Feet

1 inch = 94 feet

Date: 5/24/19

Application #: _____

PROCEDURES AND GUIDELINES FOR MANUFACTURED HOMES
Replacement & Removal Criteria and Certification

I, Crystal McAnnis, do hereby certify the following:
(Print Name)

1. That I own a tract of land located on SR NC27W in an RA-30 / RA-40 or RA-20R RA-20M zoning district which has a functional septic tank;
2. That the existing single/~~double-wide~~ manufactured home is to be removed or was removed on 6/20/19 (date)
3. That I am replacing an existing (circle one) single wide/~~double wide~~ manufactured home with a (circle one) single wide/~~double wide~~ manufactured home or **other residential structure**, and;
4. That the replacement of this manufactured home creates 1 residence(s) on this single tract of land, and;
5. That there will be 1 manufactured home(s) on this single tract of land and I (circle one) **do/do not** own property within 500 feet of this tract that contains a manufactured home.
6. The home must have a pitched roof, for a manufactured home, whether A-shaped or rounded, which has a minimum rise of twelve (12) inches for every seven (7) feet of width. (See diagram)

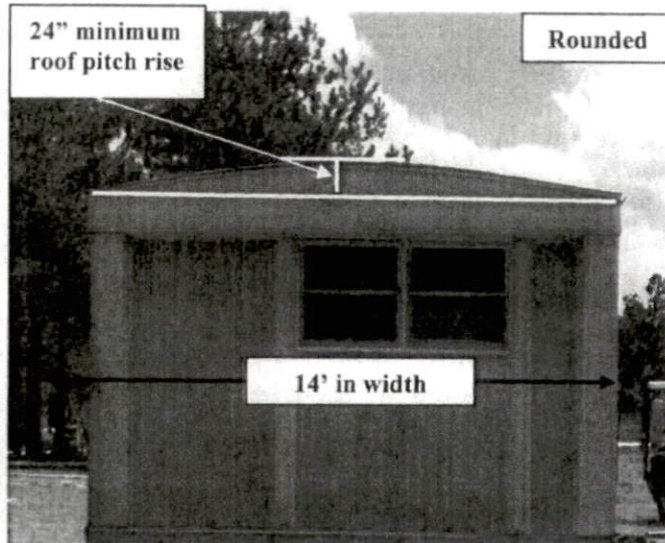
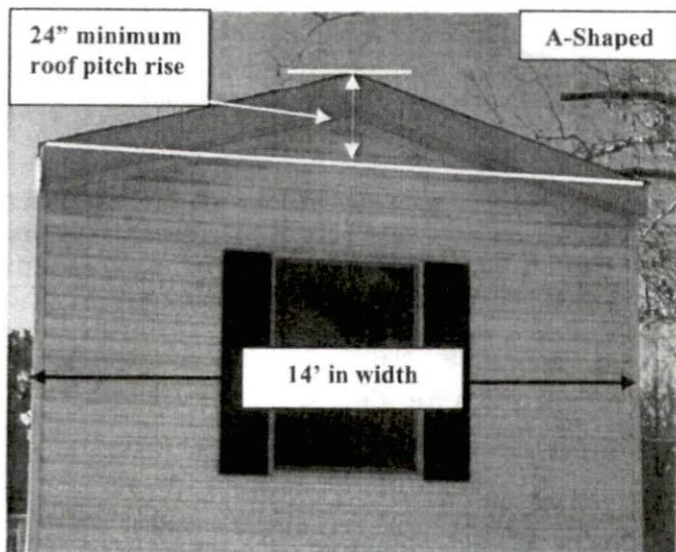

Note: Most rounded roofs **will not** meet the roof pitch requirement as illustrated. The measurement from the peak of the roof to the base line of the roof must be 12" for every 7" of total width of the home. (Example: 14' wide home = 24" roof rise)

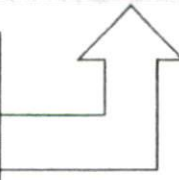

Continued...

7. The home must be underpinned, the underpinning must be installed in good workmanship-like manner along the entire base of a manufactured home, except for ventilation and crawl space requirements, and consisting of the following: metal with a baked-on finish of uniform color; a uniform design and color vinyl; or brick, cinder block, and stone masonry as well as artificial stone masonry.
8. The home must have been constructed after July 1, 1976.
9. The homes moving apparatus must be removed, underpinned or landscaped.
10. Select One of the Following Options Below
 - The current manufactured home will be removed prior to the Zoning Inspection.
 - A valid moving permit or demolition permit shall be submitted and approved prior to issuance of permit for the new structure.
 - The current manufactured home will be removed after the final inspection has been performed and the certificate of occupancy has been issued. ***Additional Fees and Requirements shall apply, see below for additional information.**

***Additional Information for Option B: Temporary approval for replacement of a manufactured home is allowed only under the procedures and limitations stated below.**

Please initial next to each item to indicate that you understand and have or will comply with as necessary.

1. A valid manufactured home moving permit must be submitted for the removal of the existing home located on the property to Harnett County Planning Services. _____
2. A copy of a Bill of Sale or a Title Transfer of the existing home must be submitted to Harnett County Development Services. _____
3. Items 1 & 2 must be submitted to Central Permitting prior to your permit issuance. _____
4. Property owner acknowledges that due to the fact that a second zoning inspection is required, in order to facilitate this request, a re-inspection fee in the amount of fifty (\$50.00) dollars shall be paid during the permitting process. _____
5. Once the home has met all other zoning requirements, a temporary approval shall be granted in order to proceed with obtaining a certificate of occupancy. From the date the certificate of occupancy is issued, the property owner shall have five (5) business days to remove the pre-existing manufactured home. _____
6. Property owner acknowledges that if the pre-existing manufactured home is not removed by the specified time of five (5) business days that he / or she shall be in direct violation of the Harnett County Unified Development Ordinance. And by creating a violation of the Harnett County Unified Development Ordinance shall subject themselves to enforcement actions, penalties, and fines specified within Article XV, (Administration, Enforcement, and Penalties) of the Harnett County Unified Development Ordinance. Each day the violation continues is a separate offense and is a misdemeanor punishable by a fine not to exceed one hundred (\$100.00) dollars or imprisonment not to exceed thirty (30) days. _____
7. Property owner acknowledges and affirms that the guidelines, procedures, and requirements associated with the replacement of a manufactured home and the penalties for creating a violation of the Harnett County Unified Development Ordinance have been explained and accepts this document as an initial *Notice of Violation*. _____

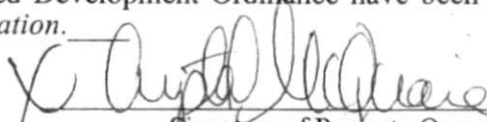

 Signature of Property Owner

5-24-19

 Date

***By signing this form the owner is stating that they have read and understand the information stated above and should consider this as their initial *Notice of Violation* if any of the above requirements/regulations are not adhered to.**