

01-5-2289

No 13529

OPERATIONS PERMIT

Name: (owner) DENNIS NORRIS BUILDERS INC New Installation Septic Tank
 Property Location: SR# 1415 RAWLS CH RD Repairs Nitrification Line
 Subdivision LEGACY @ RAWLS Lot # 9
 TAX ID# _____ Quadrant # _____
 Contractor: OTIS STRICKLAND Registration # _____

Basement with Plumbing: Garage:

Water Supply: Well Public Community

Distance From Well: 100 ft.

Following are the specifications for the sewage disposal system on above captioned property.

Type of system: Conventional Other _____

Size of tank: Septic Tank: 1000 gallons Pump Tank: _____ gallons

Subsurface Drainage Field No. of ditches 4 exact length of each ditch 100 ft. width of ditches 3 ft. depth of ditches 18 in.

French Drain: _____ Linear feet

Date: 4/2/02

PERMIT NO. 18567

Inspected by: [Signature]
Environmental Health Specialist

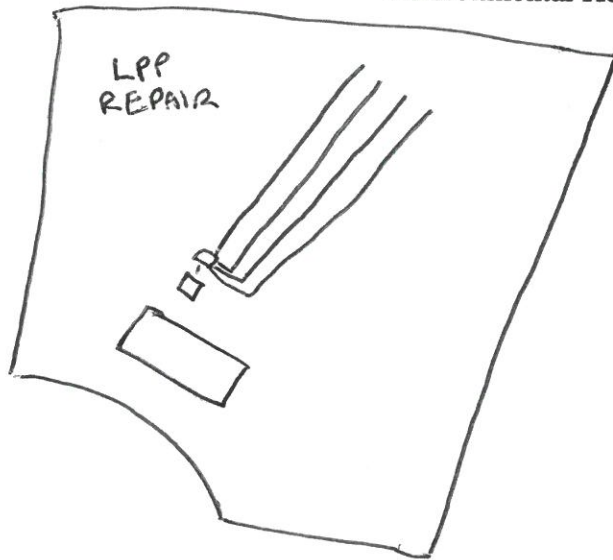

HARNETT COUNTY HEALTH DEPARTMENT IMPROVEMENT PERMIT

No 18567
1-5-2268

Be it ordained by the Harnett County Board of Health as follows: Section III, Item B. "No Person shall begin construction of any building at which a septic tank system is to be used for disposal of sewage without first obtaining a written permit from the Harnett County Health Department."

Name: (owner) DENNIS NORRIS BUILDERS INC New Installation Septic Tank
 Property Location: SR# 1475 RAWLS CH. RD. Repairs Nitrification Line

Subdivision THE LEGACY @ RAWLS Lot # 9

Tax ID # _____ Quadrant # _____

Number of Bedrooms Proposed: 3 Lot Size: 1.025 AC

Basement with Plumbing: Garage:

Water Supply: Well Public Community

Distance From Well: 100 ft.

Following is the minimum specifications for sewage disposal system on above captioned property. Subject to final approval.

Type of system: Conventional Other _____

Size of tank: Septic Tank: 1000 gallons Pump Tank: _____ gallons

Subsurface Drainage Field No. of ditches 4 exact length of each ditch 100 ft. width of ditches 3 ft. depth of ditches 18 in. * SEE BELOW

French Drain Required: _____ Linear feet

Date: 7/10/01

Signed: [Signature]
Environmental Health Specialist

This permit is subject to revocation if site plans or intended use change.

- * MAINTAIN ALL SETBACKS
- * RUN LINES ON CONTOUR
- * LOT HAS A 15% SLOPE. TRENCHES SHOULD BE DUG AS DIAGRAMED BELOW TO ACCOUNT FOR THE SLOPE

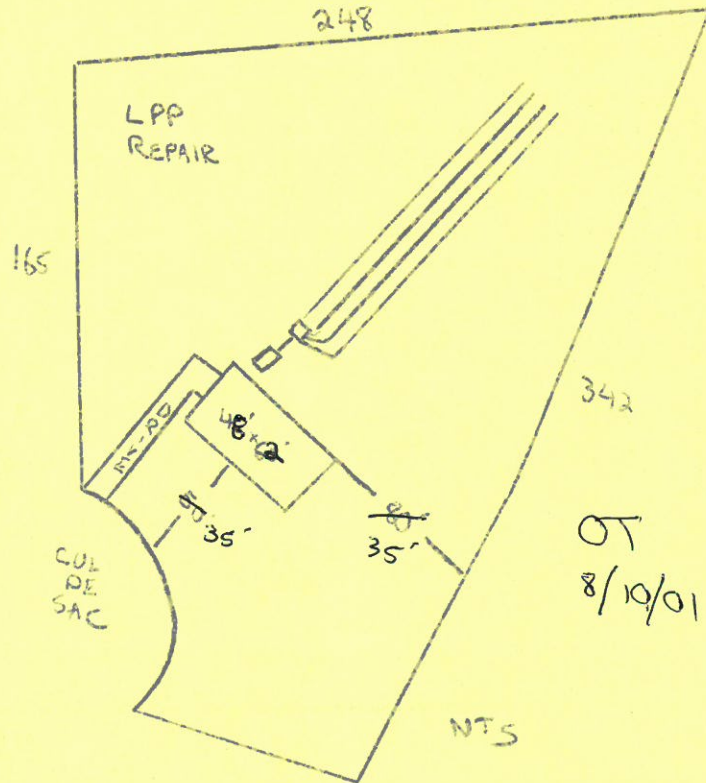
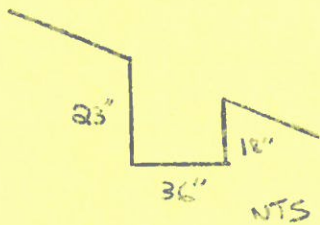

OT
8/10/01