

- Replace 3 Rafters on Each side (2x6)
- Replace 2 Ceiling Joists (2x8)
- Replace 5' of Ridge (2x8)

Seam to Be Blocked on Each Side w/
2x8

- Replace 1/2" Plywood @ Repair Area

(15) - 2x6 Rafters @ 16" O.C.

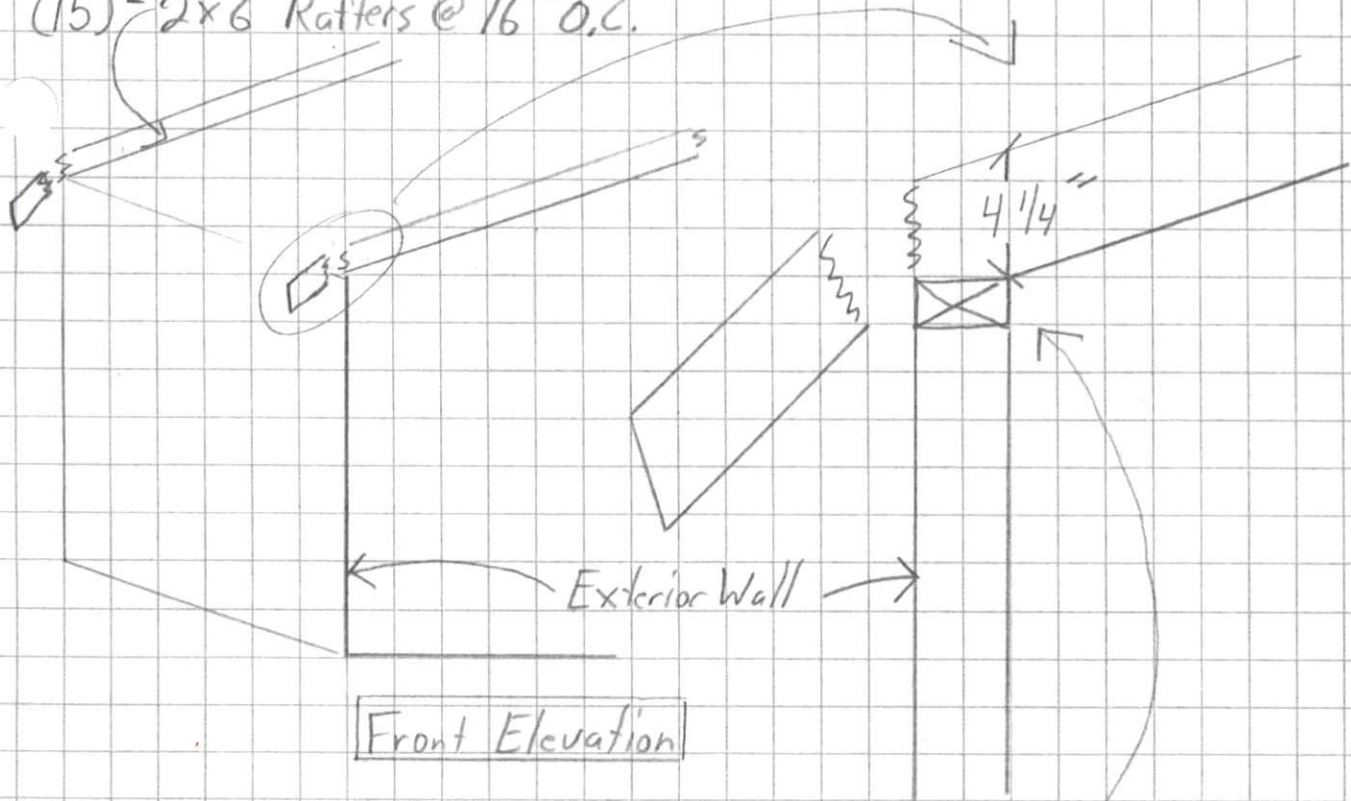

- Existing Condition

- Repair: Sister New Rafter tails 4 feet up the Rafter From Wall

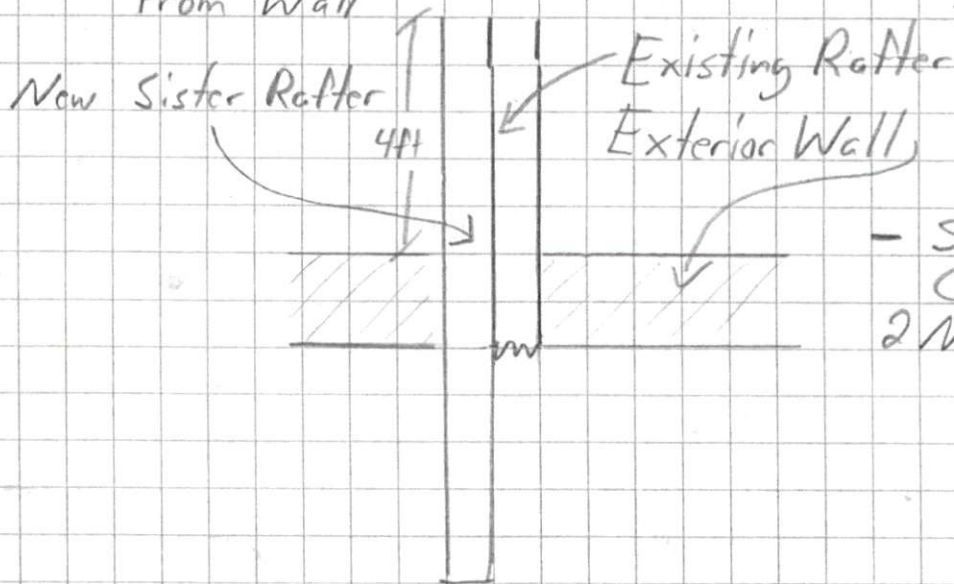

- Sister Rafters Connected w/ 16D 2 Nails every 6"