



Initial Application Date: 4-25-19

Application # BRES1904-0060

CU# _____

COUNTY OF HARNETT RESIDENTIAL LAND USE APPLICATION

Central Permitting 108 E. Front Street, Lillington, NC 27546 Phone: (910) 893-7525 ext:2 Fax: (910) 893-2793 www.harnett.org/permits

****A RECORDED SURVEY MAP, RECORDED DEED (OR OFFER TO PURCHASE) & SITE PLAN ARE REQUIRED WHEN SUBMITTING A LAND USE APPLICATION****

LANDOWNER: Johnathon Parker Mailing Address: 12297 US 421 N
City: Broadway State: NC Zip: 27505 Contact No: (919) 449-3732 Email: _____

APPLICANT*: Clayton Homes Sanford Mailing Address: 1921 Keller Andrews Rd.
City: Sanford State: NC Zip: 27330 Contact No: 919-774-1125 Email: HC1034@claytonhomes.com
*Please fill out applicant information if different than landowner

ADDRESS: Hicks Rd. Broadway PIN: 0611-18-6632.000

Zoning: RA 30 Flood: minimal Watershed: US-11 Deed Book / Page: _____

Setbacks - Front: 90 Back: 300+ Side: 200+ Corner: _____

PROPOSED USE:

- SFD: (Size ____ x ____) # Bedrooms: ____ # Baths: ____ Basement(w/wo bath): ____ Garage: ____ Deck: ____ Crawl Space: ____ Slab: ____ Slab: ____
(Is the bonus room finished? () yes () no w/ a closet? () yes () no (if yes add in with # bedrooms)
- Mod: (Size ____ x ____) # Bedrooms ____ # Baths ____ Basement (w/wo bath) ____ Garage: ____ Site Built Deck: ____ On Frame ____ Off Frame ____
(Is the second floor finished? () yes () no Any other site built additions? () yes () no
- Manufactured Home: _ _SW_ (DW) _TW (Size 28 x 56) # Bedrooms: 3 Garage: ____ (site built? ____) Deck: ____ (site built? ____)
2 bath
- Duplex: (Size ____ x ____) No. Buildings: _____ No. Bedrooms Per Unit: _____
- Home Occupation: # Rooms: _____ Use: _____ Hours of Operation: _____ #Employees: _____
- Addition/Accessory/Other: (Size ____ x ____) Use: _____ Closets in addition? () yes () no

Water Supply: ____ County ____ Existing Well ____ New Well (# of dwellings using well ____) *Must have operable water before final
(Need to Complete New Well Application at the same time as New Tank)

Sewage Supply: New Septic Tank ____ Expansion ____ Relocation ____ Existing Septic Tank ____ County Sewer
(Complete Environmental Health Checklist on other side of application if Septic)

Does owner of this tract of land, own land that contains a manufactured home within five hundred feet (500') of tract listed above? () yes no

Does the property contain any easements whether underground or overhead () yes no

Structures (existing or proposed): Single family dwellings: ____ Manufactured Homes: Other (specify): _____

If permits are granted I agree to conform to all ordinances and laws of the State of North Carolina regulating such work and the specifications of plans submitted. I hereby state that foregoing statements are accurate and correct to the best of my knowledge. Permit subject to revocation if false information is provided.

[Signature]
Signature of Owner or Owner's Agent

4/24/19
Date

*****It is the owner/applicants responsibility to provide the county with any applicable information about the subject property, including but not limited to: boundary information, house location, underground or overhead easements, etc. The county or its employees are not responsible for any incorrect or missing information that is contained within these applications.*****

This application expires 6 months from the initial date if permits have not been issued*

APPLICATION CONTINUES ON BACK

****This application expires 6 months from the initial date if permits have not been issued****

This application to be filled out when applying for a septic system inspection.

County Health Department Application for Improvement Permit and/or Authorization to Construct

IF THE INFORMATION IN THIS APPLICATION IS FALSIFIED, CHANGED, OR THE SITE IS ALTERED, THEN THE IMPROVEMENT PERMIT OR AUTHORIZATION TO CONSTRUCT SHALL BECOME INVALID. The permit is valid for either 60 months or without expiration depending upon documentation submitted. (Complete site plan = 60 months; Complete plat = without expiration)

Environmental Health New Septic System

- **All property irons must be made visible.** Place "pink property flags" on each corner iron of lot. All property lines must be clearly flagged approximately every 50 feet between corners.
- Place "orange house corner flags" at each corner of the proposed structure. Also flag driveways, garages, decks, out buildings, swimming pools, etc. Place flags per site plan developed at/for Central Permitting.
- Place orange Environmental Health card in location that is easily viewed from road to assist in locating property.
- If property is thickly wooded, Environmental Health requires that you clean out the undergrowth to allow the soil evaluation to be performed. Inspectors should be able to walk freely around site. **Do not grade property.**
- **All lots to be addressed within 10 business days after confirmation. \$25.00 return trip fee may be incurred for failure to uncover outlet lid, mark house corners and property lines, etc. once lot confirmed ready.**

Environmental Health Existing Tank Inspections

- Follow above instructions for placing flags and card on property.
- Prepare for inspection by removing soil over **outlet end** of tank as diagram indicates, and lift lid straight up (*if possible*) and then **put lid back in place.** (Unless inspection is for a septic tank in a mobile home park)
- **DO NOT LEAVE LIDS OFF OF SEPTIC TANK**

"MORE INFORMATION MAY BE REQUIRED TO COMPLETE ANY INSPECTION"

SEPTIC

If applying for authorization to construct please indicate desired system type(s): can be ranked in order of preference, must choose one.

- Accepted
 Innovative
 Conventional
 Any
 Alternative
 Other _____

The applicant shall notify the local health department upon submittal of this application if any of the following apply to the property in question. If the answer is "yes", applicant **MUST ATTACH SUPPORTING DOCUMENTATION**:

- YES NO Does the site contain any Jurisdictional Wetlands?
 YES NO Do you plan to have an irrigation system now or in the future?
 YES NO Does or will the building contain any drains? Please explain. _____
 YES NO Are there any existing wells, springs, waterlines or Wastewater Systems on this property?
 YES NO Is any wastewater going to be generated on the site other than domestic sewage?
 YES NO Is the site subject to approval by any other Public Agency?
 YES NO Are there any Easements or Right of Ways on this property?
 YES NO Does the site contain any existing water, cable, phone or underground electric lines?

If yes please call No Cuts at 800-632-4949 to locate the lines. This is a free service.

I Have Read This Application And Certify That The Information Provided Herein Is True, Complete And Correct. Authorized County And State Officials Are Granted Right Of Entry To Conduct Necessary Inspections To Determine Compliance With Applicable Laws And Rules. I Understand That I Am Solely Responsible For The Proper Identification And Labeling Of All Property Lines And Corners And Making The Site Accessible So That A Complete Site Evaluation Can Be Performed.

Print this page



Property Description:

15.92 AC JESSE PATTERSON CALC AC

Harnett County GIS

PID: 130612 0012 01

PIN: 0611-18-6632.000

REID: 0034084

Subdivision:

Taxable Acreage: 15.920 AC ac

Caclulated Acreage: 15.92 ac

Account Number: 1500023641

Owners: PRESSLEY PHILLIP EDWARD & PARKER JONATHAN GABRIEL

Owner Address : 2053 BUCKHORN RD SANFORD, NC 27330

Property Address: 2752 COOL SPRINGS RD BROADWAY, NC 27505

City, State, Zip: BROADWAY, NC, 27505

Building Count: 0

Township Code: 13

Fire Tax District: Boone Trail

Parcel Building Value: \$0

Parcel Outbuilding Value : \$0

Parcel Land Value : \$24340

Parcel Special Land Value : \$0

Total Value : \$24340

Parcel Deferred Value : \$0

Total Assessed Value : \$24340

Neighborhood: 01301

Actual Year Built:

TotalAcutalAreaHeated: Sq/Ft

Sale Month and Year: 6 / 2017

Sale Price: \$78500

Deed Book & Page: 3516-0865

Deed Date: 2017/06/23

Plat Book & Page: -

Instrument Type: WD

Vacant or Improved:

QualifiedCode: Q

Transfer or Split: T

Within 1mi of Agriculture District: Yes

Prior Building Value: \$0

Prior Outbuilding Value : \$0

Prior Land Value : \$16420

Prior Special Land Value : \$0

Prior Deferred Value : \$0

Prior Assessed Value : \$16420



Jonathan Parker
TBD Hicks Rd
Broad way NC 27505

28x56
3 bedroom 2 bath

Cool Springs Rd.

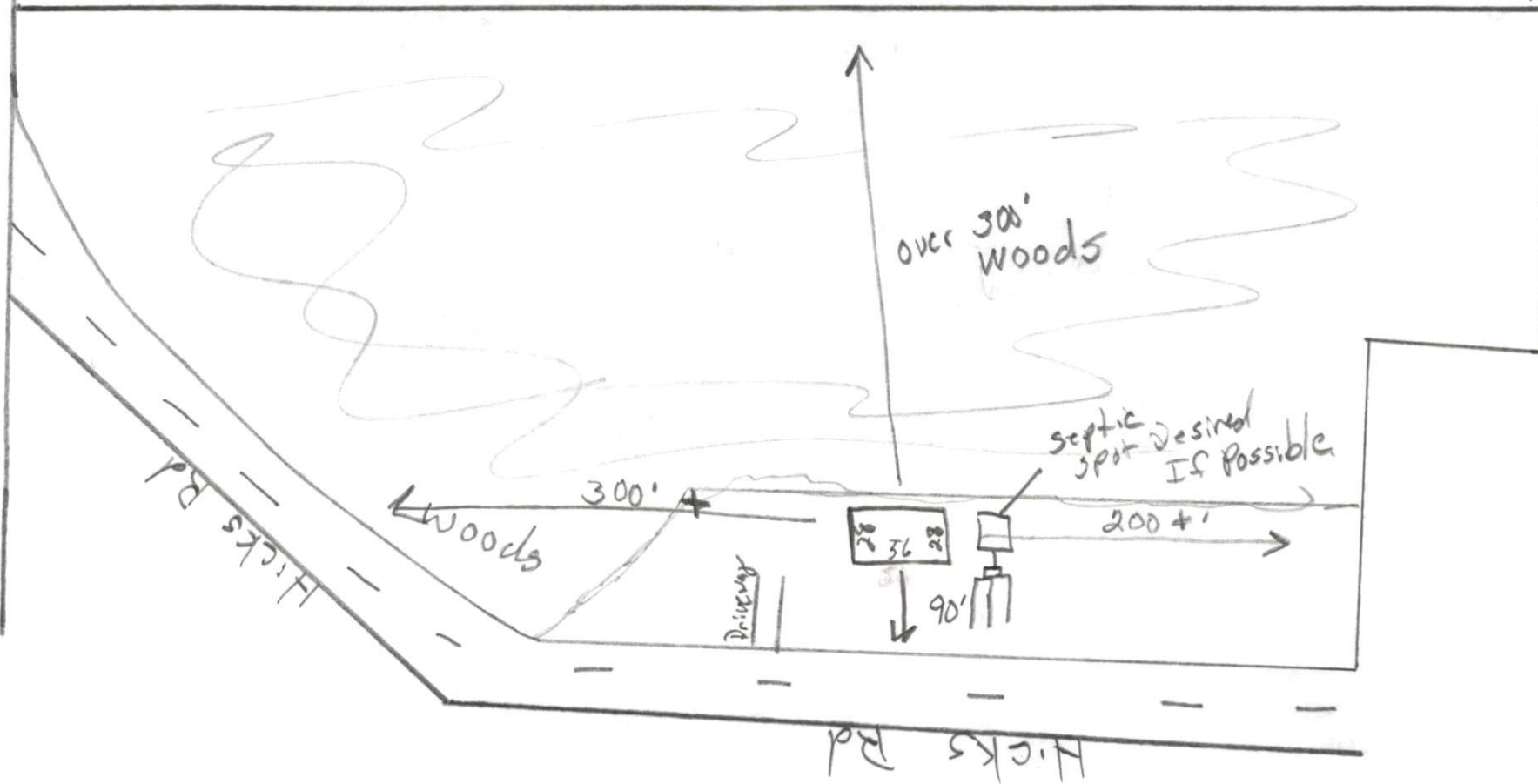

SITE PLAN APPROVAL

DISTRICT RA30 USE DW/MH

BEDROOMS 3

425-19

[Signature]
ADMINISTRATOR