



\$25.00 land use

Initial Application Date: 3-18-19

Application # BRES1910.3.002.9

CU# _____

COUNTY OF HARNETT RESIDENTIAL LAND USE APPLICATION
Central Permitting 108 E. Front Street, Lillington, NC 27546 Phone: (910) 893-7525 ext:2 Fax: (910) 893-2793 www.harnett.org/permits

****A RECORDED SURVEY MAP, RECORDED DEED (OR OFFER TO PURCHASE) & SITE PLAN ARE REQUIRED WHEN SUBMITTING A LAND USE APPLICATION****

LANDOWNER: SHERRILL LEVON KELLY Mailing Address: 744 Mt. Olive Church Rd
City: Lillington State: NC Zip: 27546 Contact No: 910-890-2467 Email: KBLACKIN@AOL.COM

APPLICANT*: _____ Mailing Address: _____
City: _____ State: _____ Zip: _____ Contact No: _____ Email: _____

*Please fill out applicant information if different than landowner
ADDRESS: mt Olive Church Rd PIN: 0518-96-6066

Zoning: R130 Flood: _____ Watershed: _____ Deed Book / Page: _____

Setbacks - Front: 95' Back: 25' Side: 130' Corner: _____

PROPOSED USE:

- SFD: (Size _____ x _____) # Bedrooms: _____ # Baths: _____ Basement(w/wo bath): _____ Garage: _____ Deck: _____ Crawl Space: _____ Slab: _____ Slab: _____
(Is the bonus room finished? () yes () no w/ a closet? () yes () no (if yes add in with # bedrooms)
- Mod: (Size _____ x _____) # Bedrooms _____ # Baths _____ Basement (w/wo bath) _____ Garage: _____ Site Built Deck: _____ On Frame _____ Off Frame _____
(Is the second floor finished? () yes () no Any other site built additions? () yes () no
- Manufactured Home: _____ SW _____ DW _____ TW (Size _____ x _____) # Bedrooms: _____ Garage: _____ (site built? _____) Deck: _____ (site built? _____)
- Duplex: (Size _____ x _____) No. Buildings: _____ No. Bedrooms Per Unit: _____
- Home Occupation: # Rooms: _____ Use: _____ Hours of Operation: _____ #Employees: _____
- Addition/Accessory/Other: (Size 30 x 40) Use: Residential Storage Closets in addition? () yes () no

Water Supply: _____ County _____ Existing Well _____ New Well (# of dwellings using well) _____ **Must have operable water before final**
(Need to Complete New Well Application at the same time as New Tank)

Sewage Supply: _____ New Septic Tank _____ Expansion _____ Relocation _____ Existing Septic Tank _____ County Sewer _____
(Complete Environmental Health Checklist on other side of application if Septic)

Does owner of this tract of land, own land that contains a manufactured home within five hundred feet (500') of tract listed above? () yes () no N/A

Does the property contain any easements whether underground or overhead () yes () no

Structures (existing or proposed): Single family dwellings: _____ Manufactured Homes: _____ Other (specify): Proposed
App: 12/2018

If permits are granted I agree to conform to all ordinances and laws of the State of North Carolina regulating such work and the specifications of plans submitted. I hereby state that foregoing statements are accurate and correct to the best of my knowledge. Permit subject to revocation if false information is provided.

Sherriell L Kelly _____ 3-18-19
Signature of Owner or Owner's Agent Date

*****It is the owner/applicants responsibility to provide the county with any applicable information about the subject property, including but not limited to: boundary information, house location, underground or overhead easements, etc. The county or its employees are not responsible for any incorrect or missing information that is contained within these applications.*****
This application expires 6 months from the initial date if permits have not been issued*

APPLICATION CONTINUES ON BACK



744 MT OLIVE CHURCH R X

Show search results for 744 MT...



SITE PLAN APPROVAL

DISTRICT RA30 USE slab found.

#BEDROOMS 3-18-19

3-18-19

ZONING ADMINISTRATOR

detached slab found. for future res. storage bldg.

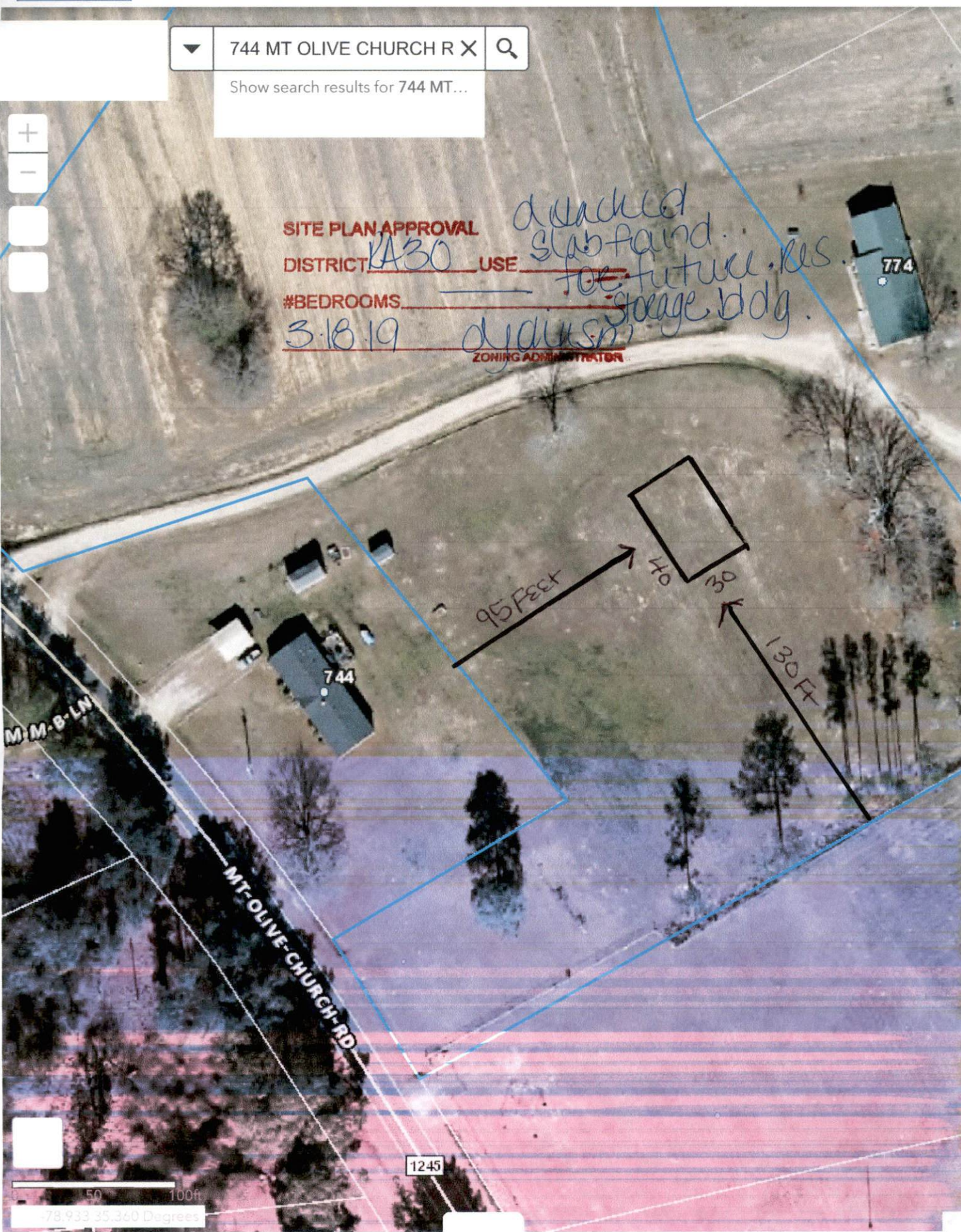

Scale bar: 50 100ft
Coordinates: -78.933 35.360 Degrees

1245

30' x 40' Shop Slab with Slick Finish, 4" thick concrete
with plastic under slab, 3 loads fill material

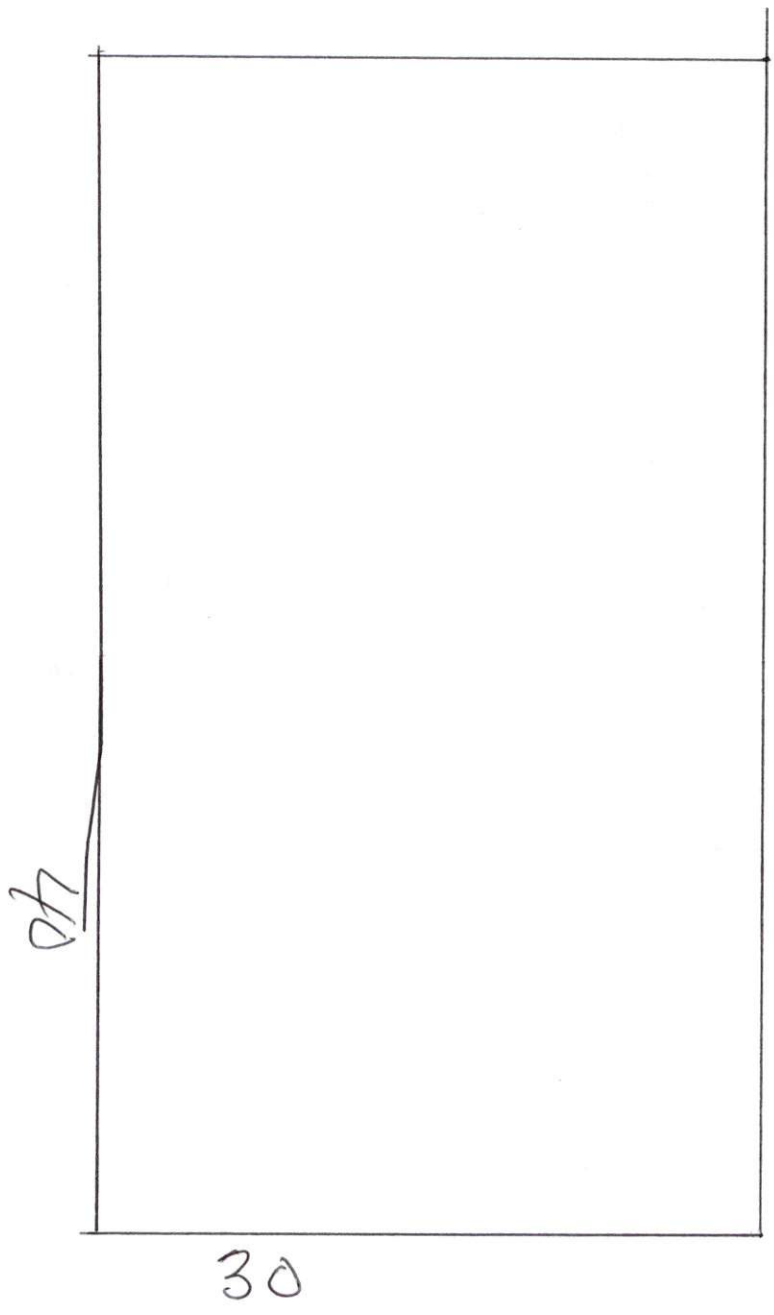

this is slab only
Bldg. will be built
later.

\$100.00 Bldg.
25.00 plan rev.
125.00
Application # _____



Harnett
COUNTY
NORTH CAROLINA

Harnett County Central Permitting
PO Box 65 Lillington, NC 27546
910-893-7525 Fax 910-893-2793 www.harnett.org/permits

* Each section below to be filled out
by whomever performing work.
Must be owner or licensed
contractor. Address, company
name & phone must match
information on license.

Application for Residential Building and Trades Permit

Owner's Name: _____ Date: _____
Site Address: _____ Phone: _____
Subdivision: _____ Lot: _____
Description of Proposed Work: _____

General Contractor Information

Building Contractor's Company Name _____ Telephone _____
Address _____ Email Address _____
License # OWNER

Electrical Contractor Information

Description of Work _____ Service Size: _____ Amps T-Pole: Yes No
Electrical Contractor's Company Name _____ Telephone _____
Address _____ Email Address _____
License # _____

Mechanical/HVAC Contractor Information

Description of Work _____
Mechanical Contractor's Company Name _____ Telephone _____
Address _____ Email Address _____
License # _____

Plumbing Contractor Information

Description of Work _____ # Baths _____
Plumbing Contractor's Company Name _____ Telephone _____
Address _____ Email Address _____
License # _____

Insulation Contractor Information

Insulation Contractor's Company Name & Address _____ Telephone _____

***NOTE: General Contractor / owner must fill out and sign the second page of this application.**



I hereby certify that I have the authority to make necessary application, that the application is correct and that the construction will conform to the regulations in the Building, Electrical, Plumbing and Mechanical codes, and the Harnett County Zoning Ordinance. I state the information on the above contractors is correct as known to me and that **by signing below I have obtained all subcontractors permission to obtain these permits** and if **any** changes occur including listed contractors, site plan, number of bedrooms, building and trade plans, Environmental Health permit changes or proposed use changes, I certify it is my responsibility to notify the Harnett County Central Permitting Department of any and all changes.

EXPIRED PERMIT FEES - 6 Months to 2 years permit re-issue fee is \$150.00. After 2 years re-issue fee is as per current fee schedule.

Terrell L. Kelly
Signature of Owner/Contractor/Officer(s) of Corporation

3-18-19
Date

Affidavit for Worker's Compensation N.C.G.S. 87-14

The undersigned applicant being the:

General Contractor Owner Officer/Agent of the Contractor or Owner

Do hereby confirm under penalties of perjury that the person(s), firm(s) or corporation(s) performing the work set forth in the permit:

- Has three (3) or more employees and has obtained workers' compensation insurance to cover them.
- Has one (1) or more subcontractors(s) and has obtained workers' compensation insurance to cover them.
- Has one (1) or more subcontractors(s) who has their own policy of workers' compensation insurance covering themselves.
- Has no more than two (2) employees and no subcontractors.

While working on the project for which this permit is sought it is understood that the Central Permitting Department issuing the permit may require certificates of coverage of worker's compensation insurance prior to issuance of the permit and at any time during the permitted work from any person, firm or corporation carrying out the work.

Sign w/Title: Terrell L. Kelly Date: 3-18-19