

Initial Application Date: 3/1/19

Application # _____

CU# _____

COUNTY OF HARNETT RESIDENTIAL LAND USE APPLICATION
Central Permitting 108 E. Front Street, Lillington, NC 27548 Phone: (910) 893-7525 ext:2 Fax: (910) 893-2793 www.harnett.org/permits

A RECORDED SURVEY MAP, RECORDED DEED (OR OFFER TO PURCHASE) & SITE PLAN ARE REQUIRED WHEN SUBMITTING A LAND USE APPLICATION

LANDOWNER: Mark Allen Mailing Address: 3705 Yorktown Rd
City: Hope Mills State: NC Zip: 28348 Contact No: 910 495 4246 Email: Mark.allen.86@yahoo.com

APPLICANT: Mark Allen Mailing Address: 3705 Yorktown Rd
City: Hope Mills State: NC Zip: 28348 Contact No: 910 495 4246 Email: mark.allen@yahoo.com
*Please fill out applicant information if different than landowner

ADDRESS: 1332 Hayes Rd Spring Lake NC 28390 PIN: 010534007701

Zoning: _____ Flood: _____ Watershed: _____ Deed Book / Page: _____

Setbacks - Front: _____ Back: _____ Side: _____ Corner: _____

PROPOSED USE:

- SFD: (Size _____ x _____) # Bedrooms: _____ # Baths: _____ Basement (w/w/o bath): _____ Garage: _____ Deck: _____ Crawl Space: _____ Slab: _____ Monolithic Slab: _____
(Is the bonus room finished? () yes () no w/ a closet? () yes () no (if yes add in with # bedrooms))
- Mod: (Size _____ x _____) # Bedrooms _____ # Baths _____ Basement (w/w/o bath) _____ Garage: _____ Site Built Deck: _____ On Frame _____ Off Frame _____
(Is the second floor finished? () yes () no Any other site built additions? () yes () no
- Manufactured Home: _____ SW _____ DW _____ TW (Size _____ x _____) # Bedrooms: _____ Garage: _____ (site built? _____) Deck: _____ (site built? _____)
- Duplex: (Size _____ x _____) No. Buildings: _____ No. Bedrooms Per Unit: _____
- Home Occupation: # Rooms: _____ Use: _____ Hours of Operation: _____ #Employees: _____
- Addition/Accessory/Other: (Size 24 x 26) Use: Storage 3 Vehicle Storage Closets in addition? () yes (X) no

Water Supply: N/A County _____ Existing Well _____ New Well (# of dwellings using well _____) *Must have operable water before final (Need to Complete New Well Application at the same time as New Tank)

Sewage Supply: N/A New Septic Tank _____ Expansion _____ Relocation _____ Existing Septic Tank _____ County Sewer
(Complete Environmental Health Checklist on other side of application if Septic)

Does owner of this tract of land, own land that contains a manufactured home within five hundred feet (500') of tract listed above? () yes (X) no

Does the property contain any easements whether underground or overhead () yes (X) no

Structures (existing or proposed): Single family dwellings: 2200 Septic Manufactured Homes: _____ Other (specify): _____

If permits are granted I agree to conform to all ordinances and laws of the State of North Carolina regulating such work and the specifications of plans submitted. I hereby state that foregoing statements are accurate and correct to the best of my knowledge. Permit subject to revocation if false information is provided.

[Signature] Signature of Owner or Owner's Agent Date: 3/1/19

It is the owner/applicants responsibility to provide the county with any applicable information about the subject property, including but not limited to: boundary information, house location, underground or overhead easements, etc. The county or its employees are not responsible for any incorrect or missing information that is contained within these applications.
*This application expires 6 months from the initial date if permits have not been issued**

APPLICATION CONTINUES ON BACK

*NO EH needed
shown on siteplan
w/ house app #
17-5041923*

County Health Department Application for Improvement Permit and/or Authorization to Construct

IF THE INFORMATION IN THIS APPLICATION IS FALSIFIED, CHANGED, OR THE SITE IS ALTERED, THEN THE IMPROVEMENT PERMIT OR AUTHORIZATION TO CONSTRUCT SHALL BECOME INVALID. The permit is valid for either 60 months or without expiration depending upon documentation submitted. (Complete site plan = 60 months; Complete plat = without expiration)

Environmental Health New Septic System

- **All property irons must be made visible.** Place "pink property flags" on each corner iron of lot. All property lines must be clearly flagged approximately every 50 feet between corners.
- Place "orange house corner flags" at each corner of the proposed structure. Also flag driveways, garages, decks, out buildings, swimming pools, etc. Place flags per site plan developed at/for Central Permitting.
- Place orange Environmental Health card in location that is easily viewed from road to assist in locating property.
- If property is thickly wooded, Environmental Health requires that you clean out the undergrowth to allow the soil evaluation to be performed. Inspectors should be able to walk freely around site. **Do not grade property.**
- **All lots to be addressed within 10 business days after confirmation. \$25.00 return trip fee may be incurred for failure to uncover outlet lid, mark house corners and property lines, etc. once lot confirmed ready.**

Environmental Health Existing Tank Inspections

- Follow above instructions for placing flags and card on property.
- Prepare for inspection by removing soil over **outlet end** of tank as diagram indicates, and lift lid straight up (if possible) and then put lid back in place. (Unless inspection is for a septic tank in a mobile home park)
- **DO NOT LEAVE LIDS OFF OF SEPTIC TANK**

SEPTIC

If applying for authorization to construct please indicate desired system type(s): can be ranked in order of preference, must choose one.

- Accepted Innovative Conventional Any
 Alternative Other _____

The applicant shall notify the local health department upon submittal of this application if any of the following apply to the property in question. If the answer is "yes", applicant **MUST ATTACH SUPPORTING DOCUMENTATION**:

- YES NO Does the site contain any Jurisdictional Wetlands?
 YES NO Do you plan to have an irrigation system now or in the future?
 YES NO Does or will the building contain any drains? Please explain. _____
 YES NO Are there any existing wells, springs, waterlines or Wastewater Systems on this property?
 YES NO Is any wastewater going to be generated on the site other than domestic sewage?
 YES NO Is the site subject to approval by any other Public Agency?
 YES NO Are there any Easements or Right of Ways on this property?
 YES NO Does the site contain any existing water, cable, phone or underground electric lines?

If yes please call No Cuts at 800-632-4949 to locate the lines. This is a free service.

I Have Read This Application And Certify That The Information Provided Herein Is True, Complete And Correct. Authorized County And State Officials Are Granted Right Of Entry To Conduct Necessary Inspections To Determine Compliance With Applicable Laws And Rules. I Understand That I Am Solely Responsible For The Proper Identification And Labeling Of All Property Lines And Corners And Making The Site Accessible So That A Complete Site Evaluation Can Be Performed.

NTE# 17-5-41923

Permit # 09599

Harnett County Department of Public Health Site Sketch

ISSUED TO: William & Joanne Winfrey PROPERTY LOCATION: Hayes Road (SR 2047)
SUBDIVISION _____ LOT # _____

Authorized State Agent: ~~Andrew Currin~~ Date: 08/11/2017
ANDREW CURRIN

SITE PLAN APPROVAL
DISTRICT RA-20R USE SFD
FEEDHOOPS 4
11/29/18
ZJ
 zoning Administrator

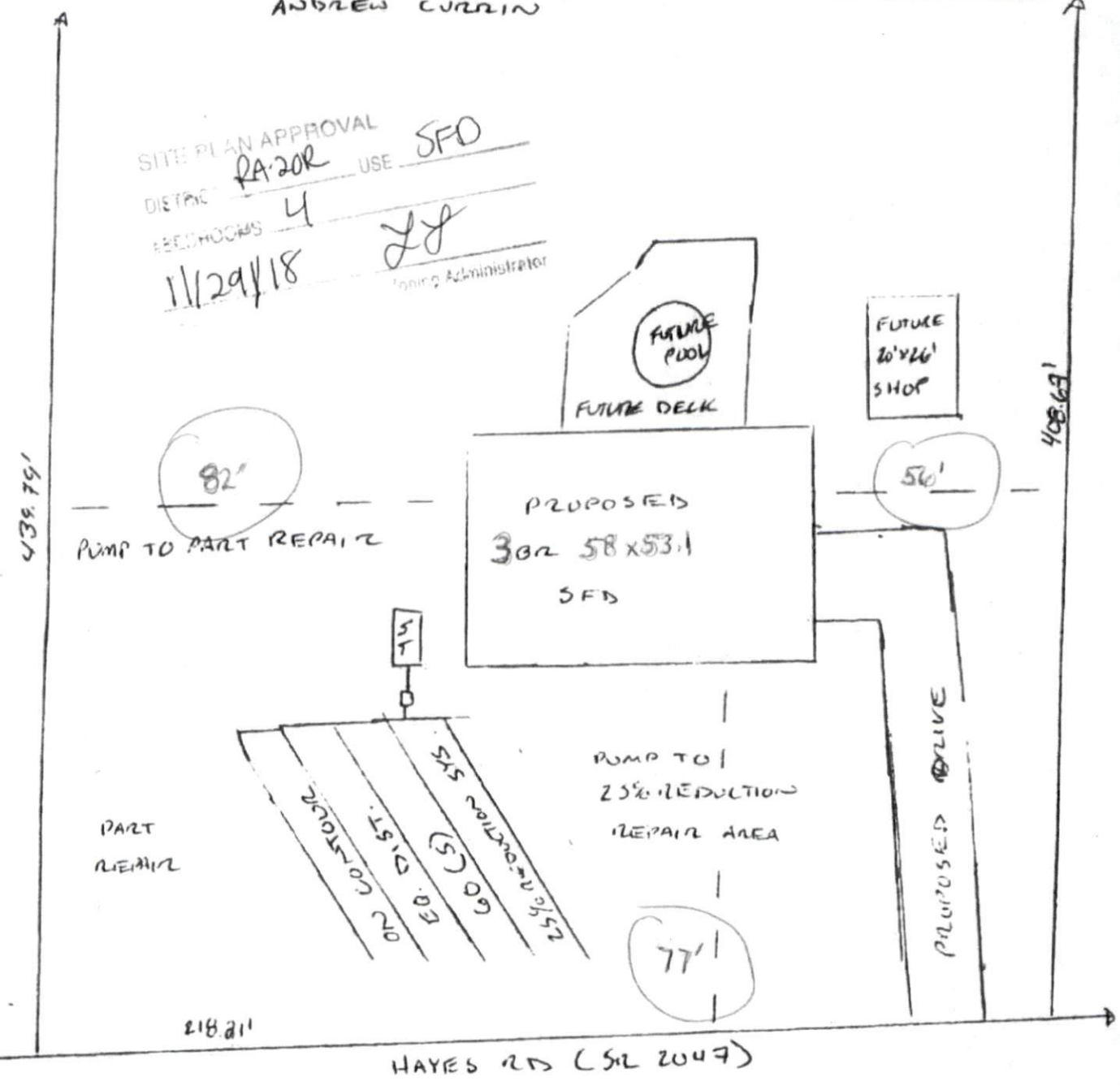

Application # _____

Harnett County Central Permitting
PO Box 65 Lillington, NC 27546
910-893-7626 Fax 910-893-2793 www.hamett.org/permits

* Each section below to be filled out by whomever performing work. Must be owner or licensed contractor. Address, company name & phone must match information on license.

Application for Residential Building and Trades Permit

Owner's Name: Mark ALLEN Date: 3/1/19
Site Address: 1332 HAYES RD Spring Lake NC 28390 Phone: 910 995 4246
Subdivision: N/A Lot: _____
Description of Proposed Work: Building PREFAB 24x26 Vehicle/Storage Bldg

General Contractor Information

K3G Storage INC 843 774 2150
Building Contractor's Company Name Telephone
1736 Hwy 301 South, Dillon SC 29536
Address Email Address
28666
License #

Electrical Contractor Information

Description of Work outlets / Lighting Service Size: _____ Amps T-Pole: Yes No
Mark ALLEN (Home/Land owner) 843 774 2150
Electrical Contractor's Company Name Telephone
Yorktown Rd Hope Mills NC 28348 mark.allen.86@yukoo.com
Address Email Address
N/A (Land owner)
License #

Mechanical/HVAC Contractor Information

Description of Work N/A
Mechanical Contractor's Company Name Telephone _____
Address Email Address _____
License # _____

Plumbing Contractor Information

Description of Work N/A # Baths _____
Plumbing Contractor's Company Name Telephone _____
Address Email Address _____
License # _____

Insulation Contractor Information

Insulation Contractor's Company Name & Address Telephone _____

***NOTE: General Contractor / owner must fill out and sign the second page of this application.**

I hereby certify that I have the authority to make necessary application, that the application is correct and that the construction will conform to the regulations in the Building, Electrical, Plumbing and Mechanical codes, and the Harnett County Zoning Ordinance. I state the information on the above contractors is correct as known to me and that by signing below I have obtained all subcontractors permission to obtain these permits and if any changes occur including listed contractors, site plan, number of bedrooms, building and trade plans, Environmental Health permit changes or proposed use changes, I certify it is my responsibility to notify the Harnett County Central Permitting Department of any and all changes.

EXPIRED PERMIT FEES - 6 Months to 2 years permit re-issue fee is \$150.00. After 2 years re-issue fee is as per current fee schedule.

Signature of Owner/Contractor/Officer(s) of Corporation

3/1/19
Date

Affidavit for Worker's Compensation N.C.G.S. 87-14

The undersigned applicant being the:

General Contractor Owner Officer/Agent of the Contractor or Owner

Do hereby confirm under penalties of perjury that the person(s), firm(s) or corporation(s) performing the work set forth in the permit:

Has three (3) or more employees and has obtained workers' compensation insurance to cover them.

Has one (1) or more subcontractors(s) and has obtained workers' compensation insurance to cover them.

Has one (1) or more subcontractors(s) who has their own policy of workers' compensation insurance covering themselves.

Has no more than two (2) employees and no subcontractors.

While working on the project for which this permit is sought it is understood that the Central Permitting Department issuing the permit may require certificates of coverage of worker's compensation insurance prior to issuance of the permit and at any time during the permitted work from any person, firm or corporation carrying out the work.

Sign w/Title: 

Date: 3/1/19