

HARNETT DEPARTMENT OF PUBLIC HEALTH PERMIT
TO CONSTRUCT A DRINKING WATER SUPPLY WELL

PIN #: 9563-76-7852.000 Parcel #: 099575 0029 Application #: BRES1903-0001 Subdivision: Imperial Rchette Lot #: 22

Applicant Name: Taylor Ray Lester
Address: 128 Rice Road Vass, NC 28394

Type of Facility Served by Well: DWMH

Sewage System: Conventional / 25% Reduction

Permit Conditions: Location: 396 N Forsythe Ln. - Marks Road (SR 1111)

General Permit Conditions:

- Drinking water supply well construction must meet 15A NCAC 02C.100 rules
- The permitted drinking water supply well shall be located in accordance with the **SITE PLAN**
- **ANY ALTERATION** of the site of the site (including location of structures and appurtenance) or modification in use of the well, may subject this Permit to revocation

Authorized State Agent [Signature] Date 03/13/2019

Grouting Inspection Witnessed _____ Date _____
 Grouting self-certified by driller GW-1 provided? Yes No

See attachment for construction sketch

WELL CERTIFICATE OF COMPLETION

Date: _____ Application #: BRES1903-0001 Well Contractor: _____

Applicant Name: Taylor Ray Lester
Address: 128 Rice Road Vass, NC 28394
Directions to Site: 396 N Forsythe Ln. - Marks Road (SR 1111)

Use of Well: _____ Date Drilled: _____ Total Depth: _____ Replacement Well? Yes No
Static Water Level: _____ Top of Casing is _____ in. above surface. Yield: _____ gpm at _____ ft.
Disinfection: Type _____ Amount _____

<u>Water Zone (depth)</u>	<u>Casing</u>	<u>Grout</u>
From _____ To _____	From _____ To _____	From 0 To _____
From _____ To _____	Diameter: _____ Material: _____ Thickness: _____	Material: _____ Method: _____
From _____ To _____	From _____ To _____	From _____ To _____
	Diameter: _____ Material: _____ Thickness: _____	Material: _____ Method: _____
	From _____ To _____	From _____ To _____
	Diameter: _____ Material: _____ Thickness: _____	Material: _____ Method: _____

Inspector: _____ On Hold Date: _____ Release Date: _____

Remarks: _____

Well Head Information

Casing Height: _____ (above finished grade) Access Port: _____ Vent Stack: _____
Well ID Tag: _____ Pump ID Tag: _____ Sampling Tap: _____ Backflow Preventer: _____
Sample Taken? Yes No Well Head properly sealed: _____

Remarks: _____

Authorized State Agent _____ Date _____

Application #: 02E51903-0001

Applicant Name: Taylor Leskes Subdivision: Imperial
Nantkette

Lot #: 2A

Well Construction Sketch

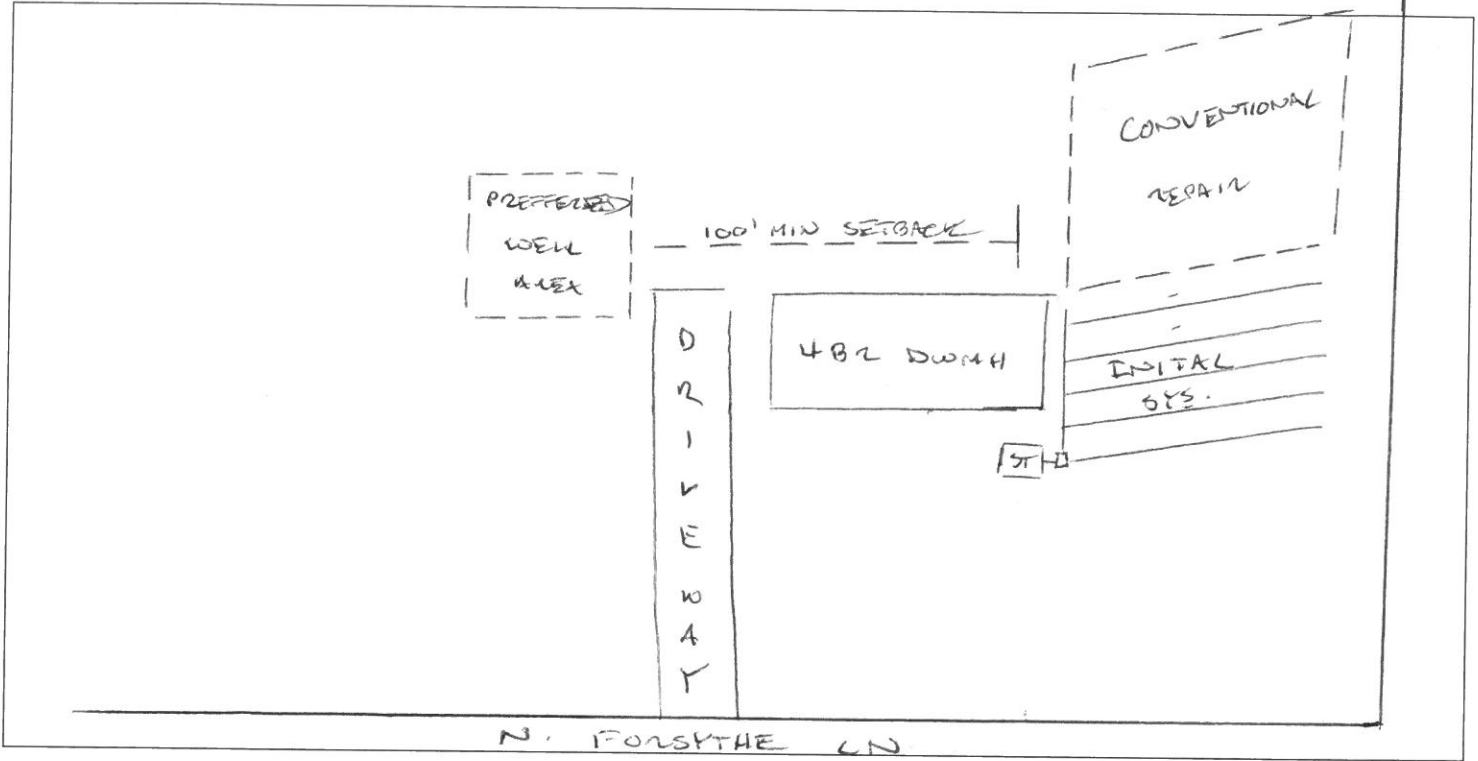

Well Completion Sketch

