

Received 01115119

Application # BRES1901-0023

Harnett County Central Permitting

PO Box 65 Lillington, NC 27546

Telephone Number: 910-893-7525 Fax 910-893-2783 www.harnett.org/permits

Application for Manufactured Home Set-Up Permit

(Please fill out each part completely)

Part I - Owner Information:

Home Owner Information (To be completed by owner of the manufactured home)

Name: Connie Richardson Address: 141 Valley Road

City: Spring Lake State: NC Zip: 28390 Daytime Phone: (910) 284-0391

Landowner Information (To be completed by landowner, if different than above)

Name: _____ Address: _____

City: _____ State: _____ Zip: _____ Daytime Phone: () _____

Part II - Contractor Information (To be completed by Contractors or Homeowner, if applicable.)

Name, address, & phone must match information on license)

A. **Set-Up Contractor Company Name:** State MH Movers

Phone: 919-422-8623 Address: 485 H Aquilla Road

City: Benson State: NC Zip: 27504

State Lic# 2859 Email: _____

B. **Electrical Contractor Company Name:** Mabry Electric Service Inc.

Phone: 919-639-4837 Address: 737 Mabry Road

City: Angier State: NC Zip: 27501

State Lic# 15077 Email: _____

C. **Mechanical Contractor Company Name:** Spell Mechanical

Phone: 910-325-5976 Address: P.O. Box 93

City: Autryville State: NC Zip: 28318

State Lic# 10574 Email: _____

D. **Plumbing Contractor Company Name:** Priority Plumbing

Phone: 919-639-7200 Address: P.O. Box 254

City: Willow Spring State: NC Zip: 27592

State Lic# 18650P-1 Email: _____

Part III - Manufactured Home Information

Model Year: 2019 Size: 22x68 *Complete & follow zoning criteria sheet*

Park Name: _____ Lot Number: _____

I hereby certify that I have the authority to apply for this permit, that the application is correct including the contractor information and have obtained their permission to purchase these permits on their behalf, and that the construction or installation will conform to the applicable manufactured home set-up requirements, and the Harnett County Zoning Ordinance. I understand that if any item is incorrect or false information has been provided that this permit could be revoked.

Connie G. Richardson
Signature of Home Owner or Agent

1-14-19
Date

**Effective July 1, 2004, a County Tax Department Moving Permit must be provided before a Set Up Permit will be issued. It is purchased from the tax office of the county that the home is moved from. If the home is from a dealer, we need proof of year on the Form 500 and if available, the serial number.*

List of inspections and Egress requirements available upon request. Progress Energy customers must provide Premise Number.

SETUP

04/11

CLAYTON HOMES-DUNN
 2001 W CUMBERLAND
 STREET
 DUNN, NC 28334
 Monday - Thursday 9am - 6pm
 Friday 9am - 6pm
 Saturday 9am - 5pm
 Sunday: closed
 (919) 592-0103

<https://www.claytonhomes.com>

PRIDE number 7
 4 beds • 2 baths • 1904 sq.ft. • 28' width • 68' depth

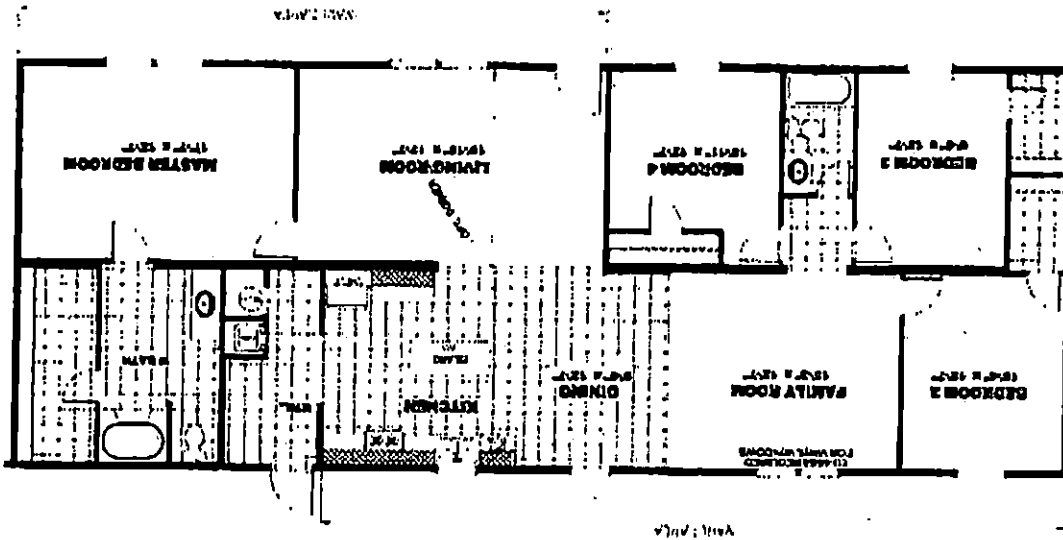

Size: 28 X 68

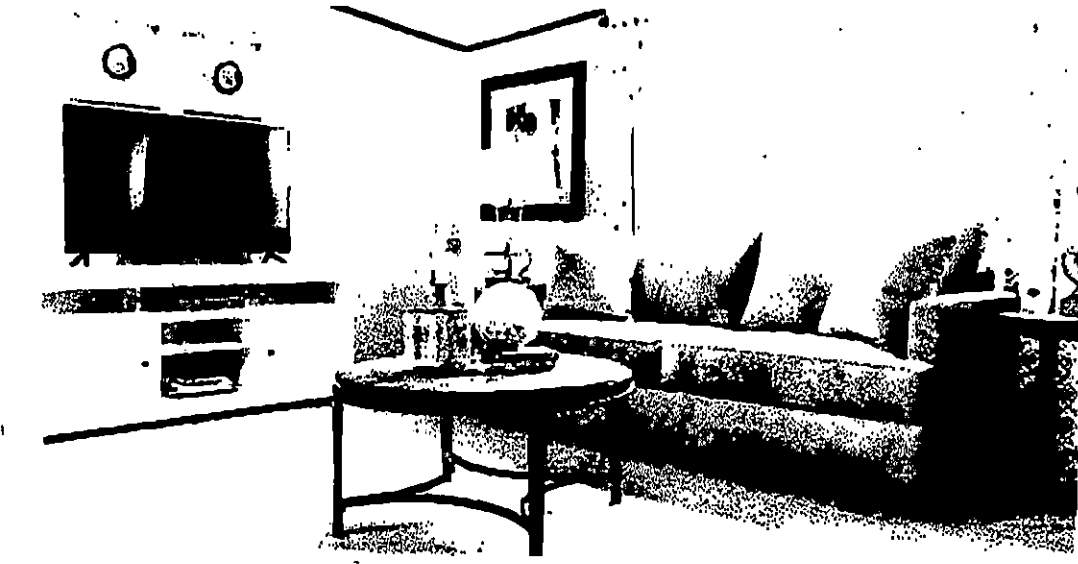

PRIDE
4 beds • 2 baths • 1904 sq.ft. • 28' width • 68' depth

CLAYTON HOMES DUNN
2001 W. CUMBERLAND STREET
DUNN, NC 28334
Monday - Thursday 9am - 6pm
Friday 9am - 6pm
Saturday 9am - 5pm
Sunday Closed
(810) 892-0100

CLAYTON HOMES DUNN
2001 W. CUMBERLAND STREET
DUNN, NC 28334
Monday - Thursday 9am - 6pm
Friday 9am - 6pm
Saturday 9am - 5pm
Sunday Closed
(810) 892-0100