

Improvement Permit

A building permit cannot be issued with only an Improvement Permit

ISSUED TO: Phyllis Byron
NEW [X] REPAIR [] EXPANSION []
Type of Structure: 3BR SWMH 15'x70'
Proposed Wastewater System Type: 25% reduction
Projected Daily Flow: 360 GPD
Number of bedrooms: 3 Number of Occupants: 6 max
Basement [] Yes [X] No
Pump Required: [] Yes [X] No
Type of Water Supply: [] Community [X] Public [] Well
Permit conditions:
Permit valid for: [X] Five years [] No expiration

Authorized State Agent: [Signature] Date: 01/22/2019 SEE ATTACHED SITE SKETCH
The issuance of this permit by the Health Department in no way guarantees the issuance of other permits. The permit holder is responsible for checking with appropriate governing bodies in meeting their requirements. This site is subject to revocation if the site plan, plat, or the intended use changes. The Improvement Permit shall not be affected by a change in ownership of the site. This permit is subject to compliance with the provisions of the Laws and Rules for Sewage Treatment and Disposal and to conditions of this permit.

Construction Authorization

(Required for Building Permit)

The construction and installation requirements of Rules .1950, .1952, .1954, .1955, .1956, .1957, .1958, and .1959 are incorporated by references into this permit and shall be met. Systems shall be installed in accordance with the attached system layout.

ISSUED TO: Phyllis Byron
PROPERTY LOCATION: 406 Tom Myers Rd. (522160)
SUBDIVISION _____ LOT # 3
Facility Type: 3BR SWMH 15'x70' [X] New [] Expansion [] Repair
Basement? [] Yes [X] No Basement Fixtures? [] Yes [] No
Type of Wastewater System: 25% reduction system (Initial) Wastewater Flow: 360 GPD
(See note below, if applicable [])
Installation Requirements/Conditions:
Septic Tank Size 1000 gallons
Pump Tank Size _____ gallons
Number of trenches 1
Exact length of each trench 160 feet
Trenches shall be installed on contour at a
Maximum Trench Depth of: 24 inches
(Trench bottoms shall be level to +/-1/4"
in all directions)
Trench Spacing: 9 Feet on Center
Soil Cover: 12 inches
(Maximum soil cover shall not exceed
36" above the trench bottom)
Pump Requirements: _____ ft. TDH vs. _____ GPM
Aggregate Depth: NA inches below pipe
NA inches above pipe
NA inches total
Conditions: Deep (24IN) to shallow (18IN) install
may be required

WATER LINES (INCLUDING IRRIGATION) MUST BE 10FT. FROM ANY PART OF SEPTIC SYSTEM OR REPAIR AREA.
NO UTILITIES ALLOWED IN INITIAL OR REPAIR DRAIN FIELD AREA.

**If applicable: I understand the system type specified is different from the type specified on the application. I accept the specifications of this permit.

Owner/Legal Representative Signature: _____ Date: _____

This Construction Authorization is subject to revocation if the site plan, plat, or the intended use changes. The Construction Authorization shall not be transferred when there is a change in ownership of the site. This Construction Authorization is subject to compliance with the provisions of the Laws and Rules for Sewage Treatment and Disposal and to the conditions of this permit. SEE ATTACHED SITE SKETCH

Authorized State Agent: [Signature] Date: 01/22/2019
ANDREW CURRIN Construction Authorization Expiration Date: 01/22/2024

HTE# BRES1901-0016

Permit # 30344

Harnett County Department of Public Health Site Sketch

ISSUED TO: Phyllis Byron PROPERTY LOCATOR: 406 Tom Myers Rd. (SR 2160)
SUBDIVISION _____ LOT # 3

Authorized State Agent: [Signature] Date: 01/22/2019
ANDREW CURRAN

* DEEP (24IN) TO SHALLOW (18IN) INSTALL
MAY BE REQUIRED

* 160FT SERIAL DISTRIBUTION
OR TWO (2) 80FT EQUAL
DISTRIBUTION LINES w/ D-BOX
AND STEPDOWN

TO TOM
MYERS RD
(SR 2160)

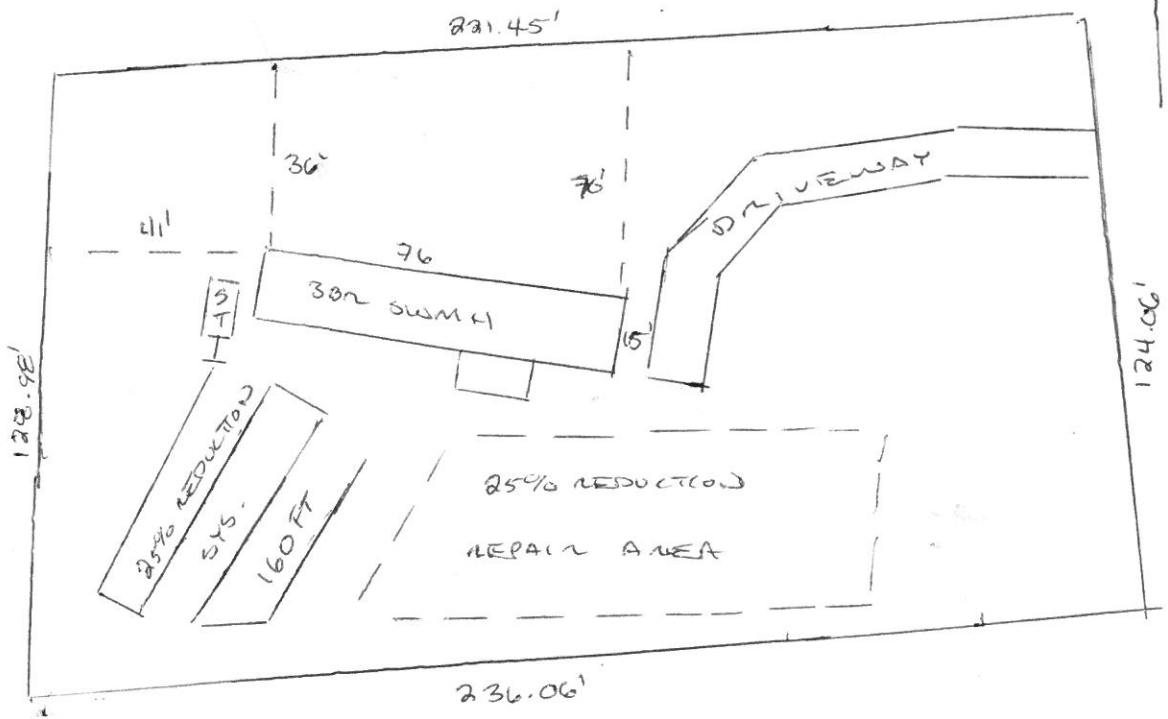

* REAR DECK/PORCH SHALL BE MARKED OR INSTALLED
AT SEPTIC INSTALL [5 FT SETBACK]