

# OPERATIONS PERMIT

Name: (owner) DARRELL + Adria G Milton  New Installation  Septic Tank  
 Property Location: SR# 1516 Sheriff John  Repairs  Nitrification Line  
 Subdivision \_\_\_\_\_ Lot # \_\_\_\_\_  
 TAX ID# \_\_\_\_\_ Quadrant # \_\_\_\_\_  
 Contractor: BATES STRICKLAND Registration # \_\_\_\_\_

Basement with Plumbing:  Garage:   
 Water Supply:  Well  Public  Community  
 Distance From Well: 50' ft.

Following are the specifications for the sewage disposal system on above captioned property.

Type of system:  Conventional  Other \_\_\_\_\_

Size of tank: Septic Tank: 1000 gallons Pump Tank: \_\_\_\_\_ gallons

Subsurface Drainage Field No. of ditches 3 exact length of each ditch 115 ft. width of ditches 3 ft. depth of ditches 18 2/3 in.

French Drain: \_\_\_\_\_ Linear feet

Date: 1-3-01

PERMIT NO. 13531

Inspected by: James E Mahant RWS.  
Environmental Health Specialist

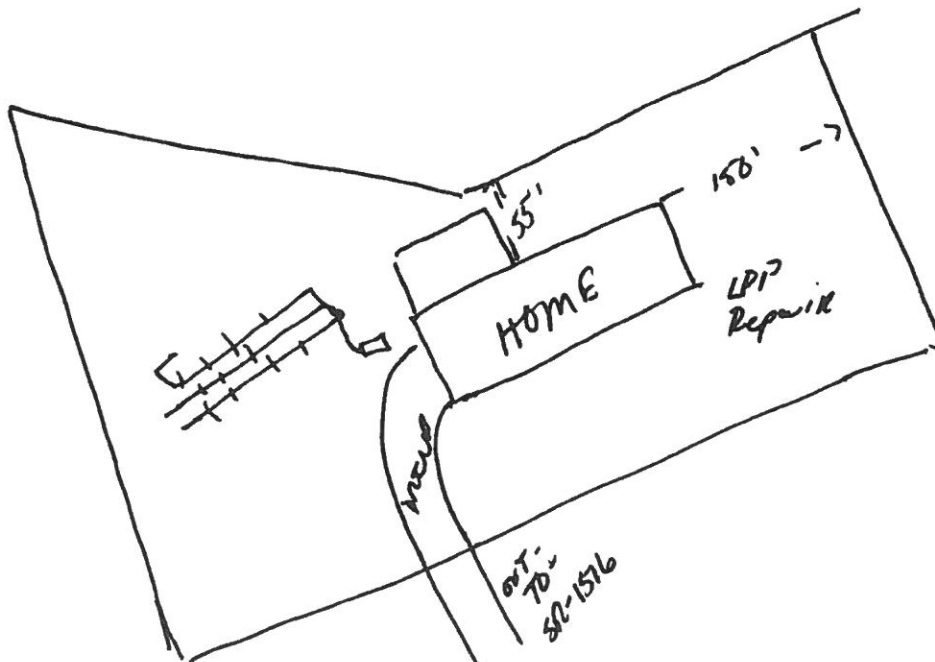

# HARNETT COUNTY HEALTH DEPARTMENT IMPROVEMENT PERMIT

No 13531

Be it ordained by the Harnett County Board of Health as follows: Section III, Item B. "No Person shall begin construction of any building at which a septic tank system is to be used for disposal of sewage without first obtaining a written permit from the Harnett County Health Department."

Name: (owner) DARRELL V + ADRIAN G MITTON       New Installation       Septic Tank  
 Property Location: SR# 1516 OLD COATS ROAD       Repairs       Nitrification Line  
Sheriff Johnson

Subdivision \_\_\_\_\_ Tax ID # \_\_\_\_\_ Lot # \_\_\_\_\_

Number of Bedrooms Proposed: 4      Quadrant # \_\_\_\_\_  
 Lot Size: 3.00 acres

Basement with Plumbing:       Garage:   
 Water Supply:  Well       Public       Community

Distance From Well: 50' ft.

Following is the minimum specifications for sewage disposal system on above captioned property. Subject to final approval.

Type of system:  Conventional       Other \_\_\_\_\_  
 Size of tank: Septic Tank: 1000 gallons      Pump Tank: \_\_\_\_\_ gallons

Subsurface Drainage Field: No. of ditches 3      exact length of each ditch 115 ft.      width of ditches 3 ft.      depth of ditches 18-20 in.  
 French Drain Required: \_\_\_\_\_ Linear feet

**This permit is subject to revocation if site plans or intended use change.**

Date: 7-8-99  
 Signed: James E. Markant, Esq.  
 Environmental Health Specialist

\* old well to be properly abandoned!

\* Maintain all setbacks!  
 \* CONTRACTOR TO MEET ON SITE PRIOR TO INSTALLATION!

