

TRAILER FOOTING PLAN
SCALE: 1"=60'

NOTES:

1. PER MINIMUM NORTH CAROLINA BUILDING CODE, FOOTINGS SHALL BE 4" BELOW FROST LINE.
2. STRAPS WILL BE 11'-0" OC W/ Xi2 SYSTEM PER HUD SPECIFICATIONS. CRISS CROSS EACH END.
3. 16"X16" MORTAR BLOCK CMU @ 6' OC SPACING.
4. 20"X20"X8" FOOTING
5. HORIZONTAL ANCHORAGE = Ah - TRANSVERSE DIRECTION: 960 LBS/FT STRAPING TO CONCRETE IN PLACE ANCHOR.
6. HORIZONTAL ANCHORAGE Ah - LONGITUDINAL DIRECTION: 26 LBS/FT STRAPING TO CONCRETE IN PLACE ANCHOR.

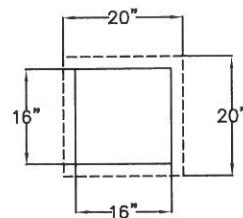

FOOTING/MORTAR BLOCK DETAIL

SCALE: 1"=20'

FOOTING = 20" X 20" X 8"
MORTAR BLOCK = 16"X16"

GRAPHIC SCALE



(IN FEET)
1 inch = 60 ft.

Enoch Engineers, P.A.
CONSULTING ENGINEERS & SURVEYORS
1403 NC Highway 50 South - Benson, NC 27504
Phone: (919) 894-7765 Fax: (919) 894-8190
E-mail: general@enochengineers.com
N.C. Firm License #C-2061

DESIGNED BY: BH	HORIZONTAL SCALE: AS NOTED
DRAWN BY: CC	VERTICAL SCALE: AS NOTED
CHECKED BY: JEG	DATE CREATED: 11/21/2018
REVISIONS:	

LOCATION: 216 BYRD RD BUNNLEVEL, NC 28323	OWNER: MELISSA SPRUILL & LAURA JONES 214 BYRD RD BUNNLEVEL, NC 28323
---	---

FOOTING LAYOUT
ASHLEY JONES RESI.

EE PROJECT: 4933

S-1

SHEET 1 OF 1

NOTE: This document, in physical or electronic form, discloses subject matter considered confidential to ENOCH ENGINEERS, P.A. and in which ENOCH ENGINEERS, P.A. has exclusive property rights. Neither receipt nor possession thereof confers or transfers any rights to reproduce this document or any part thereof, or to disclose any information contained therein to others, or to use it for any purpose without the written permission of ENOCH ENGINEERS, P.A.