



Initial Application Date: 10.10.18

Application # BRES1810.0038

CU# _____

COUNTY OF HARNETT RESIDENTIAL LAND USE APPLICATION
Central Permitting 108 E. Front Street, Lillington, NC 27546 Phone: (910) 893-7525 ext:2 Fax: (910) 893-2793 www.harnett.org/permits

****A RECORDED SURVEY MAP, RECORDED DEED (OR OFFER TO PURCHASE) & SITE PLAN ARE REQUIRED WHEN SUBMITTING A LAND USE APPLICATION****

LANDOWNER: MARY PAT HUGHES Mailing Address: 5404 SIRIUS DRIVE #202
City: WILMINGTON State: NC Zip: 28405 Contact No: 919 749 5578 Email: mp@marypathughes.com

APPLICANT*: _____ Mailing Address: _____

City: _____ State: _____ Zip: _____ Contact No: _____ Email: _____

*Please fill out applicant information if different than landowner

CONTACT NAME APPLYING IN OFFICE: _____ Phone # _____

ADDRESS: _____ PIN: 0651-97-8554

DEED OR OTP: 3499/0520

PROPOSED USE:

SFD: (Size _____ x _____) # Bedrooms: _____ # Baths: _____ Basement (w/wo bath): Garage: Deck: Crawl Space: Slab: Monolithic Slab:
(Is the bonus room finished? yes no w/a closet? yes no (if yes add in with # bedrooms).

Mod: (Size _____ x _____) # Bedrooms _____ # Baths _____ Basement (w/wo bath) Garage: Site Built Deck: On Frame Off Frame
(Is the second floor finished? yes no Any other site built additions? yes no

Manufactured Home: SW DW TW (Size 28 x 48) # Bedrooms: 3 Garage: site built? Deck: site built?
front porch 20x6 future.

Duplex: (Size _____ x _____) No. Buildings: _____ No. Bedrooms Per Unit: _____

Home Occupation: # Rooms: _____ Use: _____ Hours of Operation: _____ #Employees: _____

Addition/Accessory/Other: (Size _____ x _____) Use: _____ Closets in addition? yes no

Water Supply: _____ County Existing Well _____ New Well (# of dwellings using well _____) *Must have operable water before final
(Need to Complete New Well Application at the same time as New Tank)

Sewage Supply: New Septic Tank _____ Expansion _____ Relocation _____ Existing Septic Tank _____ County Sewer
(Complete Environmental Health Checklist on other side of application if Septic)

Does owner of this tract of land, own land that contains a manufactured home within five hundred feet (500') of tract listed above? yes no

Does the property contain any easements whether underground or overhead yes no *DSL lines @ front of property*
Structures (existing or proposed): Single family dwellings: _____ Manufactured Homes: 1 Other (specify): proposed

If permits are granted I agree to conform to all ordinances and laws of the State of North Carolina regulating such work and the specifications of plans submitted. I hereby state that foregoing statements are accurate and correct to the best of my knowledge. Permit subject to revocation if false information is provided.

Mary Pat Hughes Signature of Owner or Owner's Agent Date 10-10-18

It is the owner/applicants responsibility to provide the county with any applicable information about the subject property, including but not limited to: boundary information, house location, underground or overhead easements, etc. The county or its employees are not responsible for any incorrect or missing information that is contained within these applications.

This application expires 6 months from the initial date if permits have not been issued*
APPLICATION CONTINUES ON BACK

strong roots • new growth

strong roots • new growth

This application expires 6 months from the initial date if permits have not been issued

This application to be filled out when applying for a septic system inspection.

County Health Department Application for Improvement Permit and/or Authorization to Construct

IF THE INFORMATION IN THIS APPLICATION IS FALSIFIED, CHANGED, OR THE SITE IS ALTERED, THEN THE IMPROVEMENT PERMIT OR AUTHORIZATION TO CONSTRUCT SHALL BECOME INVALID. The permit is valid for either 60 months or without expiration depending upon documentation submitted. (Complete site plan = 60 months; Complete plat = without expiration)

Environmental Health New Septic System

- All property irons must be made visible. Place "pink property flags" on each corner iron of lot. All property lines must be clearly flagged approximately every 50 feet between corners.
- Place "orange house corner flags" at each corner of the proposed structure. Also flag driveways, garages, decks, out buildings, swimming pools, etc. Place flags per site plan developed at/for Central Permitting.
- Place orange Environmental Health card in location that is easily viewed from road to assist in locating property.
- If property is thickly wooded, Environmental Health requires that you clean out the undergrowth to allow the soil evaluation to be performed. Inspectors should be able to walk freely around site. Do not grade property.
- All lots to be addressed within 10 business days after confirmation. \$25.00 return trip fee may be incurred for failure to uncover outlet lid, mark house corners and property lines, etc. once lot confirmed ready.

Environmental Health Existing Tank Inspections

- Follow above instructions for placing flags and card on property.
- Prepare for inspection by removing soil over outlet end of tank as diagram indicates, and lift lid straight up (if possible) and then put lid back in place. (Unless inspection is for a septic tank in a mobile home park)
- DO NOT LEAVE LIDS OFF OF SEPTIC TANK

[MORE INFORMATION MAY BE REQUIRED TO COMPLETE ANY INSPECTION]

SEPTIC

If applying for authorization to construct please indicate desired system type(s): can be ranked in order of preference, must choose one.

- Accepted Innovative Conventional Any
 Alternative Other UNKNOWN

The applicant shall notify the local health department upon submittal of this application if any of the following apply to the property in question. If the answer is "yes", applicant MUST ATTACH SUPPORTING DOCUMENTATION:

- YES NO Does the site contain any Jurisdictional Wetlands? UNKNOWN
- YES NO Do you plan to have an irrigation system now or in the future? NO
- YES NO Does or will the building contain any drains? Please explain. _____
- YES NO Are there any existing wells, springs, waterlines or Wastewater Systems on this property? NO
- YES NO Is any wastewater going to be generated on the site other than domestic sewage? NO
- YES NO Is the site subject to approval by any other Public Agency? NO
- YES NO Are there any Easements or Right of Ways on this property? Yes DSL line in road front ditch
- YES NO Does the site contain any existing water, cable, phone or underground electric lines? NO

If yes please call No Cuts at 800-632-4949 to locate the lines. This is a free service.

I Have Read This Application And Certify That The Information Provided Herein Is True, Complete And Correct. Authorized County And State Officials Are Granted Right Of Entry To Conduct Necessary Inspections To Determine Compliance With Applicable Laws And Rules. I Understand That I Am Solely Responsible For The Proper Identification And Labeling Of All Property Lines And Corners And Making The Site Accessible So That A Complete Site Evaluation Can Be Performed!

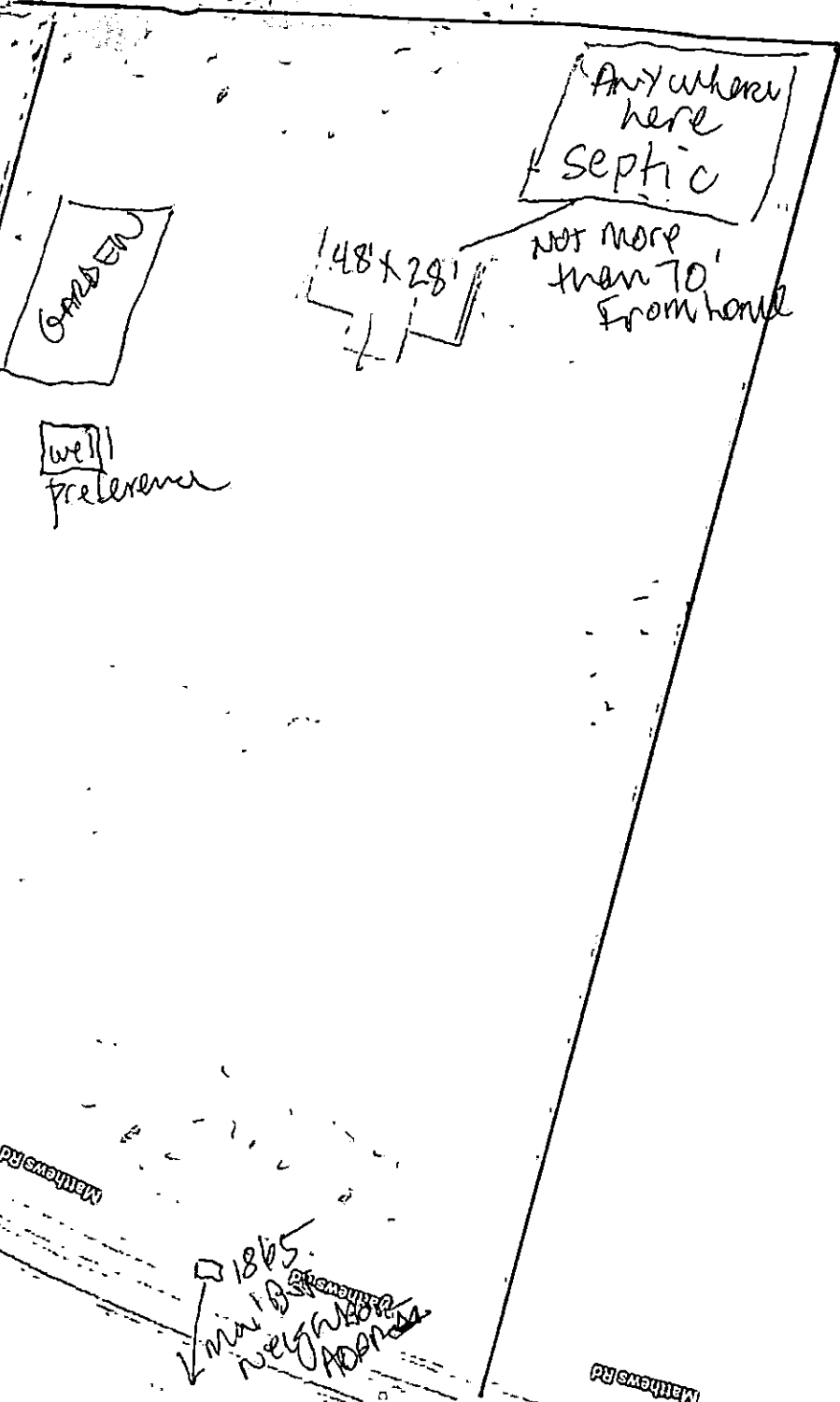

SITE PLAN APPROVAL

DISTRICT RA30 USE DWMA

#BEDROOMS 3

10.10.18 djowish
ADMINISTRATOR

Matthews Rd
No ADDRESS

1900's
box

1865
near 1865
neighborhood

PROCEDURES AND GUIDELINES FOR MANUFACTURED HOMES

RA-30 Criteria Certification

I, Mary Pat Hubert, landowner/agent of Parcel Identification Number 11-0051-0021-08 located in an RA-30 Zoning District, do hereby certify the following:

The multi-section manufactured home shall meet the following appearance standards, verified by zoning inspection approval, prior to the issuance of a Certificate of Occupancy:

1. The structure must be a multi-section unit built to the HUD code for manufactured homes.
2. When located on the site, the longest axis of the unit must be parallel to the lot frontage.
3. The structure must have a pitched roof that is covered with material commonly used in standard residential roofing construction. Said material must be installed properly and be consistent in appearance.
4. The structure must have masonry underpinning that is continuous, permanent and unpierced except for ventilation and access.
5. The exterior siding must consist predominantly of vinyl, aluminum, wood, or hardboard; and must be comparable in composition, appearance, and durability to the exterior siding commonly used in standard residential construction. Said exterior siding shall be in good condition, complete, and not damaged or loose.
6. The minimum lot size must be one (1) acre excluding any street right-of-way and the minimum lot frontage must be 150 feet as measured at the right-of-way line or along an easement whichever applies.
7. The tongue or towing device must be removed.

By signing this form, I acknowledge that I understand and agree to comply with each of the seven (7) appearance criteria listed above for the multi-section manufactured home I propose to place on the above referenced property. I further acknowledge that a Certificate of Occupancy (CO) entitling me to apply for electric service will not be issued until each appearance criteria has been met and approved.

Mary Pat Hubert
*Signature of Landowner/Agent

10/10/2018
Date

*By signing this form the owner/agent is stating that they have read and understand the information on this form