

Initial Application Date: 10/4/18

Application # BRES1810-0011

COUNTY OF HARNETT RESIDENTIAL LAND USE APPLICATION

CU# _____

Central Permitting 108 E. Front Street, Lillington, NC 27546 Phone: (910) 893-7525 ext:2 Fax: (910) 893-2793 www.harnett.org/permits

****A RECORDED SURVEY MAP, RECORDED DEED (OR OFFER TO PURCHASE) & SITE PLAN ARE REQUIRED WHEN SUBMITTING A LAND USE APPLICATION****

LANDOWNER: NEIL + MONA WATKINS Mailing Address: 78 CLYDE LANE
 City: CAMERON State: NC Zip: 28526 Contact No: 910-818-3426 Email: _____

APPLICANT: CHAPMAN-WILSON POOLS SPAS + HOME IMPROVEMENTS INC Mailing Address: 606 HOPE MILLS RD
 City: FAYETTEVILLE State: NC Zip: 28304 Contact No: 910-424-4663 Email: CHAPWILE406.COM

*Please fill out applicant information if different than landowner

CONTACT NAME APPLYING IN OFFICE: BARRY HOOKER Phone # 910-424-4663

ADDRESS: 606 HOPE MILLS RD JAY NC 28304 PIN: 9565-96-9110-000

DEED OR OTP: _____

PROPOSED USE:

SFD: (Size _____ x _____) # Bedrooms: _____ # Baths: _____ Basement (w/wo bath): Garage: Deck: Crawl Space: Slab: Monolithic Slab:
 (Is the bonus room finished? yes no w/ a closet? yes no (if yes add in with # bedrooms)

Mod: (Size _____ x _____) # Bedrooms _____ # Baths _____ Basement (w/wo bath) Garage: Site Built Deck: On Frame Off Frame
 (Is the second floor finished? yes no Any other site built additions? yes no

Manufactured Home: SW DW TW (Size _____ x _____) # Bedrooms: _____ Garage: (site built?) Deck: (site built?)

Duplex: (Size _____ x _____) No. Buildings: _____ No. Bedrooms Per Unit: _____

Home Occupation: # Rooms: _____ Use: _____ Hours of Operation: _____ #Employees: _____

Addition/Accessory/Other: (Size 14 x 16) Use: Covered Deck Closets in addition? yes no

Water Supply: County _____ Existing Well _____ New Well (# of dwellings using well _____) ***Must have operable water before final**
 (Need to Complete New Well Application at the same time as New Tank)

Sewage Supply: _____ New Septic Tank _____ Expansion _____ Relocation Existing Septic Tank _____ County Sewer
 (Complete Environmental Health Checklist on other side of application if Septic)

Does owner of this tract of land, own land that contains a manufactured home within five hundred feet (500') of tract listed above? yes no

Does the property contain any easements whether underground or overhead yes no

Structures (existing or proposed): Single family dwellings: Manufactured Homes: _____ Other (specify): _____

If permits are granted I agree to conform to all ordinances and laws of the State of North Carolina regulating such work and the specifications of plans submitted. I hereby state that foregoing statements are accurate and correct to the best of my knowledge. Permit subject to revocation if false information is provided.

Barry Hooker, AGENT
 Signature of Owner or Owner's Agent

10-4-2018
 Date

*****It is the owner/applicants responsibility to provide the county with any applicable information about the subject property, including but not limited to: boundary information, house location, underground or overhead easements, etc. The county or its employees are not responsible for any incorrect or missing information that is contained within these applications.*****

This application expires 6 months from the initial date if permits have not been issued*

APPLICATION CONTINUES ON BACK

****This application expires 6 months from the initial date if permits have not been issued****

This application to be filled out when applying for a septic system inspection.

County Health Department Application for Improvement Permit and/or Authorization to Construct

IF THE INFORMATION IN THIS APPLICATION IS FALSIFIED, CHANGED, OR THE SITE IS ALTERED, THEN THE IMPROVEMENT PERMIT OR AUTHORIZATION TO CONSTRUCT SHALL BECOME INVALID. The permit is valid for either 60 months or without expiration depending upon documentation submitted. (Complete site plan = 60 months; Complete plat = without expiration)

Environmental Health New Septic System

- **All property irons must be made visible.** Place "pink property flags" on each corner iron of lot. All property lines must be clearly flagged approximately every 50 feet between corners.
- Place "orange house corner flags" at each corner of the proposed structure. Also flag driveways, garages, decks, out buildings, swimming pools, etc. Place flags per site plan developed at/for Central Permitting.
- Place orange Environmental Health card in location that is easily viewed from road to assist in locating property.
- If property is thickly wooded, Environmental Health requires that you clean out the **undergrowth** to allow the soil evaluation to be performed. Inspectors should be able to walk freely around site. **Do not grade property.**
- **All lots to be addressed within 10 business days after confirmation. \$25.00 return trip fee may be incurred for failure to uncover outlet lid, mark house corners and property lines, etc. once lot confirmed ready.**

Environmental Health Existing Tank Inspections

- Follow above instructions for placing flags and card on property.
- Prepare for inspection by removing soil over **outlet end** of tank as diagram indicates, and lift lid straight up (*if possible*) and then **put lid back in place.** (Unless inspection is for a septic tank in a mobile home park)
- **DO NOT LEAVE LIDS OFF OF SEPTIC TANK**

"MORE INFORMATION MAY BE REQUIRED TO COMPLETE ANY INSPECTION"

SEPTIC

If applying for authorization to construct please indicate desired system type(s): can be ranked in order of preference, must choose one.

- Accepted Innovative Conventional Any
 Alternative Other _____

The applicant shall notify the local health department upon submittal of this application if any of the following apply to the property in question. If the answer is "yes", applicant **MUST ATTACH SUPPORTING DOCUMENTATION**:

- YES NO Does the site contain any Jurisdictional Wetlands?
- YES NO Do you plan to have an irrigation system now or in the future?
- YES NO Does or will the building contain any drains? Please explain. _____
- YES NO Are there any existing wells, springs, waterlines or Wastewater Systems on this property?
- YES NO Is any wastewater going to be generated on the site other than domestic sewage?
- YES NO Is the site subject to approval by any other Public Agency?
- YES NO Are there any Easements or Right of Ways on this property?
- YES NO Does the site contain any existing water, cable, phone or underground electric lines?
- If yes please call No Cuts at 800-632-4949 to locate the lines. This is a free service.

I Have Read This Application And Certify That The Information Provided Herein Is True, Complete And Correct. Authorized County And State Officials Are Granted Right Of Entry To Conduct Necessary Inspections To Determine Compliance With Applicable Laws And Rules. I Understand That I Am Solely Responsible For The Proper Identification And Labeling Of All Property Lines And Corners And Making The Site Accessible So That A Complete Site Evaluation Can Be Performed.

strong roots • new growth

78 CLYDE LANE, CAMERON N.C.

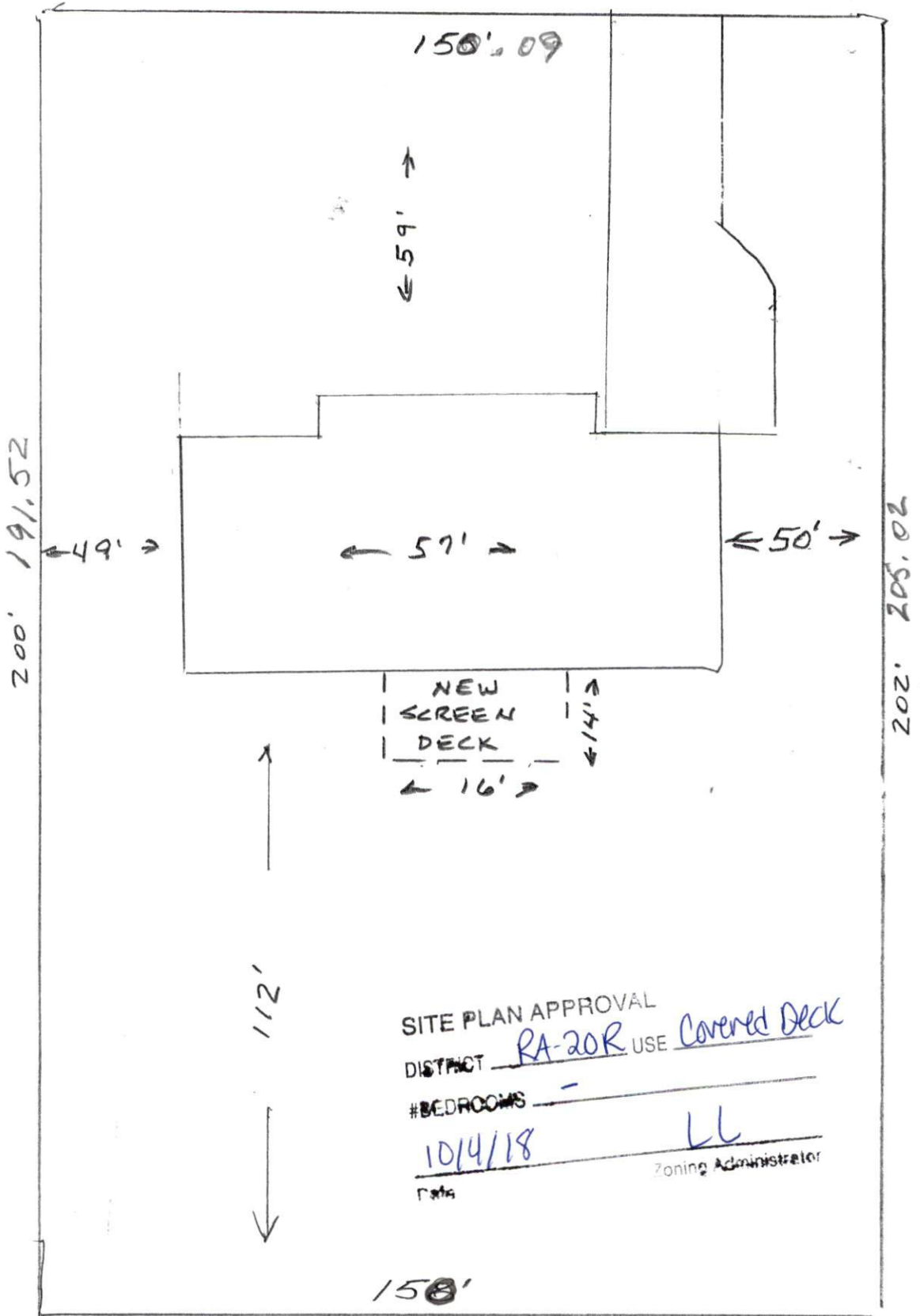

DO NOT REMOVE!

Details: Appointment of Lien Agent

Entry #: 923849

Filed on: 09/25/2018

Initially filed by: chapwil

Designated Lien Agent

Fidelity National Title Company, LLC

Online: www.liensnc.com <http://www.liensnc.com>

Address: 19 W. Hargett St., Suite 507 / Raleigh, NC 27601

Phone: 888-690-7384

Fax: 913-489-5231

Email: support@liensnc.com support@liensnc.com

Project Property

78 clyde lane
cameron, NC 28326
harnett County

Property Type

1-2 Family Dwelling

Print & Post



Contractors:

Please post this notice on the Job Site.

Suppliers and Subcontractors:

Scan this image with your smart phone to view this filing. You can then file a Notice to Lien Agent for this project.

Owner Information

Neil watkins
78 clyde lane
cameron, NC 28326
United States
Email: chapwil@aol.com
Phone: 910-424-4663

Date of First Furnishing

10/01/2018

View Comments (0)

Technical Support Hotline: (888) 690-7384