

 **Approved**
britton 10/10/2018

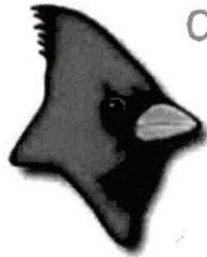

Carolina Carports, Inc.
Carports · Buildings · Garages

STRUCTURAL DESIGN

ENCLOSED BUILDING

**MAXIMUM 30'-0" WIDE X 20'-0" EAVE HEIGHT- BOX EAVE
FRAME AND BOW FRAME**

15 January 2018
Revision 7

M&A Project No. 15156S, 16135S & 17324S

AA4

HARNETT COUNTY CENTRAL PERMITTING
APPLICATION # BRES1810-0007
JOB NAME Hall
DATE PLANS RECEIVED 10/2/18
SITE PLANS APPROVED _____
APPROVED BY _____

Prepared for:

Carolina Carports, Inc.
187 Cardinal Ridge Trail
Dobson, NC 27017

Prepared by:

MAY 09 2018

Moore and Associates Engineering and Consulting, Inc.
1009 East Avenue
North Augusta, SC 29841

401 S. Main Street, Suite 200
Mount Airy, NC 27030

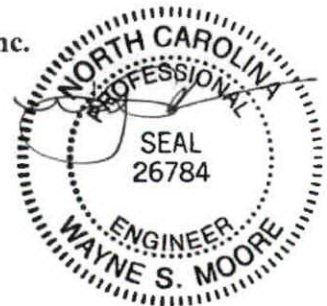

MOORE AND ASSOCIATES
ENGINEERING AND CONSULTING

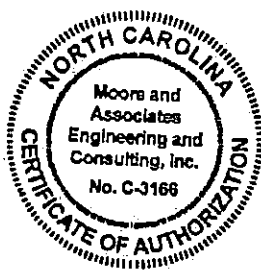
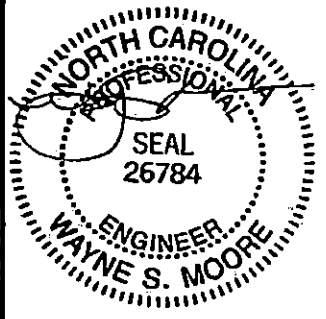
			MAY 0 9 2018
			

MOORE AND ASSOCIATES ENGINEERING AND CONSULTING, INC.	DRAWN BY: JRS	CAROLINA CARPORTS, INC. 187 CARDINAL RIDGE TRAIL DOBSON, NC 27017 30'x20' ENCLOSED STRUCTURE		
	CHECKED BY: PDH	PROJECT MGR: VSM	DATE: 1-15-18	SCALE: NTS
THIS DOCUMENT IS THE PROPERTY OF MOORE AND ASSOCIATES ENGINEERING AND CONSULTING. THE UNAUTHORIZED REPRODUCTION, COPYING, OR OTHERWISE USE OF THIS DOCUMENT IS STRICTLY PROHIBITED AND ANY INFRINGEMENT THEREUPON MAY BE SUBJECT TO LEGAL ACTION.	CLIENT: CAROLINA CARPORTS	SHT. 1	DWG. NO: SK-3	JOB NO: 131565 16139S 17324S REV. 7

DRAWING INDEX

SHEET 1	PE SEAL COVER SHEET
SHEET 1A	PE SEAL COVER SHEET
SHEET 2	DRAWING INDEX
SHEET 3A	INSTALLATION NOTES AND SPECIFICATIONS
SHEET 3B	TYPICAL SIDE AND END ELEVATIONS
SHEET 4	TYPICAL RAFTER/COLUMN END AND SIDE FRAMING SECTION (BOX EAVE RAFTER) EXPOSURE B
SHEET 4A	TYPICAL RAFTER/COLUMN END AND SIDE FRAMING SECTION (BOX EAVE RAFTER) EXPOSURE C
SHEET 4B	TYPICAL RAFTER/COLUMN END FRAMING SECTION (BOX EAVE RAFTER) DOUBLE COLUMN EXPOSURE B
SHEET 4C	TYPICAL RAFTER/COLUMN END FRAMING SECTION (BOX EAVE RAFTER) LACED DOUBLE LEG COLUMN EXPOSURE B
SHEET 4D	TYPICAL RAFTER/COLUMN END FRAMING SECTION (BOX EAVE RAFTER) LACED DOUBLE LEG COLUMN EXPOSURE C
SHEET 4E	TYPICAL SIDE FRAMING SECTION (BOX EAVE RAFTER) LACED DOUBLE LEG AND DOUBLE COLUMN OPTION
SHEET 5	COLUMN CONNECTION DETAILS (BOX EAVE STRUCTURE EXPOSURE B (140 MPH)
SHEET 5A	COLUMN CONNECTION DETAILS (BOX EAVE STRUCTURE EXPOSURE B (170 MPH)
SHEET 5B	COLUMN CONNECTION DETAILS (BOX EAVE STRUCTURE EXPOSURE C (140 MPH)
SHEET 5C	COLUMN CONNECTION DETAILS (BOX EAVE STRUCTURE EXPOSURE C (170 MPH)
SHEET 5D	COLUMN CONNECTION DETAILS (BOX EAVE STRUCTURE EXPOSURE B (140 MPH) LACED DOUBLE LEG AND DOUBLE COLUMN OPTION
SHEET 5E	COLUMN CONNECTION DETAILS (BOX EAVE STRUCTURE EXPOSURE B (170 MPH) LACED DOUBLE LEG AND DOUBLE COLUMN OPTION
SHEET 5F	COLUMN CONNECTION DETAILS (BOX EAVE STRUCTURE EXPOSURE C (140 MPH) LACED DOUBLE LEG AND DOUBLE COLUMN OPTION
SHEET 5G	COLUMN CONNECTION DETAILS (BOX EAVE STRUCTURE EXPOSURE C (170 MPH) LACED DOUBLE LEG AND DOUBLE COLUMN OPTION
SHEET 6	TYPICAL RAFTER/COLUMN END AND SIDE FRAMING SECTION (BOW RAFTER) EXPOSURE B
SHEET 6A	TYPICAL RAFTER/COLUMN END AND SIDE FRAMING SECTION (BOW RAFTER) EXPOSURE C
SHEET 7	COLUMN CONNECTION DETAILS (BOW RAFTER STRUCTURE EXPOSURE B 140 MPH)
SHEET 7A	COLUMN CONNECTION DETAILS (BOW RAFTER STRUCTURE EXPOSURE B 170 MPH)
SHEET 7B	COLUMN CONNECTION DETAILS (BOW RAFTER STRUCTURE EXPOSURE C 140 MPH)
SHEET 7C	COLUMN CONNECTION DETAILS (BOW RAFTER STRUCTURE EXPOSURE C 170 MPH)
SHEET 8	BASE RAIL ANCHORAGE OPTIONS
SHEET 9	TYPICAL END WALL AND SIDE WALL FRAMING SECTIONS (BOX EAVE)
SHEET 11	TYPICAL END WALL AND SIDE WALL FRAMING SECTIONS (BOW RAFTER)
SHEET 11	WALL OPENING DETAILS
SHEET 12	WALL OPENING DETAILS
SHEET 13	LEAN-TO OPTIONS (BOX EAVE RAFTER)
SHEET 14	LEAN-TO OPTIONS (BOW RAFTER)
SHEET 15	VERTICAL ROOF/SIDING OPTION END AND SIDE ELEVATION AND SECTION
SHEET 16	BASE RAIL ON GRADE APPLICATION
SHEET 17	OPTIONAL BASE RAIL ON TIMBER BEAM
SHEET 18	OPTIONAL BASE RAIL ON TIMBER BEAM WITH SOIL NAIL
SHEET 19	OPTIONAL CONCRETE STRIP FOOTING
SHEET 20	OPTIONAL HEADER

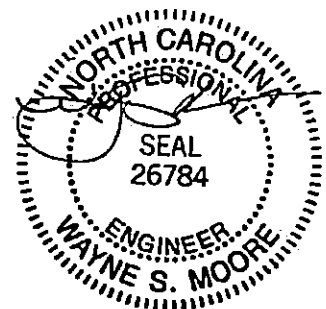

MAY 09 2018

MOORE AND ASSOCIATES ENGINEERING AND CONSULTING, INC.	DRAWN BY: JRS	CAROLINA CARPORTS, INC. 187 CARDINAL RIDGE TRAIL DOBSON, NC 27017 30'x20' ENCLOSED STRUCTURE		
	CHECKED BY: PJH	PROJECT MGR: WSH	DATE: 1-15-18	SCALE: NTS
THIS DOCUMENT IS THE PROPERTY OF MOORE AND ASSOCIATES ENGINEERING AND CONSULTING. THE UNAUTHORIZED REPRODUCTION, COPYING, OR OTHERWISE USE OF THIS DOCUMENT IS STRICTLY PROHIBITED AND ANY INFRINGEMENT THEREUPON MAY BE SUBJECT TO LEGAL ACTION.	CLIENT: CAROLINA CARPORTS	SHT. 2	DWG. NO: SK-3	JOB NO: 151563 161355 17324S REV: 7

INSTALLATION NOTES AND SPECIFICATIONS

- 1 DESIGN IS FOR MAXIMUM 30'-0" WIDE x 20'-0" EAVE HEIGHT ENCLOSED STRUCTURES
- 2 DESIGN WAS DONE IN ACCORDANCE WITH THE 2017 FLORIDA BUILDING CODE (FBC) 6TH EDITION, 2012 NORTH CAROLINA BUILDING CODE, 2006 INTERNATIONAL BUILDING CODE (IBC) 2009 IBC 2012 IBC AND 2015 IBC
- 3 DESIGN LOADS ARE AS FOLLOWS
 - A) DEAD LOAD = 15 PSF
 - B) LIVE LOAD = 12 PSF
 - C) GROUND SNOW LOAD = 30 PSF ($\leq 24'$), 35 PSF ($24' < W \leq 30'$), 35 PSF @ 4'-0" OC SPACING ($\leq 24'$)
(MAXIMUM 45 PSF FOR EXPOSURE B AND 55 PSF FOR EXPOSURE C AT 4'-0" OC SPACING)
- 4 LOW ULTIMATE WIND SPEED (LW) 105 TO 140 MPH (NOMINAL WIND SPEED 81 TO 108 MPH) MAXIMUM RAFTER/POST AND END POST SPACING = 50 FEET
- 5 HIGH ULTIMATE WIND SPEED (HW) 141 TO 170 MPH (NOMINAL WIND SPEED 109 TO 132 MPH) MAXIMUM RAFTER/POST AND END POST SPACING = 40 FEET
- 6 RISK CATEGORY I
- 7 WIND EXPOSURE CATEGORY B OR C
- 8 SPECIFICATIONS APPLICABLE TO 29 GAUGE METAL PANELS FASTENED DIRECTLY TO 2 1/2" x 2 1/2" - 14 GAGE TUBE STEEL (TS) FRAMING MEMBERS (UNLESS NOTED OTHERWISE)
- 9 AVERAGE FASTENER SPACING ON-CENTERS ALONG RAFTERS OR HAT CHANNELS AND COLUMNS (INTERIOR OR END) = 8" OC (MAX) 6" OC (MAX) FOR HIGH WIND APPLICATIONS
- 10 FASTENERS CONSIST OF #12-14x3/4" SELF-DRILLING FASTENER (SDF) USE CONTROL SEAL WASHER WITH EXTERIOR FASTENERS SPECIFICATIONS APPLICABLE ONLY FOR MEAN ROOF HEIGHT OF 20 FEET OR LESS AND ROOF SLOPES OF 14' (3:12 PITCH) OR LESS SPACING REQUIREMENTS FOR OTHER ROOF HEIGHTS AND/OR SLOPES MAY VARY
- 11 ANCHORS SHALL BE INSTALLED THROUGH BASE RAIL WITHIN 6" OF EACH RAFTER COLUMN ALONG SIDES
- 12 GROUND ANCHORS (SOIL NAILS) CONSIST OF #4 REBAR W/ WELDED NUT x 30" LONG IN SUITABLE SOIL CONDITIONS OPTIONAL ANCHORAGE MAY BE USED IN SUITABLE SOILS AND MUST BE USED IN UNSUITABLE SOILS AS NOTED NOT ALLOWED FOR HIGH WIND APPLICATION
- 13 WIND FORCES GOVERN OVER SEISMIC FORCES SEISMIC PARAMETERS ANALYZED ARE
 SOIL SITE CLASS = I
 RISK CATEGORY I/II/III
 $R = 325$ $I_g = 1.0$
 $S_{IS} = 1.522$ $V = C_s W$
 $S_{II} = 0.639$

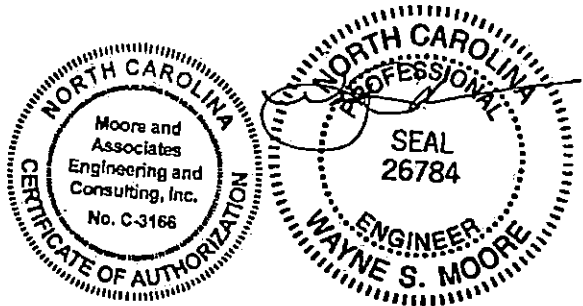

MAY 09 2018

MOORE AND ASSOCIATES ENGINEERING AND CONSULTING, INC.	DRAWN BY: JRS	CAROLINA CARPORTS, INC. 187 CARDINAL RIDGE TRAIL DOBSON, NC 27017 30'x20' ENCLOSED STRUCTURE		
	CHECKED BY: PDH	DATE: 1-15-18	SCALE: NTS	JOB NO: 15156S 16135S 17324S
THIS DOCUMENT IS THE PROPERTY OF MOORE AND ASSOCIATES ENGINEERING AND CONSULTING. THE UNAUTHORIZED REPRODUCTION, COPYING, OR OTHERWISE USE OF THIS DOCUMENT IS STRICTLY PROHIBITED AND ANY INFRINGEMENT THEREUPON MAY BE SUBJECT TO LEGAL ACTION.	PROJECT MGR: VSM	CLIENT: CAROLINA CARPORTS	SHT. 3A	DWG. NO: SK-3 REV. 7

BOX EAVE FRAME RAFTER STRUCTURE (Sheets 4, 4A, 4B, 4C, 4D, 4E, 5, 5A, 5B, 5C, 5D, 5E, 5F, 5G, 8, 9, 11, 12, 13, AND 15)

WINDOW (AS APPLICABLE)
 DESIGN PRESSURE
 LOW = (26.38 PSF, -35.21 PSF)
 HIGH = (39.75 PSF, -49.55 PSF)

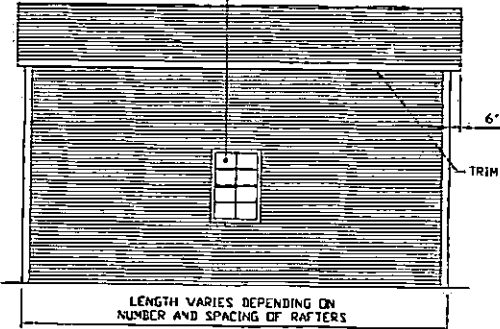

TYPICAL SIDE ELEVATION-HORIZONTAL ROOF
 SCALE: NTS

ROLL-UP DOOR
 (AS APPLICABLE)
 DESIGN PRESSURE
 LOW = (22.39 PSF, -24.68 PSF)
 HIGH = (23.82 PSF, -37.15 PSF)

SWINGING DOOR
 (AS APPLICABLE)
 DESIGN PRESSURE
 LOW = (25.17 PSF, -27.35 PSF)
 HIGH = (37.93 PSF, -41.32 PSF)

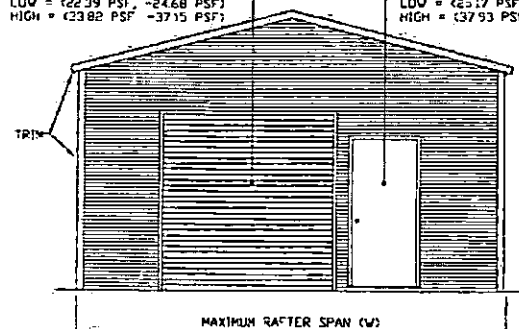

TYPICAL END ELEVATION-HORIZONTAL ROOF
 SCALE: NTS

BOX FRAME RAFTER STRUCTURE (Sheets 6, 6A, 7, 7A, 7B, 7C, 8, 10, 11, 12, AND 14)

WINDOW (AS APPLICABLE)
 DESIGN PRESSURE
 LOW = (26.38 PSF, -35.21 PSF)
 HIGH = (39.75 PSF, -49.55 PSF)

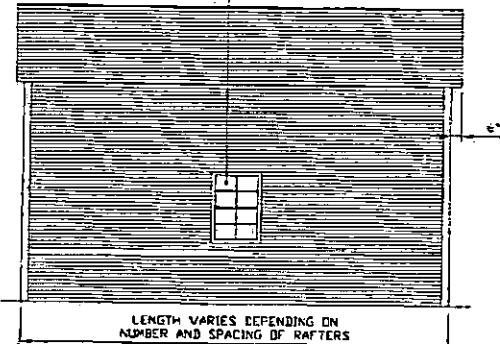

TYPICAL SIDE ELEVATION
 SCALE: NTS

ROLL-UP DOOR
 (AS APPLICABLE)
 DESIGN PRESSURE
 LOW = (22.39 PSF, -24.66 PSF)
 HIGH = (23.82 PSF, -37.15 PSF)

SWINGING DOOR
 (AS APPLICABLE)
 DESIGN PRESSURE
 LOW = (25.17 PSF, -27.35 PSF)
 HIGH = (37.93 PSF, -41.32 PSF)

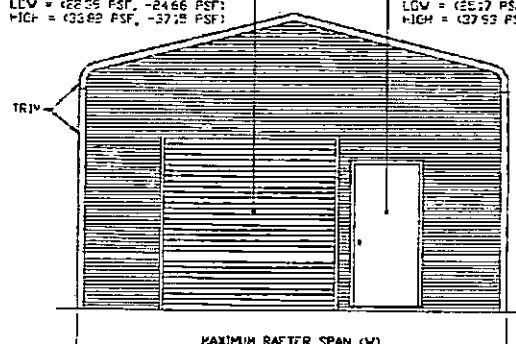

TYPICAL END ELEVATION
 SCALE: NTS

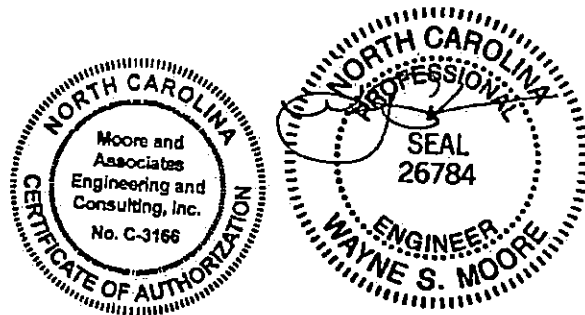

MAY 09 2018

**MOORE AND ASSOCIATES
 ENGINEERING AND CONSULTING, INC.**

DRAWN BY: JRS

CHECKED BY: PDM

PROJECT MGR: VSM

CLIENT: CAROLINA
 CARPORTS

DATE: 1-15-18

SHT: 3B

CAROLINA CARPORTS, INC.
 187 CARDINAL RIDGE TRAIL
 DOBSON, NC 27017

30'x20' ENCLOSED STRUCTURE

SCALE: NTS

DWG. NO: SK-3

JOB NO: 15156S 16135S
 17324S

REV: 7

THIS DOCUMENT IS THE PROPERTY OF MOORE AND ASSOCIATES ENGINEERING AND CONSULTING. THE UNAUTHORIZED REPRODUCTION, COPYING, OR OTHERWISE USE OF THIS DOCUMENT IS STRICTLY PROHIBITED AND ANY INFRINGEMENT THEREUPON MAY BE SUBJECT TO LEGAL ACTION.

EXPOSURE B

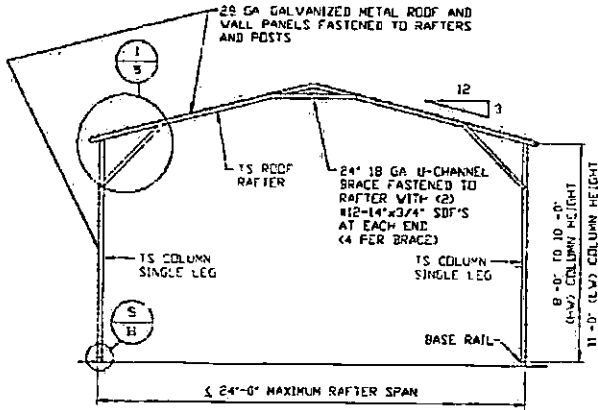

TYPICAL RAFTER/COLUMN END FRAME SECTION
SCALE: NTS

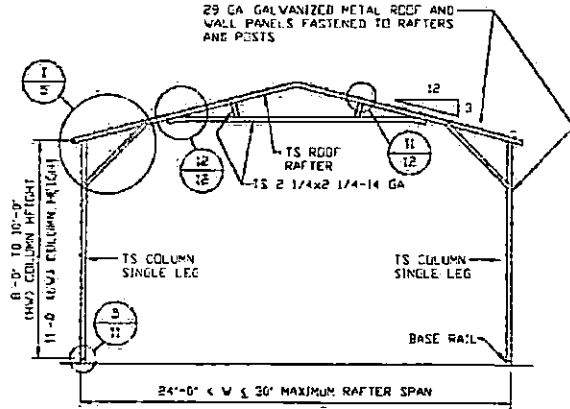

TYPICAL RAFTER/COLUMN END FRAME SECTION
SCALE: NTS

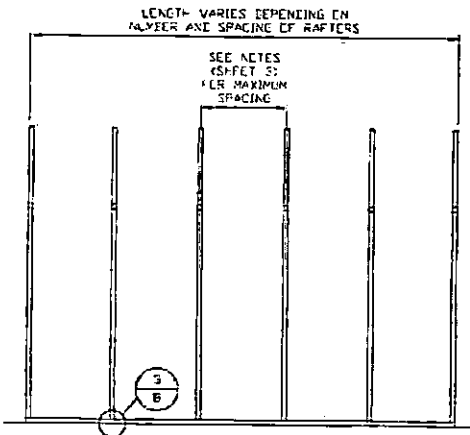

TYPICAL RAFTER/COLUMN SIDE FRAMING SECTION
SCALE: NTS

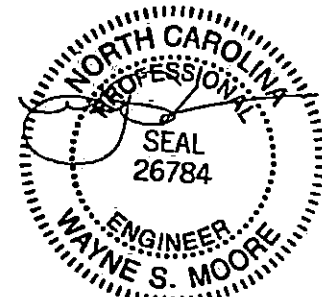

MAY 09 2018

**MOORE AND ASSOCIATES
ENGINEERING AND CONSULTING, INC.**

DRAWN BY: JRS

CHECKED BY: PDM

PROJECT NO.: VSM

CLIENT: CAROLINA CARPORTS

CAROLINA CARPORTS, INC.
187 CARDINAL RIDGE TRAIL
DOBSON, NC 27017
30'x20' ENCLOSED STRUCTURE

DATE: 1-15-18

SHT.: 4

SCALE: NTS

DWG. NO.: SK-3

JOB NO.: 151565 161355 173245

REV.: 7

THIS DOCUMENT IS THE PROPERTY OF MOORE AND ASSOCIATES ENGINEERING AND CONSULTING. THE UNAUTHORIZED REPRODUCTION, COPYING, OR OTHERWISE USE OF THIS DOCUMENT IS STRICTLY PROHIBITED AND ANY INFRINGEMENT THEREUPON MAY BE SUBJECT TO LEGAL ACTION.

EXPOSURE C

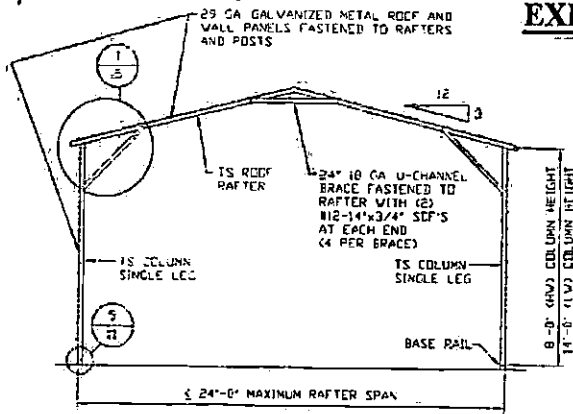

TYPICAL RAFTER/COLUMN END FRAME SECTION
SCALE: NTS

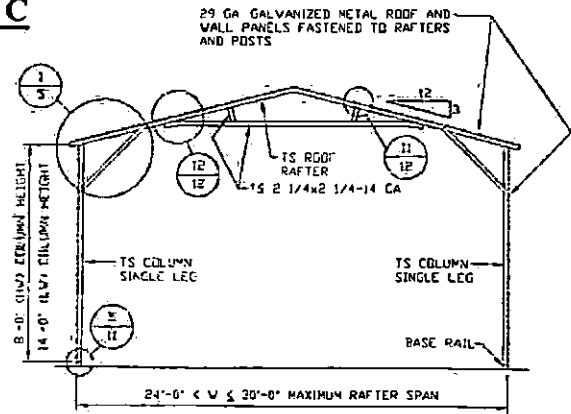

TYPICAL RAFTER/COLUMN END FRAME SECTION
SCALE: NTS

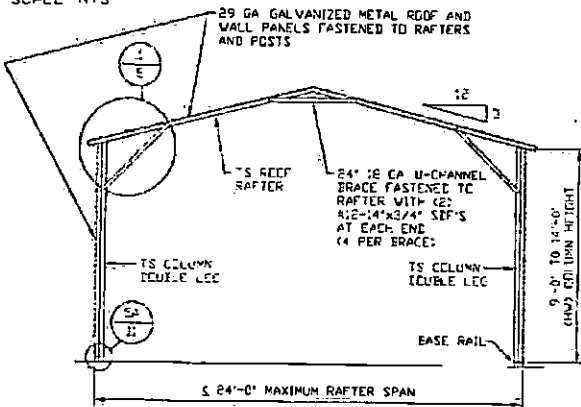

TYPICAL RAFTER/COLUMN END FRAME SECTION
SCALE: NTS

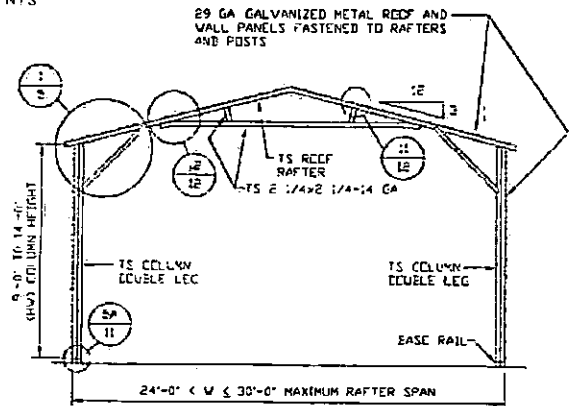

TYPICAL RAFTER/COLUMN END FRAME SECTION
SCALE: NTS

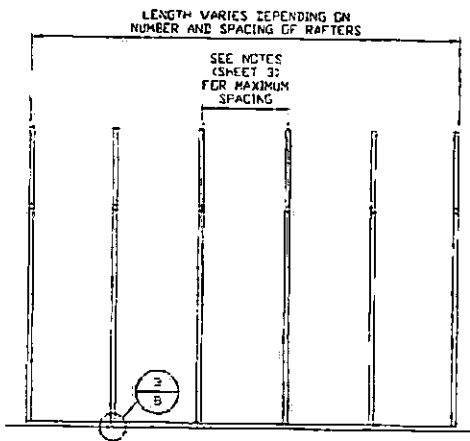

TYPICAL RAFTER/COLUMN SIDE FRAMING SECTION
SCALE: NTS

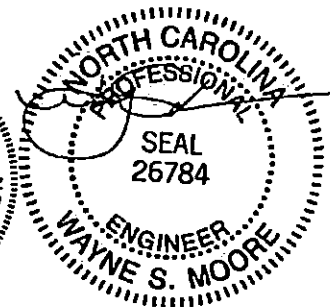
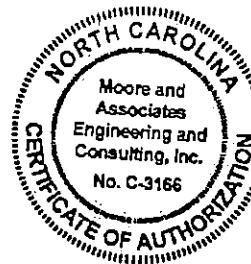

MAY 09 2018

**MOORE AND ASSOCIATES
ENGINEERING AND CONSULTING, INC.**

DRAWN BY: JRS

CHECKED BY: PDH

PROJECT MGR: WSM

CLIENT: CAROLINA CARPORTS

CAROLINA CARPORTS, INC.
187 CARDINAL RIDGE TRAIL
DOBSON, NC 27017
30'x20' ENCLOSED STRUCTURE

DATE: 1-15-18

SHT. 4A

SCALE: NTS

DWG. NO: SK-3

JOB NO: 15156S 16135S
17324S

REV: 7

THIS DOCUMENT IS THE PROPERTY OF MOORE AND ASSOCIATES ENGINEERING AND CONSULTING. THE UNAUTHORIZED REPRODUCTION, COPYING, OR OTHERWISE USE OF THIS DOCUMENT IS STRICTLY PROHIBITED AND ANY INFRINGEMENT THEREUPON MAY BE SUBJECT TO LEGAL ACTION.

EXPOSURE B

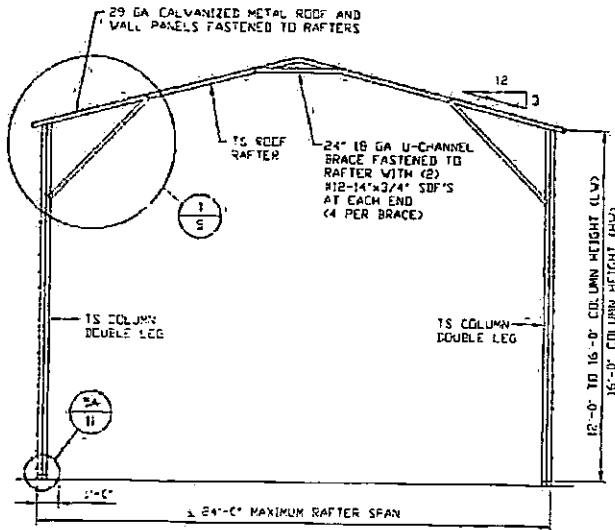

TYPICAL RAFTER/COLUMN END FRAME SECTION
SCALE: NTS

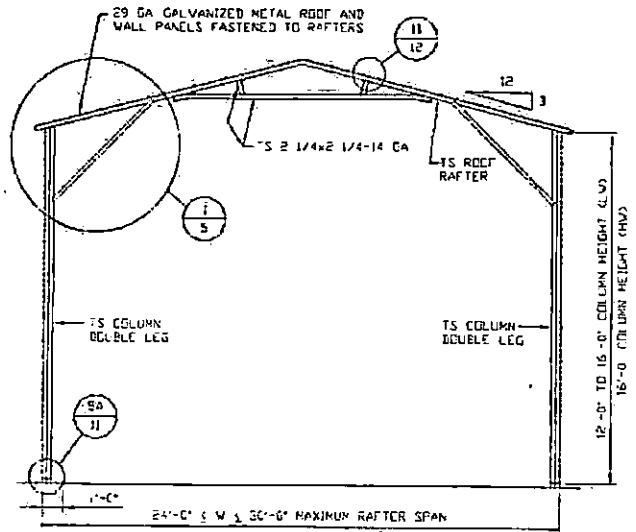

TYPICAL RAFTER/COLUMN END FRAME SECTION
SCALE: NTS

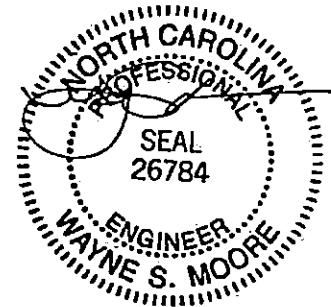
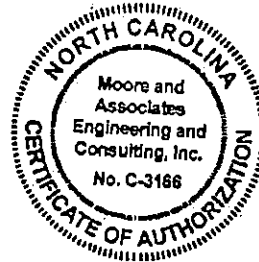

MAY 09 2018

**MOORE AND ASSOCIATES
ENGINEERING AND CONSULTING, INC.**

DRAWN BY: JRS

CHECKED BY: PDH

PROJECT MGR: VSM

CLIENT: CAROLINA
CARPORTS

DATE: 1-15-18

SHT. 4B

CAROLINA CARPORTS, INC.
187 CARDINAL RIDGE TRAIL
DOBSON, NC 27017
30'x20' ENCLOSED STRUCTURE

SCALE: NTS

DWG. NO. SK-3

JOB NO: 15156S 16135S
17324S

REV: 7

THIS DOCUMENT IS THE PROPERTY OF MOORE AND ASSOCIATES ENGINEERING AND CONSULTING. THE UNAUTHORIZED REPRODUCTION, COPYING, OR OTHERWISE USE OF THIS DOCUMENT IS STRICTLY PROHIBITED AND ANY INFRINGEMENT THEREUPON MAY BE SUBJECT TO LEGAL ACTION.

EXPOSURE B

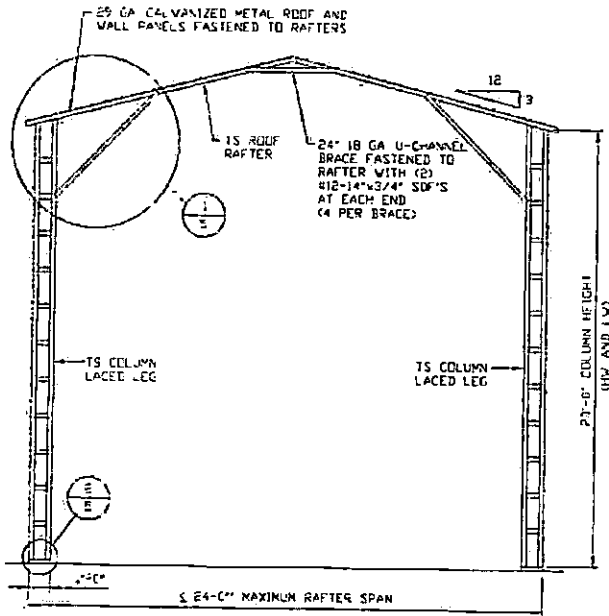

TYPICAL RAFTER/COLUMN END FRAME SECTION
SCALE: NTS

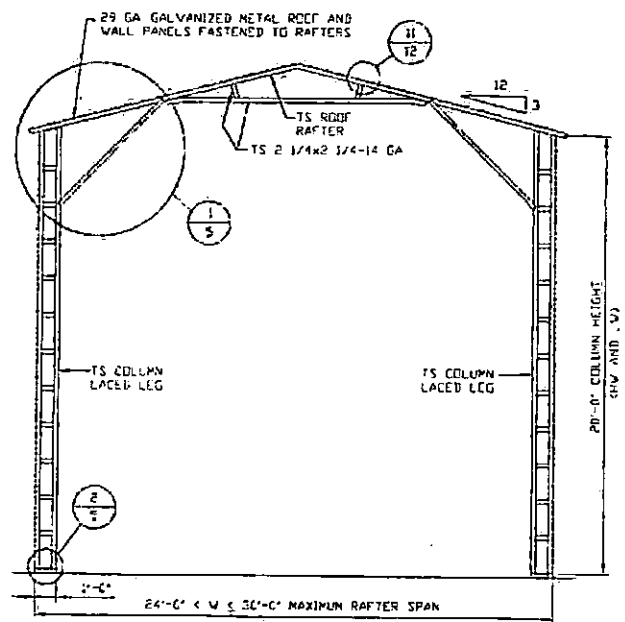

TYPICAL RAFTER/COLUMN END FRAME SECTION
SCALE: NTS

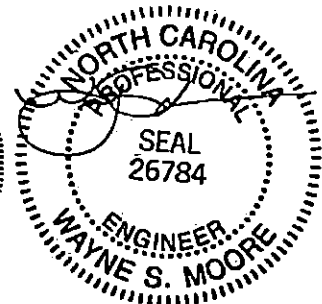
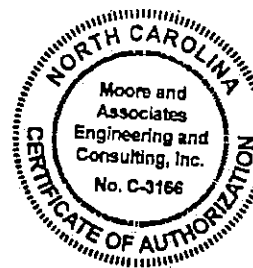

MAY 09 2018

**MOORE AND ASSOCIATES
ENGINEERING AND CONSULTING, INC.**

DRAWN BY: JRS

CHECKED BY: PDH

PROJECT MGR: WSM

CLIENT: CAROLINA
CARPORTS

CAROLINA CARPORTS, INC.
187 CARDINAL RIDGE TRAIL
DOBSON, NC 27017
30'x20' ENCLOSED STRUCTURE

DATE: 1-15-18

SHT. 4C

SCALE: NTS

DWG. NO: SK-3

JOB NO: 15156S 16135S
17324S

REV: 7

THIS DOCUMENT IS THE PROPERTY OF MOORE AND ASSOCIATES ENGINEERING AND CONSULTING. THE UNAUTHORIZED REPRODUCTION, COPYING, OR OTHERWISE USE OF THIS DOCUMENT IS STRICTLY PROHIBITED AND ANY INFRINGEMENT THEREUPON MAY BE SUBJECT TO LEGAL ACTION.

EXPOSURE C

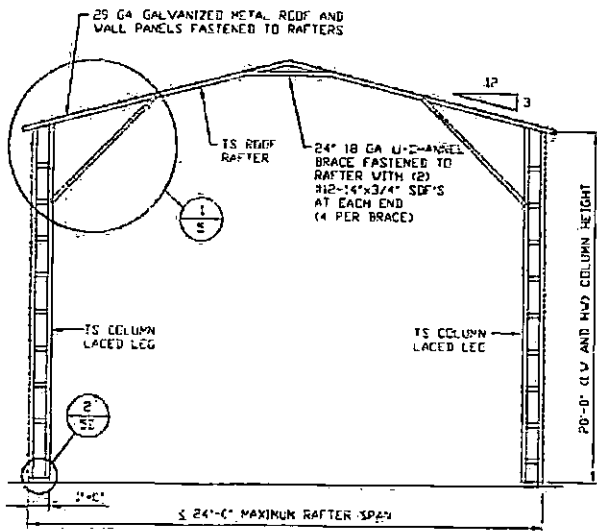

TYPICAL RAFTER/COLUMN END FRAME SECTION
SCALE: NTS

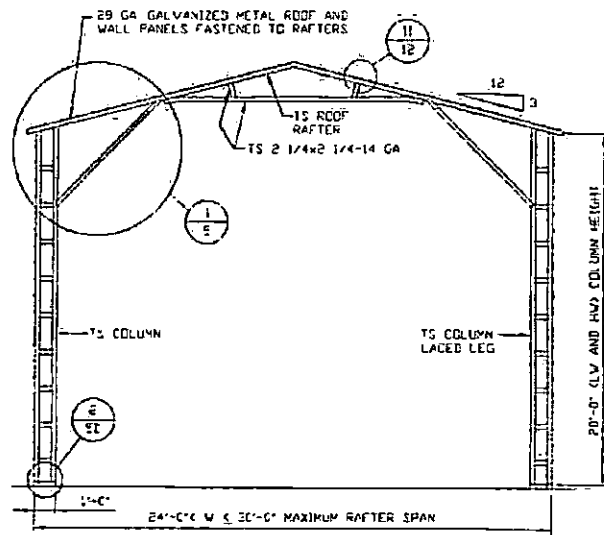

TYPICAL RAFTER/COLUMN END FRAME SECTION
SCALE: NTS

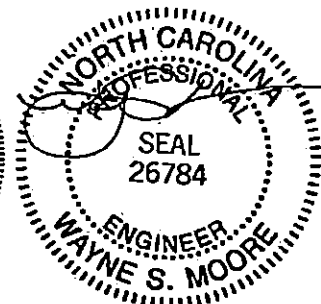
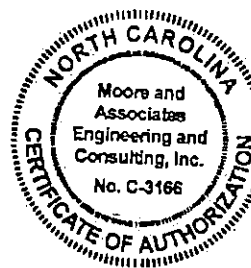

MAY 09 2018

**MOORE AND ASSOCIATES
ENGINEERING AND CONSULTING, INC.**

DRAWN BY: JRS

CHECKED BY: PDH

PROJECT MGR: WSM

CLIENT: CAROLINA
CARPORTS

CAROLINA CARPORTS, INC.
187 CARDINAL RIDGE TRAIL
DOBSON, NC 27017
30'x20' ENCLOSED STRUCTURE

DATE: 1-15-18

SHT. 4D

SCALE: NTS

DWG. NO: SK-3

JOB NO: 15156S 1613SS
17324S

REV: 7

THIS DOCUMENT IS THE PROPERTY OF MOORE AND ASSOCIATES ENGINEERING AND CONSULTING. THE UNAUTHORIZED REPRODUCTION, COPYING, OR OTHERWISE USE OF THIS DOCUMENT IS STRICTLY PROHIBITED AND ANY INFRINGEMENT THEREUPON MAY BE SUBJECT TO LEGAL ACTION.

LENGTH VARIES DEPENDING ON
NUMBER AND SPACING OF RAFTERS

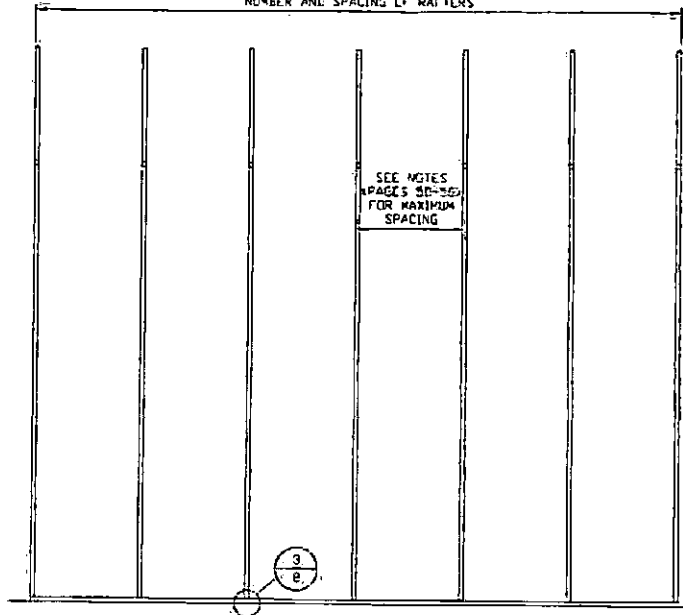

TYPICAL RAFTER/COLUMN SIDE FRAMING SECTION
SCALE: NTS

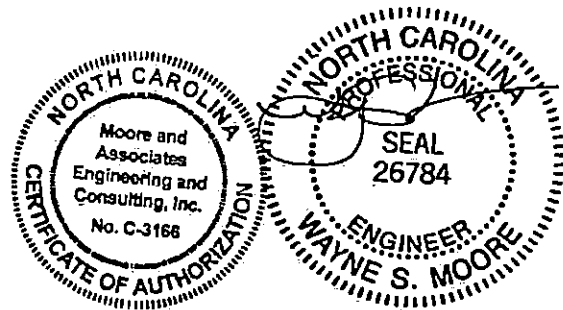

MAY 09 2018

MOORE AND ASSOCIATES ENGINEERING AND CONSULTING, INC.	DRAWN BY: JRS	CAROLINA CARPORTS, INC. 187 CARDINAL RIDGE TRAIL DOBSON, NC 27017 30'x20' ENCLOSED STRUCTURE		
	CHECKED BY: PDH			
THIS DOCUMENT IS THE PROPERTY OF MOORE AND ASSOCIATES ENGINEERING AND CONSULTING. THE UNAUTHORIZED REPRODUCTION, COPYING, OR OTHERWISE USE OF THIS DOCUMENT IS STRICTLY PROHIBITED AND ANY INFRINGEMENT THEREUPON MAY BE SUBJECT TO LEGAL ACTION.	PROJECT MGR: WSM	DATE: 1-15-18	SCALE: NTS	JOB NO: 15156S 1613SS 17324S
	CLIENT: CAROLINA CARPORTS	SHT. 4E	DWG. NO: SK-3	REV: 7

EXPOSURE B (170 MPH)

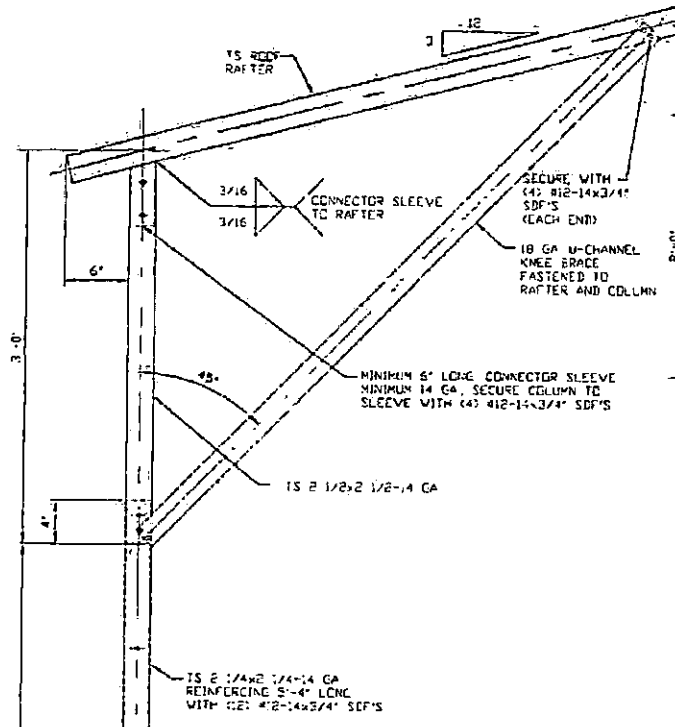

1A
BOX EAVE RAFTER COLUMN CONNECTION DETAIL FOR HEIGHTS 12'-0" < TO <= 14'-0"
SCALE NTS

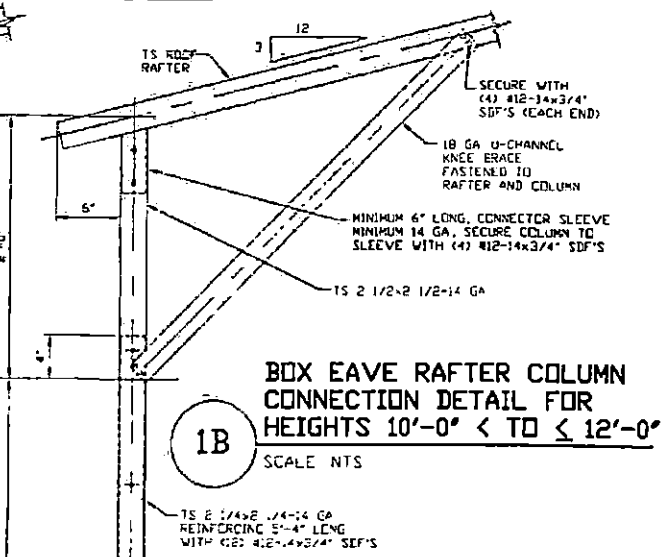

1B
BOX EAVE RAFTER COLUMN CONNECTION DETAIL FOR HEIGHTS 10'-0" < TO <= 12'-0"
SCALE NTS

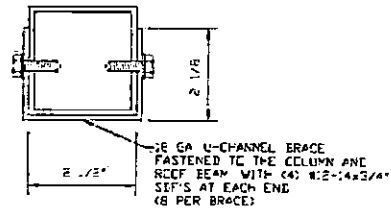

BRACE SECTION
SCALE NTS

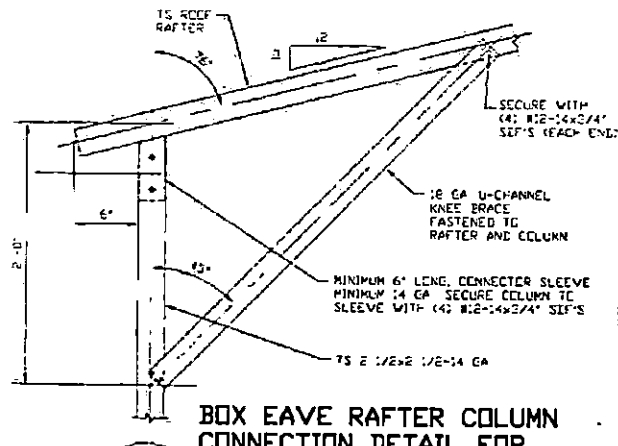

1C
BOX EAVE RAFTER COLUMN CONNECTION DETAIL FOR HEIGHTS <= 10'-0"
SCALE NTS

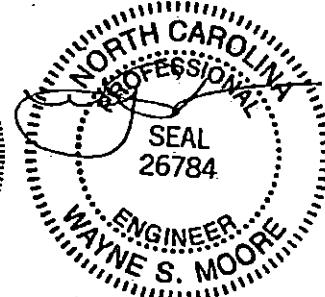
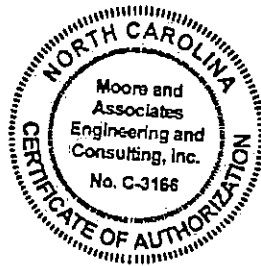

MAY 09 2018

MOORE AND ASSOCIATES ENGINEERING AND CONSULTING, INC.

DRAWN BY: JRS

CHECKED BY: PDH

PROJECT MGR: WSM

CLIENT: CAROLINA CARPORTS

CAROLINA CARPORTS, INC.
187 CARDINAL RIDGE TRAIL
DOBSON, NC 27017
30'x20' ENCLOSED STRUCTURE

DATE: 1-15-18

SHT. 5A

SCALE: NTS

DWG. NO. SK-3

JOB NO: 15156S 16135S 17324S

REV. 7

THIS DOCUMENT IS THE PROPERTY OF MOORE AND ASSOCIATES ENGINEERING AND CONSULTING. THE UNAUTHORIZED REPRODUCTION, COPYING, OR OTHERWISE USE OF THIS DOCUMENT IS STRICTLY PROHIBITED AND ANY INFRINGEMENT THEREUPON MAY BE SUBJECT TO LEGAL ACTION.

EXPOSURE C (140 MPH)

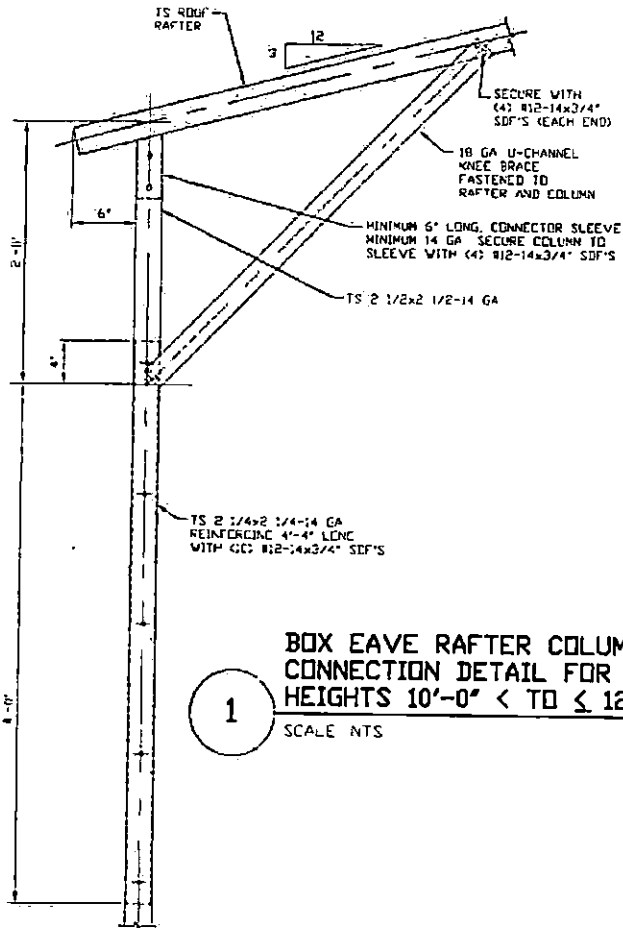

1 BOX EAVE RAFTER COLUMN CONNECTION DETAIL FOR HEIGHTS 10'-0" < TO ≤ 12'-0"

SCALE: NTS

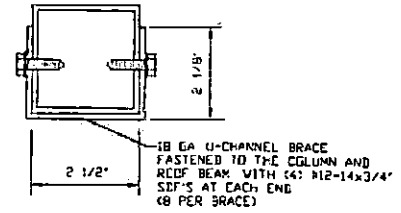

BRACE SECTION
SCALE: NTS

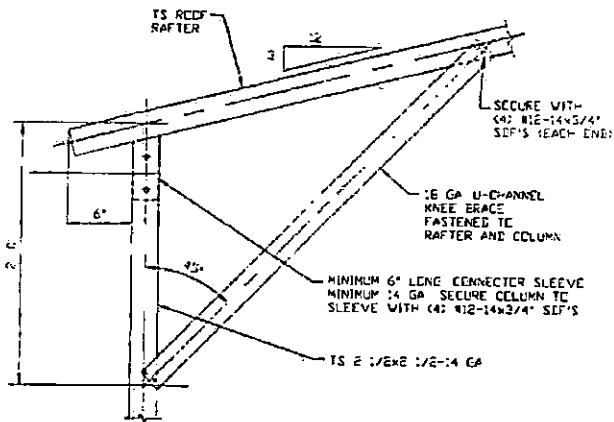

1B BOX EAVE RAFTER COLUMN CONNECTION DETAIL FOR HEIGHTS ≤ 10'-0"

SCALE: NTS

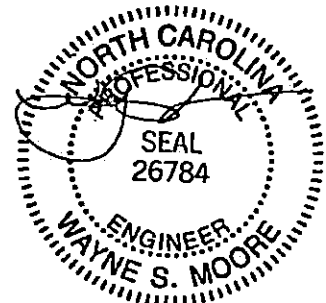
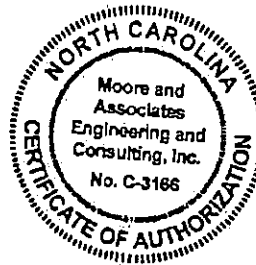

MAY 09 2018

MOORE AND ASSOCIATES ENGINEERING AND CONSULTING, INC.

DRAWN BY: JRS

CHECKED BY: PDH

PROJECT MGR: WSH

CLIENT: CAROLINA CARPORTS

CAROLINA CARPORTS, INC.
187 CARDINAL RIDGE TRAIL
DOBSON, NC 27017
30'x20' ENCLOSED STRUCTURE

DATE: 1-15-18

SHT. 5B

SCALE: NTS

DWG. NO SK-3

JOB NO 151563 161353 17324S

REV: 7

THIS DOCUMENT IS THE PROPERTY OF MOORE AND ASSOCIATES ENGINEERING AND CONSULTING. THE UNAUTHORIZED REPRODUCTION, COPYING, OR OTHERWISE USE OF THIS DOCUMENT IS STRICTLY PROHIBITED AND ANY INFRINGEMENT THEREUPON MAY BE SUBJECT TO LEGAL ACTION.

EXPOSURE C (170 MPH)

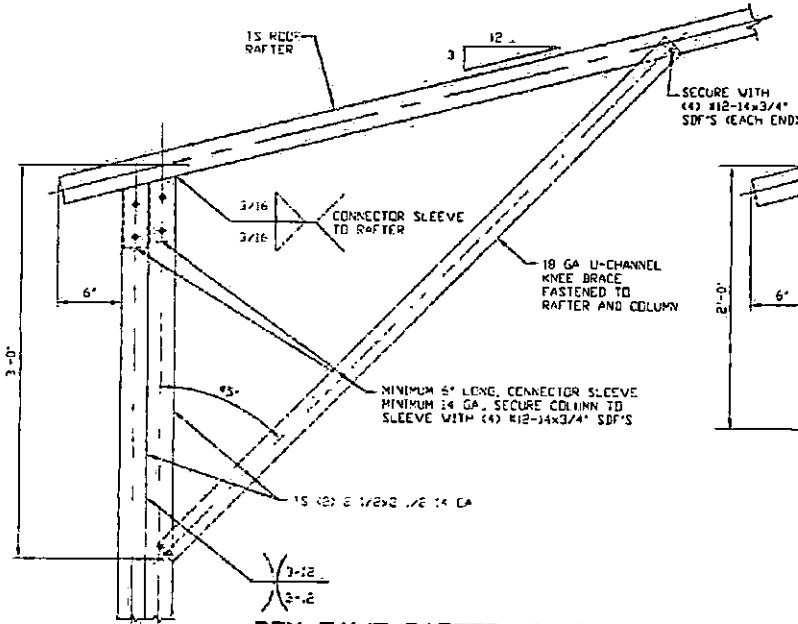

1A BOX EAVE RAFTER COLUMN CONNECTION DETAIL FOR HEIGHTS 12'-0" < TO <= 14'-0" SCALE NTS

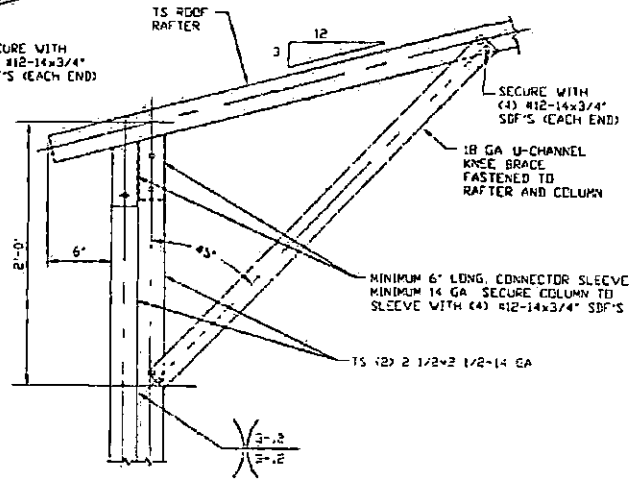

1B BOX EAVE RAFTER COLUMN CONNECTION DETAIL FOR HEIGHTS 8'-0" < TO <= 12'-0" SCALE NTS

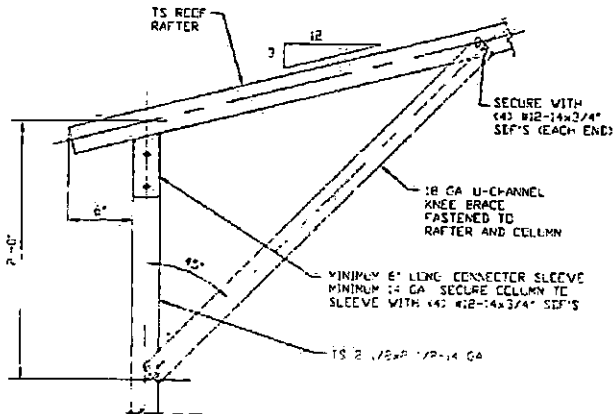

1C BOX EAVE RAFTER COLUMN CONNECTION DETAIL FOR HEIGHTS <= 8'-0" SCALE NTS

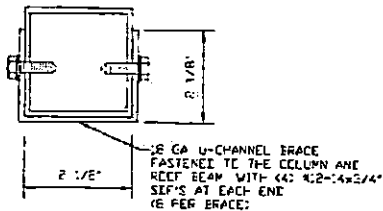

BRACE SECTION SCALE NTS

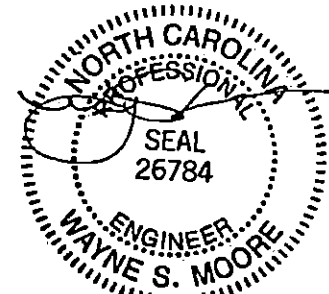
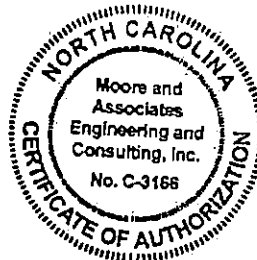

MAY 09 2018

**MOORE AND ASSOCIATES
ENGINEERING AND CONSULTING, INC.**

DRAWN BY: JRS

CHECKED BY: PDH

PROJECT MGR: WSH

CLIENT: CAROLINA CARPORTS

CAROLINA CARPORTS, INC.
187 CARDINAL RIDGE TRAIL
DOBSON, NC 27017
30'x20' ENCLOSED STRUCTURE

DATE: 1-15-18

SHT. 5C

SCALE: NTS

DWG. NO SK-3

JOB NO: 15156S 16135S 17324S

REV: 7

THIS DOCUMENT IS THE PROPERTY OF MOORE AND ASSOCIATES ENGINEERING AND CONSULTING. THE UNAUTHORIZED REPRODUCTION, COPYING, OR OTHERWISE USE OF THIS DOCUMENT IS STRICTLY PROHIBITED AND ANY INFRINGEMENT THEREUPON MAY BE SUBJECT TO LEGAL ACTION.

EXPOSURE B (140 MPH)

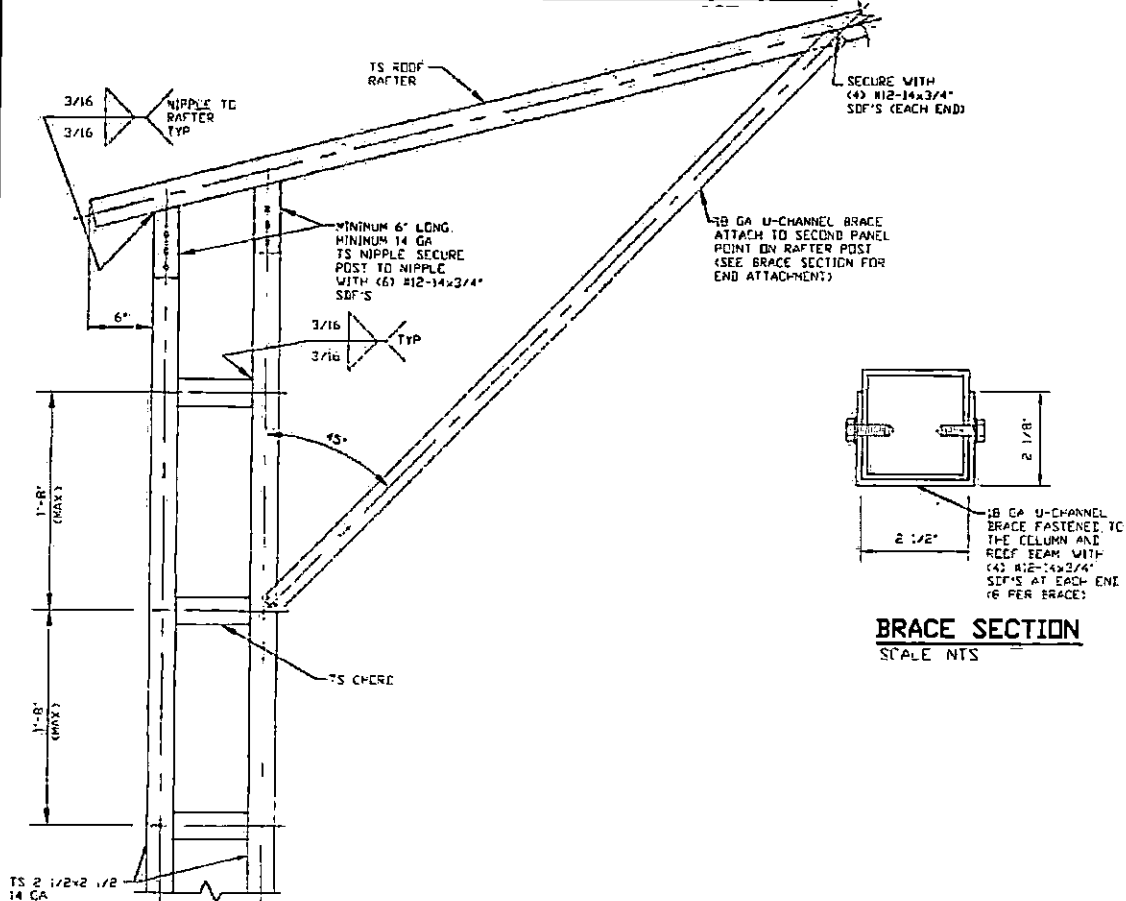

1 BOX EAVE RAFTER COLUMN CONNECTION
DETAIL FOR HEIGHT 20'-0"

SCALE: NTS

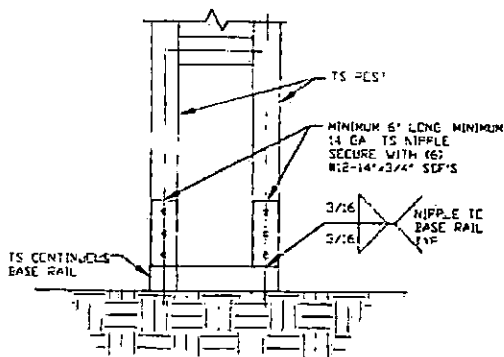

2 POST/BASE RAIL CONNECTION DETAIL

SCALE: NTS

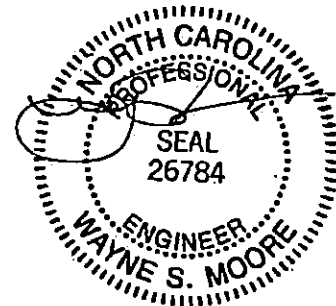
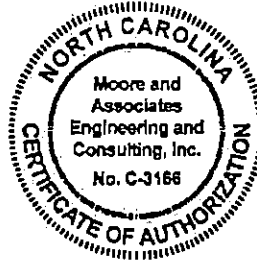

MAY 09 2018

**MOORE AND ASSOCIATES
ENGINEERING AND CONSULTING, INC.**

DRAWN BY: JRS

CHECKED BY: PDH

PROJECT: MGR VSM

CLIENT: CAROLINA CARPORTS

CAROLINA CARPORTS, INC.
187 CARDINAL RIDGE TRAIL
DOBSON, NC 27017
30'x20' ENCLOSED STRUCTURE

DATE: 1-15-18

SHT. 5D

SCALE: NTS

DWG. NO: SK-3

JOB NO: 15156S 1613SS
17324S

REV: 7

THIS DOCUMENT IS THE PROPERTY OF MOORE AND ASSOCIATES ENGINEERING AND CONSULTING. THE UNAUTHORIZED REPRODUCTION, COPYING, OR OTHERWISE USE OF THIS DOCUMENT IS STRICTLY PROHIBITED AND ANY INFRINGEMENT THEREUPON MAY BE SUBJECT TO LEGAL ACTION.

EXPOSURE B (170 MPH)

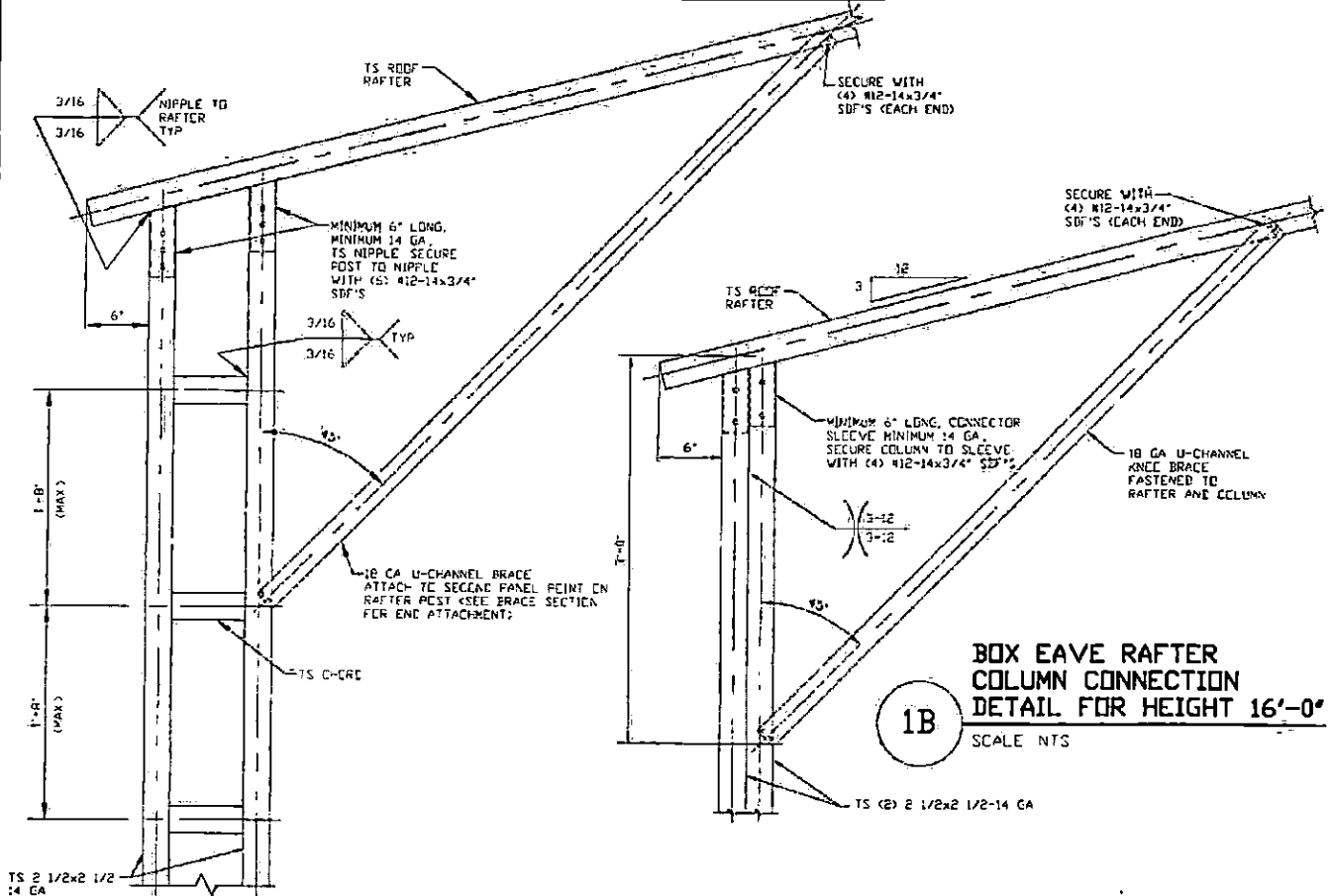

1A
BOX EAVE RAFTER
COLUMN CONNECTION
DETAIL FOR
HEIGHT 20'-0"
SCALE NTS

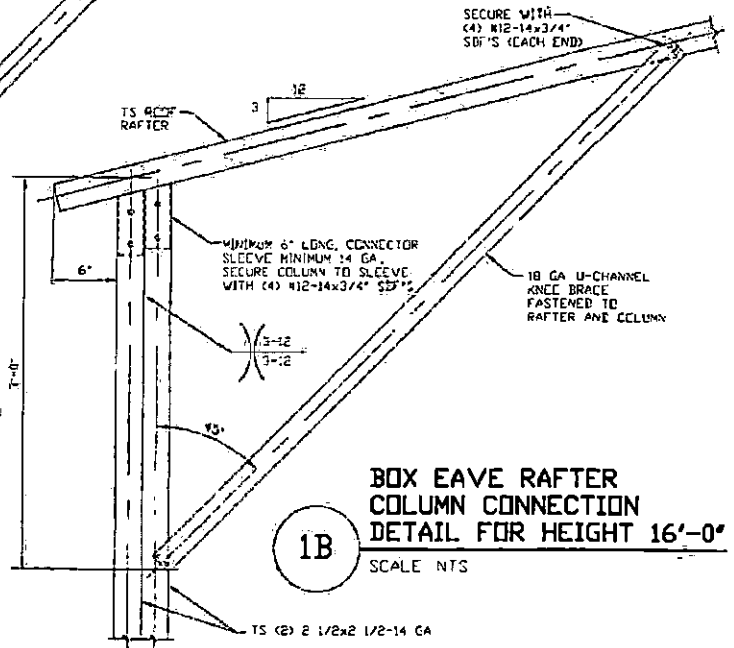

1B
BOX EAVE RAFTER
COLUMN CONNECTION
DETAIL FOR HEIGHT 16'-0"
SCALE NTS

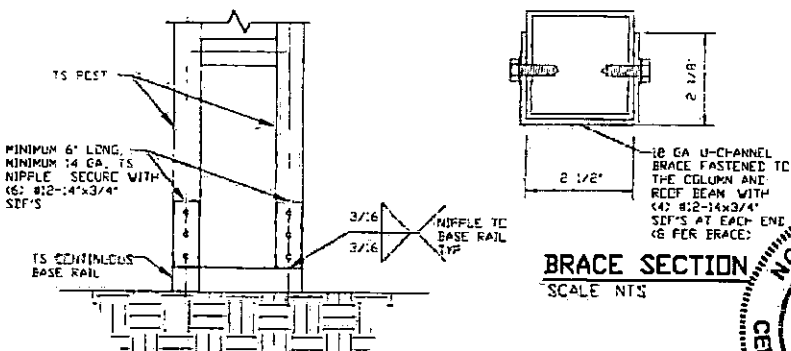

2
POST/BASE RAIL CONNECTION
DETAIL
SCALE NTS

BRACE SECTION
SCALE NTS

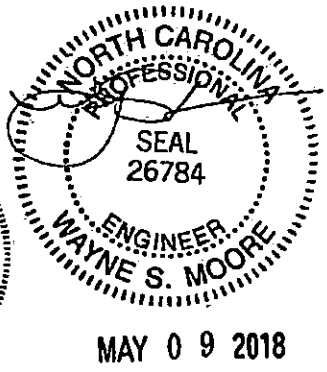
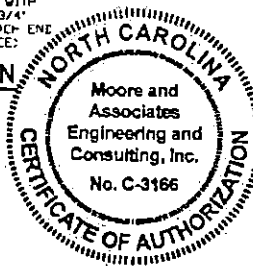

MAY 09 2018

**MOORE AND ASSOCIATES
ENGINEERING AND CONSULTING, INC.**

DRAWN BY: JRS		CAROLINA CARPORTS, INC. 187 CARDINAL RIDGE TRAIL DOBSON, NC 27017 30'x20' ENCLOSED STRUCTURE	
CHECKED BY: PDH		DATE: 1-15-18	SCALE: NTS
PROJECT MGR: VSM	DATE: 1-15-18	SCALE: NTS	JOB NO: 15156S 1613SS 17324S
CLIENT: CAROLINA CARPORTS	SHT. 5E	DWG. NO SK-3	REV. 7

THIS DOCUMENT IS THE PROPERTY OF MOORE AND ASSOCIATES ENGINEERING AND CONSULTING, INC. UNAUTHORIZED REPRODUCTION, COPYING, OR OTHERWISE USE OF THIS DOCUMENT IS STRICTLY PROHIBITED AND ANY INFRINGEMENT THEREUPON MAY BE SUBJECT TO LEGAL ACTION.

EXPOSURE C (140 MPH)

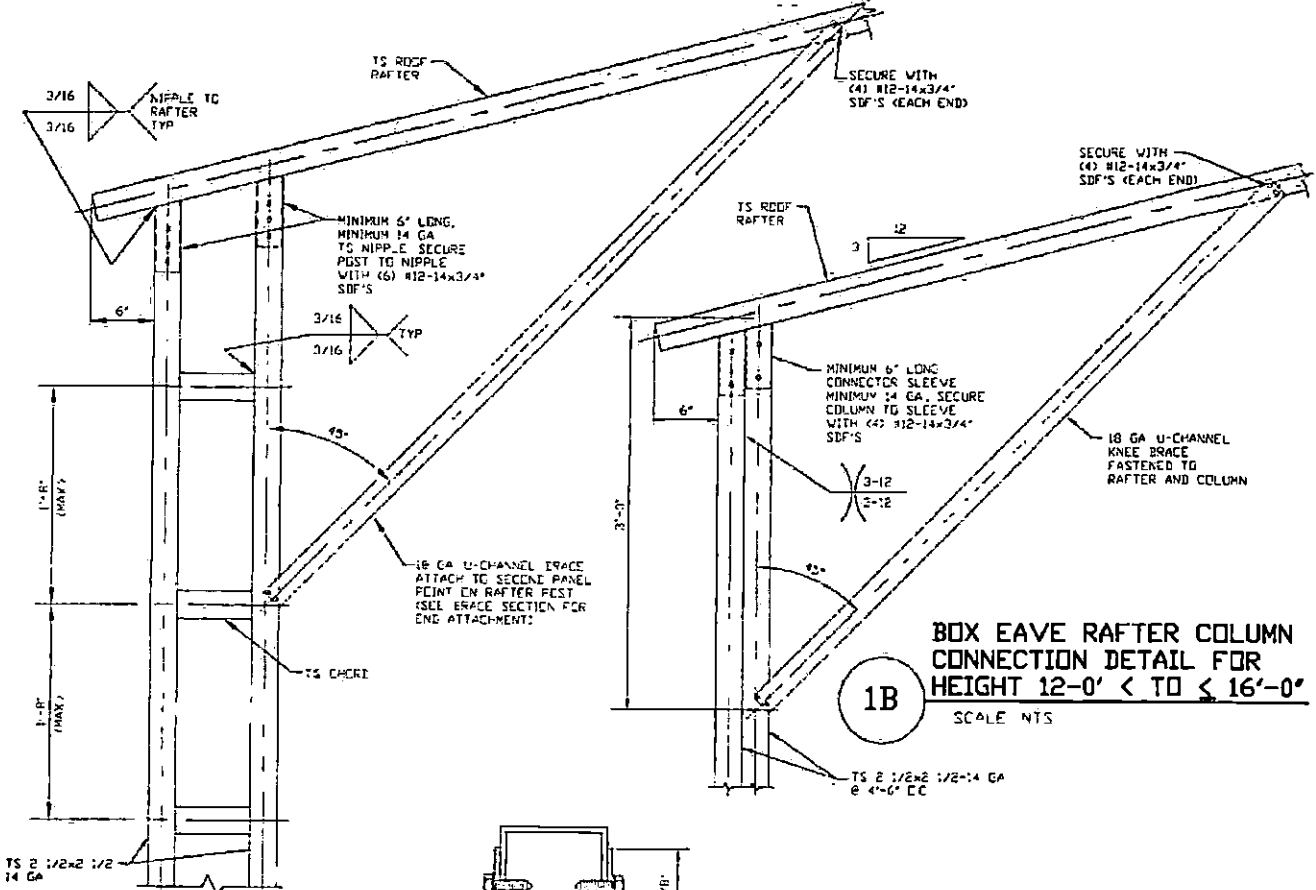

BOX EAVE RAFTER COLUMN CONNECTION DETAIL FOR HEIGHT 12'-0" < TO < 16'-0"
SCALE NTS

1A BOX EAVE RAFTER COLUMN CONNECTION DETAIL FOR HEIGHT 20'-0"
SCALE NTS

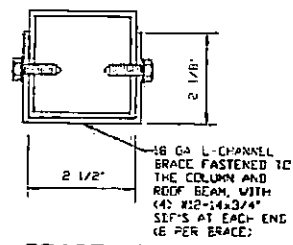

BRACE SECTION
SCALE NTS

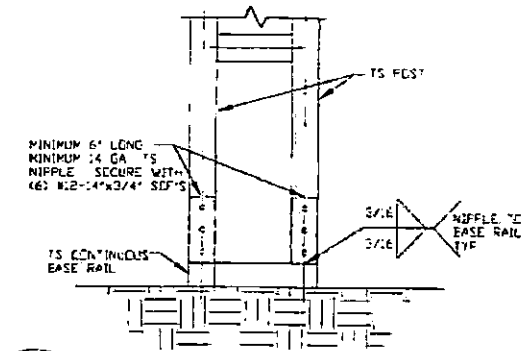

2 POST/BASE RAIL CONNECTION DETAIL
SCALE NTS

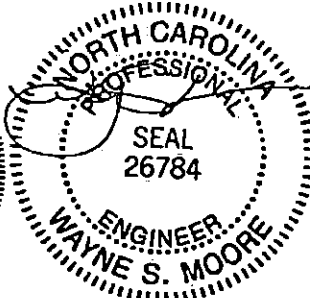
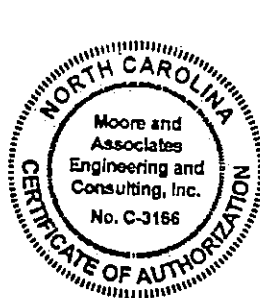

MAY 09 2018

MOORE AND ASSOCIATES ENGINEERING AND CONSULTING, INC.

DRAWN BY: JRS	CAROLINA CARPORTS, INC. 187 CARDINAL RIDGE TRAIL DOBSON, NC 27017 30'x20' ENCLOSED STRUCTURE		
CHECKED BY: PDH	DATE: 1-15-18	SCALE: NTS	JOB NO: 15136S 1613SS 17324S
PROJECT MGR: WSH	SHT. 5F	DWG. NO: SK-3	REV: 7
CLIENT: CAROLINA CARPORTS			

THIS DOCUMENT IS THE PROPERTY OF MOORE AND ASSOCIATES ENGINEERING AND CONSULTING, INC. UNAUTHORIZED REPRODUCTION, COPYING, OR OTHERWISE USE OF THIS DOCUMENT IS STRICTLY PROHIBITED AND ANY INFRINGEMENT THEREUPON MAY BE SUBJECT TO LEGAL ACTION.

EXPOSURE C (170 MPH)

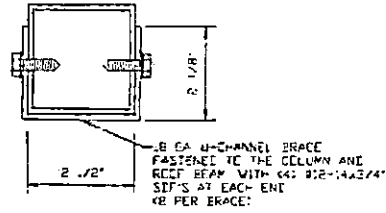
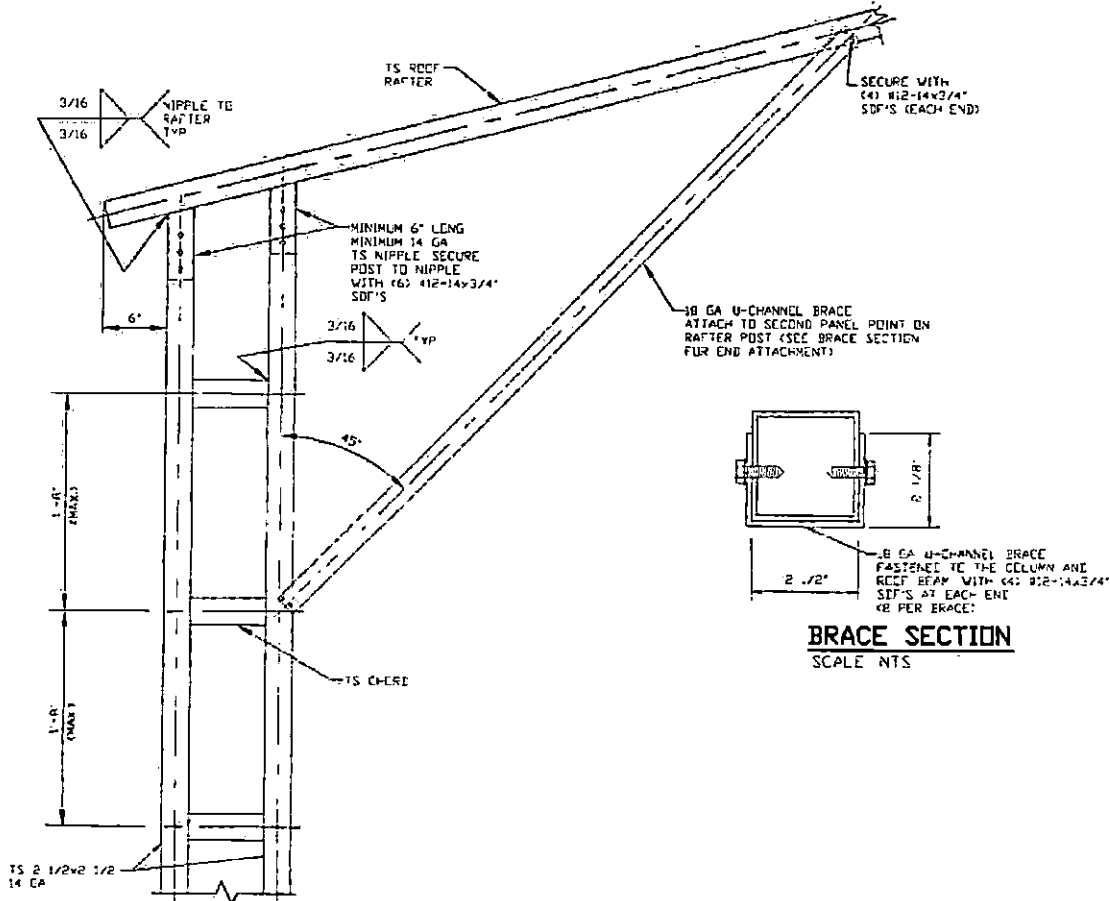

BRACE SECTION
SCALE NTS

1 BOX EAVE RAFTER COLUMN CONNECTION DETAIL FOR HEIGHTS 14'-0" < TO ≤ 20'-0"
SCALE NTS

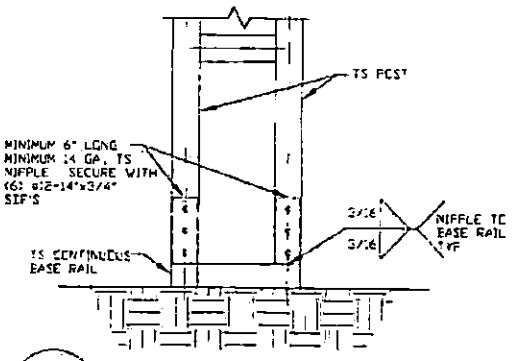

2 POST/BASE RAIL CONNECTION DETAIL
SCALE NTS

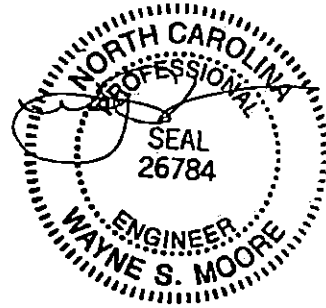
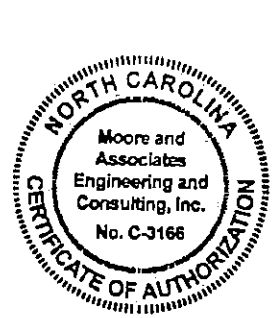

MAY 09 2018

MOORE AND ASSOCIATES ENGINEERING AND CONSULTING, INC.		DRAWN BY: JRS		CAROLINA CARPORTS, INC. 187 CARDINAL RIDGE TRAIL DOBSON, NC 27017 30'x20' ENCLOSED STRUCTURE	
		CHECKED BY: PDH			
THIS DOCUMENT IS THE PROPERTY OF MOORE AND ASSOCIATES ENGINEERING AND CONSULTING. THE UNAUTHORIZED REPRODUCTION, COPYING, OR OTHERWISE USE OF THIS DOCUMENT IS STRICTLY PROHIBITED AND ANY INFRINGEMENT THEREUPON MAY BE SUBJECT TO LEGAL ACTION.		PROJECT MGR: WSM	DATE: 1-15-18	SCALE: NTS	JOB NO: 15156S 16135S 17324S
		CLIENT: CAROLINA CARPORTS	SHT. 5G	IMG. NO: SK-3	REV: 7

EXPOSURE B

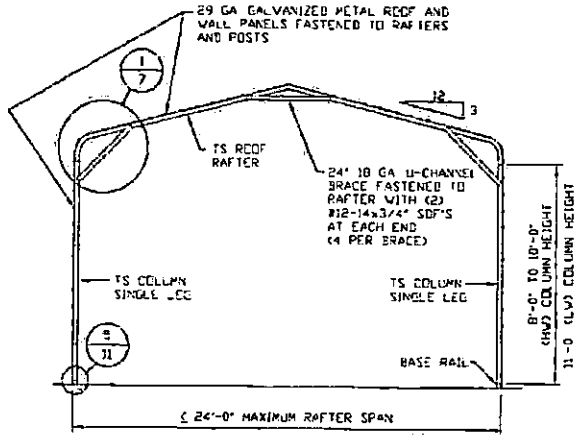

TYPICAL RAFTER/COLUMN END FRAME SECTION
SCALE: NTS

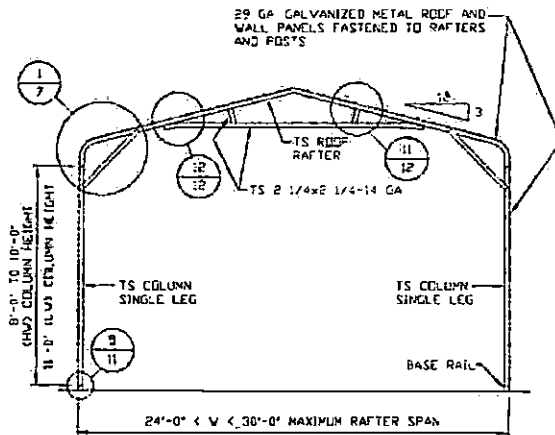

TYPICAL RAFTER/COLUMN END FRAME SECTION
SCALE: NTS

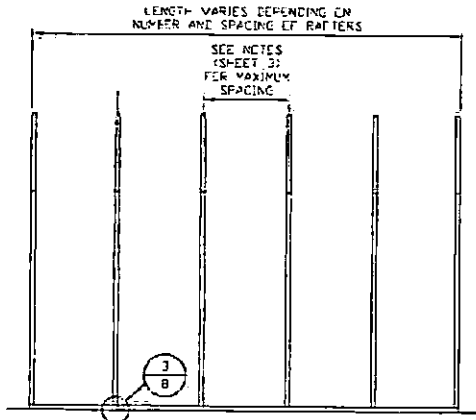

TYPICAL RAFTER/COLUMN FRAMING SIDE SECTION
SCALE: NTS

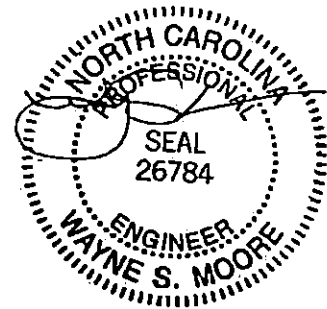
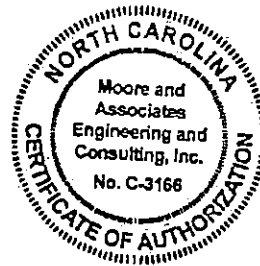

MAY 09 2018

**MOORE AND ASSOCIATES
ENGINEERING AND CONSULTING, INC.**

DRAWN BY: JRS

CHECKED BY: PIH

PROJECT MGR: WSM

CLIENT: CAROLINA
CARPORTS

CAROLINA CARPORTS, INC.
187 CARDINAL RIDGE TRAIL
DOBSON, NC 27017
30'x20' ENCLOSED STRUCTURE

DATE: 1-15-18

SHT. 6

SCALE: NTS

DWG. NO: SK-3

JOB NO: 15156S 16135S
17324S

REV: 7

THIS DOCUMENT IS THE PROPERTY OF MOORE AND ASSOCIATES ENGINEERING AND CONSULTING. THE UNAUTHORIZED REPRODUCTION, COPYING, OR OTHERWISE USE OF THIS DOCUMENT IS STRICTLY PROHIBITED AND ANY INFRINGEMENT THEREUPON MAY BE SUBJECT TO LEGAL ACTION.

EXPOSURE C

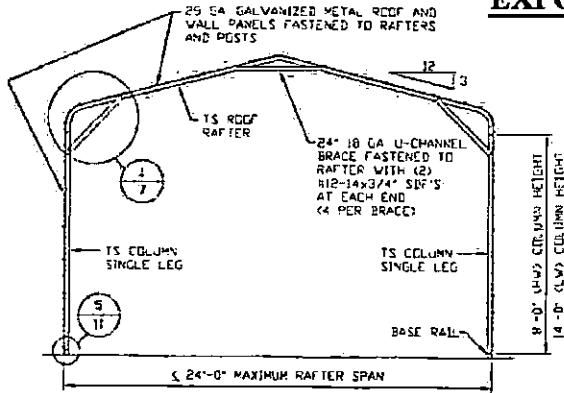

TYPICAL RAFTER/COLUMN END FRAME SECTION

SCALE NTS

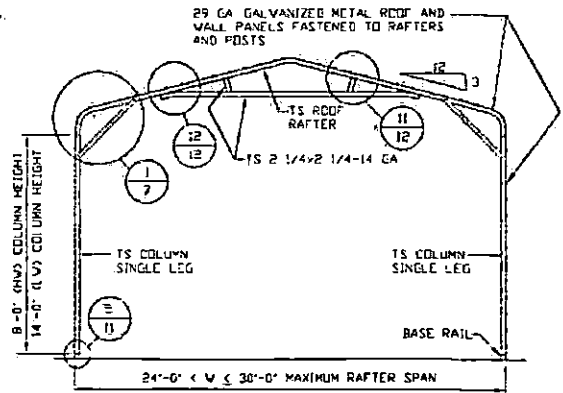

TYPICAL RAFTER/COLUMN END FRAME SECTION

SCALE NTS

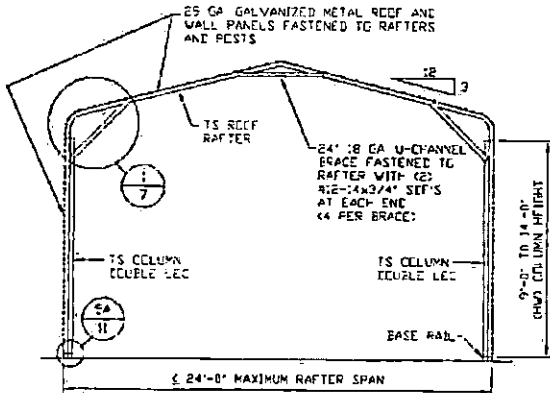

TYPICAL RAFTER/COLUMN END FRAME SECTION

SCALE NTS

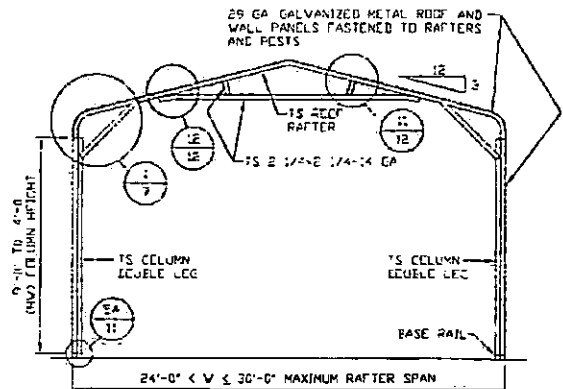

TYPICAL RAFTER/COLUMN END FRAME SECTION

SCALE: NTS

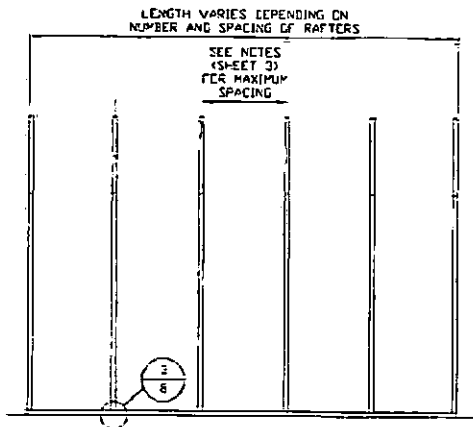

TYPICAL RAFTER/COLUMN FRAMING SIDE SECTION

SCALE NTS

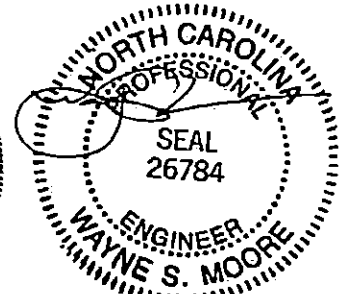
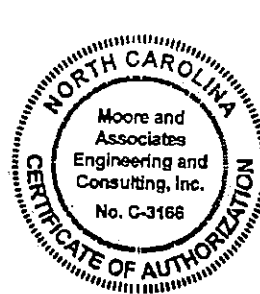

MAY 09 2018

**MOORE AND ASSOCIATES
ENGINEERING AND CONSULTING, INC.**

DRAWN BY: JRS

CHECKED BY: PDH

PROJECT MGR: WSM

CLIENT: CAROLINA
CARPORTS

CAROLINA CARPORTS, INC.
187 CARDINAL RIDGE TRAIL
DOBSON, NC 27017
30'x20' ENCLOSED STRUCTURE

DATE: 1-15-18

SHT. 6A

SCALE: NTS

DWG. NO. SK-3

JOB NO. 151565 161355
17324S

REV: 7

THIS DOCUMENT IS THE PROPERTY OF MOORE AND ASSOCIATES ENGINEERING AND CONSULTING. THE UNAUTHORIZED REPRODUCTION, COPYING, OR OTHERWISE USE OF THIS DOCUMENT IS STRICTLY PROHIBITED AND ANY INFRINGEMENT THEREUPON MAY BE SUBJECT TO LEGAL ACTION.

EXPOSURE B (170 MPH)

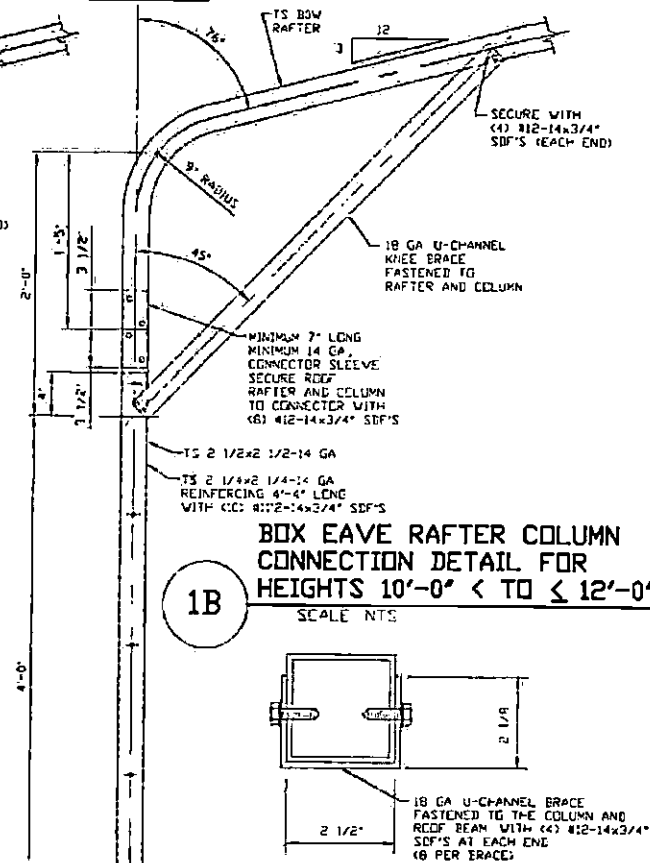
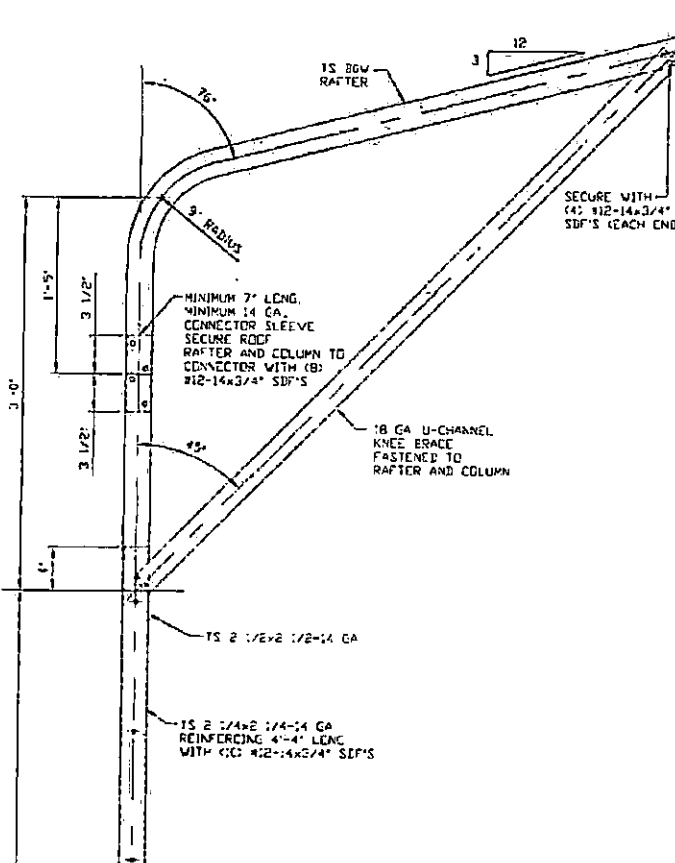

BOX EAVE RAFTER COLUMN CONNECTION DETAIL FOR HEIGHTS 10'-0" < TO < 12'-0"
SCALE: NTS

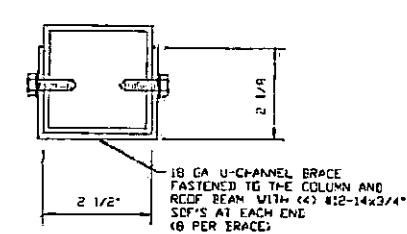

BOX EAVE RAFTER COLUMN CONNECTION DETAIL FOR HEIGHTS 12'-0" < TO < 14'-0"
SCALE: NTS

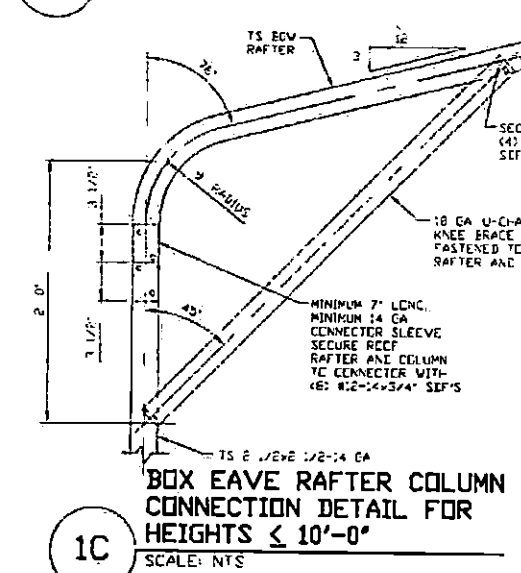

BOX EAVE RAFTER COLUMN CONNECTION DETAIL FOR HEIGHTS < 10'-0"
SCALE: NTS

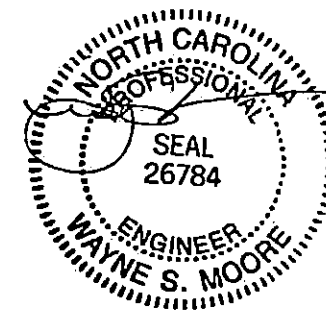
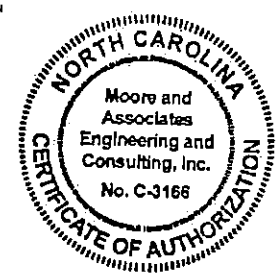

MAY 09 2018

MOORE AND ASSOCIATES ENGINEERING AND CONSULTING, INC.	DRAWN BY: JRS	CAROLINA CARPORTS, INC. 187 CARDINAL RIDGE TRAIL DOBSON, NC 27017 30'x20' ENCLOSED STRUCTURE		
	CHECKED BY: PDH	PROJECT MGR: WSM	DATE: 1-15-18	SCALE: NTS
THIS DOCUMENT IS THE PROPERTY OF MOORE AND ASSOCIATES ENGINEERING AND CONSULTING. THE UNAUTHORIZED REPRODUCTION, COPYING, OR OTHERWISE USE OF THIS DOCUMENT IS STRICTLY PROHIBITED AND ANY INFRINGEMENT THEREUPON MAY BE SUBJECT TO LEGAL ACTION.	CLIENT: CAROLINA CARPORTS	SHT. 7A	DWG. NO. SK-3	JOB NO. 15156S 16135S 17324S REV: 7

EXPOSURE C (140 MPH)

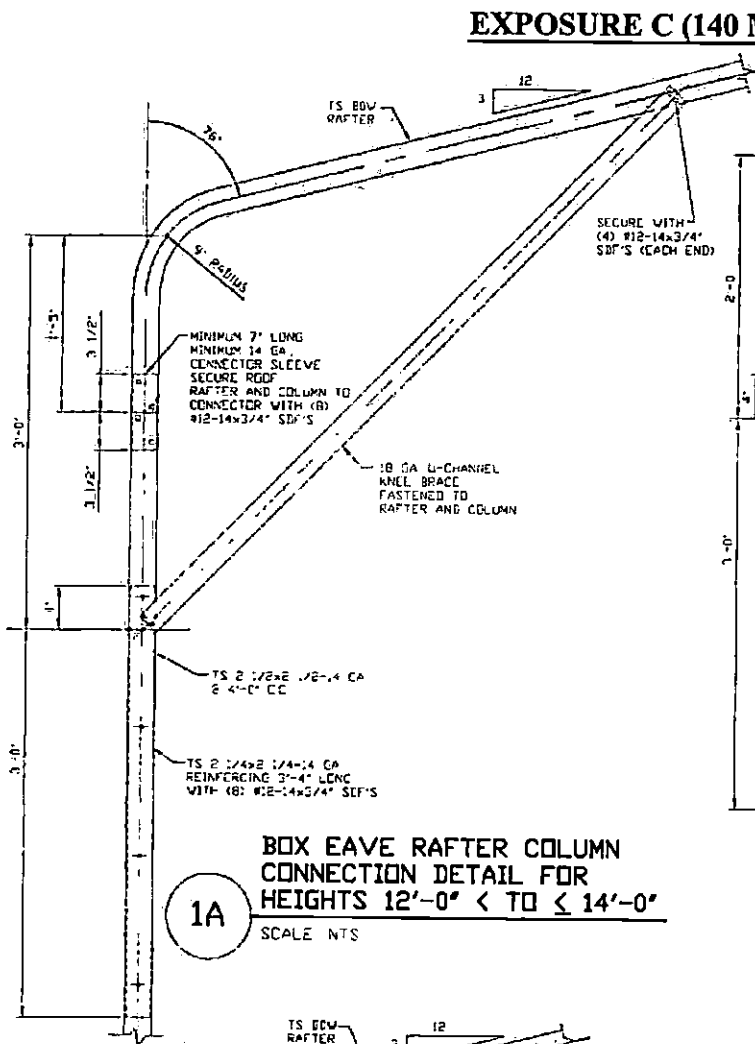

1A
BOX EAVE RAFTER COLUMN CONNECTION DETAIL FOR HEIGHTS 12'-0" < TO <= 14'-0"
SCALE: NTS

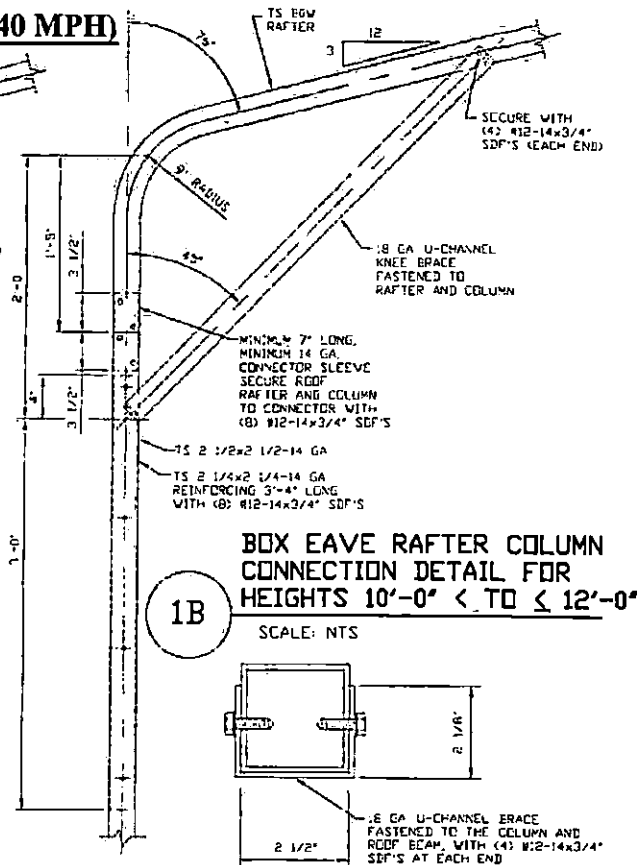

1B
BOX EAVE RAFTER COLUMN CONNECTION DETAIL FOR HEIGHTS 10'-0" < TO <= 12'-0"
SCALE: NTS

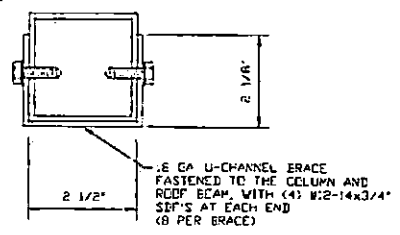

BRACE SECTION
SCALE: NTS

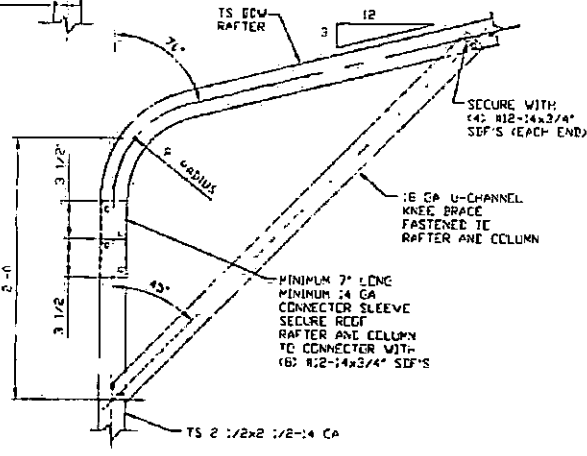

1C
BOX EAVE RAFTER COLUMN CONNECTION DETAIL FOR HEIGHTS <= 10'-0"
SCALE: NTS

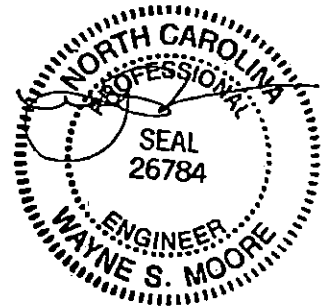
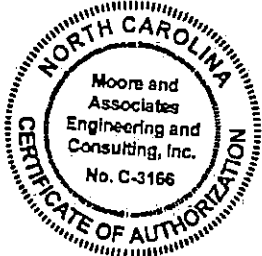

MAY 09 2018

**MOORE AND ASSOCIATES
ENGINEERING AND CONSULTING, INC.**

DRAWN BY: JRS

CHECKED BY: PIH

PROJECT MGR: VSM

CLIENT: CAROLINA CARPORTS

CAROLINA CARPORTS, INC.
187 CARDINAL RIDGE TRAIL
DOBSON, NC 27017
30'x20' ENCLOSED STRUCTURE

DATE: 1-15-18

SHT. 7B

SCALE: NTS

DWG. NO: SK-3

JOB NO: 15156S 16135S

REV: 7

THIS DOCUMENT IS THE PROPERTY OF MOORE AND ASSOCIATES ENGINEERING AND CONSULTING. THE UNAUTHORIZED REPRODUCTION, COPYING, OR OTHERWISE USE OF THIS DOCUMENT IS STRICTLY PROHIBITED AND ANY INFRINGEMENT THEREUPON MAY BE SUBJECT TO LEGAL ACTION.

EXPOSURE C (170 MPH)

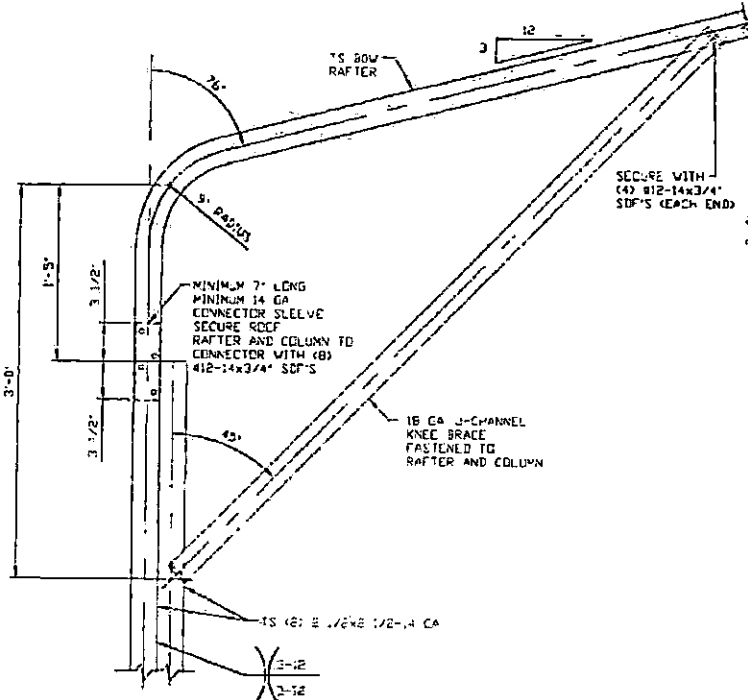

1A
BOX EAVE RAFTER COLUMN CONNECTION DETAIL FOR HEIGHTS 12'-0" < TO <= 14'-0"
 SCALE NTS

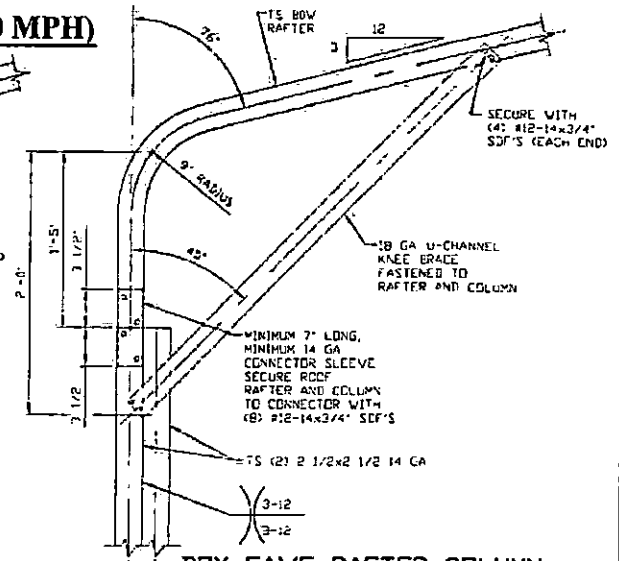

1B
BOX EAVE RAFTER COLUMN CONNECTION DETAIL FOR HEIGHTS 8'-0" < TO <= 12'-0"
 SCALE NTS

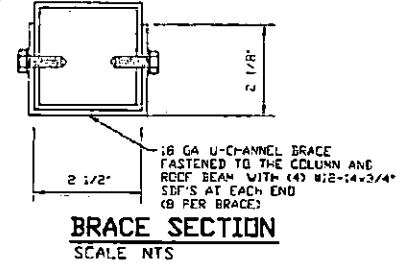

BRACE SECTION
 SCALE NTS

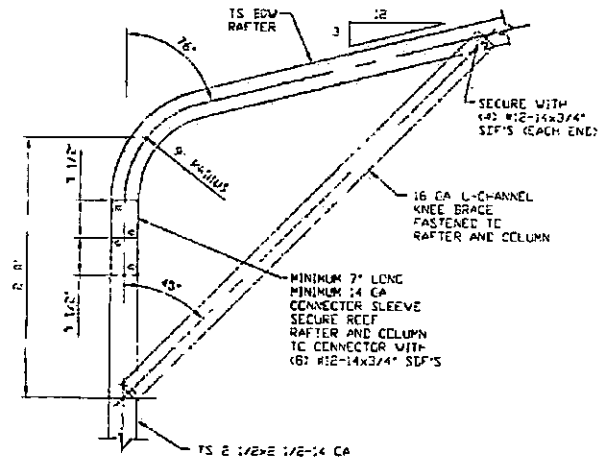

1C
BOX EAVE RAFTER COLUMN CONNECTION DETAIL FOR HEIGHTS <= 8'-0"
 SCALE NTS

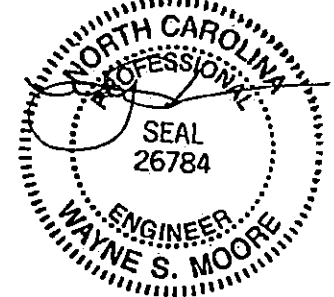
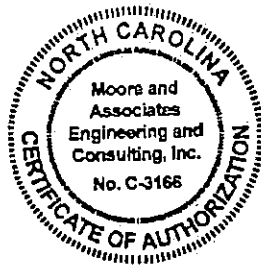

MAY 09 2018

MOORE AND ASSOCIATES ENGINEERING AND CONSULTING, INC.	DRAWN BY: JRS	CAROLINA CARPORTS, INC. 187 CARDINAL RIDGE TRAIL DOBSON, NC 27017 30'x20' ENCLOSED STRUCTURE		
	CHECKED BY: PJH	PROJECT MGR: WSM	DATE: 1-15-18	SCALE: NTS
THIS DOCUMENT IS THE PROPERTY OF MOORE AND ASSOCIATES ENGINEERING AND CONSULTING. UNAUTHORIZED REPRODUCTION, COPYING, OR OTHERWISE USE OF THIS DOCUMENT IS STRICTLY PROHIBITED AND ANY INFRINGEMENT THEREUPON MAY BE SUBJECT TO LEGAL ACTION.	CLIENT: CAROLINA CARPORTS	SHT. 7C	DWG. NO: SK-3	JOB NO: 15156S 16135S 17324S REV: 7

BASE RAIL ANCHORAGE OPTIONS

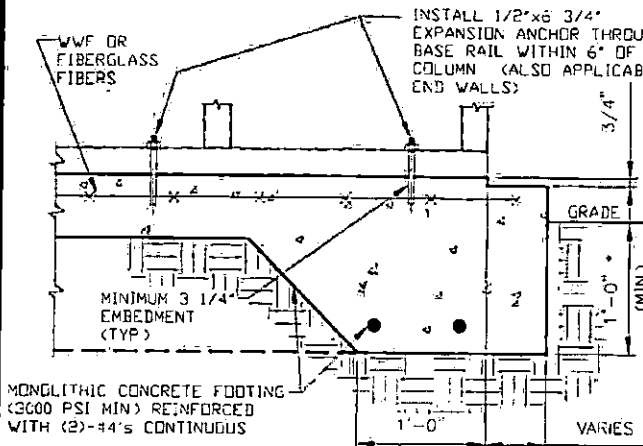

3A

CONCRETE MONOLITHIC SLAB BASE RAIL ANCHORAGE

SCALE NTS
(MINIMUM ANCHOR EDGE DISTANCE IS 4")
* COORDINATE WITH LOCAL CODES/ORD

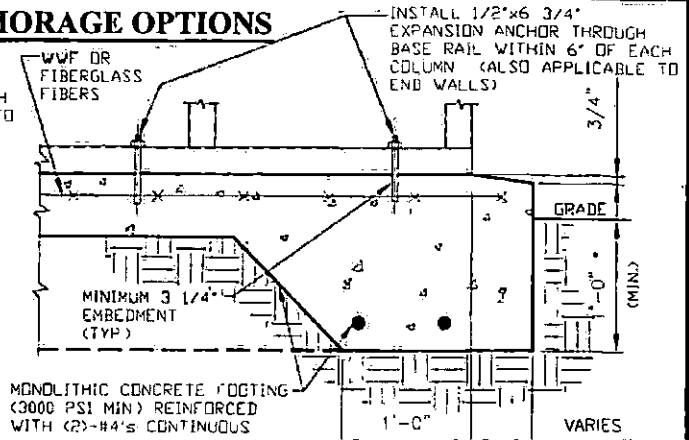

3B

CONCRETE MONOLITHIC SLAB BASE RAIL ANCHORAGE

SCALE NTS
(MINIMUM ANCHOR EDGE DISTANCE IS 4")
* COORDINATE WITH LOCAL CODES/ORD

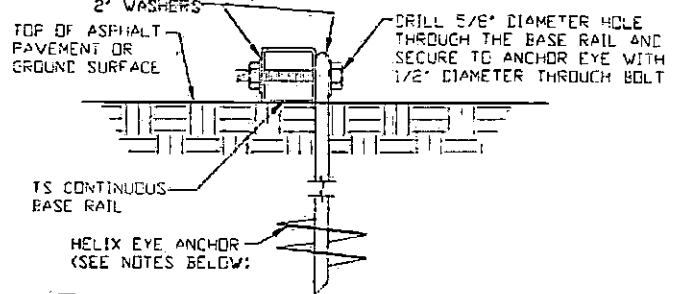

3C

GROUND BASE HELIX ANCHORAGE

SCALE NTS (CAN BE USED FOR ASPHALT)

GENERAL NOTES

CONCRETE:

CONCRETE SHALL HAVE A MINIMUM SPECIFIED COMPRESSIVE STRENGTH OF 3,000 PSI AT 28 DAYS

COVER OVER REINFORCING STEEL:

FOR FOUNDATIONS MINIMUM CONCRETE COVER OVER REINFORCING BARS SHALL BE PER ACI-318
3" IN FOUNDATIONS WHERE THE CONCRETE IS CAST AGAINST AND PERMANENTLY IN CONTACT WITH THE EARTH OR EXPOSED TO THE EARTH OR WEATHER, AND 1 1/2" ELSEWHERE

REINFORCING STEEL:

THE TURNDOWN REINFORCING STEEL SHALL BE ASTM A615 GRADE 60 THE SLAB REINFORCEMENT SHALL BE WELDED WIRE FABRIC MEETING ASTM A185 OR FIBERGLASS FIBER REINFORCEMENT

REINFORCEMENT MAY BE BENT IN THE SHOP OR THE FIELD PROVIDED:

- 1 REINFORCEMENT IS BENT COLD
- 2 THE DIAMETER OF THE BEND MEASURED ON THE INSIDE OF THE BAR IS NOT LESS THAN SIX-BAR DIAMETERS
- 3 REINFORCEMENT PARTIALLY EMBEDDED IN CONCRETE SHALL NOT BE FIELD BENT

HELIX ANCHOR NOTES:

- 1 FOR VERY DENSE AND/OR CEMENTED SANDS COARSE GRAVEL AND COBBLES CALICHE PRELATERED SILTS AND CLAYS USE MINIMUM (2) 4" HELICES WITH MINIMUM 30" EMBEDMENT OR SINGLE 6" HELIX WITH MINIMUM 50" EMBEDMENT
- 2 FOR CORAL USE MINIMUM (2) 4" HELICES WITH MINIMUM 30" EMBEDMENT OR SINGLE 6" HELIX WITH MINIMUM 50" EMBEDMENT
- 3 FOR MEDIUM DENSE COARSE SANDS SANDY GRAVELS VERY STIFF SILTS AND CLAYS USE MINIMUM (2) 4" HELICES WITH MINIMUM 30 INCH EMBEDMENT OR SINGLE 6" HELIX WITH MINIMUM 50" EMBEDMENT
- 4 FOR LOOSE TO MEDIUM DENSE SANDS FIRM TO STIFF CLAYS AND SILTS ALLUVIAL FILL USE MINIMUM (2) 6" HELICES WITH MINIMUM 50" EMBEDMENT
- 5 FOR VERY LOSE TO MEDIUM DENSE SANDS FIRM TO STIFFER CLAYS AND SILTS ALLUVIAL FILL USE MINIMUM (2) 8" HELICES WITH MINIMUM 60" EMBEDMENT

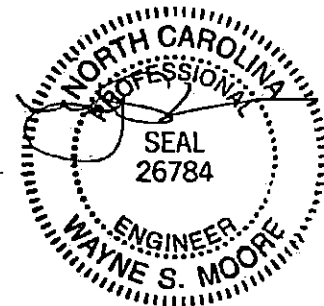
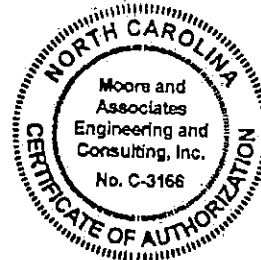

MAY 09 2018

**MOORE AND ASSOCIATES
ENGINEERING AND CONSULTING, INC.**

DRAWN BY: JRS

CHECKED BY: PDH

PROJECT MGR: WSM

CLIENT: CAROLINA
CARPORTS

DATE: 1-15-18

SHT. 8

CAROLINA CARPORTS, INC.
187 CARDINAL RIDGE TRAIL
DOBSON, NC 27017
30'x20' ENCLOSED STRUCTURE

SCALE: NTS

DWG. NO: SK-3

JOB NO: 15156S 1613SS
17324S

REV. 7

THIS DOCUMENT IS THE PROPERTY OF MOORE AND ASSOCIATES ENGINEERING AND CONSULTING. THE UNAUTHORIZED REPRODUCTION, COPYING, OR OTHERWISE USE OF THIS DOCUMENT IS STRICTLY PROHIBITED AND ANY INFRINGEMENT THEREUPON MAY BE SUBJECT TO LEGAL ACTION.

BOX EAVE RAFTER END WALL AND SIDE WALL OPENINGS

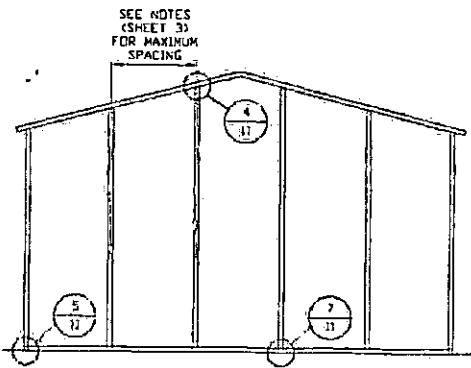

**TYPICAL BOX EAVE RAFTER
END WALL FRAMING SECTION**
SCALE: NTS

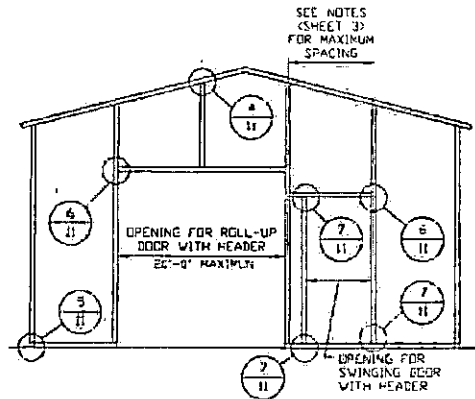

**TYPICAL BOX EAVE RAFTER END
WALL OPENINGS FRAMING SECTION**
SCALE: NTS

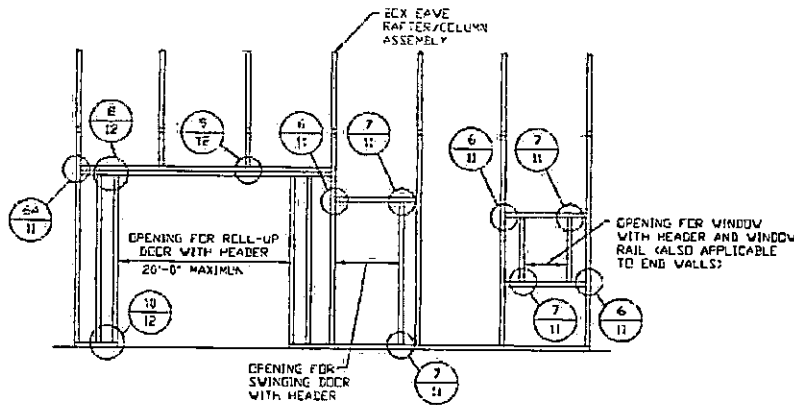

**TYPICAL BOX EAVE RAFTER
SIDE WALL OPENINGS FRAMING SECTION**
SCALE: NTS

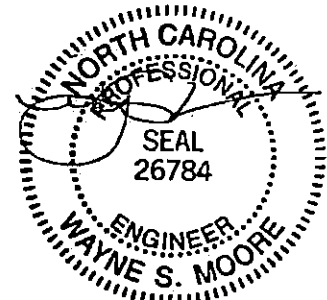

MAY 09 2018

**MOORE AND ASSOCIATES
ENGINEERING AND CONSULTING, INC.**

DRAWN BY: JRS

CHECKED BY: PDH

PROJECT: HGR VSM

**CLIENT: CAROLINA
CARPORTS**

**CAROLINA CARPORTS, INC.
187 CARDINAL RIDGE TRAIL
DOBSON, NC 27017
30'x20' ENCLOSED STRUCTURE**

DATE: 1-15-18

SHT. 9

SCALE: NTS

DWG. NO. SK-3

**JOB NO. 15156S 16135S
17324S**

REV. 7

THIS DOCUMENT IS THE PROPERTY OF MOORE AND ASSOCIATES ENGINEERING AND CONSULTING. THE UNAUTHORIZED REPRODUCTION, COPYING, OR OTHERWISE USE OF THIS DOCUMENT IS STRICTLY PROHIBITED AND ANY INFRINGEMENT THEREUPON MAY BE SUBJECT TO LEGAL ACTION.

BOW RAFTER END WALL AND SIDE WALL OPENINGS

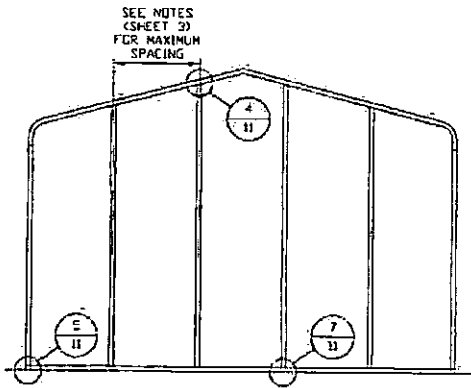

**TYPICAL BOW RAFTER
END WALL FRAMING SECTION**
SCALE: NTS

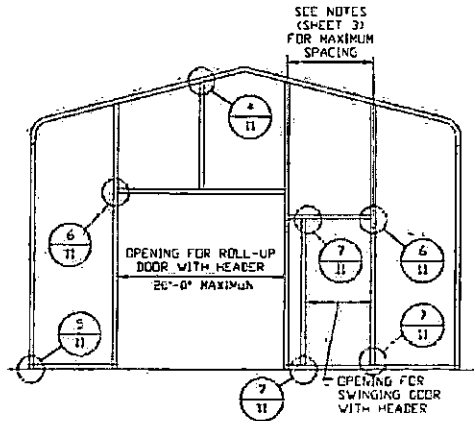

**TYPICAL BOW RAFTER END
WALL OPENINGS FRAMING SECTION**
SCALE: NTS

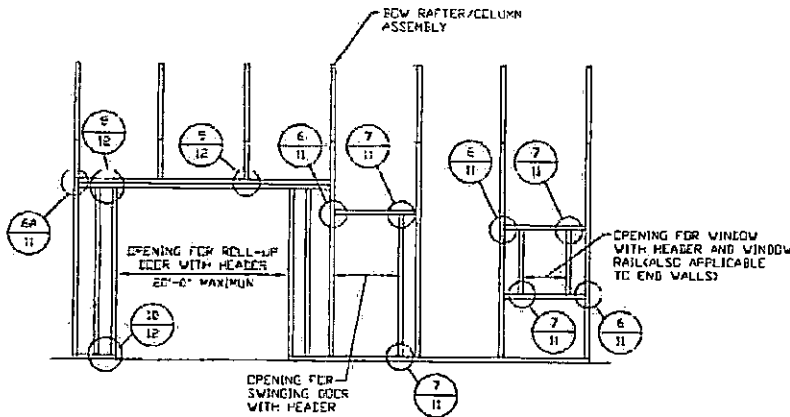

**TYPICAL BOW RAFTER SIDE
WALL OPENINGS FRAMING SECTION**
SCALE: NTS

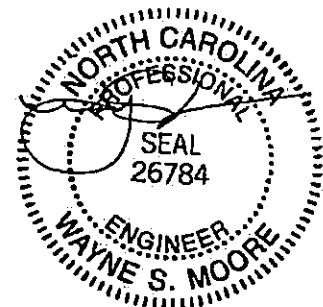
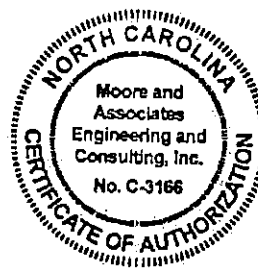

MAY 09 2018

**MOORE AND ASSOCIATES
ENGINEERING AND CONSULTING, INC.**

DRAWN BY: JRS

CHECKED BY: PDH

PROJECT MGR: WSM

CLIENT: CAROLINA
CARPORTS

CAROLINA CARPORTS, INC.
187 CARDINAL RIDGE TRAIL
DOBSON, NC 27017
30'x20' ENCLOSED STRUCTURE

DATE: 1-15-18

SHT. 10

SCALE: NTS

DRG. NO: SK-3

JOB NO: 151563 161355
173245

REV: 7

THIS DOCUMENT IS THE PROPERTY OF MOORE AND ASSOCIATES ENGINEERING AND CONSULTING. THE UNAUTHORIZED REPRODUCTION, COPYING, OR OTHERWISE USE OF THIS DOCUMENT IS STRICTLY PROHIBITED AND ANY INFRINGEMENT THEREUPON MAY BE SUBJECT TO LEGAL ACTION.

BOW AND BOX EAVE RAFTER WALL OPENING DETAILS

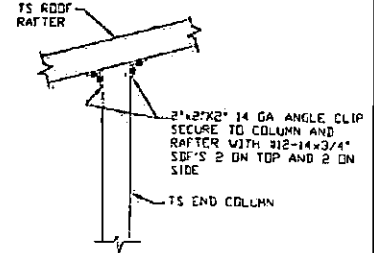
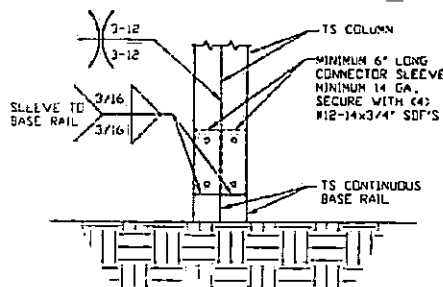
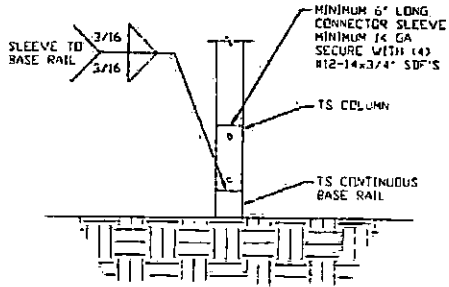

2 RAFTER COLUMN/BASE RAIL CONNECTION DETAIL
SCALE: NTS

2A RAFTER COLUMN/BASE RAIL CONNECTION DETAIL
SCALE: NTS

4 END COLUMN/RAFTER CONNECTION DETAIL
SCALE: NTS

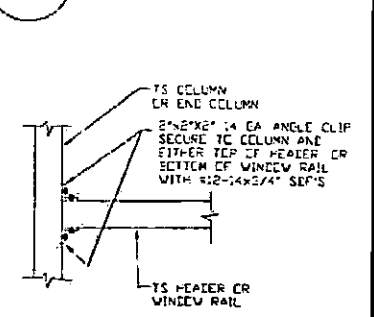
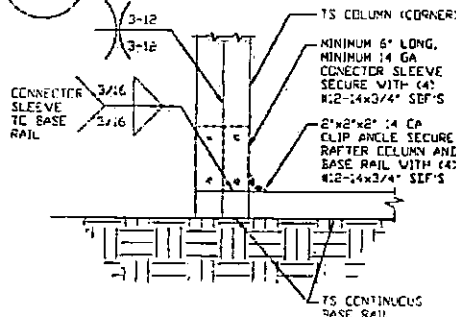
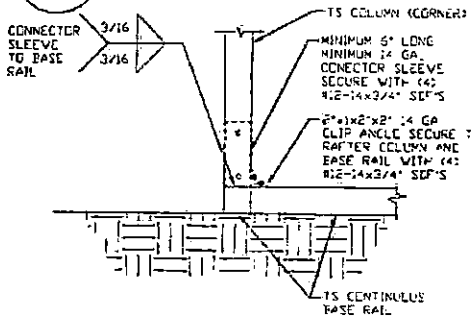

5 END COLUMN/BASE RAIL CONNECTION DETAIL
SCALE: NTS

5A END COLUMN/BASE RAIL CONNECTION DETAIL
SCALE: NTS

6 COLUMN OR WINDOW RAIL TO POST CONNECTION DETAIL
SCALE: NTS

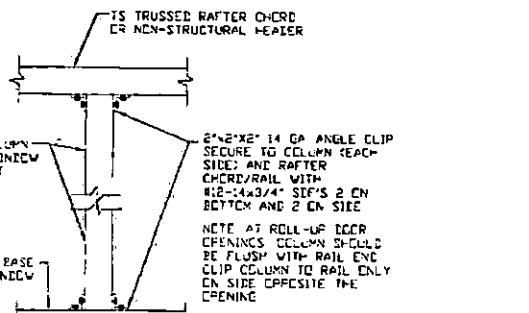
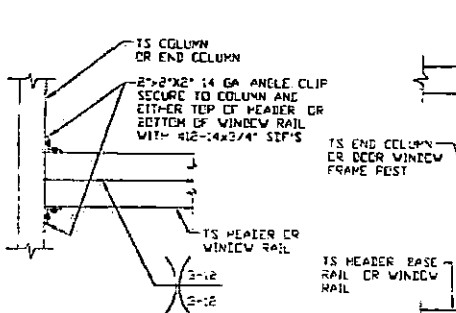

6A COLUMN OR WINDOW RAIL TO POST CONNECTION DETAIL
SCALE: NTS

7 COLUMN TO HEADER, BASE RAIL, OR WINDOW RAIL CONNECTION DETAIL
SCALE: NTS

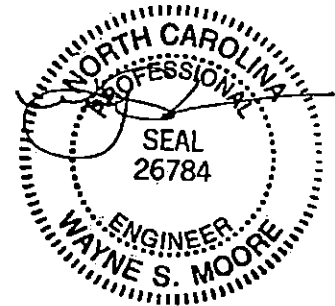
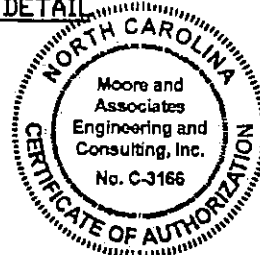

MAY 09 2018

MOORE AND ASSOCIATES
ENGINEERING AND CONSULTING, INC.

DRAWN BY: JRS
CHECKED BY: PDH

CAROLINA CARPORTS, INC.
187 CARDINAL RIDGE TRAIL
DOBSON, NC 27017
30'x20' ENCLOSED STRUCTURE

THIS DOCUMENT IS THE PROPERTY OF MOORE AND ASSOCIATES ENGINEERING AND CONSULTING. THE UNAUTHORIZED REPRODUCTION, COPYING, OR OTHERWISE USE OF THIS DOCUMENT IS STRICTLY PROHIBITED AND ANY INFRINGEMENT THEREUPON MAY BE SUBJECT TO LEGAL ACTION.

PROJECT MGR: WSM	DATE: 1-15-18	SCALE: NTS	JOB NO: 15156S 16135S 17324S
CLIENT: CAROLINA CARPORTS	SHT. 11	DWG. NO: SK-3	REV: 7

BOW AND BOX EAVE RAFTER WALL OPENING DETAILS

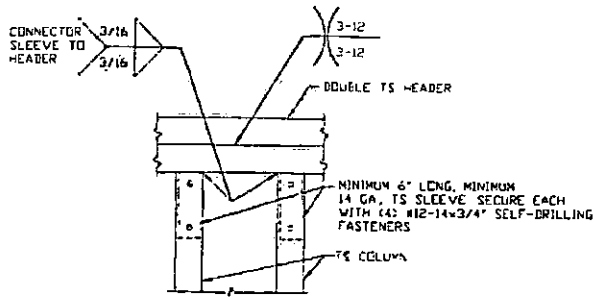

8 DOUBLE HEADER/COLUMN CONNECTION DETAIL
SCALE: NTS

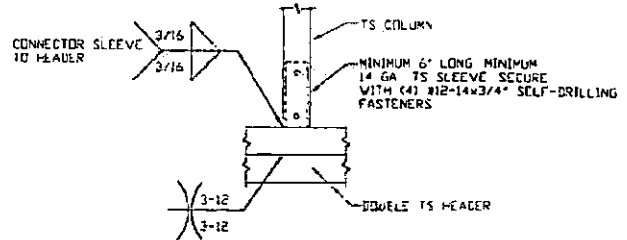

9 COLUMN/DOUBLE HEADER CONNECTION DETAIL
SCALE: NTS

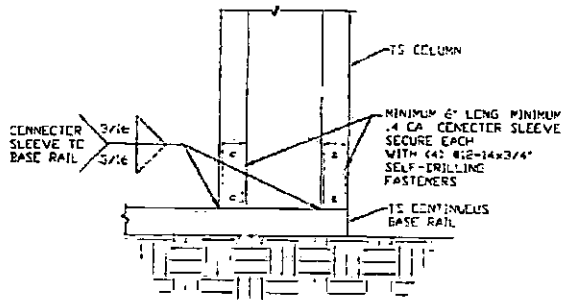

10 COLUMN/BASE RAIL CONNECTION DETAIL
SCALE: NTS

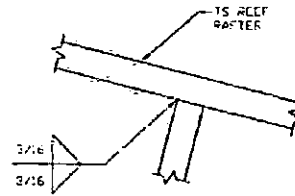

11 RAFTER TO CHORD CONNECTION DETAIL
SCALE: NTS

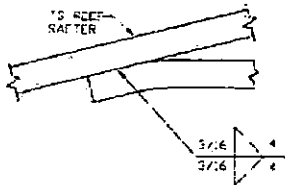

12 COLLAR TIE CONNECTION DETAIL
SCALE: NTS

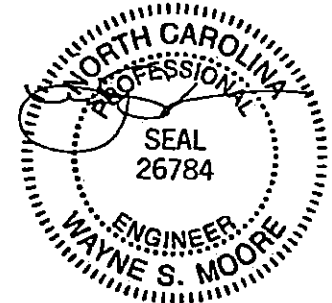
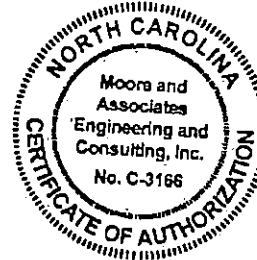

MAY 0 9 2018

MOORE AND ASSOCIATES ENGINEERING AND CONSULTING, INC.	DRAWN BY: JRS	CAROLINA CARPORTS, INC. 187 CARDINAL RIDGE TRAIL DOBSON, NC 27017 30'x20' ENCLOSED STRUCTURE		
	CHECKED BY: PJH			
THIS DOCUMENT IS THE PROPERTY OF MOORE AND ASSOCIATES ENGINEERING AND CONSULTING. THE UNAUTHORIZED REPRODUCTION, COPYING, OR OTHERWISE USE OF THIS DOCUMENT IS STRICTLY PROHIBITED AND ANY INFRINGEMENT THEREUPON MAY BE SUBJECT TO LEGAL ACTION.	PROJECT MGR: VSM	DATE: 1-15-18	SCALE: NTS	JOB NO: 15156S 16135S 17324S
	CLIENT: CAROLINA CARPORTS	SHT. 12	DWG. NO: SK-3	REV. 7

BOW RAFTER LEAN-TO OPTION

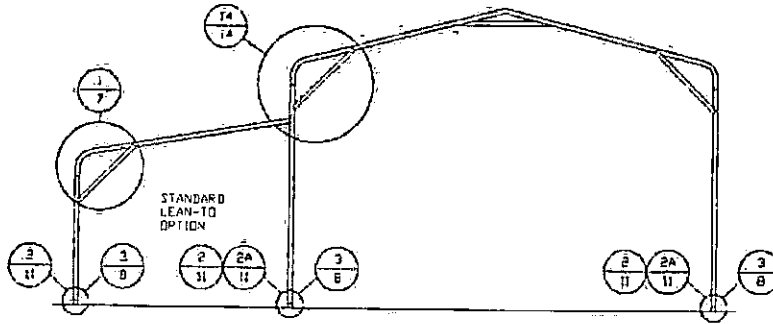

TYPICAL BOW RAFTER LEAN-TO OPTION FRAMING SECTION

SCALE: NTS

MINIMUM WIDTH OF STANDARD LEAN-TO/ROOF EXTENSION IS 12'-0"

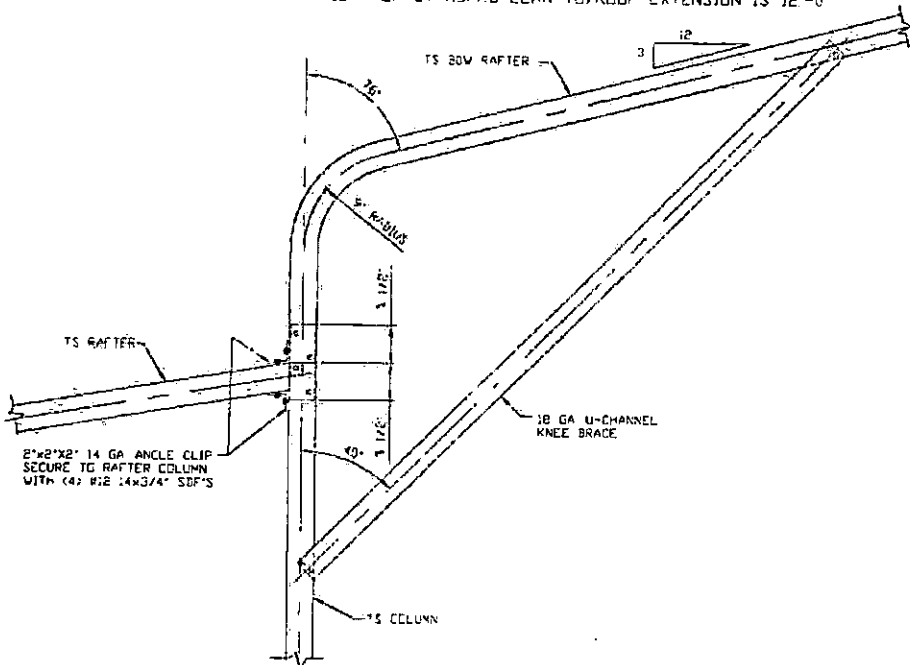

LEAN-TO RAFTER TO RAFTER COLUMN CONNECTION DETAIL

14

SCALE: NTS

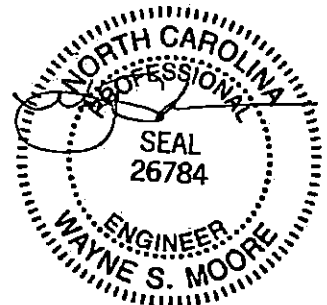
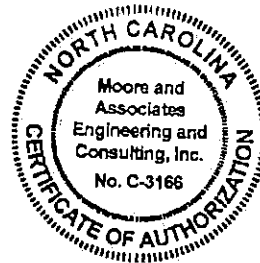

MAY 09 2018

MOORE AND ASSOCIATES
ENGINEERING AND CONSULTING, INC.

DRAWN BY: JRS

CHECKED BY: PDH

PROJECT MGR: VSM

CLIENT: CAROLINA
CARPORTS

CAROLINA CARPORTS, INC.
187 CARDINAL RIDGE TRAIL
DOBSON, NC 27017
30'x20' ENCLOSED STRUCTURE

DATE: 1-15-18

SHT. 14

SCALE: NTS

DWG. NO: SK-3

JOB NO: 151565, 161355
173245

REV: 7

THIS DOCUMENT IS THE PROPERTY OF MOORE AND ASSOCIATES ENGINEERING AND CONSULTING. THE UNAUTHORIZED REPRODUCTION, COPYING, OR OTHERWISE USE OF THIS DOCUMENT IS STRICTLY PROHIBITED AND ANY INFRACTION THEREUPON MAY BE SUBJECT TO LEGAL ACTION.

BOX EAVE RAFTER VERTICAL ROOF/SIDING OPTION

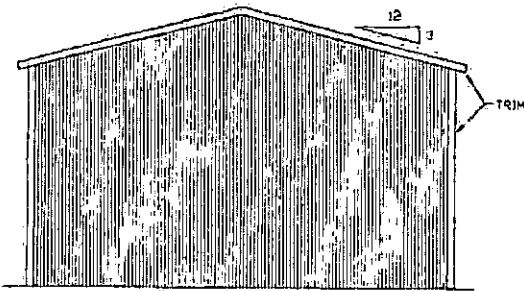

**TYPICAL END ELEVATION
VERTICAL ROOF/SIDING**

SCALE: NTS

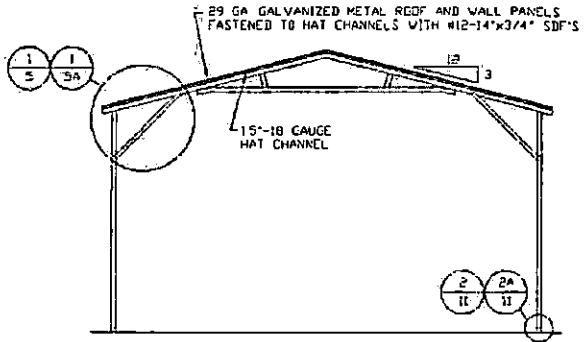

**TYPICAL SECTION
VERTICAL ROOF/SIDING OPTION**

SCALE: NTS

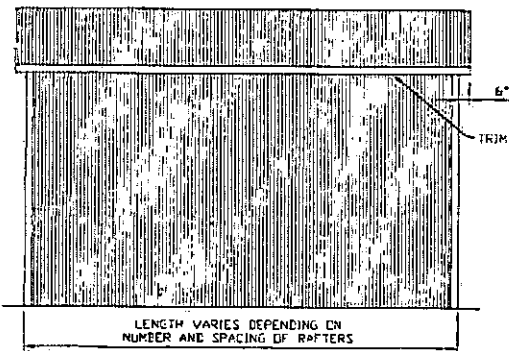

**TYPICAL SIDE ELEVATION
VERTICAL ROOF/SIDING**

SCALE: NTS

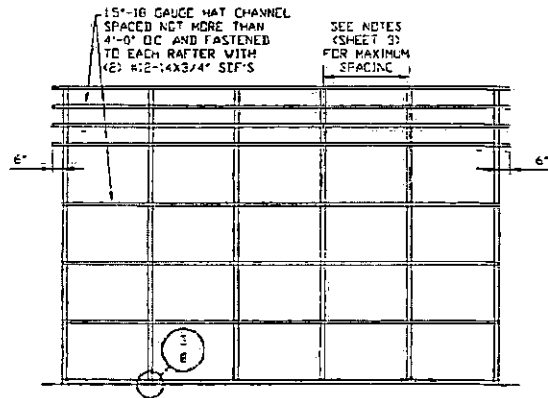

**TYPICAL FRAMING SECTION
VERTICAL ROOF/SIDING OPTION**

SCALE: NTS

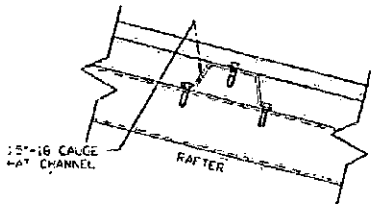

PANEL ATTACHMENT

(ALTERNATE FOR VERTICAL ROOF PANELS)
SCALE: NTS

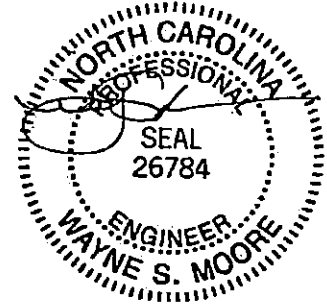
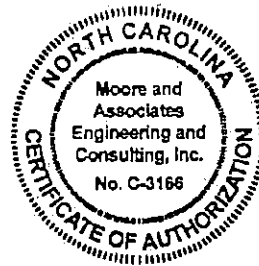

MAY 09 2018

**MOORE AND ASSOCIATES
ENGINEERING AND CONSULTING, INC.**

DRAWN BY: JRS

CHECKED BY: PDM

PROJECT MGR: VSM

CLIENT: CAROLINA
CARPORTS

CAROLINA CARPORTS, INC.
187 CARDINAL RIDGE TRAIL
DOBSON, NC 27017
30'x20' ENCLOSED STRUCTURE

DATE: 1-15-18

SHT. 15

SCALE: NTS

DWG. NO SK-3

JOB NO: 15196S 16135S
17324S

REV: 7

THIS DOCUMENT IS THE PROPERTY OF MOORE AND ASSOCIATES ENGINEERING AND CONSULTING. THE UNAUTHORIZED REPRODUCTION, COPYING, OR OTHERWISE USE OF THIS DOCUMENT IS STRICTLY PROHIBITED AND ANY INFRINGEMENT THEREUPON MAY BE SUBJECT TO LEGAL ACTION.

BASE RAIL ON GRADE APPLICATION

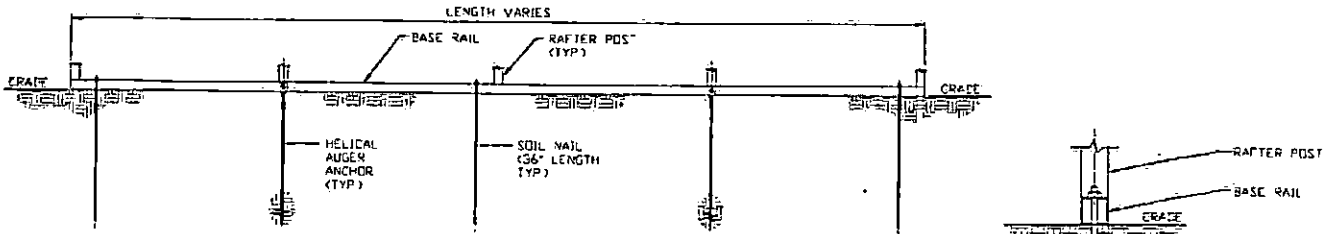

SECTION 2
SCALE: NTS

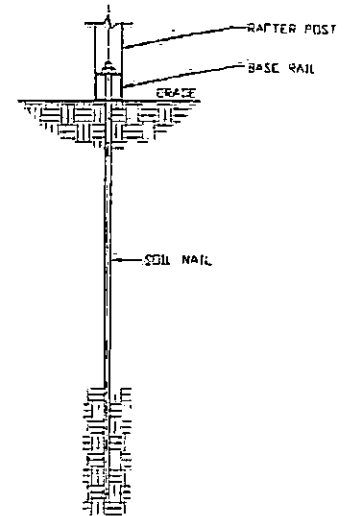

SECTION 1
SCALE: NTS

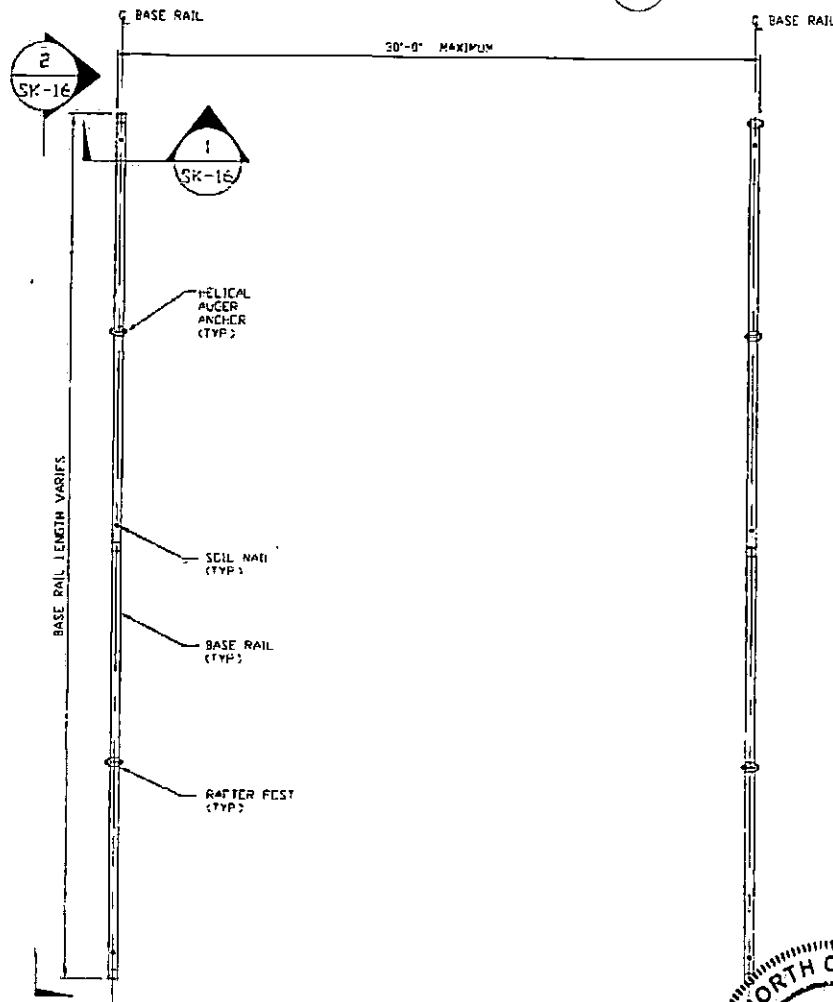

BASE RAIL PLAN
SCALE: NTS

HELIX ANCHOR	
SIDE LENGTH	SPACING
20'	20'
25'	25' NOTE 2
30'	10' (EVERY OTHER POST)

- NOTES
- 1: INSTALLATION OF SOIL NAILS OR EXPANSION ANCHORS ALSO APPLY TO END WALLS
 - 2: FOR EXPOSURE C USE 10' SPACING (EVERY OTHER POST)

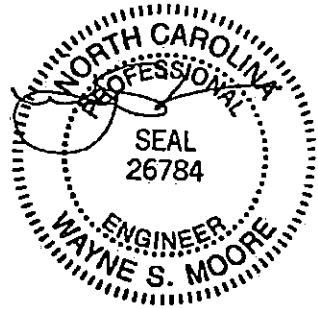
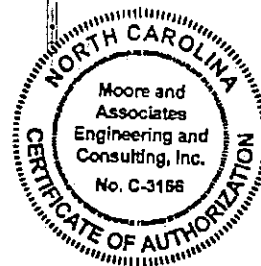

MAY 09 2018

MOORE AND ASSOCIATES ENGINEERING AND CONSULTING, INC.	DRAWN BY: JRS	CAROLINA CARPORTS, INC. 187 CARDINAL RIDGE TRAIL DOBSON, NC 27017 30'x20' ENCLOSED STRUCTURE		
	CHECKED BY: PDH	PROJECT MGR: VSM	DATE: 1-15-18	SCALE: NTS
THIS DOCUMENT IS THE PROPERTY OF MOORE AND ASSOCIATES ENGINEERING AND CONSULTING. THE UNAUTHORIZED REPRODUCTION, COPYING, OR OTHERWISE USE OF THIS DOCUMENT IS STRICTLY PROHIBITED AND ANY INFRINGEMENT THEREUPON MAY BE SUBJECT TO LEGAL ACTION.	CLIENT: CAROLINA CARPORTS	SHT. 16	DWG. NO: SK-3	JOB NO: 15156S 16135S 17324S REV: 7

OPTIONAL BASE RAIL ON TIMBER BEAM

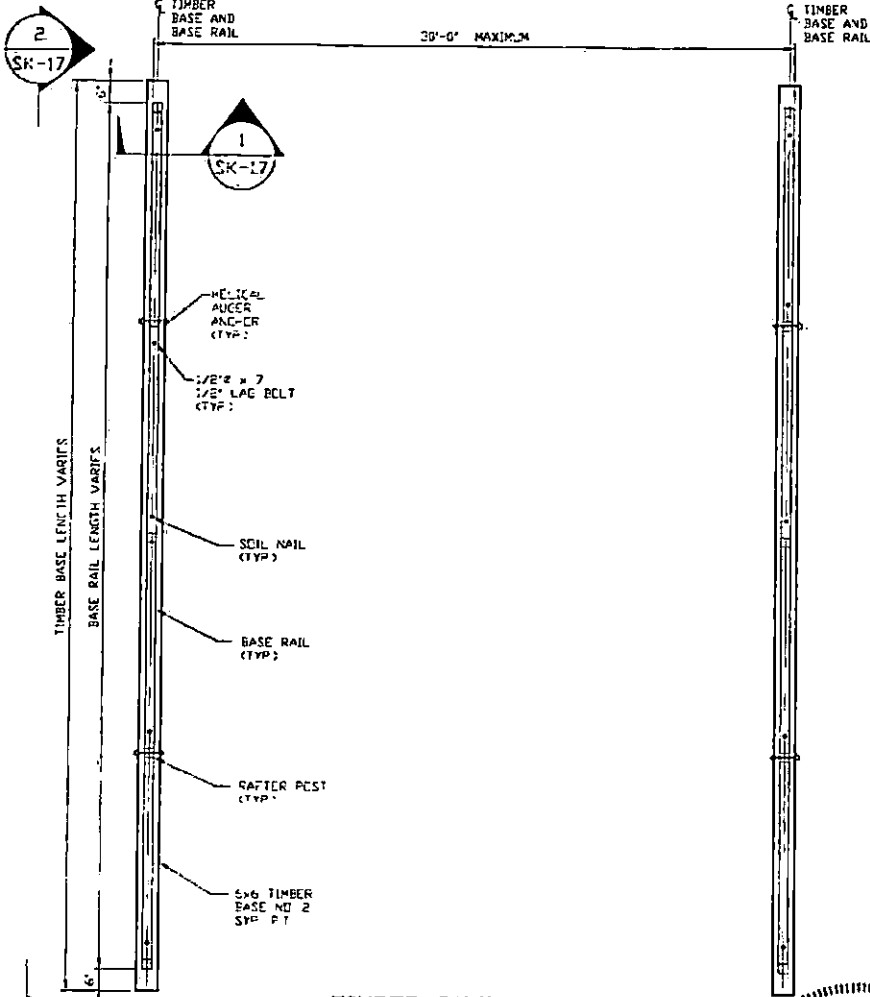
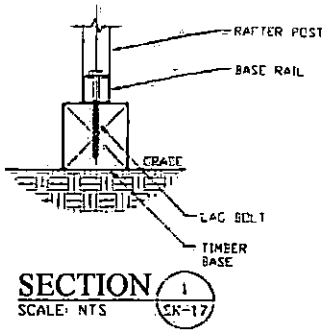
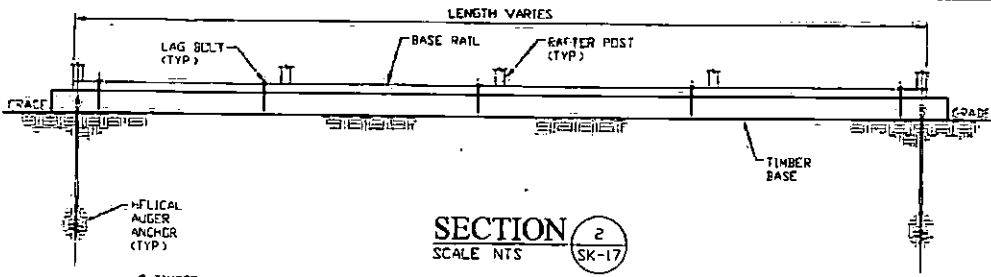

TIMBER FOOTING PLAN
SCALE NTS

HELIX ANCHOR	
SIDE LENGTH	SPACING
20'	20'
25'	25' NOTE 2
30'	10' (EVERY OTHER POST)

- NOTES
- 1 INSTALLATION OF SOIL NAILS OR EXPANSION ANCHORS ALSO APPLY TO END WALLS
 - 2 FOR EXPOSURE C USE 10' SPACING (EVERY OTHER POST)

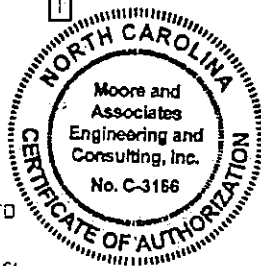

MAY 09 2018

MOORE AND ASSOCIATES ENGINEERING AND CONSULTING, INC.	DRAWN BY: JRS	CAROLINA CARPORTS, INC. 187 CARDINAL RIDGE TRAIL DOBSON, NC 27017 30'x20' ENCLOSED STRUCTURE		
	CHECKED BY: PDH	DATE: 1-15-18	SCALE: NTS	JOB NO: 15156S 16135S 17324S
THIS DOCUMENT IS THE PROPERTY OF MOORE AND ASSOCIATES ENGINEERING AND CONSULTING. THE UNAUTHORIZED REPRODUCTION, COPYING, OR OTHERWISE USE OF THIS DOCUMENT IS STRICTLY PROHIBITED AND ANY INFRINGEMENT THEREUPON MAY BE SUBJECT TO LEGAL ACTION.	PROJECT MGR: VSM	CLIENT: CAROLINA CARPORTS	SHT. 17	DWG. NO: SK-3 REV: 7

OPTIONAL BASE RAIL ON TIMBER BEAM WITH SOIL NAIL

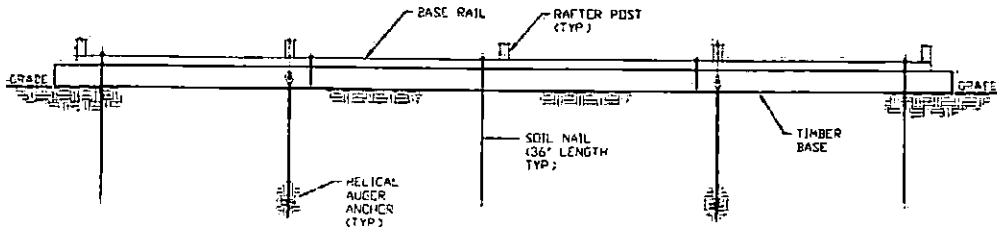

SECTION 2
SCALE: NTS
SK-18

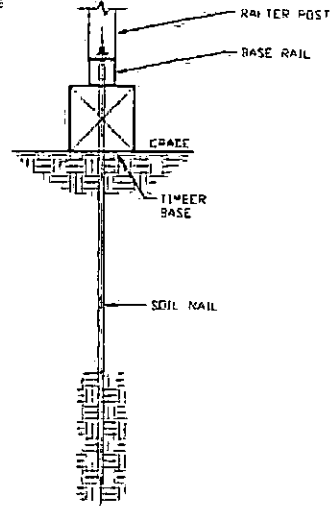

SECTION 1
SCALE: NTS
SK-18

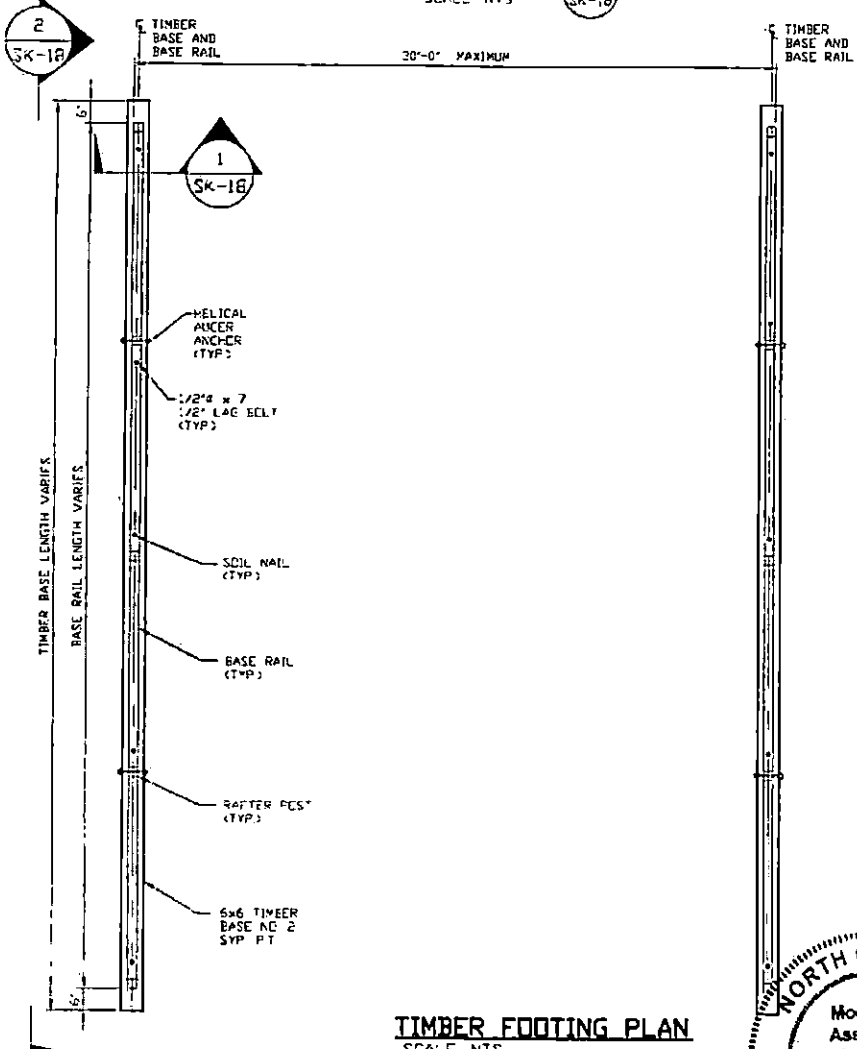

TIMBER FOOTING PLAN
SCALE: NTS

HELIX ANCHOR	
SIDE LENGTH	SPACING
20'	20'
25'	25' NOTE 2
30'	10' (EVERY OTHER POST)

- NOTES
1. INSTALLATION OF SOIL NAILS OR EXPANSION ANCHORS ALSO APPLY TO END WALLS
 2. FOR EXPOSURE C USE 10' SPACING (EVERY OTHER POST)

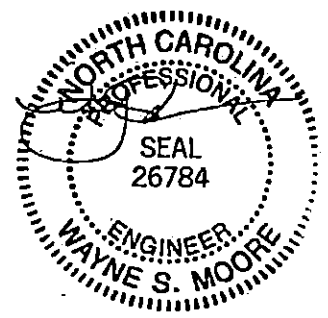
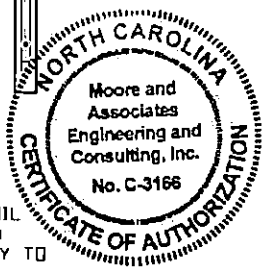

MAY 09 2018

MOORE AND ASSOCIATES ENGINEERING AND CONSULTING, INC.	DRAWN BY: JRS	CAROLINA CARPORTS, INC. 187 CARDINAL RIDGE TRAIL DOBSON, NC 27017 30'x20' ENCLOSED STRUCTURE		
	CHECKED BY: PDH	DATE: 1-15-18	SCALE: NTS	JOB NO: 15156S 16135S 17324S
THIS DOCUMENT IS THE PROPERTY OF MOORE AND ASSOCIATES ENGINEERING AND CONSULTING. THE UNAUTHORIZED REPRODUCTION, COPYING, OR OTHERWISE USE OF THIS DOCUMENT IS STRICTLY PROHIBITED AND ANY INFRINGEMENT THEREUPON MAY BE SUBJECT TO LEGAL ACTION.	PROJECT MGR: VSM	DATE: 1-15-18	SCALE: NTS	JOB NO: 15156S 16135S 17324S
	CLIENT: CAROLINA CARPORTS	SHT. 18	DRG. NO: SK-3	REV: 7

OPTIONAL CONCRETE STRIP FOOTING

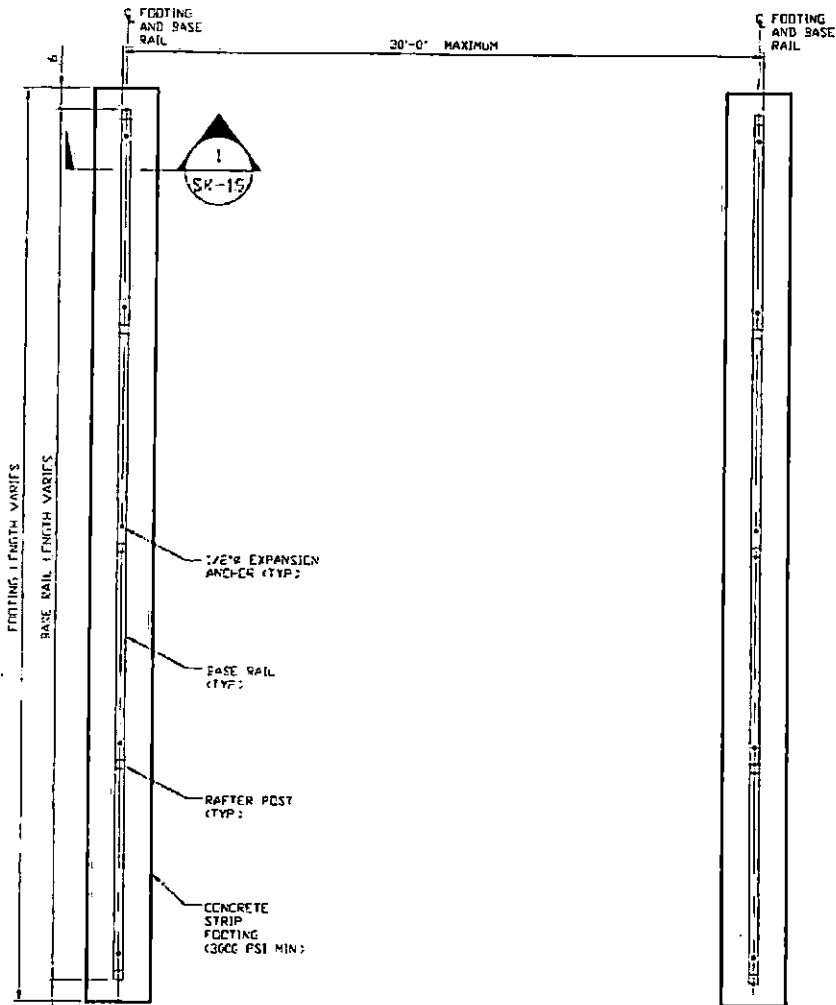

CONCRETE STRIP FOOTING PLAN
SCALE: NTS

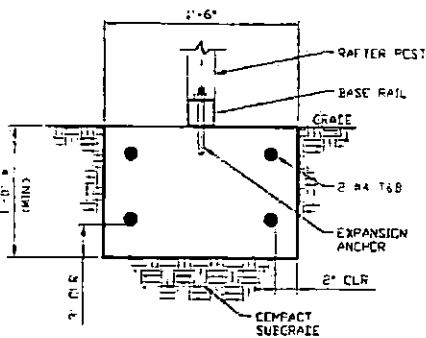

SECTION
SCALE: NTS

► COORDINATE WITH LOCAL CODES/ORD

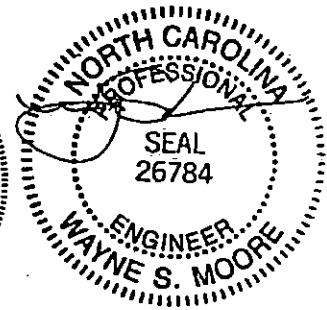
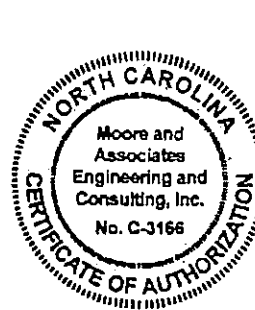

MAY 09 2018

**MOORE AND ASSOCIATES
ENGINEERING AND CONSULTING, INC.**

DRAWN BY: JRS
CHECKED BY: PDH

CAROLINA CARPORTS, INC.
187 CARDINAL RIDGE TRAIL
DOBSON, NC 27017
30'x20' ENCLOSED STRUCTURE

THIS DOCUMENT IS THE PROPERTY OF MOORE AND ASSOCIATES ENGINEERING AND CONSULTING. THE UNAUTHORIZED REPRODUCTION, COPYING, OR OTHERWISE USE OF THIS DOCUMENT IS STRICTLY PROHIBITED AND ANY INFRINGEMENT THEREUPON MAY BE SUBJECT TO LEGAL ACTION.

PROJECT MGR: WSM	DATE: 1-15-18	SCALE: NTS	JOB NO: 15156S 16135S 17324S
CLIENT: CAROLINA CARPORTS	SHT. 19	DWG. NO: SK-3	REV: 7

OPTIONAL HEADER

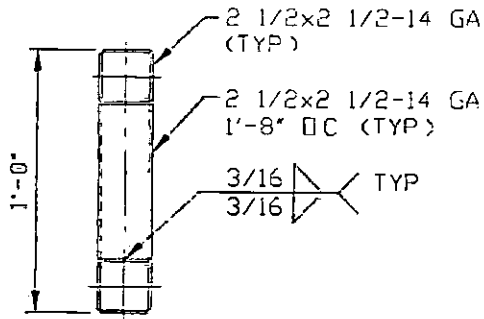

HEADER DETAIL FOR OPENINGS
12'-0" ≤ LENGTH ≤ 20'-0"
 SCALE NTS

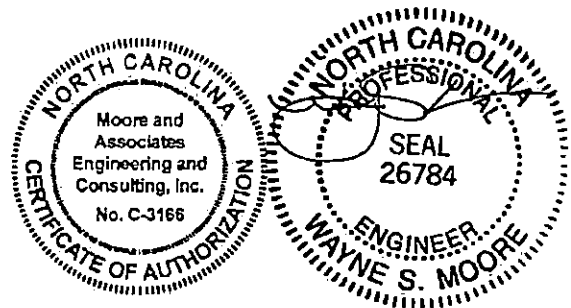

MAY 09 2018

MOORE AND ASSOCIATES ENGINEERING AND CONSULTING, INC.	DRAWN BY: JRS	CAROLINA CARPORTS, INC. 187 CARDINAL RIDGE TRAIL DOBSON, NC 27017 30'x20' ENCLOSED STRUCTURE		
	CHECKED BY: PDH			
THIS DOCUMENT IS THE PROPERTY OF MOORE AND ASSOCIATES ENGINEERING AND CONSULTING. THE UNAUTHORIZED REPRODUCTION, COPYING, OR OTHERWISE USE OF THIS DOCUMENT IS STRICTLY PROHIBITED AND ANY INFRINGEMENT THEREUPON MAY BE SUBJECT TO LEGAL ACTION.	PROJECT NGR: VSM	DATE: 1-15-18	SCALE: NTS	JOB NO: 15156S 16135S 17324S
	CLIENT: CAROLINA CARPORTS	SHT. 20	DWG NO SK-3	REV. 7