

WINDOW SCHEDULE
SECOND FLOOR

(1)	1'-8" x 4'-6" DH - 4'-0" x 6'-6" Fixed Circle Head - 1'-8" x 4'-6" DH
(1)	Triple - 3'-0" x 4'-6" DH
(2)	Triple - 2'-8" x 4'-6" DH
(1)	Twin 2'-4" x 5'-2" DH
(1)	Twin 2'-8" x 5'-2" DH
(1)	Twin 3'-0" x 3'-10" DH
(1)	Twin 3'-0" x 4'-6" DH

DOOR SCHEDULE
SECOND FLOOR

(2)	3'-0" X 6'-8" RH with weather stripping and threshold
(1)	3'-0" X 6'-8" LH with weather stripping and threshold
(1)	2'-4" x 6'-8" RH
(1)	6'-0" x 6'-8" Double Hung
(2)	5'-0" x 6'-8" Double Hung
(1)	3'-0" x 6'-8" LH
(1)	4'-0" x 6'-8" Double Hung

SECOND FLOOR WALLS WILL BE 8' HIGH

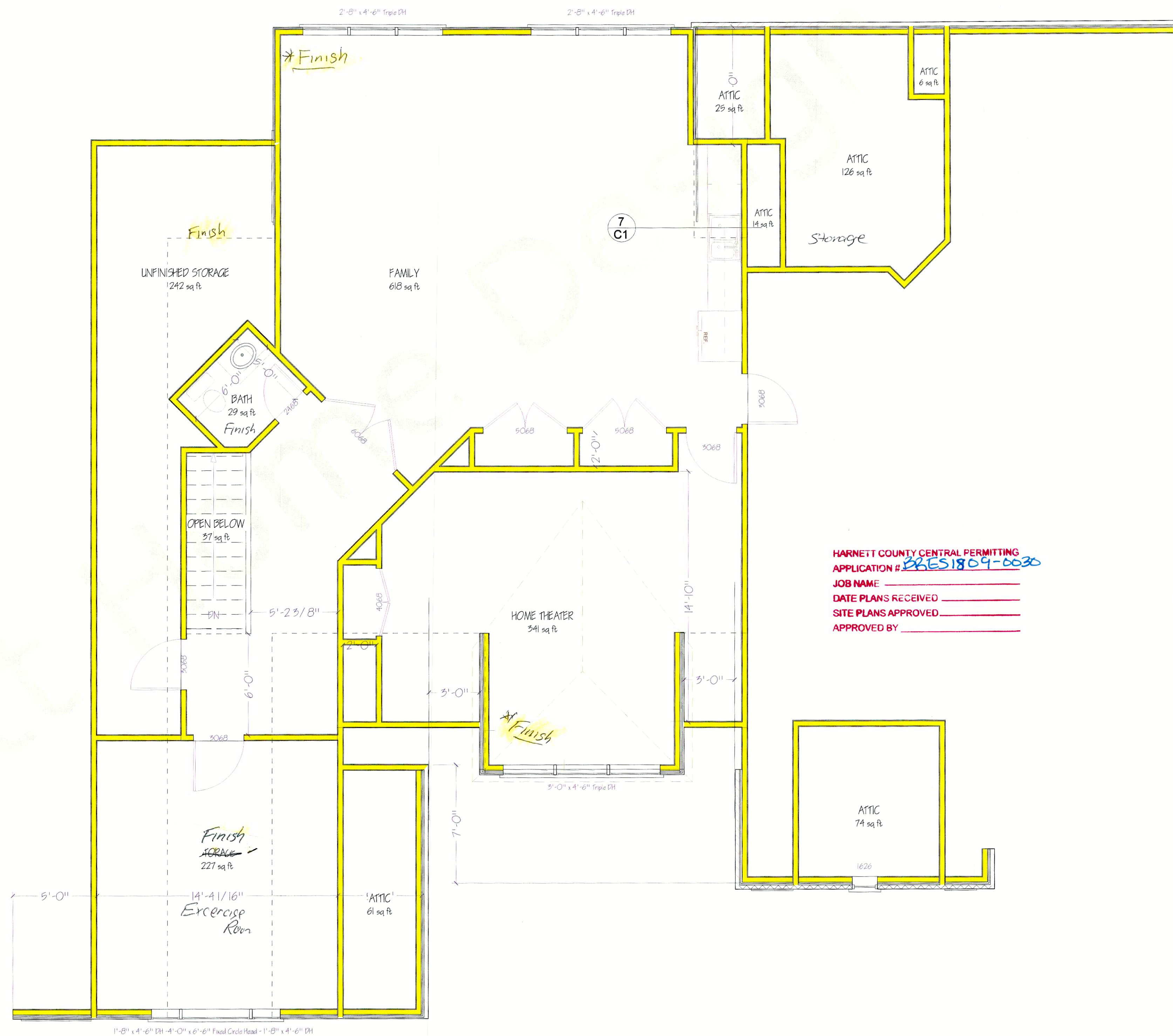

HARNETT COUNTY CENTRAL PERMITTING
APPLICATION # 28ES1809-0030
JOB NAME _____
DATE PLANS RECEIVED _____
SITE PLANS APPROVED _____
APPROVED BY _____

COPYRIGHT CORBETT HOME DESIGN 2007. ALL RIGHTS RESERVED.
REPRODUCTION OF THIS SHEET, IN WHOLE OR IN PART, IS STRICTLY PROHIBITED.
PLANS MAY BE USED ONCE BY CLIENT. UNAUTHORIZED USE IS STRICTLY PROHIBITED.
PLANS NOT VALID FOR CONSTRUCTION WITHOUT APPROPRIATE PROFESSIONAL SEALS.

GENERAL NOTES:
1. ALL DRAWINGS ARE TO BE COORDINATED WITH ALL SITE INFORMATION BY OWNER AND CONTRACTOR, AND APPLICABLE CODES.
2. CONTRACTOR IS TO NOTIFY DESIGNER IMMEDIATELY OF CONDITIONS OR ITEMS VARYING FROM DEPICTED INFORMATION.
3. CORBETT HOME DESIGN IS NOT RESPONSIBLE FOR CONSTRUCTED VARIATIONS FROM THE INFORMATION DEPICTED.

4. CORBETT HOME DESIGN WILL NOT ASSUME ANY LIABILITY FOR EXPENSES ASSOCIATED WITH ERRORS AND OMISSIONS ON THESE DRAWINGS UNLESS OFFSET BY VERIFIED CONSTRUCTION SAVINGS AS A RESULT OF CORBETT HOME DESIGN.
5. CORBETT HOME DESIGN RETAINS OWNERSHIP OF ALL DESIGNS DEPICTED AND IMPLIED HEREIN.
6. CORBETT HOME DESIGN IS NOT RESPONSIBLE FOR ESTIMATING, MAINTAINING, OR REGULATING CONSTRUCTION COSTS ASSOCIATED WITH THESE PLANS.



Designed by:
Barry Corbett
Corbett Home Design
183 Wind Chime Court
Suite 202
Raleigh, NC 27615
(919) 845-7987

New Home Plans for:
Lloyd and Emily Dillon
Lot #5 Annie Meadow Lane
Holly Springs, NC 27540

Date:
February 5, 2009

Sheet: A-3
Second Floor Plan