

Adams Soil Consulting
1676 Mitchell Road
Angier, NC 27501
919-414-6761

January 15, 2018
Project # 565

Rhonda Johnson
105 J Roy Drive
Apex, NC 27523

RE: Preliminary soil/site evaluation for Lot #13 & #14 Basin Street in Harnett County.

Ms. Johnson,

Adams Soil Consulting (ASC) conducted a preliminary soil evaluation on the above referenced parcel to determine the areas of soils which are suitable for subsurface wastewater disposal systems (conventional & LPP). The soil/site evaluation was performed using hand auger borings during moist soil conditions and the suitable soil boundary was sketched map boundary taken from the Harnett County GIS data base. The investigation was preliminary in nature and does not guarantee any permit for a wastewater disposal system.

The provisionally suitable soils shown on the accompanying soil map have potential for an ultra-shallow conventional, LPP, drip, or low-profile chamber type initial and repair area for a 3-bedroom home. The lot contains greater than 15,000 ft² of potentially provisionally suitable soils that consist of sandy clay loam subsoil that can support a daily loading rate of 0.3-0.4 gallons/day/ft². The specific septic system and loading rates for this lot will be permitted by the Harnett County Health Department. The areas for the proposed septic fields shall not be impacted by home sites, pools, garages and shall not be mechanically altered from the natural lay of the land. The lot should accommodate a house foot print of at least 28' x 70'. It is my opinion that the lots will need to be recombined into one parcel in order to accommodate a septic system for one single family residence.

The final lot will require a detailed soils evaluation by the Harnett County Health Department prior to issuance of any permits for a septic system. A more detailed evaluation/design may be required prior to issuance of any permit. A preliminary septic system design was performed with this investigation in order to demonstrate adequate available space. Due to the subjective nature of the permitting process and the variability of naturally occurring soils, Adams Soil Consulting cannot guarantee that areas delineated as suitable for on-site wastewater disposal systems will be permitted by the governing agency. The lot may require a septic system utilizing pumps, shallow or ultra-shallow conventional trench placement, low pressure pipe system, and/or pre-treatment or reductions system for final approval. The accompanying soil map is preliminary in nature, no further assumptions or subdivision should be made without a more detailed evaluation.

If you have any questions regarding the findings on the attached map or in this report, please feel free to contact me anytime. Thank you allowing me to perform this site evaluation for you.

Sincerely,

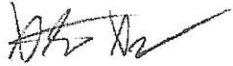

Alex Adams
NC Licensed Soil Scientist #1247

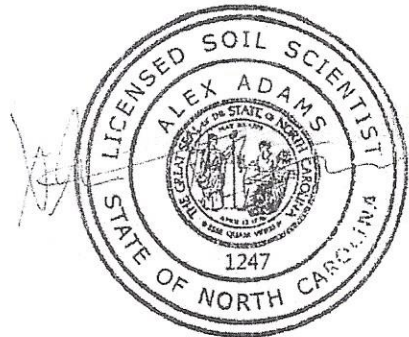

J.W. and Rhonda Johnson
Lot# 13 Captain's Landing - Basin Street
3-Bedroom Layout

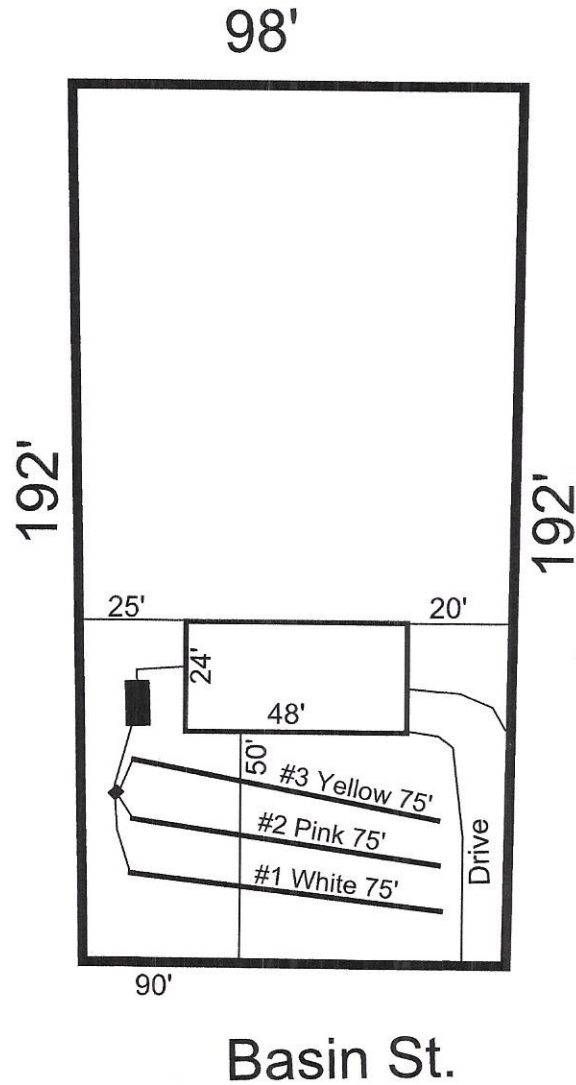

System: Gravity to D-Box
Lines: 1-3, (225')
0.4 LTAR
12" Trench Bottom
Accepted Status System
Repair: Exempt

GRAPHIC SCALE
1" = 40'

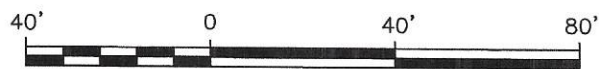

Adams
Soil Consulting
919-414-6761
Job #565

J.W. & Rhonda Johnson
Lot #13 Basin St - Captain's Landing

3-Bedroom Home (360 gal./day)

<u>LINE #</u>	<u>COLOR</u>	<u>BS</u>	<u>HI</u>	<u>FS</u>	<u>ELEVATION</u>	<u>LINE LENGTH</u>	<u>Design Length</u>
TBM		2.0		100.0		<u>in field</u>	<u>installation</u>
INST. 1			102.0				
1	White			2.9	4	85	75
2	Pink			3.7	4.2	85	75
3	Yellow			4.5	4.1	85	75
Total						255	225

	<u>System</u>	<u>Repair</u>
	Lines 1-3	
System Type	Accepted Status System EZ-FLOW	Exempt
Suggested Soil LTAR	0.40	
Total Line Length	225	
Square Footage	675	
Proposed Trench Bottom	12"	
Distribution Method	Gravity to D-Box	