



Initial Application Date: 8/7/2018  
8.21.18

Application # BRES 1808-0008R

CU# \_\_\_\_\_

**COUNTY OF HARNETT RESIDENTIAL LAND USE APPLICATION**

Central Permitting 108 E. Front Street, Lillington, NC 27546 Phone: (910) 893-7525 ext:2 Fax: (910) 893-2793 www.harnett.org/permits

**\*\*A RECORDED SURVEY MAP, RECORDED DEED (OR OFFER TO PURCHASE) & SITE PLAN ARE REQUIRED WHEN SUBMITTING A LAND USE APPLICATION\*\***

LANDOWNER: David & Jennifer Rucker Mailing Address: 221 Valley View Ct  
City: Sanford State: NC Zip: 27332 Contact No: 910-309-3424 Email: druck2616@gmail.com

APPLICANT\*: Same Mailing Address: \_\_\_\_\_

City: \_\_\_\_\_ State: \_\_\_\_\_ Zip: \_\_\_\_\_ Contact No: \_\_\_\_\_ Email: \_\_\_\_\_

\*Please fill out applicant information if different than landowner

CONTACT NAME APPLYING IN OFFICE: David Rucker Phone # (910) 309-3424

ADDRESS: 221 Valley View Ct PIN: 9587-50-3981.000

DEED OR OTP: 2558/547

**PROPOSED USE:**

- SFD: (Size \_\_\_\_\_ x \_\_\_\_\_) # Bedrooms: \_\_\_\_\_ # Baths: \_\_\_\_\_ Basement (w/wo bath):  Garage:  Deck:  Crawl Space:  Slab:  Monolithic Slab:   
(Is the bonus room finished?  yes  no w/ a closet?  yes  no (if yes add in with # bedrooms)
- Mod: (Size \_\_\_\_\_ x \_\_\_\_\_) # Bedrooms \_\_\_\_\_ # Baths \_\_\_\_\_ Basement (w/wo bath)  Garage:  Site Built Deck:  On Frame  Off Frame   
(Is the second floor finished?  yes  no Any other site built additions?  yes  no
- Manufactured Home:  SW  DW  TW (Size \_\_\_\_\_ x \_\_\_\_\_) # Bedrooms: \_\_\_\_\_ Garage:  site built?  Deck:  site built?
- Duplex: (Size \_\_\_\_\_ x \_\_\_\_\_) No. Buildings: \_\_\_\_\_ No. Bedrooms Per Unit: \_\_\_\_\_
- Home Occupation: # Rooms: \_\_\_\_\_ Use: \_\_\_\_\_ Hours of Operation: \_\_\_\_\_ #Employees: \_\_\_\_\_
- Addition/Accessory/Other: (Size 14 x 31) Use: Swimming Pool / deck Closets in addition?  yes  no

Water Supply:  County \_\_\_\_\_ Existing Well \_\_\_\_\_ New Well (# of dwellings using well \_\_\_\_\_) \*Must have operable water before final  
(Need to Complete New Well Application at the same time as New Tank)

Sewage Supply: \_\_\_\_\_ New Septic Tank \_\_\_\_\_ Expansion \_\_\_\_\_ Relocation  Existing Septic Tank \_\_\_\_\_ County Sewer  
(Complete Environmental Health Checklist on other side of application if Septic)

Does owner of this tract of land, own land that contains a manufactured home within five hundred feet (500') of tract listed above?  yes  no

Does the property contain any easements whether underground or overhead  yes  no

Structures (existing or proposed): Single family dwellings: \_\_\_\_\_ Manufactured Homes: \_\_\_\_\_ Other (specify): pool

If permits are granted I agree to conform to all ordinances and laws of the State of North Carolina regulating such work and the specifications of plans submitted. I hereby state that foregoing statements are accurate and correct to the best of my knowledge. Permit subject to revocation if false information is provided.

[Signature]  
Signature of Owner or Owner's Agent

8/7/18  
Date

**\*\*\*It is the owner/applicants responsibility to provide the county with any applicable information about the subject property, including but not limited to: boundary information, house location, underground or overhead easements, etc. The county or its employees are not responsible for any incorrect or missing information that is contained within these applications.\*\*\***

**\*This application expires 6 months from the initial date if permits have not been issued\*\***

**APPLICATION CONTINUES ON BACK**

strong roots • new growth

strong roots • new growth

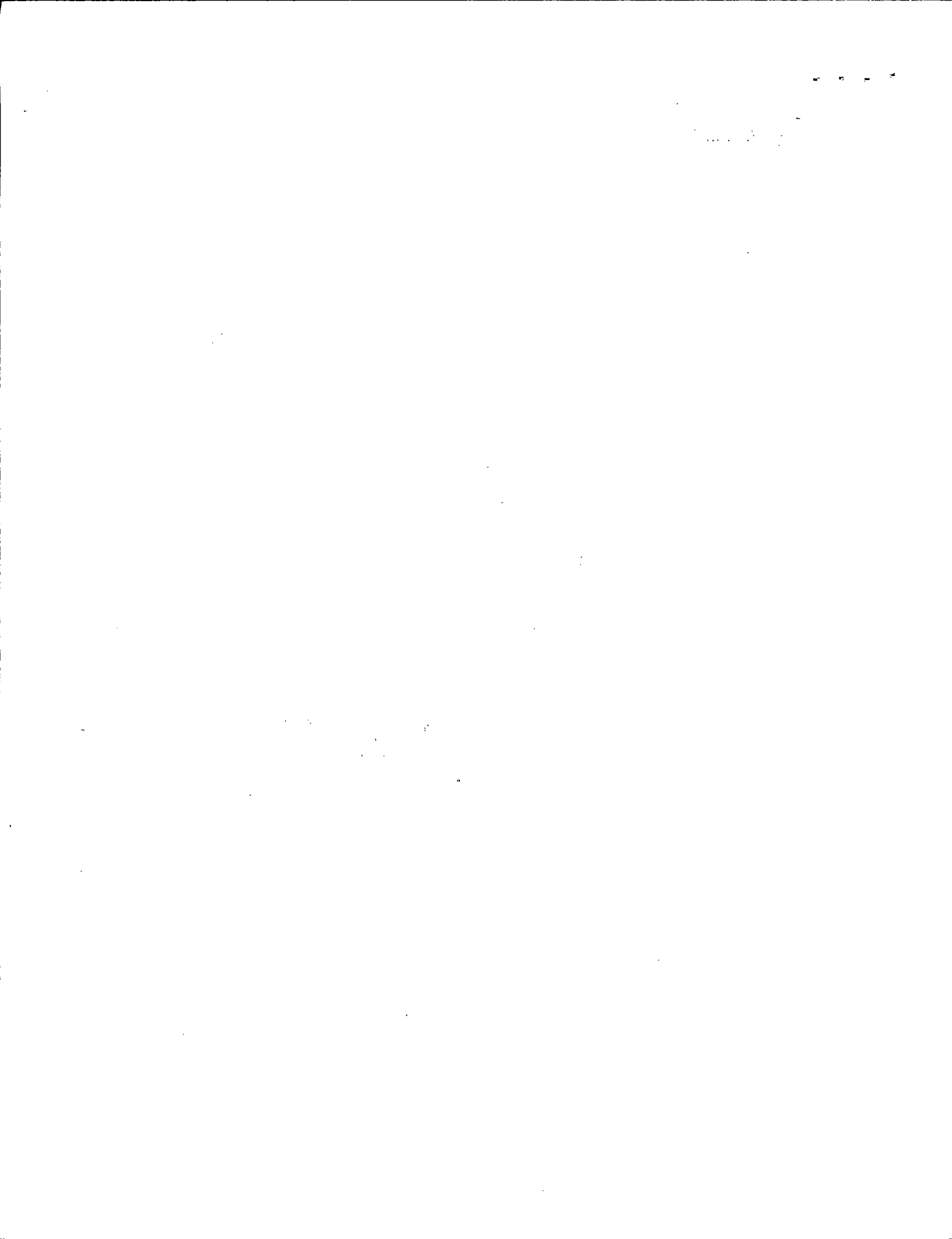

Revised  
SITE PLAN APPROVAL  
DISTRICT RA20K USE Pool

#BEDROOMS \_\_\_\_\_  
8.21.19 DUKUSM  
ZONING ADMINISTRATOR

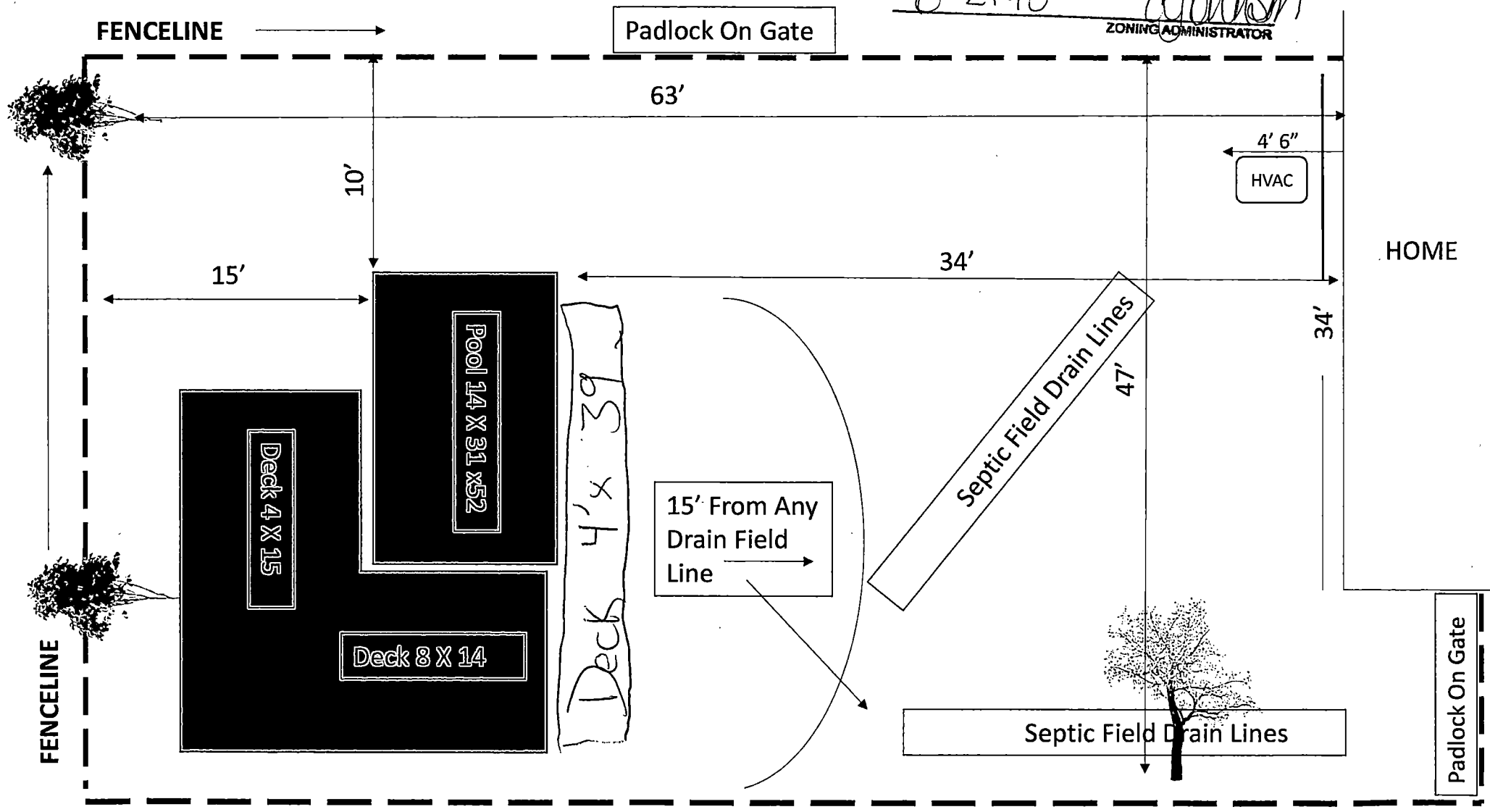

UNITED STATES DEPARTMENT OF JUSTICE

FEDERAL BUREAU OF INVESTIGATION

WASHINGTON, D. C. 20535

MEMORANDUM FOR THE DIRECTOR