

HARP
 284 Lakeside Ln
 CATALINA LAKES
 SAFFORD NC 27332
 DECK EXPANSION

910-578-0436

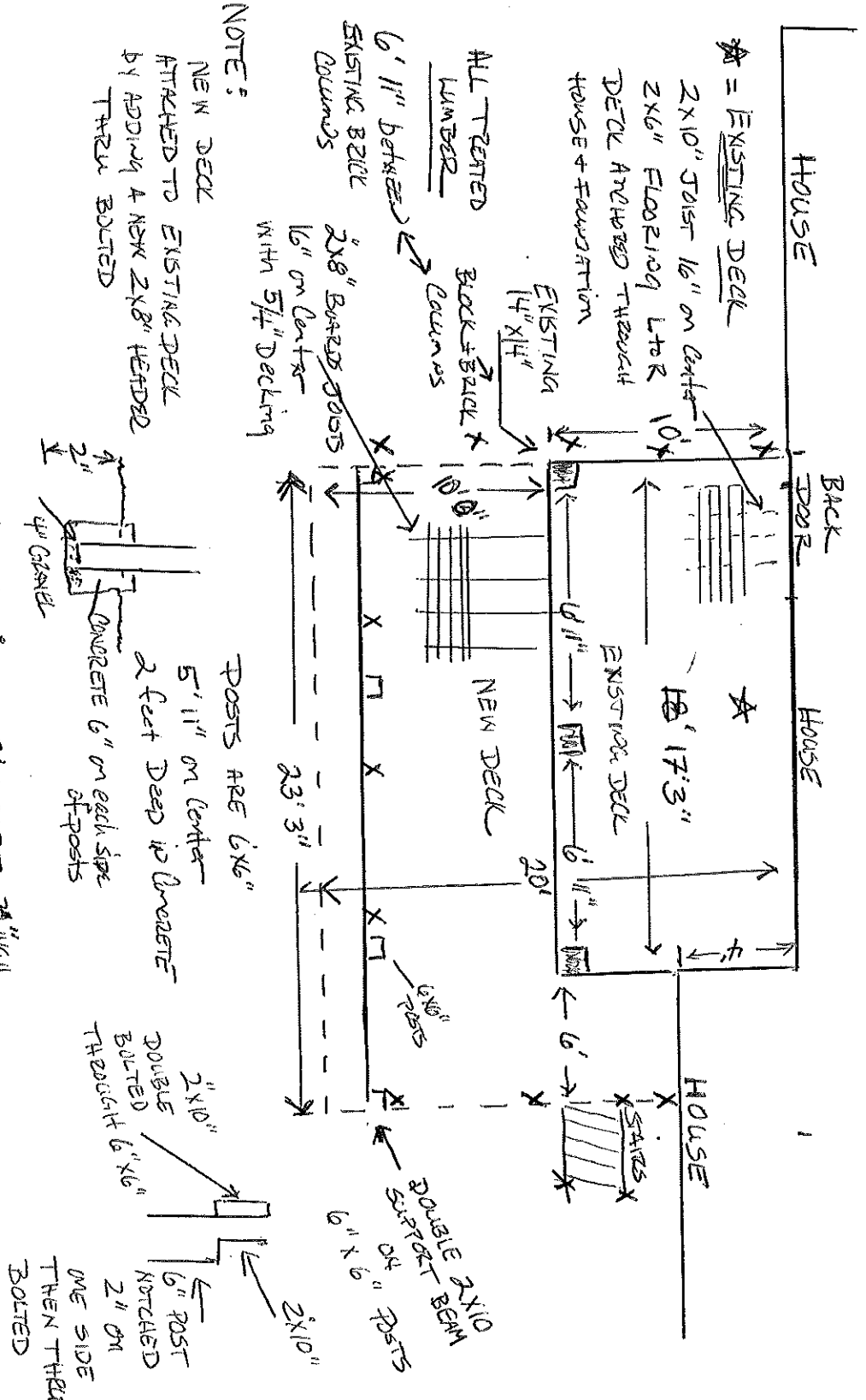

NOTE:

NEW DECK
 ATTACHED TO EXISTING DECK
 BY ADDING A NEW 2X8" HEADER
 THREE BOLTED

X = 4" x 4" PILLS 5' APART 38" HIGH

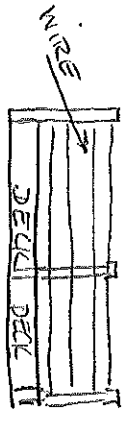

4" x 4" NOTCHED 1/2" & BOLTED
 THREE HEADER
 COATED WIRE 6" APART

2" x 10" DOUBLE BOLTED THROUGH 6" x 6"
 6" x 6" POST NOTCHED 2" ON ONE SIDE THEN THREE BOLTED

POSTS ARE 6x6"

5' 11" ON CENTER
 2 FEET DEEP IN CONCRETE
 6" ON EACH SIDE OF POSTS

DOUBLE BEAM WITH 6" x 6" POSTS
 6" x 6"

EXISTING
ROOF

HELIP
284 Lakeside Ln
DARLINGTON LAKES
SANDFORD NC 27332
910-578-0434

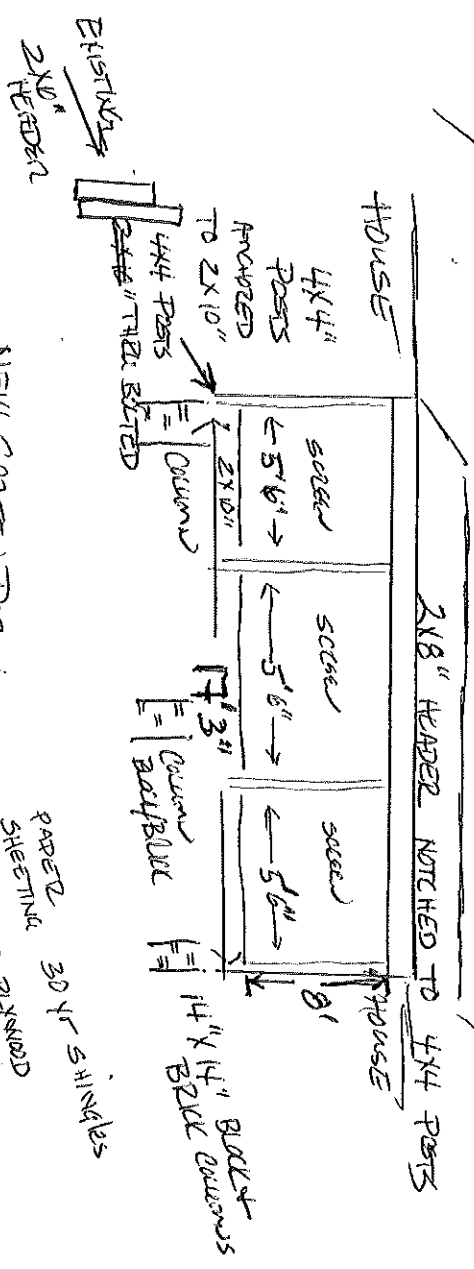

NEW SCREEN PORCH
PLACED ON EXISTING
ATTACHED DECK

DECK EXPANSION →
ADD SCREEN PORCH
TO EXISTING DECK

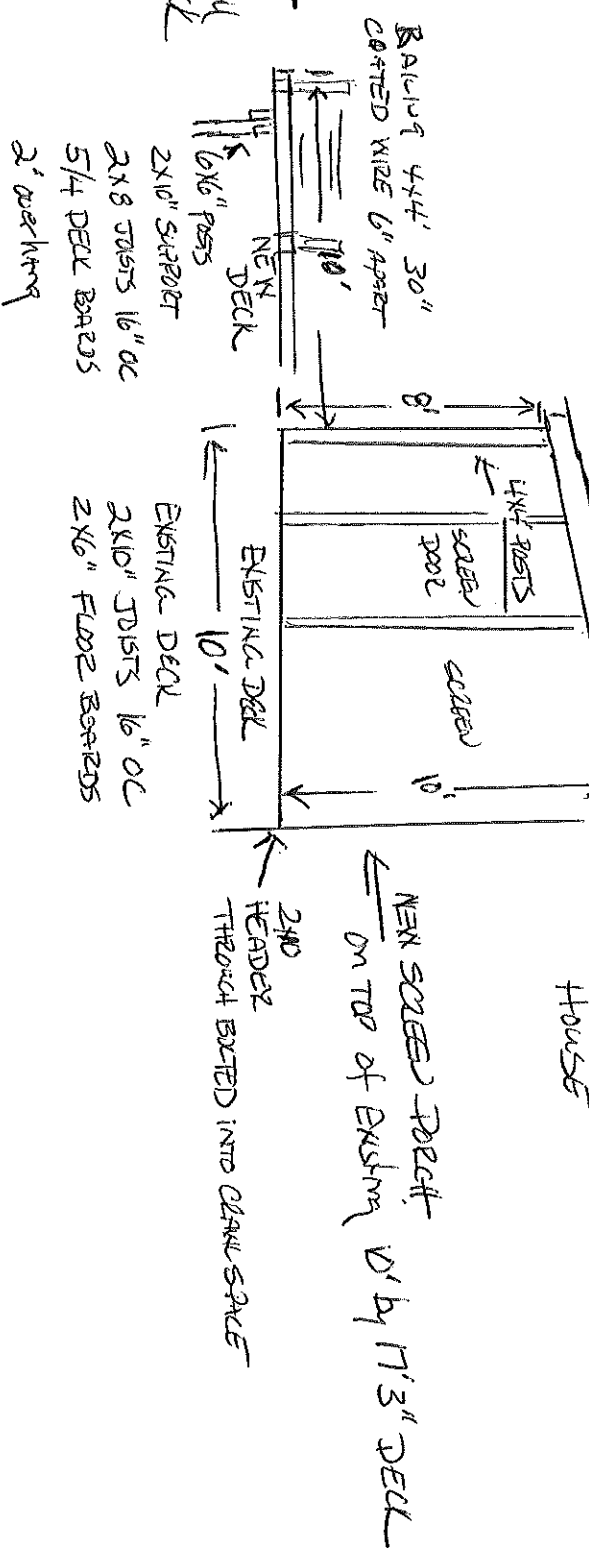

PAPER SHEETING 30 yr shingles
1/2 SHEETED PLANKWOOD
2x6 24" on center
NEW ROOF

NEW SCREEN PORCH
ON TOP of EXISTING 10' by 17'3" DECK
NEW 2x10 HEADER
THROUGH EXISTING INTO DECK SPACE