

Jim & Dorothy Boyd  
 Lot #7 (~4.27 acres) Chesterfield Estates  
 Mabry Road, Harnett County

SITE PLAN APPROVAL

DISTRICT PA-30 USE Detached garage

#BEDROOMS

7-16-18

djohann  
 ZONING ADMINISTRATOR

NOT TO  
 SCALE

*proposed detached garage*

System: \*Gravity to D-Box  
 Lines: 1-3, (300')  
 0.4 LTAR  
 18" Trench Bottom  
 Accepted Status System  
 Repair: Pump to D-Box  
 Lines: 4-6, (300')  
 0.4 LTAR  
 18" Trench Bottom

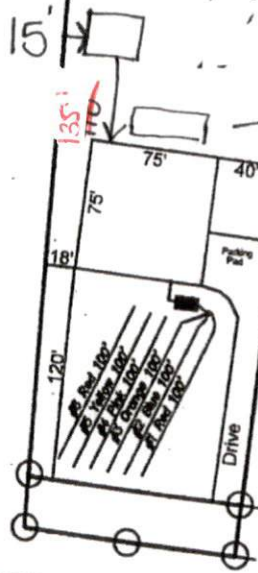

*proposed underground pool*

SITE PLAN APPROVAL  
 DISTRICT PA-30 USE Detached garage  
 #BEDROOMS 7-16-18  
djohann  
 ZONING ADMINISTRATOR

202 MABRY ROAD

GRAPHIC SCALE  
 1" = 100'



Adams  
 Soil Consulting  
 919-414-6761  
 Project #595