

R/W

R/W

C/L US 421 N (100'R/W) C/L

(TIE LINE) S 74°00'28"E 89.87' CP S 75°00'00"E 70.00' CP R/W

R/W
EXISTING
ANGLE
IRON

NORTH CAROLINA HARNETT COUNTY
I, Mickey R. Bennett, PLS do certify that this plot was drawn under
my supervision (deed description recorded in Book SEE
Page REF, etc) that the boundaries not surveyed are clearly
indicated as drawn from information found in Book SEE Page REF
that the ratio of precision as calculated is 1:10000. WITNESS
my original signature, registration number and seal this 25th
day of July, A.D. 2018.

Mickey R. Bennett
MICKEY R. BENNETT
L - 1514



DEED REFERENCE
DEED BOOK 906, PAGE 317

KEREN F. BINKLEY
DB:2973, PG:160

ASPHALT DRIVE

CARL WAYNE MCNEILL
.25 AC.
DB:906, PG:317

EXISTING FOUNDATION
OF BURNED STRUCTURE

EXISTING
BRICK
DWELLING

CARL WAYNE MCNEILL
REF 02-E-457

ASPHALT DRIVE

WELL
HOUSE

CP N 75°00'00"W 70.00' CP

CP - CALCULATED POINT

NORTH REFERENCE DB:906, PG:317

EXISTING PARCEL
SURVEY FOR:

CARL WAYNE MCNEILL

BENNETT SURVEYS F-1304
1662 CLARK RD., LILLINGTON, N.C. 27546
(910) 893-5252

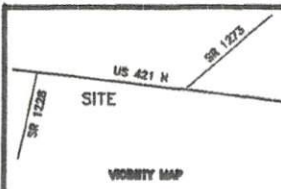

TOWNSHIP	UPPER LITTLE RIVER	COUNTY	HARNETT	
STATE:	NORTH CAROLINA		DATE:	JULY 25, 2018
ZONED	WATERSHED DISTRICT	TAX PARCEL ID#:	139691 0057	
RA-30	N/A	PIN #	9691-23-6770.000	

10' 0 20'	SURVEYED BY:	RVB	FIELD BOOK
SCALE: 1" = 40'	DRAWN BY:	MRB	DRAWING NO
CHECKED & CLOSURE BY:	MRB		18272