

**MASENGILL ASSOCIATES, P.A.**  
 CONSULTING ENGINEERING  
 116 E. MAIN ST. P.O. BOX 695  
 BENSON N.C. 27504 - 0695  
 PHONE: 919-894-2071 FAX: 919-894-7288

H & H PRODUCTS  
 3418 US 301N  
 DUNN, NORTH CAROLINA

STUDY - FLOOR PLAN

1-S  
 REVISED 10-2-06  
 1/8" = 1'-0"

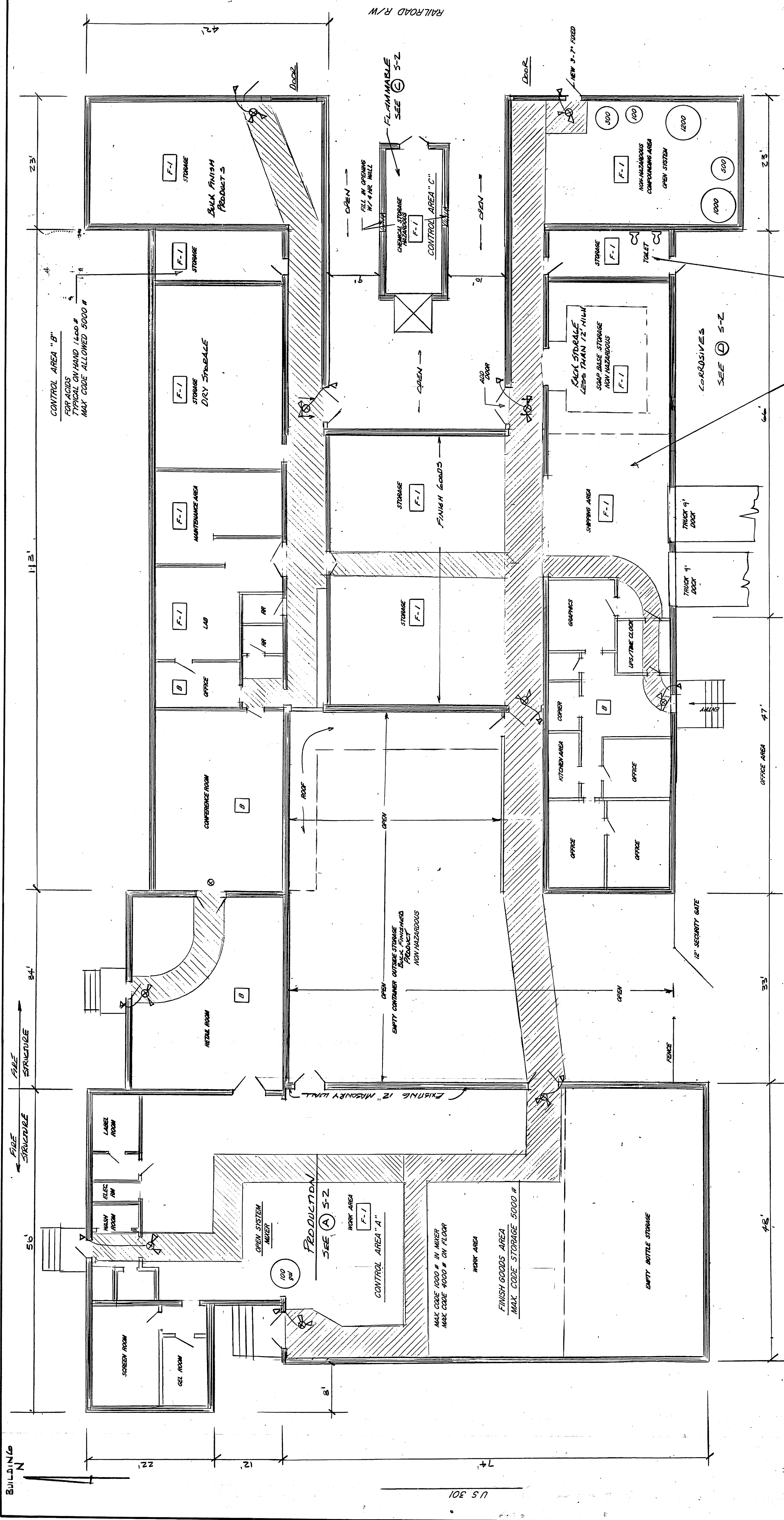

**LEGEND**  
 EMERGENCY LIGHT/EXIT SIGN COMB  
 EMERGENCY LIGHT BATTERY POWER  
 EXIT SIGN  
 4" MIN. MARKED-EXIT WAY

**SUMMARY AREA:**  
 F-1 WEST 5580 / 12,000 SF NO SPRINKLER REQ'D  
 F-1 NORTH 2670  
 F-1 SOUTH 2400  
 F-1 CENTER 1590  
 B NORTH 1700  
 B SOUTH 1170  
 C-3 325

9530 < 12,000 SF  
 NO SPRINKLER REQ'D

TYPICAL AMOUNT ON HAND 5000 #  
 ON PALLETS READY FOR SHIPMENT  
 CODE ALLOWANCE 5000 #

CONTROL AREA "D"  
 FOR CORROSIVES  
 TYPICAL ON HAND 3500 #  
 MAX CODE ALLOWED 5000 #

FLOOR PLAN STUDY



SCALE 1/8" = 1'-0"

- PHASE 1**
1. MOVE BULK ISOPROPYL ALCOHOL TO A REMOTE OFF-SITE STORAGE LOCATION
  2. ADD FIRE EXIT DOORS
  3. MARK EXIT WAY THRU PLANT
  4. INSTALL EXIT SIGN & EMERGENCY LIGHTS
  5. CLEAR FIRE LANE AROUND BUILDING