

OCCUPANT CONTENT

OFFICE	1,578 sf / 100 = 16 PERSONS
OCCUPANT CONTENT	16 PERSONS

- EXIT SIGN w/ DIRECTIONAL ARROW
- EXIT SIGN
- EXIT SIGN w/ EMERGENCY EGRESS LIGHT
- EMERGENCY EGRESS LIGHT
- FIRE EXTINGUISHER

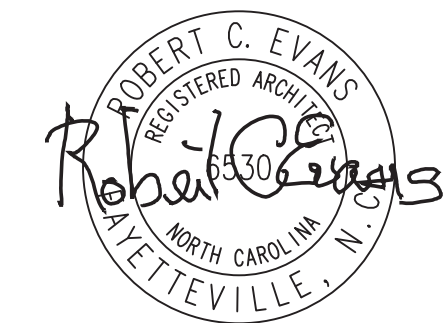
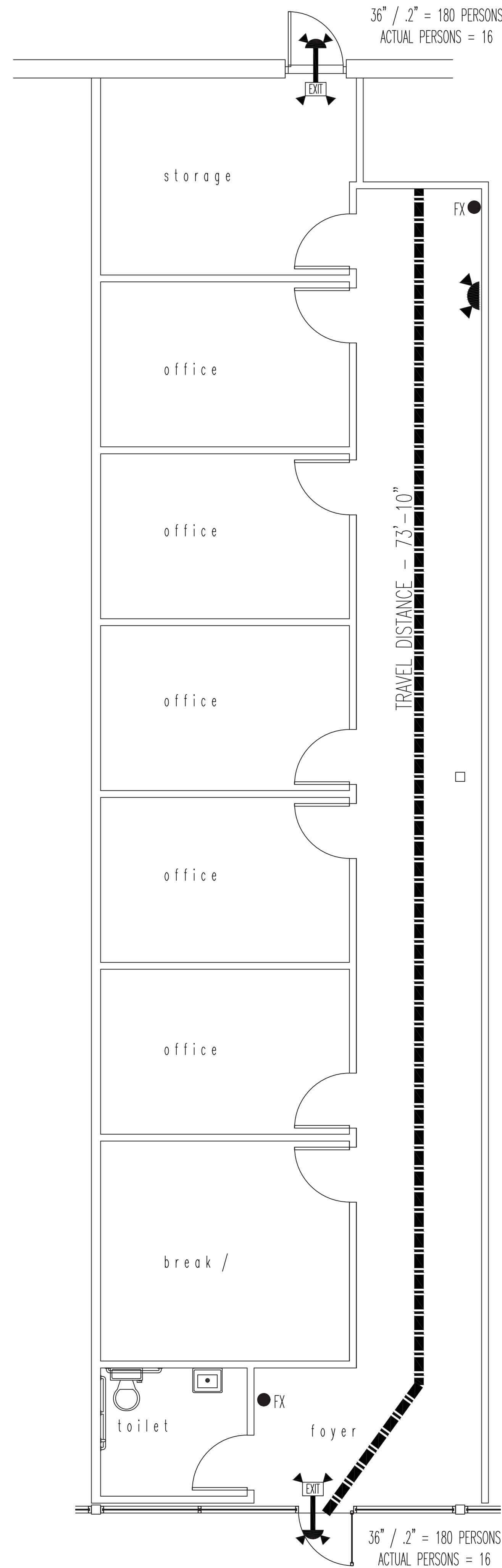

03.30.26

ROBERT CHARLES EVANS  
ARCHITECT  
ARCHITECTURE  
545 Pearl Street Fayetteville North Carolina 28303

# First Command Renovations

Drawing Name:

Floor Plan  
Life Safety Plan

Project Name:

Renovations for:  
First Command

Project Location:

181 Mittie Haddock Dr.  
Cameron  
North Carolina

DRAWINGS AND THE DESIGN ARE THE PROPERTY OF THE ARCHITECT. WHETHER THE PROJECT FOR WHICH THEY ARE PREPARED IS EXECUTED OR NOT, THE DRAWINGS SHALL NOT BE USED BY THE PROJECT OWNER OR ANYONE ELSE FOR ANY OTHER PROJECT.

ADA AND LEGAL DISCLAIMER  
THIS DOCUMENT IS INTENDED TO COMPLY WITH THE REQUIREMENTS OF THE AMERICANS WITH DISABILITIES ACT (ADA). ARCHITECTS AND ENGINEERS ARE NOT LICENSED TO INTERPRET LAWS OR CODES CONCERNING LAWS OR LEGAL MATTERS. THE OWNER SHOULD HAVE THIS DOCUMENT REVIEWED BY HIS ATTORNEY TO DETERMINE IF IT COMPLES TO ADA AND OTHER LAWS.

PROJECT NO: 26-030  
DRAWN BY: RCE.  
DATE: 03.30.26  
REVISIONS:

SHEET NO:

A1.1