

SITE NOTES

1. LOCATION AND TOPOGRAPHICAL INFORMATION WAS TAKEN FROM TOPOGRAPHIC SURVEY PERFORMED BY MCDAMS FEBRUARY 07, 2022. ALL LINEAR DIMENSIONS ARE LOCALIZED HORIZONTAL (GROUND) DISTANCES AND VERTICAL DATUM IS NAVD 88. COORDINATES AS SHOWN ARE NC STATE PLANE GRID NAD 83 (2011).
2. THE PROPERTY IS NOT LOCATED IN A SPECIAL FLOOD HAZARD ZONE AS DEFINED BY FEMA FIRM COMMUNITY PANEL #3720152700J AND 3720153700L DATED JANUARY 05, 2007.
3. PROJECT SITE IS LOCATED IN THE CAPE FEAR RIVER BASIN AND IS NOT SUBJECT TO RIPARIAN BUFFERS.
4. ALL INFORMATION OUTSIDE OF SURVEY LIMITS PROVIDED BY DUKE ENERGY PROGRESS, CONTRACTOR SHALL LOCATE FEATURES AS NECESSARY TO COORDINATE WORK WITH THIS PROJECT.
5. ALL MATERIALS, CONSTRUCTION, WORKMANSHIP, SHALL MEET HARNETT COUNTY, DUKE ENERGY PROGRESS, LLC (DEP), AND NCDOT (WHERE APPLICABLE) SPECIFICATIONS, STANDARDS AND DESIGN.
6. CONTRACTOR SHALL COMPLY WITH ALL PERTINENT PROVISIONS OF THE "MANUAL OF ACCIDENT PREVENTION IN CONSTRUCTION" ISSUED BY ACC OF AMERICA, INC., AND THE SAFETY AND HEALTH REGULATIONS FOR CONSTRUCTION ISSUED BY THE U.S. DEPARTMENT OF LABOR.
7. NOT ALL EXISTING UTILITIES ARE SHOWN. LOCATIONS SHOWN ARE APPROXIMATE. IT IS THE CONTRACTOR'S RESPONSIBILITY TO ACCURATELY LOCATE BOTH HORIZONTALLY AND VERTICALLY ALL EXISTING UTILITIES PRIOR TO THE START OF CONSTRUCTION. THE CONTRACTOR SHALL NOTIFY NCB11 OR THEIR SUCCESSOR AT 800-632-4949 PRIOR TO EXCAVATION. CONTRACTOR SHALL NOTIFY DUKE ENERGY PROGRESS, INC. IMMEDIATELY IN THE EVENT OF ENCOUNTERING ANY UNDERGROUND DISTURBANCE REQUIRING DEVIATION FROM THE PLAN. COST TO REPAIR DAMAGED UTILITIES SHALL BE BORNE BY THE CONTRACTOR.
8. THE CONTRACTOR SHALL BE RESPONSIBLE FOR THE REPAIR OF ANY PAYMENT OR EXISTING UTILITIES THAT MAY BE DAMAGED DUE TO CONSTRUCTION ACTIVITY. EXERCISE CAUTION.
9. SHOULD ANY GROUNDING BE CUT OR UNEARTHED, THE GROUNDING WILL NEED TO BE REPAIRED AND RECONNECTED. THE GROUNDING SHOULD BE BETWEEN 18" TO 24" DEPTH.
10. ALL UTILITIES SHALL BE PROTECTED AND REMAIN ACTIVE UNLESS OTHERWISE NOTED. CONTRACTOR SHALL NOT DISTURB UTILITY POLES, GUY WIRES, OR ANCHORS WITHOUT PERMISSION FROM DUKE ENERGY PROGRESS, INC.
11. EXISTING IMPROVEMENTS SLATED TO REMAIN THAT ARE DAMAGED DURING CONSTRUCTION SHALL BE REPLACED/RESTORED TO THEIR ORIGINAL CONDITION OR TO THE SATISFACTION OF THE OWNER BY THE CONTRACTOR RESPONSIBLE FOR THE DAMAGE.
12. ALL CONSTRUCTION SHALL CONFORM TO THE LATEST DUKE ENERGY SPECIFICATIONS, HARNETT COUNTY SPECIFICATIONS AND NCDOT STANDARDS AND SPECIFICATIONS, AS APPLICABLE.
13. ALL CONSTRUCTION DEBRIS SHALL BE DISPOSED OF OFF-SITE IN A STATE PERMITTED LANDFILL OR AS DIRECTED BY DEP REPRESENTATIVE.
14. EQUIPMENT AND PRODUCTS OTHER THAN THOSE SPECIFIED MAY BE USED PROVIDED APPROVAL HAS BEEN OBTAINED FROM THE OWNER IN WRITING PRIOR TO ORDERING OR INSTALLATION. THE CONTRACTOR SHALL WAIVE ANY CLAIM FOR ADDITIONAL COST RELATED TO THE SUBSTITUTION OF ALTERNATE EQUIPMENT.
15. OSHA MINIMUM EQUIPMENT APPROACH DISTANCE FOR NON-QUALIFIED ELECTRICAL WORKERS IS 20 FEET FROM ENERGIZED CONDUCTORS.
16. THERE SHALL BE NO SEEDING OR FILL IN WETLANDS OR OTHER BUFFERS.
17. A TYPE B BUFFER MUST BE INSTALLED ADJACENT TO ALL RESIDENTIAL DEVELOPED PROPERTIES ALONG THE NORTHEASTERN TO THE SOUTHERN PORTION OF JONESBORO ROAD.
18. SOLID WASTE AND HAZARDOUS WASTES SHALL BE DISPOSED OF ACCORDING TO THE APPLICABLE FEDERAL AND STATE REGULATIONS. SOLID AND HAZARDOUS WASTE SHALL BE COLLECTED BY LICENSED SOLID WASTE COLLECTORS AS DEFINED IN HARNETT COUNTY SOLID WASTE MANAGEMENT ORDINANCE, ADOPTED JULY 23, 1990.
19. THE OWNER SHALL BE RESPONSIBLE FOR MAINTENANCE OF THE PARKING AREAS, DRIVE AISLES, AND ALL LANDSCAPE BUFFERING.
20. THIS DEVELOPMENT IS WITHIN ONE MILE OF A VOLUNTARY AGRICULTURAL DISTRICT.
21. SITE LIGHTING IN SUCH A MANNER TO PREVENT DIRECT GLARE AND LIGHTING ONTO ADJACENT PROPERTY OR INTO THE PUBLIC RIGHT(S)-OF-WAY. ALL FLOOD LIGHTS SHALL BE INSTALLED IN SUCH THAT THE FIXTURE SHALL BE AIMED DOWN AT LEAST 45 DEGREES FROM VERTICAL.
22. SITE LIGHTING TO BE MCGRAW-EDISON GLEON GALLEON LIGHTS

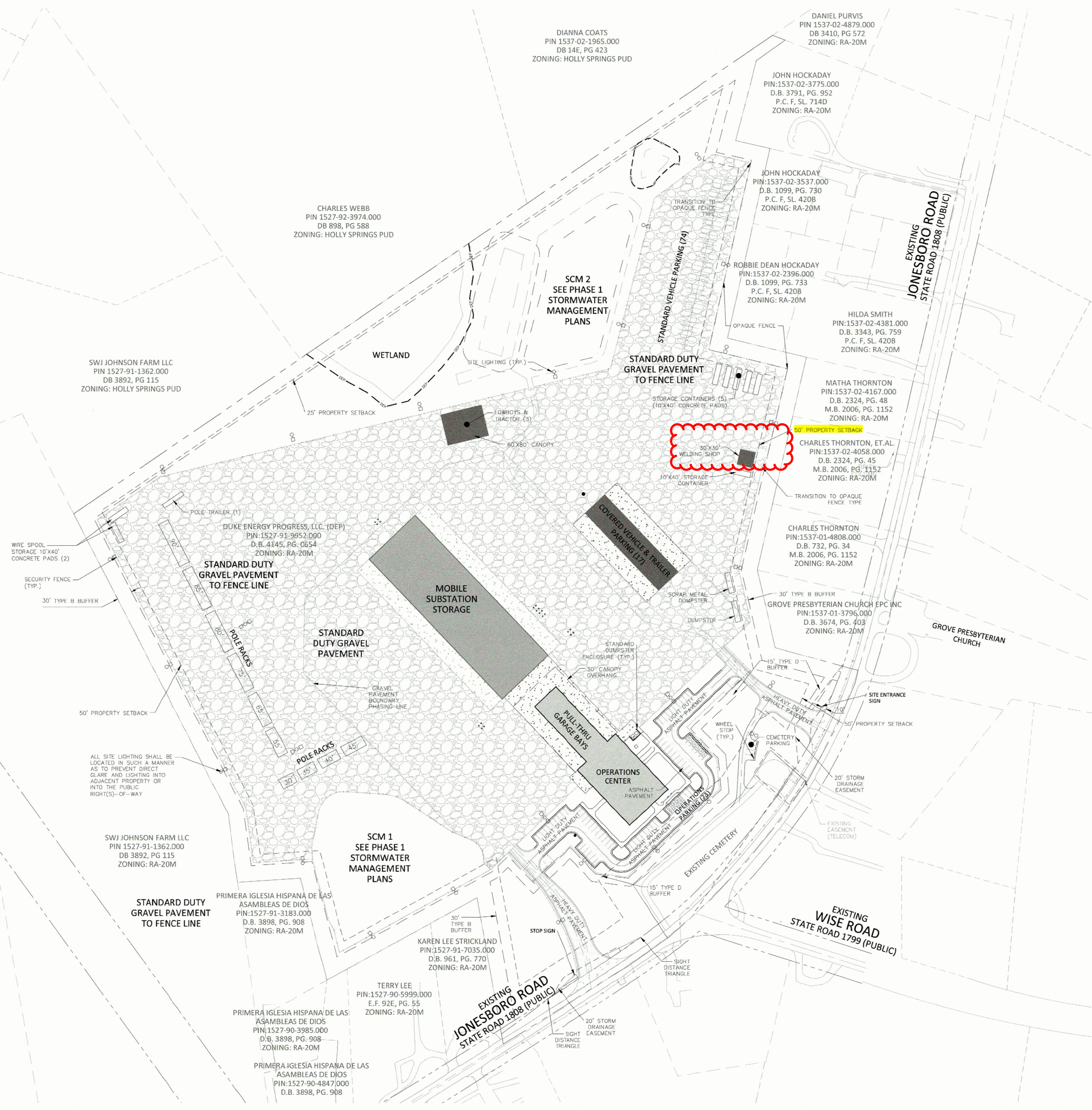

SITE LEGEND

- ○ ○ ○ LIGHT POLE (BY OTHERS)
- — — — PROPERTY LINE
- - - - - PROPERTY SETBACK
- — — — LANDSCAPING BUFFER
- — — — RIGHT-OF-WAY LINE
- — — — EASEMENT LINE
- — — — CENTERLINE
- — — — SECURITY FENCE
- — — — DEP PROTECTIVE BUFFER (20' FROM SURFACE WATERS)
- CONCRETE PAVEMENT
- STANDARD DUTY GRAVEL PAVEMENT
- ASPHALT PAVEMENT

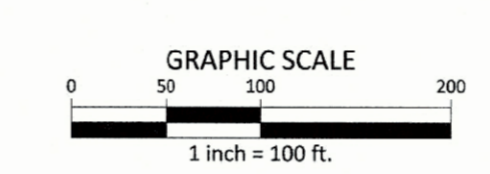

DRAWING NO. CFD-XXXX-XX-XXXX



MAILING ADDRESS:
MARK B. FRANKLIN
JUL - DUKE ENERGY ACCOUNT
410 S. WILMINGTON STREET
RALEIGH, NORTH CAROLINA 27602

Safety Expectations:



DUNN TRANSMISSION OPERATIONS CENTER

1269 JONESBORO RD
DUNN, NC. 28334, HARNETT COUNTY

DUNN OPERATION CENTER

MARK	DATE	DESCRIPTION	ISSUED FOR CONSTRUCTION
0	08/01/24	DML	ISSUED FOR CONSTRUCTION
1			
2			
3			
4			
5			
6			
7			
8			
9			

PROJECT NO:
DRAWING NUMBER
CFD-XXXX-X-XXXX

ELECTRONIC FILE CS0110.DWG

DRAWN BY: SMP 08/01/2023

CHKD BY: KAS

E-MAIL: COVIL@MCDAMSCO.COM

THIS DESIGN DRAWING IS THE EXCLUSIVE PROPERTY OF DUKE ENERGY CORPORATION AND IS CONSIDERED CONFIDENTIAL. IT SHALL NOT BE REPRODUCED, COPIED, OR DISTRIBUTED WITHOUT PRIOR APPROVAL. THIS INFORMATION SHOULD ONLY BE USED FOR THE SPECIFIC PROJECT INTENT.

SHEET TITLE: OVERALL SITE PLAN

SHEET NO. C2.00

SHEET NO. E1 SIZE DWG: PLOT SIZE (30x42)

RELEASED FOR CONSTRUCTION