

CCI Corporate Office
 PO Box 1263/187 Cardinal Ridge Trail
 Dobson, N.C. 27017
 Scheduling: (800) 670-4262



Alan's Factory Outlet
 PO Box 646, Luray VA 22835
 Alan's Phone: (800) 488-6903
 Alan's Fax: (800) 385-1204

REVISED 08/13/24 2nd REVISION

Website: www.alansfactoryoutlet.com 09092024

Date: 08/09/2024

Customer Name:	Scott Drye			County:	Cumberland	Tax %	7.00%
Address:	307 Anderson Lake Drive		City:	Spring Lake	State:	NC	Zip: 28390
Phone	Cell: (252) 621-0338	Home:		Other:			
Email:	scottd@andersoncreekclub.com						

**** CUSTOMER MUST OBTAIN PERMIT - REQUIRED TO SCHEDULE INSTALLATION ** Photos required of completed install site for scheduling process to begin***

Unit Size	18'x25'	HT.	12	GA	14	All Orders C.O.D.	
Color	Top Evergreen	Trim	White		\$6,510.00 \$6,760.00		
	Sides Evergreen	G. Door	White		Options Subtotal \$7,060.00		
	Color Screws Yes: No: X	Cost (if Applicable):			\$455.70 \$473.20		
Options	18x25 Regular Roof Style Garage				\$1,695.00	Taxes \$494.20	
	12' Leg Height				\$575.00	\$0.00	
	Both Sides Closed				\$1,040.00	Labor Charges	
	Both Ends Closed				\$2,400.00	(Cost of plans due to CCI in advance)	
	(1) 10' x 10' CERTIFIED ROLL-UP GARAGE DOOR				\$1,050.00	\$7,554.20	
	(1) 36" x 80" Walk-In Door; Color: White				\$300.00	\$6,965.70 \$7,233.20	
	Note from Customer: The delivery address is within Anderson Creek Club. Please call Scott before delivery.					Subtotal Plus Tax	

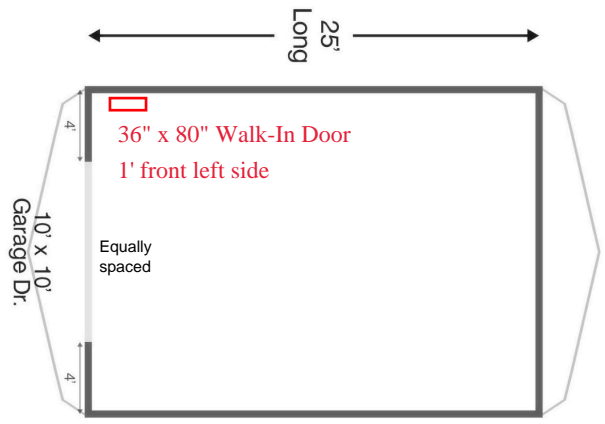

	\$1,200.20		
Collected	\$1,106.70	\$1,149.20	
\$51.00	Credit Card	AFO COLLECTED	
	17%	\$42.50 additional	
	Deposit Amount		
	\$6,354.00	\$5,859.00	\$6,084.00
	Total Remaining After Paid Deposit		
	\$6,354.00	\$5,859.00	\$6,084.00
	Balance Due at Installation		
	Balance Payment Method: (Please Choose):		
	Check (Make all checks payable to Carolina Carports, Inc.)		
	Money Order		
	Cash		
	Credit Card or E-Check (2% processing fee applies)		

NOTE: ROOF IS 1' LONGER THAN THE FRAME LENGTH	
Labor Fee/Non-Taxable (If this includes plans, must be pre-paid/are non-refundable)	\$0.00
Notes Regarding Labor Fee:	

Roof Style	Regular	X	Box Eave		Vertical	
Barn Style (if applicable)	Horse		Carolina		Seneca	
Installation Type	Cement	X	Ground		Asphalt	Other
Power Available	Yes	X	No	Uncertified	Certified	X

BINDING PURCHASE CONTRACT

LOT MUST BE LEVEL PRIOR TO INSTALL. CHECK WITH YOUR COUNTY/CITY FOR PERMIT/ZONING REQUIREMENTS
 This purchase agreement (the "Agreement") is made by and between Carolina Carport Inc. ("CCI"), a North Carolina Corporation, and Scott Drye (the "Buyer")

Buyer agrees, after being fully educated about CCI's various products including the fourteen (14) gauge, twelve (12) gauge, and certified units, to buy, and CCI agrees to sell, pursuant to the terms listed in this Agreement, the item described above. Buyer has read and understands the terms of this agreement, including the terms and conditions contained on the 2nd and 3rd pages of this document, which terms are expressly incorporated herein by reference, as well as any and all relevant warranty information and agrees to be bound by same. Prices on this contract are subject to cost increases if order is placed on hold for 90 days or more. **Delivery time frames are estimated only and are not guaranteed.** Delivery time frame does not begin until permit approved (if applicable). All payments made to CCI with a credit card or e-check will have a 2% processing fee applied.

Customer: ✓ Scott Drye CCI: _____
 8/9/2024 3:18 PM EDT By: AJB
 Authorized Representative

For Florida Customers Only: CBC1254822