

ROADSIDE / SPECIAL DITCH SCHEDULE

ROAD SIDE OR DITCH ID	BEGIN STATION (STA)	END STATION (STA)	DRAINAGE AREA (AC)	10-YEAR FLOW (CFS)	BOTTOM WIDTH (BW) (FT)	DEPTH (D) (FT)	LENGTH (FT)	SIDE SLOPE (Z)	AVE. SLOPE (%)	LINING
LT	400+23	407+30	1.6	5.1	0	1	707	4	3.1	GRASS W/ N.A.G S75
RT	400+23	402+85	0.5	1.6	0	1	262	4	3.1	GRASS W/ N.A.G S75
LT	407+30	408+35	1.7	5.3	0	1	170	4	2.0	GRASS W/ N.A.G S75

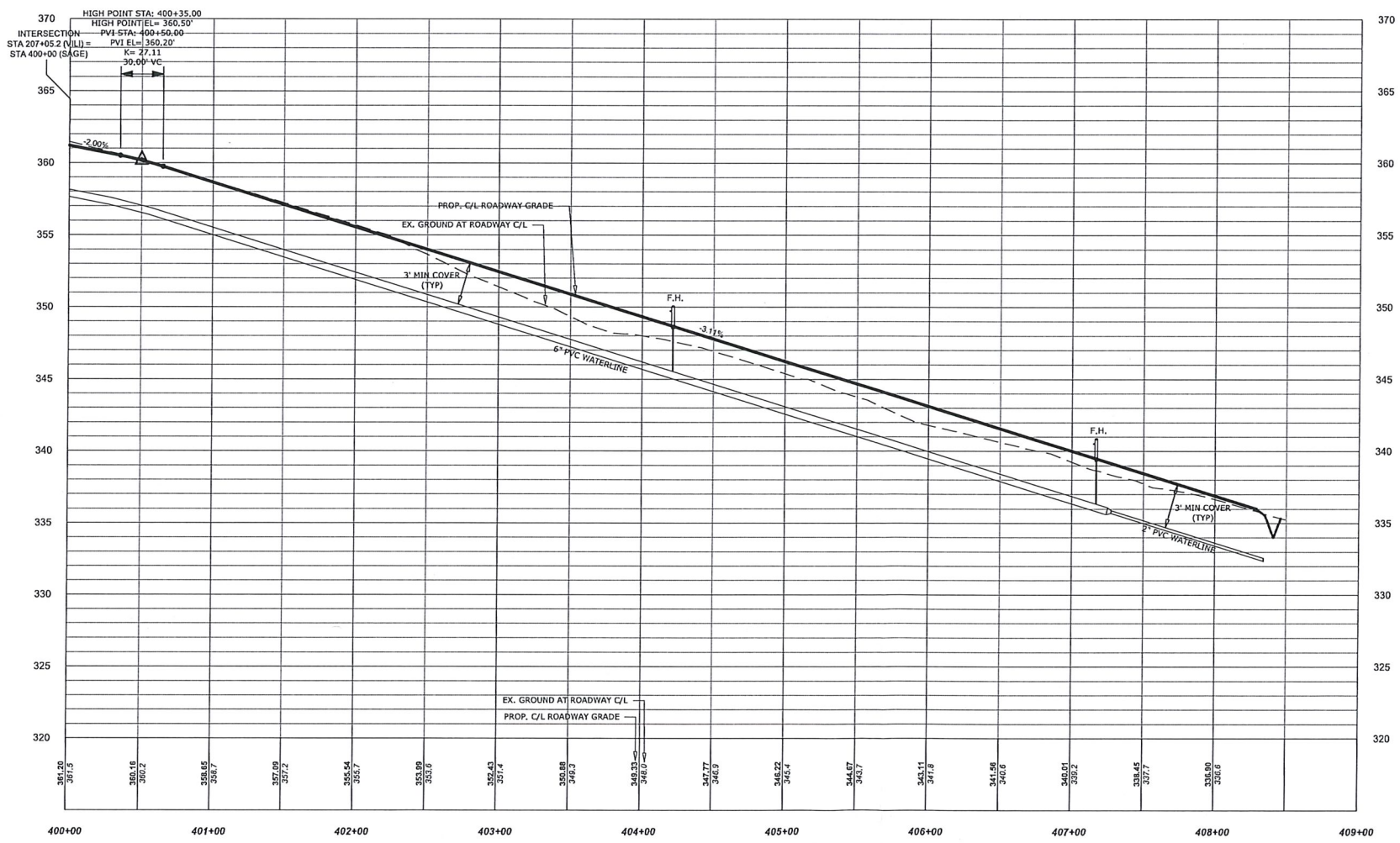
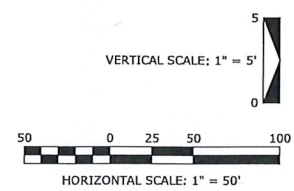

J THOMAS ENGINEERING, INC.
CIVIL ENGINEERING & PLANNING

143 Charlotte Avenue, Suite 104
Sanford, North Carolina 27330
(919) 777-6010 phone
www.jthomasengineering.com
license no. C-33389



PROFESSIONAL ENGINEER'S SEAL

HARRINGTON PLACE
RESIDENTIAL DEVELOPMENT
KNIGHT ROAD / ROSSER PITTMAN ROAD
HARNETT COUNTY, NORTH CAROLINA

PLAN / PROFILE
SAGE DRIVE: STA 400+00 TO STA 409+00

REVISIONS

AGENCY REVIEW ONLY

Scale: SEE SCALE BAR	Drawn by: JRT
Sheet: 8 of 18	Designed by: JRT
Project Number: 21-002	Reviewed by: JRT
	Date: 30 MAR 2022