

No.	Date	Remarks

REVISIONS

Scale: 1/4"=1'-0"

PAT

DWG. Checked By:

NSK

Drawn/Design By:

Date: 03/19/18

Project #: 1801-020094

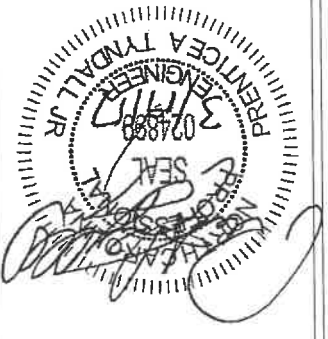

Client:

Beverly Scott
1794 Old Stage Rd.
Erwin, NC

Plan:

1794 Old Stage Rd.
Erwin, NC



TYNDALL
ENGINEERING & DESIGN, P.A.

250 Shipwash Drive • Garner • North Carolina • 27529
www.tyndallengineering.com

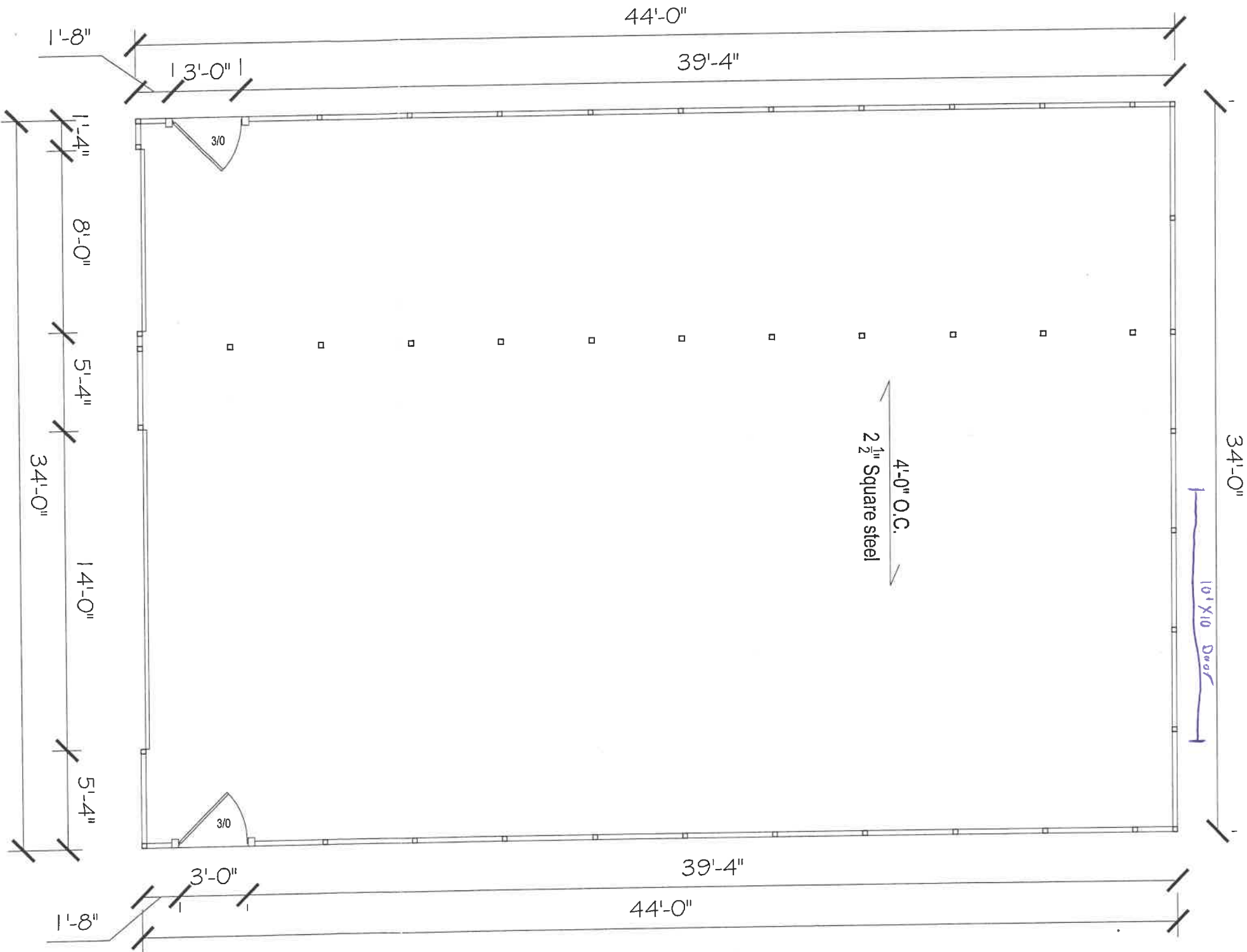

FLOOR PLAN

3/16" = 1'-0"

NOTICE TO CONTRACTOR
This drawing was prepared in accordance with the Building Code of Harnett County, North Carolina. It is subject to field inspection and verification.
Required for Code Compliance
02/16/2024

* Engineers seal does not include construction means, methods, techniques, sequences, procedures or safety precautions.
* Any deviations or discrepancies on plans are to be brought to the immediate attention of Tyndall Engineering & Design, P.A. Failure to do so will void Tyndall Engineering & Design, P.A. liability.
* Please review these documents carefully.
* Tyndall Engineering & Design, P.A. will interpret that all dimensions, recommendations, etc. presented in these documents were deemed acceptable once construction begins.