

# Harnett County Department of Public Health

## Improvement Permit

A building permit cannot be issued with only an Improvement Permit

ISSUED TO: Shakti, Jay Ambe PROPERTY LOCATION: 8920 US401 N  
 SUBDIVISION \_\_\_\_\_ LOT # \_\_\_\_\_  
 NEW  REPAIR  EXPANSION   
 Type of Structure: 6600 ft2 Conv Store Site Improvements required prior to Construction Authorization Issuance:  
Fence off drain field area. Submit pressure  
 Proposed Wastewater System Type: Accepted System  
 Projected Daily Flow: 1000 GPD manifold design  
 Number of bedrooms: \_\_\_\_\_ Number of Occupants: \_\_\_\_\_ max  
 Basement  Yes  No  
 Pump Required:  Yes  No  May be required based on final location and elevations of facilities  
 Type of Water Supply:  Community  Public  Well Distance from well \_\_\_\_\_ feet Permit valid for:  Five years  
 No expiration  
 Permit conditions: \_\_\_\_\_

Authorized State Agent: REHS Date: 12/19/23 SEE ATTACHED SITE SKETCH  
 The issuance of this permit by the Health Department in no way guarantees the substance of other permits. The permit holder is responsible for checking with appropriate governing bodies in meeting their requirements. This site is subject to revocation if the site plan, plat, or the intended use changes. The Improvement Permit shall not be affected by a change in ownership of the site. This permit is subject to compliance with the provisions of the Laws and Rules for Sewage Treatment and Disposal and to conditions of this permit.

## Construction Authorization

(Required for Building Permit)

The construction and installation requirements of Rules 1950, 1952, 1954, 1955, 1956, 1957, 1958, and 1959 are incorporated by references into this permit and shall be met. Systems shall be installed in accordance with the attached system layout.

ISSUED TO: JAY AMBE SHAKTI PROPERTY LOCATION: 8920 US401 N  
 SUBDIVISION \_\_\_\_\_ LOT # \_\_\_\_\_  
 Facility Type: 6600ft<sup>2</sup> CON STORE  New  Expansion  Repair  
 Basement?  Yes  No Basement Fixtures?  Yes  No  
 Type of Wastewater System\*\* ACCEPTED SYSTEM (Initial) Wastewater Flow: 1000 GPD  
 (See note below, if applicable  T+JPANEL)

<u>Installation Requirements/Conditions</u>	Number of trenches <u>4</u> (Repair) <del>5</del> <u>TOTAL 660'</u>	
Septic Tank Size <u>2000</u> gallons	Exact length of each trench <u>VARIOUS</u> feet	Trench Spacing: <u>9</u> Feet on Center
Pump Tank Size <u>2000</u> gallons	Trenches shall be installed on contour at a	Soil Cover: <u>12</u> inches
<u>GREASE TRAP 1000</u>	Maximum Trench Depth of: <u>24</u> inches	(Maximum soil cover shall not exceed 36" above the trench bottom)
	(Trench bottoms shall be level to +/-1/4" in all directions)	

Pump Requirements: \_\_\_\_\_ ft. TDH vs. \_\_\_\_\_ GPM \_\_\_\_\_ inches below pipe  
 Aggregate Depth: \_\_\_\_\_ inches above pipe  
 Conditions: SEE SITE SKETCH & MANIFOLD DESIGN ATTACHED  
ALL KITCHEN WASTE MUST ENTER GREASE TRAP

**WATER LINES (INCLUDING IRRIGATION) MUST BE 10FT. FROM ANY PART OF SEPTIC SYSTEM OR REPAIR AREA.**  
**NO UTILITIES ALLOWED IN INITIAL OR REPAIR DRAIN FIELD AREA.**

*\*\*If applicable: I understand the system type specified is different from the type specified on the application. I accept the specifications of this permit.*

Owner/Legal Representative Signature: \_\_\_\_\_ Date: \_\_\_\_\_

This Construction Authorization is subject to revocation if the site plan, plat, or the intended use changes. The Construction Authorization shall not be transferred when there is a change in ownership of the site. This Construction Authorization is subject to compliance with the provisions of the Laws and Rules for Sewage Treatment and Disposal and to the conditions of this permit. SEE ATTACHED SITE SKETCH

Authorized State Agent: REHS Date: 8/19/24  
 Construction Authorization Expiration Date: 8/19/29

Preliminary Septic Design  
Patel Gas Station  
(Champs)

2/19/21  
2/19/21

System: Pressure Manifold  
625+ Total feet of trench  
Lines 1-4  
0.4 LTAR  
24" Max Trench Bottom  
Accepted Status System  
Repair: Pressure Manifold  
0.4 LTAR  
24" Max Trench Bottom  
T&J Panel - 50% Reduction  
440' of trench

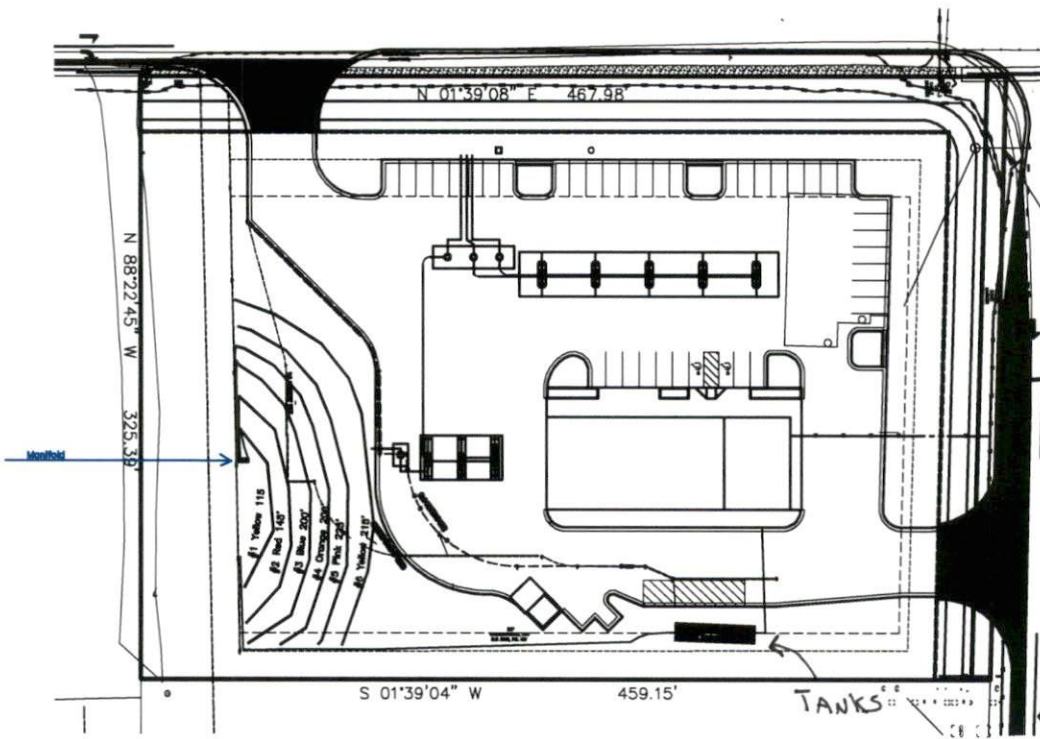

\*2000 Gallon Septic Tank  
\*2000 Gallon Pump Tank

Assume flow rate of 1000 gallon/day  
Final daily flow rate to be determined.

GRAPHIC SCALE  
1" = 100'



Adams  
Soil Consulting  
919-414-6761  
Project #963

