

REV	DATE	REVISION / ISSUE NAME
-	04/14/2023	PERMIT

PROJECT NO 2220380	DRAWN BY JB
PERMIT SUB DATE 04/14/2023	CHECKED BY RD

PROJECT
FOOD LION STORE #2594

3260 RAY ROAD
SPRING LAKE, NC 28390
2594FLMK23

CLIENT
FOOD LION

2110 EXECUTIVE DRIVE
SALISBURY, NC 28145
PH: 704-633-8250 F: 704-636-5940

SHEET TITLE
**ENLARGED DELI-BAKERY
FIXTURE PLAN**

SHEET NO 2594A4.01_00
A4.01

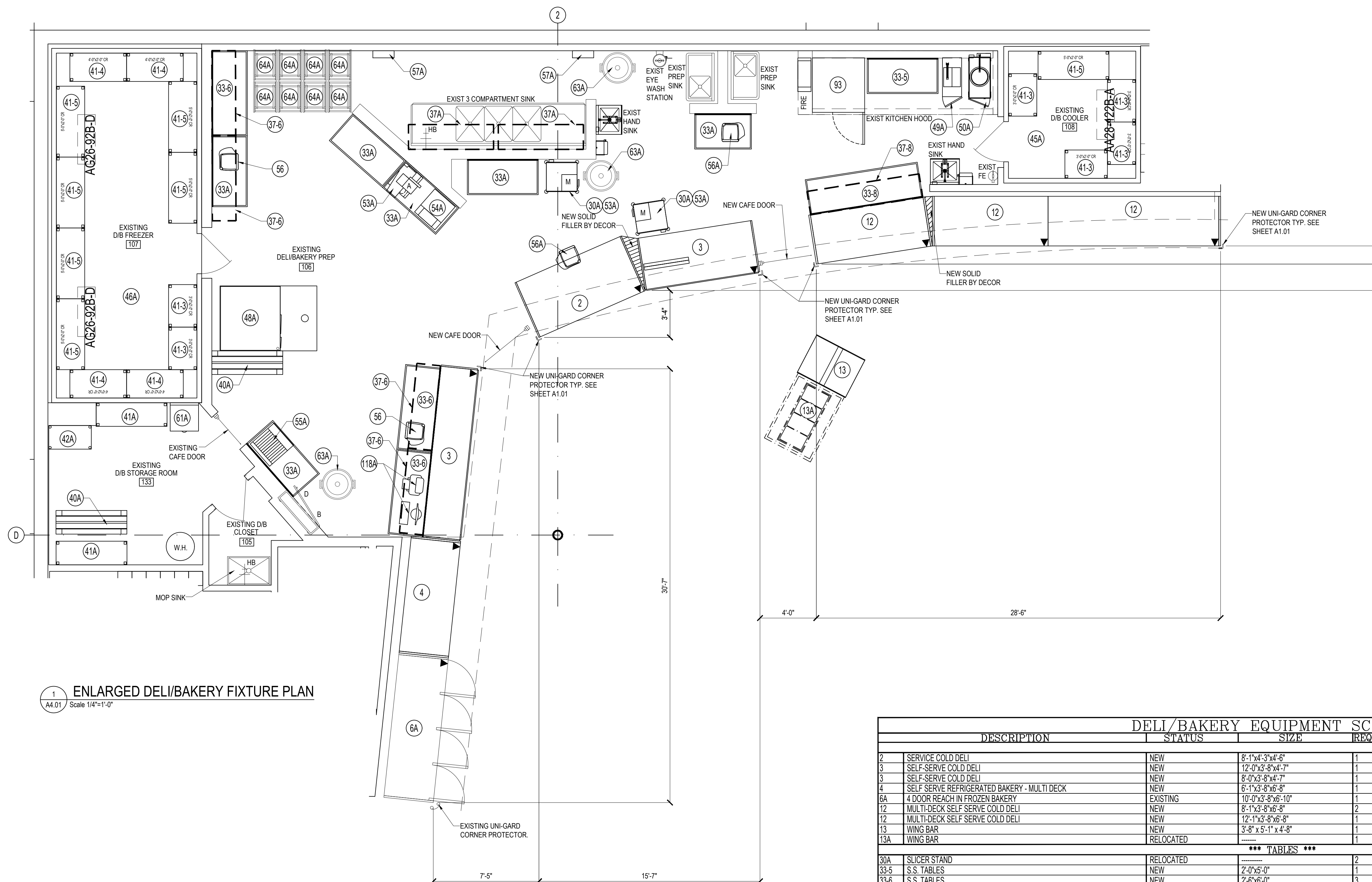

1 ENLARGED DELI/BAKERY FIXTURE PLAN
A4.01 Scale 1/4"=1'-0"

DELI/BAKERY GENERAL NOTES

- THE GENERAL CONTRACTOR IS RESPONSIBLE FOR COMPLIANCE WITH ALL HEALTH DEPARTMENT REQUIREMENTS.
- ACCESSORIES FOR PRESSURE FRYER: A. HEAVY DUTY GASTERS; B. FILTER HOSE.
- PLUMBING CONTRACTOR IS TO INSTALL ALL SINKS AND EYE WASH UNITS.
- THE MECHANICAL CONTRACTOR SHALL PROVIDE AND INSTALL MECHANICAL EQUIPMENT FOR THE DELI/BAKERY AS REQUIRED.
- THE EQUIPMENT LISTED IN THE DELI/BAKERY EQUIPMENT SCHEDULE IS SUPPLIED BY FOOD LION, AND IS SET IN PLACE BY FOOD LION'S REFRIGERATION CONTRACTOR. THE GENERAL CONTRACTOR IS RESPONSIBLE FOR ALL ELECTRICAL, PLUMBING, AND H.V.A.C. EQUIPMENT CONNECTIONS.
- THE GENERAL CONTRACTOR SHALL INSTALL THE BOAT RACKS THAT ARE PROVIDED BY FOOD LION. THE GENERAL CONTRACTOR SHALL COORDINATE THE EXACT LOCATION WITH A FOOD LION CONSTRUCTION SUPERVISOR.
- THE PAPER TOWEL HOLDERS ARE SUPPLIED BY FOOD LION AND INSTALLED BY THE GENERAL CONTRACTOR. INSTALL THE PAPER TOWEL HOLDERS AT 3'-0" ABOVE FINISHED FLOOR.
- MOUNT FLY TRAPS AT 9'-0" ABOVE FINISHED FLOOR IN DELI/BAKERY AND PRODUCE PREP.
- TWO ADDITIONAL 3-DIAMETER DISPLAY TABLES, MODEL N. 1010-100-1, SHALL BE SUPPLIED IF THE STORE HAS A REFRIGERATED FLORAL DISPLAY.
- THE GENERAL CONTRACTOR SHALL SUPPLY AND INSTALL TWO BROOM HANGERS AND THREE MOP HANGERS IN THE DELI. ALSO SUPPLY AND INSTALL A 12"x36" SHELF IN THE CLOSET AT 6'-0" ABOVE FINISHED FLOOR. COORDINATE LOCATION OF THE SHELF AND HANGERS WITH FOOD LION IF NOT ALREADY INSTALLED.
- THE GENERAL CONTRACTOR SHALL PROVIDE AND INSTALL A SYSTEM (3 ROWS OF 5 CLIPBOARD EACH) FOR HANGING FIFTEEN CLIPBOARDS ABOVE THE DESK IN THE DELI IF NOT ALREADY INSTALLED.

DELI/BAKERY EQUIPMENT SCHEDULE						
DESCRIPTION	STATUS	SIZE	REQD	MODEL	SUPPLIER/MANUFACTURER	
2 SERVICE COLD DELI	NEW	8'-1"x1'-3"x4'-6"	1	VR3HV-D-8-54	HUSSMANN	
3 SELF-SERVE COLD DELI	NEW	12'-0"x3'-8"x4'-7"	1	SSS-12-R-83	HUSSMANN	
3 SELF-SERVE COLD DELI	NEW	8'-0"x3'-8"x4'-7"	1	Q4-SS-54	HUSSMANN	
4 SELF-SERVE REFRIGERATED BAKERY - MULTI DECK	NEW	6'-1"x3'-8"x6'-8"	1	DSX	HUSSMANN	
6A 4 DOOR REACH IN FROZEN BAKERY	EXISTING	10'-0"x3'-8"x6'-10"	1			
12 MULTI-DECK SELF-SERVE COLD DELI	NEW	8'-1"x3'-8"x6'-8"	2	DSX	HUSSMANN	
12 MULTI-DECK SELF-SERVE COLD DELI	NEW	12'-1"x3'-8"x6'-8"	1	DSX	HUSSMANN	
13 WING BAR	NEW	3'-8" x 5'-1" x 4'-8"	1	MHPF3646-FF	ATLANTIC HOT FOOD BARS	
13A WING BAR	RELOCATED		1			
*** TABLES ***						
30A SLICER STAND	RELOCATED		2			
33-5 S.S. TABLES	NEW	2'-0"x6'-0"	1			
33-6 S.S. TABLES	NEW	2'-6"x6'-0"	3			
33-8 S.S. TABLES	NEW	2'-6"x6'-0"	1			
33A S.S. TABLES	EXISTING/RELOCATED		6			
*** BOAT RACKS ***						
37-6 BOAT RACK	NEW	6'-0"x1'-8"x2'-0"	4	MBR7220-2SH-FL	JOHN BOOS & COMPANY	
37-8 BOAT RACK	NEW	8'-0"x1'-8"x2'-0"	1	MBR9620-2SH-FL	JOHN BOOS & COMPANY	
37A BOAT RACKS	EXISTING		2			
*** STORAGE RACKS ***						
40A DUNNAGE RACKS	EXISTING		2			
41-3 COOLER RACKS	NEW	3'-0"x2'-0"	6	SU10-3624-4-T	CHOICE SHELVING	
41-4 COOLER RACKS	NEW	4'-0"x2'-0"	4	SU10-4824-4-T	CHOICE SHELVING	
41-5 COOLER RACKS	NEW	5'-0"x2'-0"	7	SU10-6024-4-T	CHOICE SHELVING	
41A COOLER RACKS	EXISTING		2			
42A WIRE RACKS	EXISTING		1			
*** COOLER AND FREEZER ***						
45A WALK-IN COOLER - DELI/BAKERY	EXISTING		1			
46A WALK-IN FREEZER - DELI/BAKERY	EXISTING		1			
*** ELECTRIC COOKING/HOLDING EQUIPMENT ***						
48A SINGLE RACK OVEN - ELECTRIC	EXISTING		1			
49A FRYER AND FILTER (SEE NOTE No. 2)	RELOCATED		1			
50A BASKET FRYER	RELOCATED		1			
93 CONNECTION OVEN W/ GREASE CART & STAND	NEW	3'-2"x3'-1"	1	CTP7-20E & 5034845	BLODGETT	
*** ELECTRIC PREP EQUIPMENT ***						
53A SLICERS - 2 MANUAL 1 AUTOMATIC	EXISTING/RELOCATED		3			
54A WRAPPING MACHINE	RELOCATED		1			
55A BREAD SLICER	RELOCATED		1			
56A SCALE w/BUILT IN PRINTER	NEW	1'-3"x1'-5"x1'-6"	2	HTI/HWS-ES	HOBART	
56A SCALE	EXISTING/RELOCATED		2			
57A FLY TRAP (SEE NOTE No. 8)	EXISTING		2			
118A CAKE DECORATOR/PRINTER	RELOCATED		1			
*** NON-ELECTRIC PREP EQUIPMENT ***						
61A DESK (WALL MOUNTED)	EXISTING		1			
63A TRASH CAN	EXISTING		3			
64A OVEN RACK (PLATTER CART)	EXISTING		8			