

- KEYED NOTES: #
1. INSTALL THE HEAT AND SMOKE DETECTORS WITHIN 2' OF THE SPRINKLER HEAD. ACTIVATION OF THE SMOKE DETECTOR SHALL INITIATE ELEVATOR RECALL TO THE ALTERNATE RECALL FLOOR. ACTIVATION OF THE HEAT DETECTOR SHALL INITIATE THE DELAYED REMOVAL OF POWER FROM THE ELEVATOR.

1
FA-1 FIRST FLOOR FIRE ALARM PLAN
Scale: 1/8"=1'-0"



NO.	DATE	REVISION	BY

PATTERSON
GROUP SERVICES
POWERED BY **API GROUP**
1824 DOUGLAS DRIVE
SANFORD, NC 27330
(919) 776-2403
NC LICENSE # 30023-SP-FALV

FIRE ALARM SYSTEM FOR:
**CFVH HARNETT MOB -
CORE & SHELL**
225 BRIGHTWATER DRIVE
LILLINGTON, NC 27546

FIRST FLOOR
FIRE ALARM PLAN

DATE:	10/30/2023
DRAWN BY:	JRC
CHECKED BY:	CP
SCALE:	1/8"=1'-0"

SHEET:
FA-1

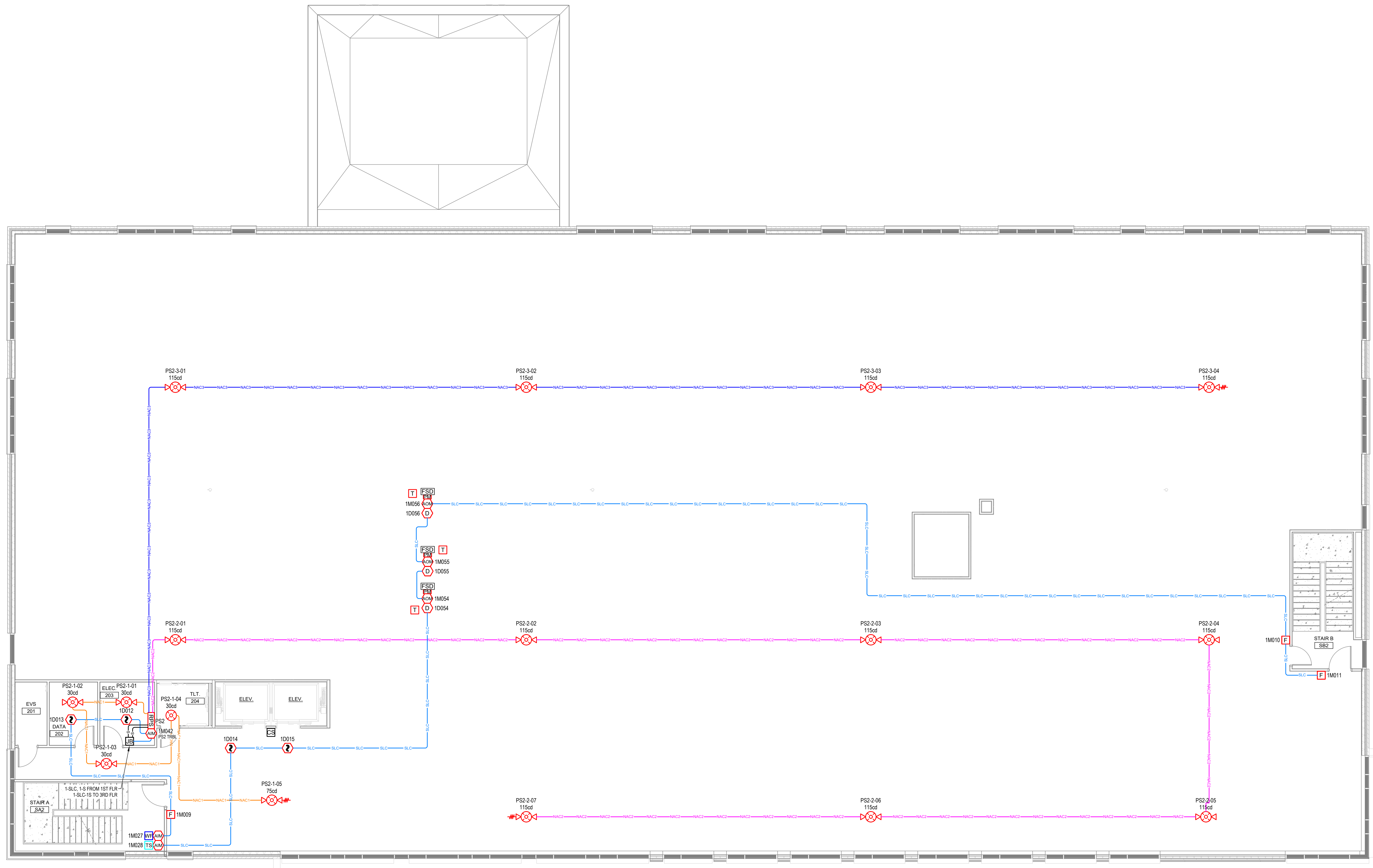

1 SECOND FLOOR FIRE ALARM PLAN
 FA-2 Scale: 1/8"=1'-0"

NO.	DATE	REVISION	BY

PATTERSON
GROUP SERVICES
 POWERED BY **API GROUP**
 1824 DOUGLAS DRIVE
 SANFORD, NC 27330
 (919) 776-2403
 NC LICENSE # 30023-SP-FALV

FIRE ALARM SYSTEM FOR:
CFVH HARNETT MOB -
CORE & SHELL
 225 BRIGHTWATER DRIVE
 LILLINGTON, NC 27546

SECOND FLOOR
 FIRE ALARM PLAN

DATE:	10/30/2023
DRAWN BY:	JRC
CHECKED BY:	CP
SCALE:	1/8"=1'-0"

SHEET:
FA-2

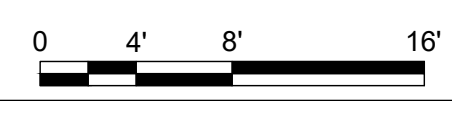

KEYED NOTES: #

1. VERIFY THE LOCATION OF THE ELEVATOR CONTROLLER PRIOR TO ROUGH-IN. INSTALL A HEAT DETECTOR WITHIN 2' FEET OF ANY SPRINKLER HEAD THAT IS WITHIN 15' OF THE ELEVATOR CONTROLLER EQUIPMENT.

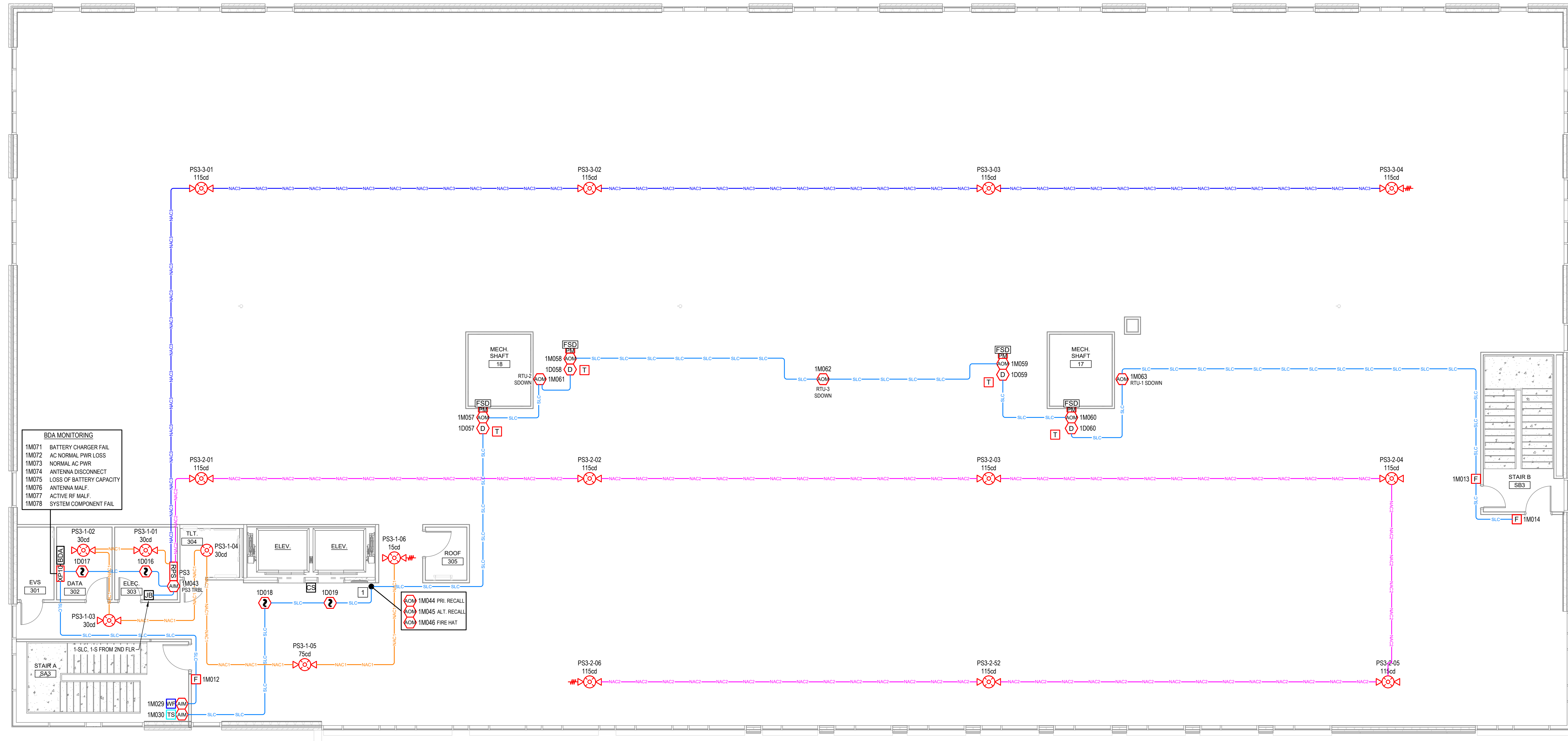

1 THIRD FLOOR FIRE ALARM PLAN
FA-3 Scale: 1/8"=1'-0"

NO.	DATE	REVISION	BY

PATTERSON
GROUP SERVICES
POWERED BY **API GROUP**
1824 DOUGLAS DRIVE
SANFORD, NC 27330
(919) 776-2403
NC LICENSE # 30023-SP-FALV

FIRE ALARM SYSTEM FOR:
CFVH HARNETT MOB -
CORE & SHELL
225 BRIGHTWATER DRIVE
LILLINGTON, NC 27546

THIRD FLOOR
FIRE ALARM PLAN

DATE:	10/30/2023
DRAWN BY:	JRC
CHECKED BY:	CP
SCALE:	1/8"=1'-0"

SHEET:
FA-3



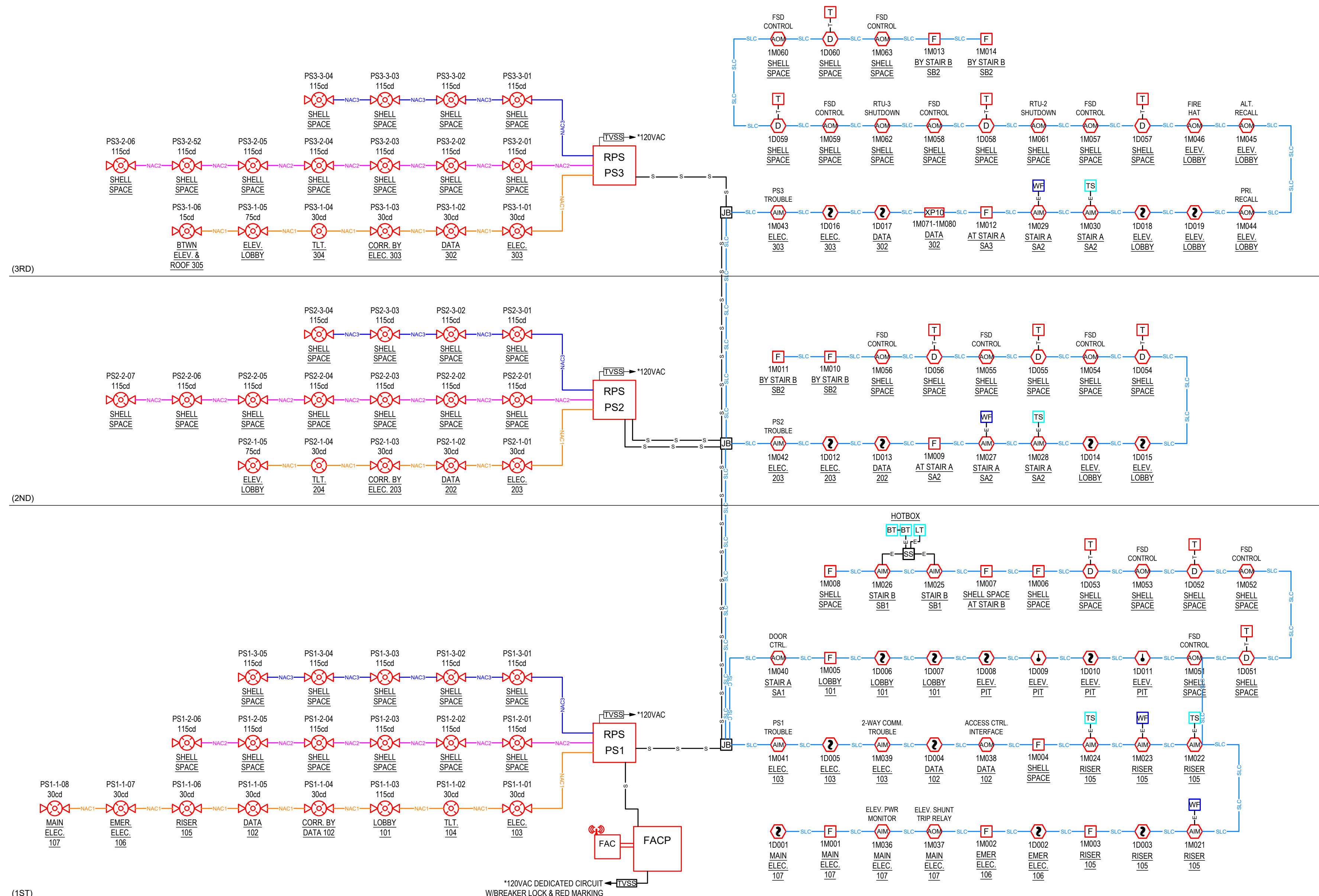

1 FIRE ALARM RISER
FA-4 Scale: None

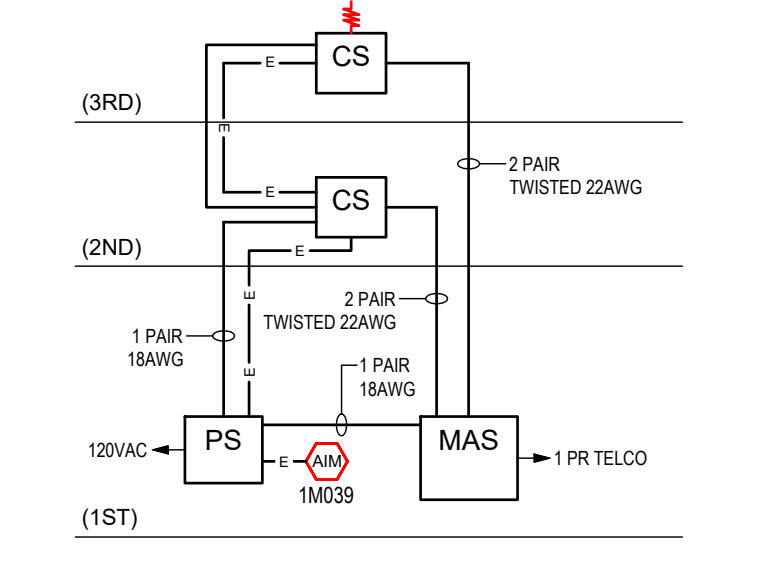

2 AOR/2-WAY COMM. SYSTEM RISER
FA-4 Scale: None

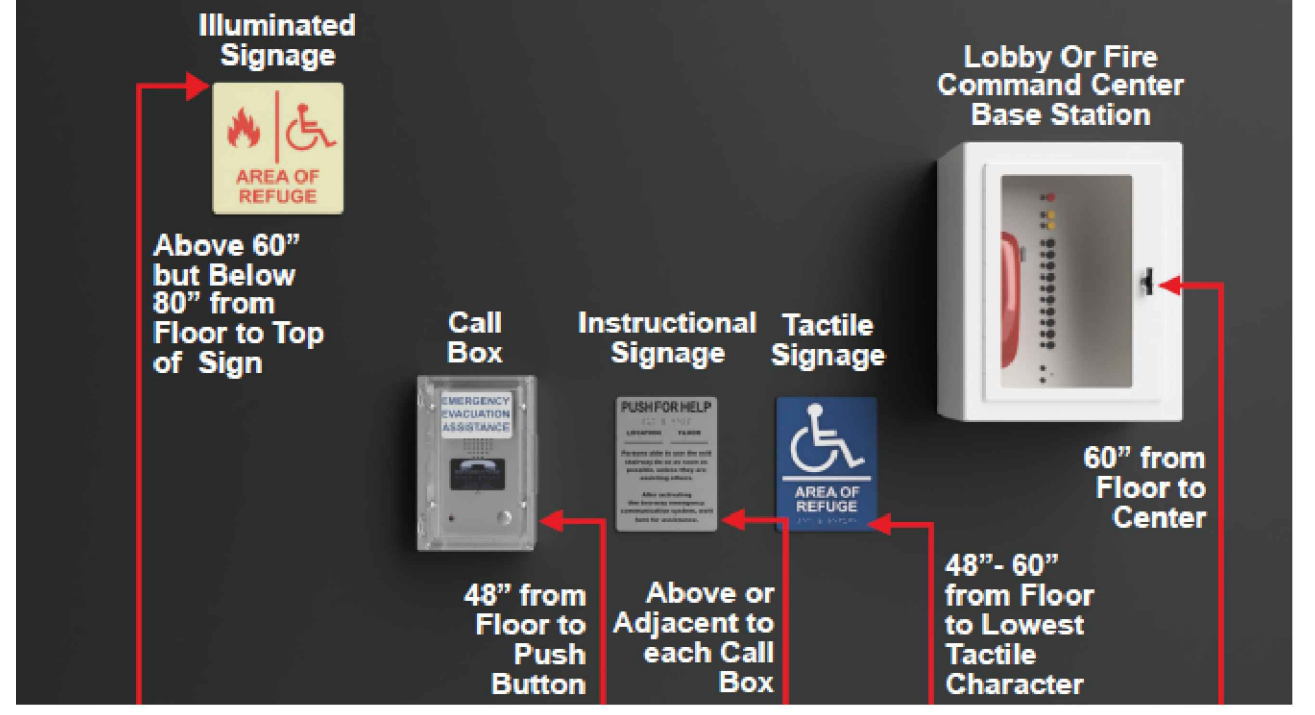

3 AOR/2-WAY COMM. MOUNTING HEIGHTS
FA-4 Scale: None

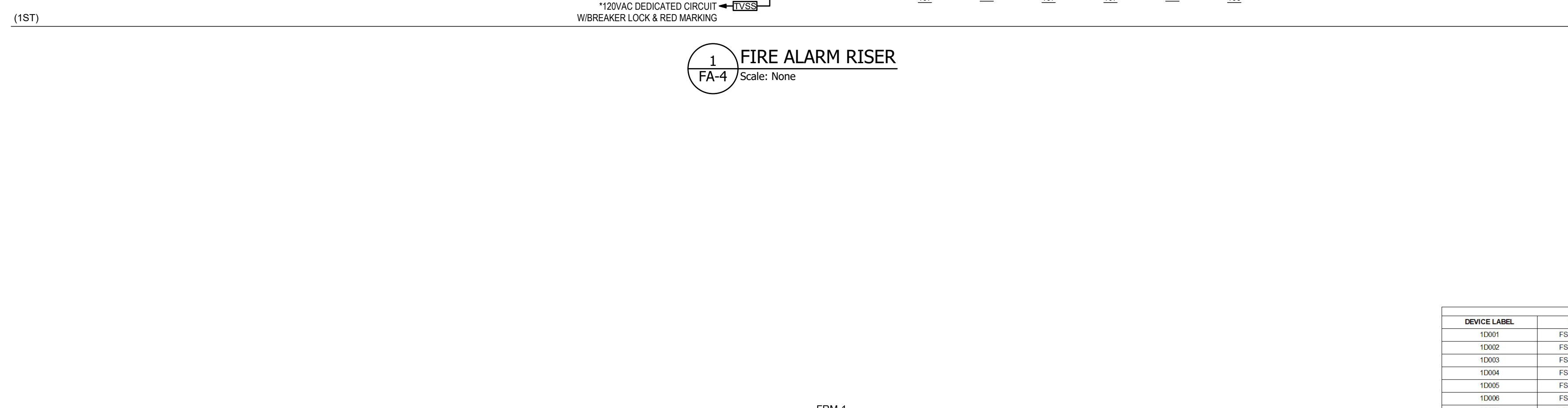

4 ELEVATOR SHUNT TRIP SUPERVISORY DETAIL
FA-4 Scale: None

CFVH HARNETT MOB CORE & SHELL DETECTOR SCHEDULE

DEVICE LABEL	PART NO.	DESCRIPTION	FLOOR	LOCATION	COMMENTS
10001	FSP-85183004	SMOKE SENSOR	1	MAIN ELEC. 107	
10002	FSP-85183004	SMOKE SENSOR	1	EMER. ELEC. 106	
10003	FSP-85183004	SMOKE SENSOR	1	RISER 105	
10004	FSP-85183004	SMOKE SENSOR	1	DATA 102	
10005	FSP-85183004	SMOKE SENSOR	1	ELEC. 103	
10006	FSP-85183004	SMOKE SENSOR	1	LOBBY 101	ELEVATOR RECALL
10007	FSP-85183004	SMOKE SENSOR	1	LOBBY 101	ELEVATOR RECALL
10008	FSP-85183004	SMOKE SENSOR	1	ELEVATOR PIT	ELEVATOR RECALL
10009	FST-85183006	HEAT SENSOR	1	ELEVATOR PIT	ELEV. SHUNT TRIP
10010	FSP-85183004	SMOKE SENSOR	1	ELEVATOR PIT	ELEVATOR RECALL
10011	FST-85183006	HEAT SENSOR	1	ELEVATOR PIT	ELEV. SHUNT TRIP
10012	FSP-85183004	SMOKE SENSOR	2	ELEC. 203	
10013	FSP-85183004	SMOKE SENSOR	2	DATA 202	
10014	FSP-85183004	SMOKE SENSOR	2	ELEVATOR LOBBY	ELEVATOR RECALL
10015	FSP-85183004	SMOKE SENSOR	2	ELEVATOR LOBBY	ELEVATOR RECALL
10016	FSP-85183004	SMOKE SENSOR	3	ELEC. 303	
10017	FSP-85183004	SMOKE SENSOR	3	DATA 302	
10018	FSP-85183004	SMOKE SENSOR	3	ELEVATOR LOBBY	ELEVATOR RECALL
10019	FSP-85183004	SMOKE SENSOR	3	ELEVATOR LOBBY	ELEVATOR RECALL
10020	DNRASD-PL3R	DUCT DETECTOR	1	TENANT SPACE	FOR FIRE/SMOKE DAMPER
10021	DNRASD-PL3R	DUCT DETECTOR	1	TENANT SPACE	FOR FIRE/SMOKE DAMPER
10022	DNRASD-PL3R	DUCT DETECTOR	1	TENANT SPACE	FOR FIRE/SMOKE DAMPER
10023	DNRASD-PL3R	DUCT DETECTOR	1	TENANT SPACE	FOR FIRE/SMOKE DAMPER
10024	DNRASD-PL3R	DUCT DETECTOR	2	TENANT SPACE	FOR FIRE/SMOKE DAMPER
10025	DNRASD-PL3R	DUCT DETECTOR	2	TENANT SPACE	FOR FIRE/SMOKE DAMPER
10026	DNRASD-PL3R	DUCT DETECTOR	2	TENANT SPACE	FOR FIRE/SMOKE DAMPER
10027	DNRASD-PL3R	DUCT DETECTOR	2	TENANT SPACE	FOR FIRE/SMOKE DAMPER
10028	DNRASD-PL3R	DUCT DETECTOR	3	TENANT SPACE	FOR FIRE/SMOKE DAMPER
10029	DNRASD-PL3R	DUCT DETECTOR	3	TENANT SPACE	FOR FIRE/SMOKE DAMPER
10030	DNRASD-PL3R	DUCT DETECTOR	3	TENANT SPACE	FOR FIRE/SMOKE DAMPER

CFVH HARNETT MOB CORE & SHELL MODULE SCHEDULE

DEVICE LABEL	PART NO.	DESCRIPTION	FLOOR	LOCATION	COMMENTS
1M001	NBG-12LX	PULL STATION	1	MAIN ELEC. 107	
1M002	NBG-12LX	PULL STATION	1	EMER. ELEC. 106	
1M003	NBG-12LX	PULL STATION	1	RISER 105	
1M004	NBG-12LX	PULL STATION	1	TENANT SPACE NR DATA 102	
1M005	NBG-12LX	PULL STATION	1	LOBBY 101	
1M006	NBG-12LX	PULL STATION	1	TENANT SPACE	
1M007	NBG-12LX	PULL STATION	1	TENANT SPACE BY STAIR B	
1M008	NBG-12LX	PULL STATION	1	TENANT SPACE	
1M009	NBG-12LX	PULL STATION	2	STAR A	
1M010	NBG-12LX	PULL STATION	2	STAR B	
1M011	NBG-12LX	PULL STATION	2	STAR B	
1M012	NBG-12LX	PULL STATION	2	STAR A	
1M013	NBG-12LX	PULL STATION	2	STAR B	
1M014	NBG-12LX	PULL STATION	2	STAR B	
1M021	FMM-1	MONITOR MODULE	1	RISER 105	MAIN WATERFLOW
1M022	FMM-1	MONITOR MODULE	1	RISER 105	MAN TAMPER
1M023	FMM-1	MONITOR MODULE	1	RISER 105	1ST FLOOR WATERFLOW
1M024	FMM-1	MONITOR MODULE	1	RISER 105	1ST FLOOR TAMPER
1M025	FMM-1	MONITOR MODULE	1	STAR B	BACKFLOW TAMPERS
1M026	FMM-1	MONITOR MODULE	1	STAR B	HOTBOX/LOW TEMPERATURE
1M027	FMM-1	MONITOR MODULE	2	STAR A	2ND FLOOR WATERFLOW
1M028	FMM-1	MONITOR MODULE	2	STAR A	2ND FLOOR TAMPER
1M029	FMM-1	MONITOR MODULE	3	STAR A	3RD FLOOR WATERFLOW
1M030	FMM-1	MONITOR MODULE	3	STAR A	3RD FLOOR TAMPER
1M031	FMM-1	MONITOR MODULE	1	MAIN ELEC. 107	ELEV. SHUNT PWR MONITOR
1M032	FRM-1	RELAY MODULE	1	EMER. ELEC. 106	ELEV. SHUNT TRIP RELAY
1M033	FRM-1	RELAY MODULE	1	DATA 102	ACCESS CONTROL INTERFACE
1M034	FMM-1	MONITOR MODULE	1	ELEC. 103	2-WAY COMM. TROUBLE
1M040	FRM-1	RELAY MODULE	1	STAR A	DOOR RELEASE
1M041	FMM-1	MONITOR MODULE	1	ELEC. 103	PS1 TROUBLE
1M042	FMM-1	MONITOR MODULE	2	ELEC. 203	PS2 TROUBLE
1M043	FMM-1	MONITOR MODULE	3	ELEC. 303	PS3 TROUBLE
1M044	FRM-1	RELAY MODULE	3	ELEV. LOBBY	PRIMARY RECALL
1M045	FRM-1	RELAY MODULE	3	ELEV. LOBBY	ALTERNATE RECALL
1M046	FRM-1	RELAY MODULE	3	ELEV. LOBBY	FIRE HAT
1M051	FRM-1	RELAY MODULE	1	TENANT SPACE	FIRE/SMOKE DAMPER CONTROL
1M052	FRM-1	RELAY MODULE	1	TENANT SPACE	FIRE/SMOKE DAMPER CONTROL
1M053	FRM-1	RELAY MODULE	1	TENANT SPACE	FIRE/SMOKE DAMPER CONTROL
1M054	FRM-1	RELAY MODULE	2	TENANT SPACE	FIRE/SMOKE DAMPER CONTROL
1M055	FRM-1	RELAY MODULE	2	TENANT SPACE	FIRE/SMOKE DAMPER CONTROL
1M056	FRM-1	RELAY MODULE	2	TENANT SPACE	FIRE/SMOKE DAMPER CONTROL
1M057	FRM-1	RELAY MODULE	3	TENANT SPACE	FIRE/SMOKE DAMPER CONTROL
1M058	FRM-1	RELAY MODULE	3	TENANT SPACE	FIRE/SMOKE DAMPER CONTROL
1M059	FRM-1	RELAY MODULE	3	TENANT SPACE	FIRE/SMOKE DAMPER CONTROL
1M060	FRM-1	RELAY MODULE	3	TENANT SPACE	FIRE/SMOKE DAMPER CONTROL
1M061	FRM-1	RELAY MODULE	3	TENANT SPACE	RTU-2 SHUTDOWN
1M062	FRM-1	RELAY MODULE	3	TENANT SPACE	RTU-3 SHUTDOWN
1M063	FRM-1	RELAY MODULE	3	TENANT SPACE	RTU-1 SHUTDOWN

5 DEVICE ADDRESS SCHEDULE
FA-4 Scale: None

BY	
REVISION	
DATE	
NO.	

PATTERSON
GROUP SERVICES
POWERED BY API GROUP
1824 DOUGLAS DRIVE
SANFORD, NC 27330
(919) 776-2403
NC LICENSE # 30023-SP-FALLY

FIRE ALARM SYSTEM FOR:
CFVH HARNETT MOB - CORE & SHELL
225 BRIGHTWATER DRIVE
LILLINGTON, NC 27546

THIRD FLOOR
FIRE ALARM PLAN

DATE: 10/30/2023
DRAWN BY: JRC
CHECKED BY: CP
SCALE: 1/8"=1'-0"

SHEET:
FA-4