

DOOR SCHEDULE

DOOR NO.	DOOR SIZE			REMARKS
	WIDE	HIGH	THICK.	
01	3'-0"	7'-0"	1 3/4"	INTERIOR WOOD SLIDING DOOR
02	3'-0"	7'-0"	1 3/4"	INTERIOR WOOD DOOR: HM FRAME
03	3'-0"	7'-0"	1 3/4"	INTERIOR WOOD DOOR: HM FRAME
04	2'-6"	7'-0"	1 3/4"	INTERIOR WOOD DOOR: HM FRAME
05	3'-0"	7'-0"	1 3/4"	INTERIOR WOOD DOOR: HM FRAME
06	3'-0"	7'-0"	1 3/4"	INTERIOR WOOD DOOR: HM FRAME
07	3'-0"	7'-0"	1 3/4"	INTERIOR WOOD DOOR: HM FRAME
08	3'-0"	7'-0"	1 3/4"	INTERIOR WOOD DOOR: HM FRAME
09	3'-0"	7'-0"	1 3/4"	INTERIOR WOOD DOOR: HM FRAME
10	3'-0"	7'-0"	1 3/4"	INTERIOR WOOD DOOR: HM FRAME
11	3'-0"	7'-0"	1 3/4"	INTERIOR WOOD DOOR: HM FRAME
12	3'-0"	7'-0"	1 3/4"	INTERIOR WOOD DOOR: HM FRAME
13	3'-0"	7'-0"	1 3/4"	INTERIOR WOOD DOOR: HM FRAME
14	3'-0"	7'-0"	1 3/4"	INTERIOR WOOD DOOR: HM FRAME
15	3'-0"	7'-0"	1 3/4"	INTERIOR WOOD DOOR: HM FRAME
16	3'-0"	7'-0"	1 3/4"	INTERIOR WOOD DOOR: HM FRAME
17	3'-0"	7'-0"	1 3/4"	INTERIOR WOOD DOOR: HM FRAME
18	3'-0"	7'-0"	1 3/4"	INTERIOR WOOD DOOR: HM FRAME
19	3'-0"	7'-0"	1 3/4"	INTERIOR WOOD DOOR: HM FRAME
20	3'-0"	7'-0"	1 3/4"	INTERIOR WOOD SLIDING DOOR

KEYNOTES:

- 1 FURROUT WALL & PROVIDE ACCESS PANEL FOR DOMESTIC WATER SUPPLY FOR WATER SERVICE ENTRANCE (SEE SHEET P-1)
- 2 2-1/2" 20 GA. METAL STUD @ 16" O.C.
- 3 6" 18 GA METAL STUDS @ 16" O.C. TO ROOF DECK
- 4 3-5/8" 20 GA. METAL STUD @ 16" O.C.
- 5 6" 20 GA METAL STUDS @ 16" O.C.

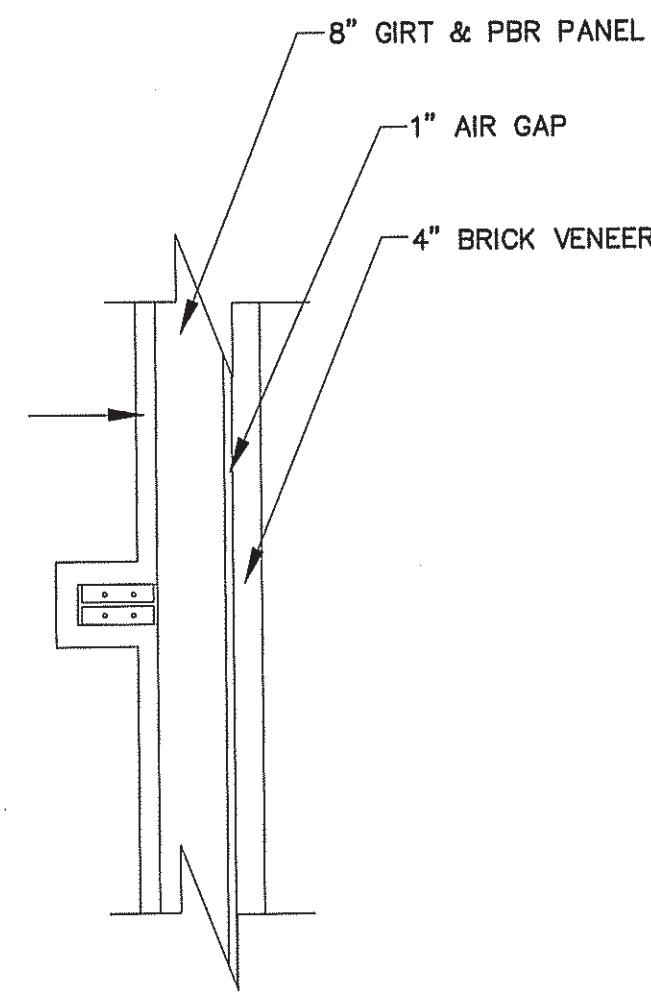

PROPOSED WALL DETAIL
SCALE: NOT TO SCALE

ROOM NO.	ROOM NAME	FLOOR				BASE				WALLS				CEL. HT.		CLG.		REMARKS
		CONCRETE	CARPET	TILE	VCT	WOOD	CERAMIC TILE	RUBBER BASE	NONE	BRICK	1/2" DRYWALL	CERAMIC TILE	FRP	10'-0"+	11'-0"+	NONE	DRYWALL	
100	LOBBY			X				X	X	X	X	X	10'-0"+	X				
101	CONFERENCE ROOM			X				X	X	X	X	X	10'-0"+	X				
102	OFFICE			X				X	X	X	X	X	10'-0"+	X				
103	UNISEX RESTROOM			X				X	X	X	X	X	10'-0"+	X				
104	OFFICE 2			X				X	X	X	X	X	10'-0"+	X				
105	OFFICE 3			X				X	X	X	X	X	10'-0"+	X				
106	BREAKROOM			X				X	X	X	X	X	10'-0"+	X				
107	OFFICE 4			X				X	X	X	X	X	10'-0"+	X				
108	WAREHOUSE	X								X			NONE	X				
200	OPEN FLOOR AREA			X				X	X	X	X	X	11'-0"+	X				*
201	OFFICE 1			X				X	X	X	X	X	10'-0"+	X				
202	OFFICE 2			X				X	X	X	X	X	10'-0"+	X				
203	STORAGE			X				X	X	X	X	X	10'-0"+	X				
204	CORRIDOR			X				X	X	X	X	X	10'-0"+	X				
205	UNISEX RESTROOM			X				X	X	X	X	X	10'-0"+	X				
300	OPEN FLOOR AREA			X				X	X	X	X	X	11'-0"+	X				*
301	OFFICE 1			X				X	X	X	X	X	10'-0"+	X				
302	OFFICE 2			X				X	X	X	X	X	10'-0"+	X				
303	STORAGE			X				X	X	X	X	X	10'-0"+	X				
304	CORRIDOR			X				X	X	X	X	X	10'-0"+	X				
305	UNISEX RESTROOM			X				X	X	X	X	X	10'-0"+	X				
400	LOBBY			X				X	X	X	X	X	11'-0"+	X				*
401	UNISEX RESTROOM			X				X	X	X	X	X	10'-0"+	X				
402	OFFICE 1			X				X	X	X	X	X	10'-0"+	X				
403	WAREHOUSE			X						X			NONE	X				

OWNER TO VERIFY ALL COLORS, HEIGHTS, AND FINISHES BEFORE ORDERING MATERIALS
*COORDINATE CEILING HEIGHT WITH HEIGHT OF STOREFRONT GLASS.

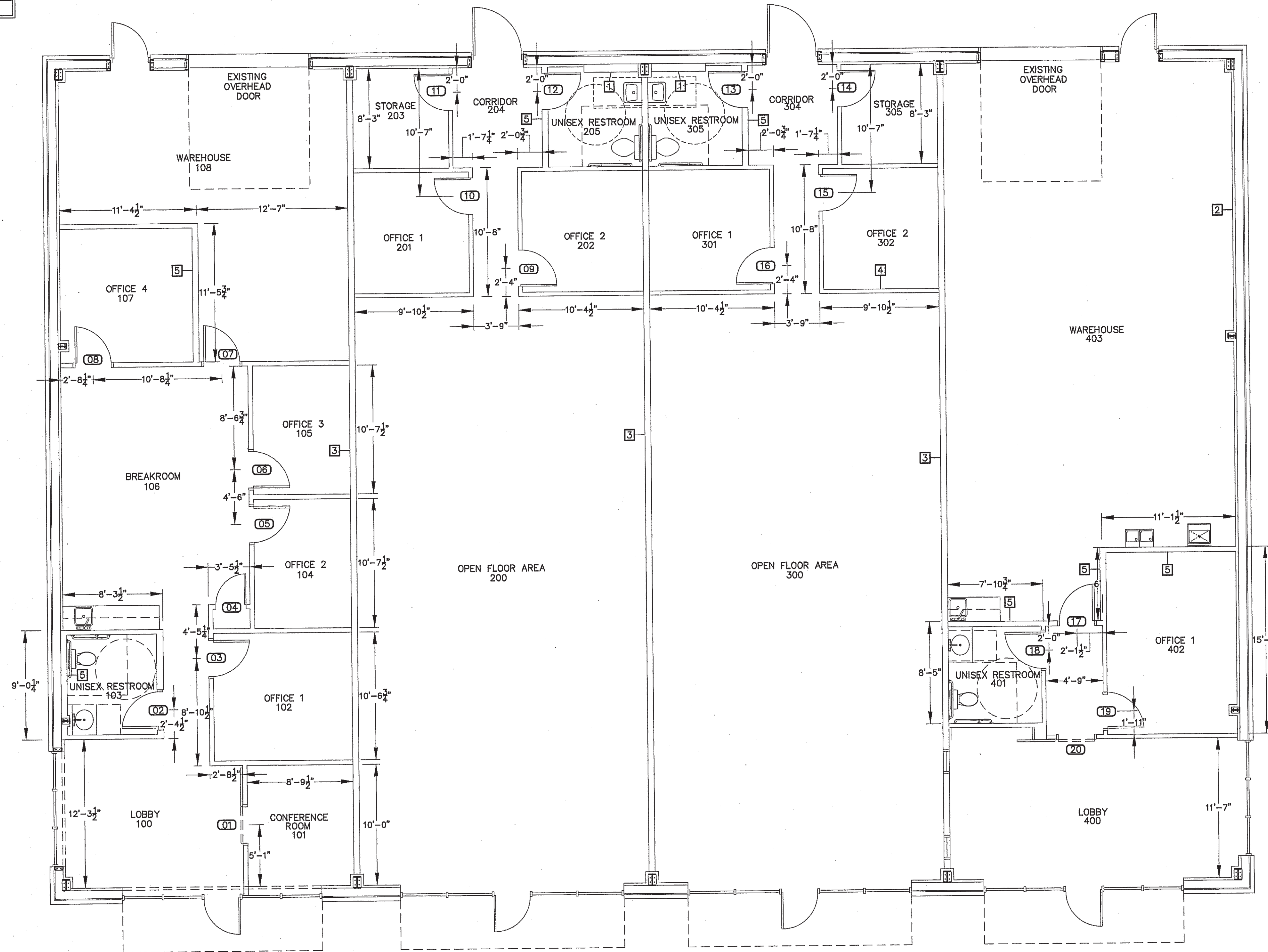

PROPOSED FLOOR PLAN
SCALE: 3/16" = 1'-0"

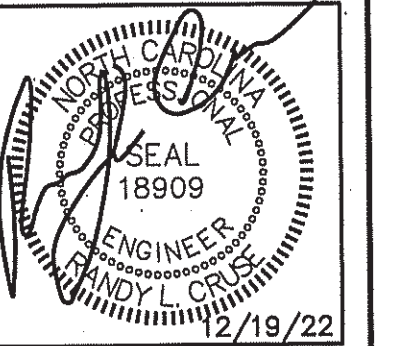

UP-FIT PLANS FOR:
T&L COATS
BUILDING #2
COATS, NORTH CAROLINA

REVISIONS

NO.	

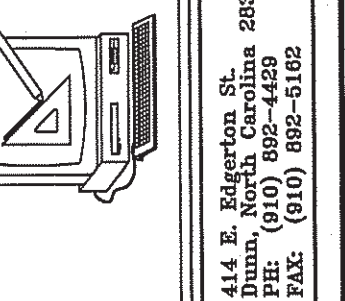

Cruse and Associates, P.A.

THESE DOCUMENTS ARE INSTRUMENTS OF SERVICE AND AS SUCH THESE DRAWINGS, DESIGNS, AND DESIGN CONCEPTS PRESENTED REMAIN THE PROPERTY OF THE ENGINEER. PUBLISHED OR DUPLICATED DRAWINGS OR DESIGNS WITHOUT THE WRITTEN PERMISSION OF THE ENGINEER.
© COPY RIGHT

DATE 12-19-22
DRAWN BY BAM
JOB NO. 22-60

SHEET NO.
F-1 OF 2