

Harnett County Department of Public Health Improvement Permit

A building permit cannot be issued with only an Improvement Permit

ISSUED TO: Land 2020 inc PROPERTY LOCATION: 555 Alpine Dr. (SR 1141)
 SUBDIVISION _____ LOT # _____
 NEW REPAIR EXPANSION Site Improvements required prior to Construction Authorization Issuance: _____
 Type of Structure: Storage facility and office
 Proposed Wastewater System Type: Pump to 25% reduction
 Projected Daily Flow: 100 GPD
 Number of bedrooms: _____ Number of Occupants: 1 max
 Basement Yes No
 Pump Required: Yes No May be required based on final location and elevations of facilities
 Type of Water Supply: Community Public Well Distance from well _____ feet Permit valid for: Five years
 No expiration
 Permit conditions: _____

Authorized State Agent: *M. A. RETT* Date: 12-5-22 SEE ATTACHED SITE SKETCH
 The issuance of this permit by the Health Department in no way guarantees the issuance of other permits. The permit holder is responsible for checking with appropriate governing bodies in meeting their requirements. This site is subject to revocation if the site plan, plat, or the intended use changes. The Improvement Permit shall not be affected by a change in ownership of the site. This permit is subject to compliance with the provisions of the Laws and Rules for Sewage Treatment and Disposal and to conditions of this permit.

Construction Authorization (Required for Building Permit)

The construction and installation requirements of Rules .1950, .1952, .1954, .1955, .1956, .1957, .1958, and .1959 are incorporated by references into this permit and shall be met. Systems shall be installed in accordance with the attached system layout.

ISSUED TO: Land 2020 inc PROPERTY LOCATION: 555 Alpine Dr. (SR 1141)
 SUBDIVISION _____ LOT # _____
 Facility Type: Storage facility and office New Expansion Repair
 Basement? Yes No Basement Fixtures? Yes No
 Type of Wastewater System** Pump to 25% reduction (Initial) Wastewater Flow: 100 GPD
 (See note below, if applicable Pump to 25% reduction (Repair)
 Installation Requirements/Conditions
 Septic Tank Size 1000 gallons Number of trenches 1
 Pump Tank Size _____ gallons Exact length of each trench 50 feet Trench Spacing: _____ Feet on Center
 Trenches shall be installed on contour at a Soil Cover: 6 inches
 Maximum Trench Depth of: 18-30 inches (Maximum soil cover shall not exceed
 (Trench bottoms shall be level to +/-1/4" 36" above the trench bottom)
 in all directions)
 Pump Requirements: _____ ft. TDH vs. _____ GPM _____ inches below pipe
 Aggregate Depth: _____ inches above pipe
 _____ inches total
 Conditions: _____

**WATER LINES (INCLUDING IRRIGATION) MUST BE 10FT. FROM ANY PART OF SEPTIC SYSTEM OR REPAIR AREA.
 NO UTILITIES ALLOWED IN INITIAL OR REPAIR DRAIN FIELD AREA.**

**If applicable: I understand the system type specified is different from the type specified on the application. I accept the specifications of this permit.
 Owner/Legal Representative Signature: _____ Date: _____

This Construction Authorization is subject to revocation if the site plan, plat, or the intended use changes. The Construction Authorization shall not be transferred when there is a change in ownership of the site. This Construction Authorization is subject to compliance with the provisions of the Laws and Rules for Sewage Treatment and Disposal and to the conditions of this permit. SEE ATTACHED SITE SKETCH

Authorized State Agent: *M. A. RETT* Date: 12-5-22
 Construction Authorization Expiration Date: 12-5-27

Application # BCOM2211-0015

Harnett County Department of Public Health Site Sketch

Property Location: 555 Alpine Dr. (SR 1141)

Issued To: Land 2020 inc Subdivision _____ Lot # _____

Authorized State Agent: Mark D. RGAH Date: 12-5-22

★ Call for layout before the day of install for septic system
Keep septic tank + Pump tank 7' off of Building
Drain Line will be 50' long, 3' wide, with MTD of 30" (Keep on contour
← ~700' →

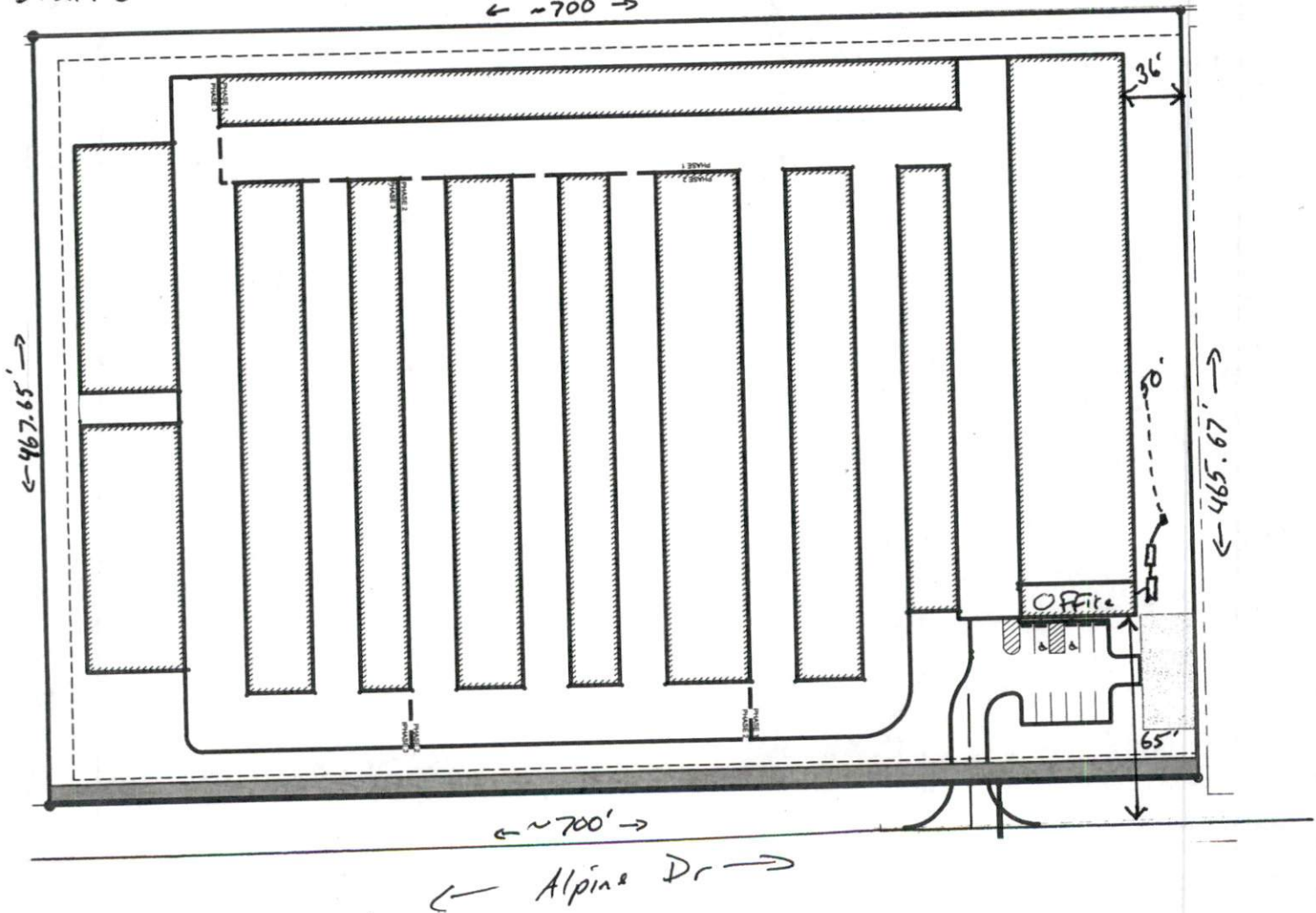

This drawing is for illustrative purposes only. System installation must meet all pertinent laws, rules, and regulations.