

3266 RAY ROAD

3274 RAY ROAD

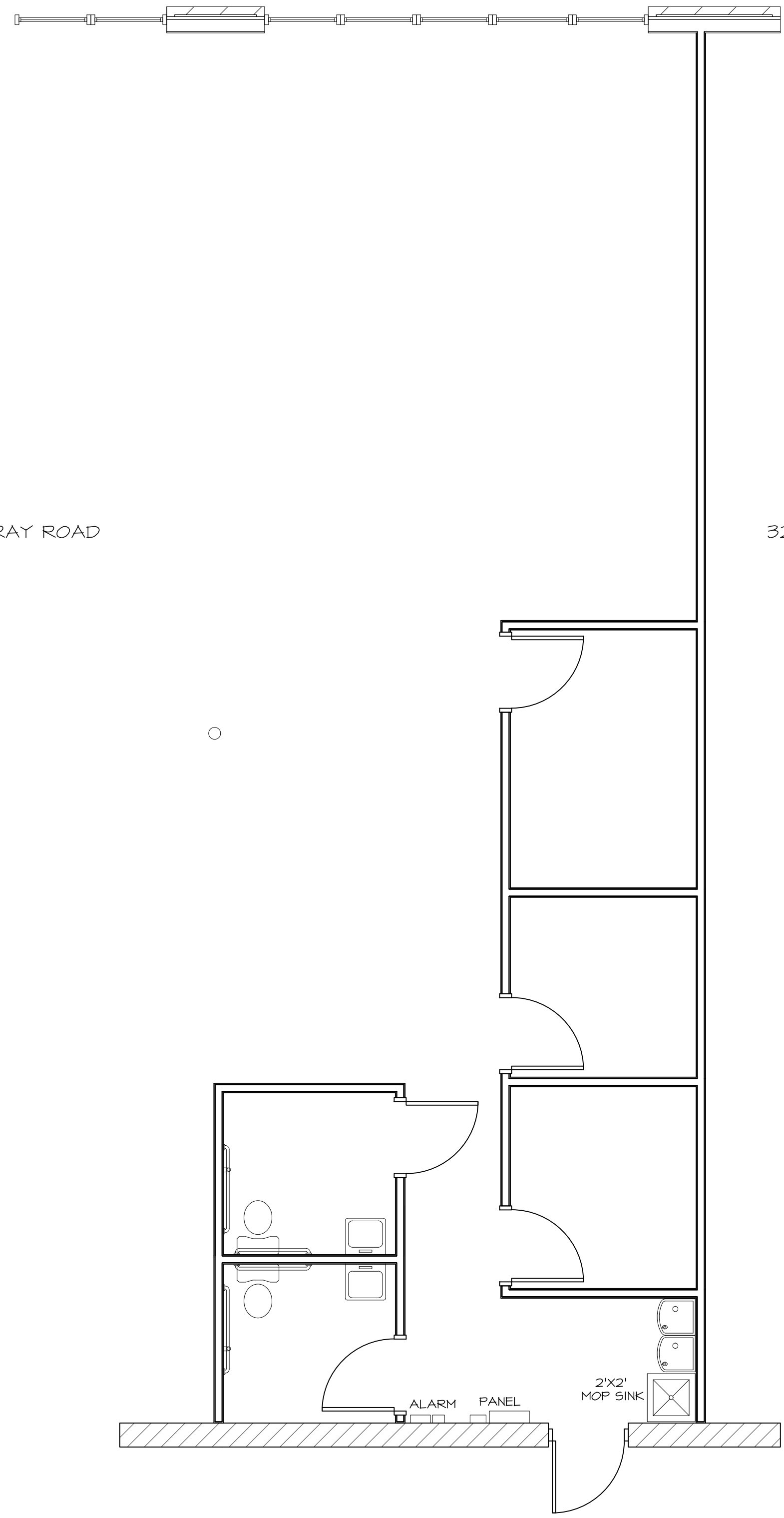

2
G1
EXISTING FLOOR PLAN
1/4" = 1' - 0"

3266 RAY ROAD

3274 RAY ROAD

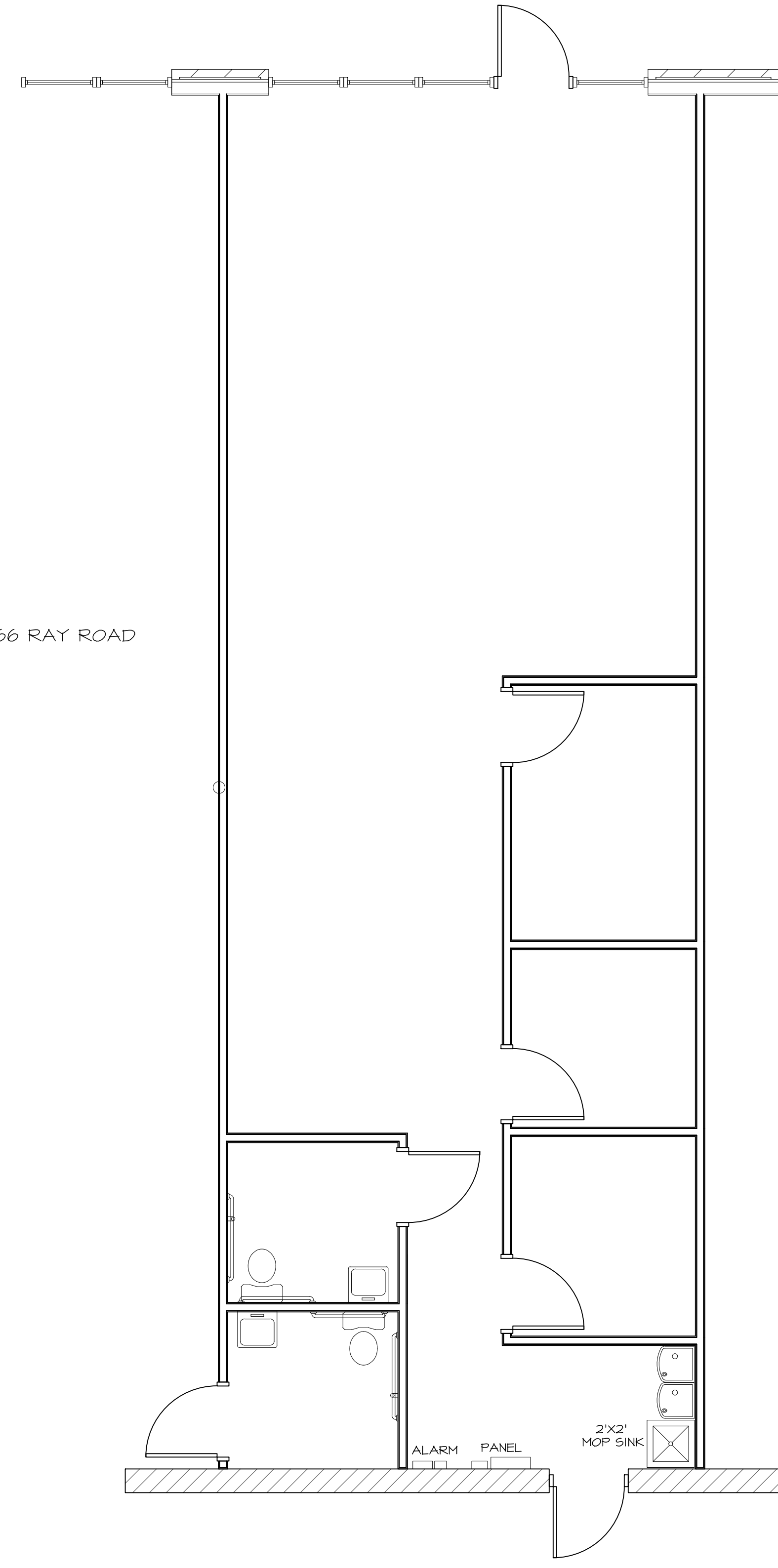

1
G1
FLOOR PLAN
1/4" = 1' - 0"

REVISIONS:

GEORGE M. ROSE, P.E.
P.O. BOX 53441
FAYETTEVILLE, NC 28305

0 910-485-5822 M 910-977-5822 EMAIL george@gmrpe.com

INTERIOR UPFIT PLAN
SPRING LAKE, NC

3268 RAY ROAD

EXISTING AND PROPOSED FLOOR PLANS

DATE: SEP 2022

DRAWN BY: GMR

CHECKED: GMR

SCALE: NOTED

SHEET NO.

G1